

II. FISCAL IMPACT ANALYSIS

A. Five Year Summary of Fiscal Impact:

Fiscal Years	<u>2019</u>	<u>2020</u>	<u>2021</u>	<u>2022</u>	<u>2023</u>
Capital Expenditures	_____	_____	_____	_____	_____
Operating Costs	_____	_____	_____	_____	_____
Operating Revenues	<u>(\$1,740)</u>	<u>\$-0-</u>	<u>\$-0-</u>	<u>\$-0-</u>	<u>\$-0-</u>
Program Income (County)	_____	_____	_____	_____	_____
In-Kind Match (County)	_____	_____	_____	_____	_____
NET FISCAL IMPACT	<u>(\$1,740)</u>	<u>\$-0-</u>	<u>\$-0-</u>	<u>\$-0-</u>	<u>\$-0-</u>
# ADDITIONAL FTE	_____	_____	_____	_____	_____
POSITIONS (Cumulative)	_____	_____	_____	_____	_____

Is Item Included in Current Budget? Yes X No _____
 Does this item include the use of federal funds? Yes _____ No X

Budget Account No: Fund 4100 Department 120 Unit 8430 RSource 4414
 Reporting Category _____

B. Recommended Sources of Funds/Summary of Fiscal Impact:

The Fourth Amendment adds 177 square feet of space effective August 1, 2019. The FY2019 rental rate for JetBlue, a signatory airline, is \$58.98 per square foot. The term of this agreement expires September 30, 2019.

C. Departmental Fiscal Review: *[Signature]* _____

III. REVIEW COMMENTS

A. OFMB Fiscal and/or Contract Development and Control Comments:

[Signature] _____
 OFMB *[Signature]* 8/15

[Signature] _____
 Contract Dev. and Control *[Signature]* 8/22/19
 [Signature] 8/21/19 TW

B. Legal Sufficiency:

[Signature] 8-23-19
 Assistant County Attorney

C. Other Department Review:

 Department Director

REVISED 11/17

(THIS SUMMARY IS NOT TO BE USED AS A BASIS FOR PAYMENT)

JETBLUE AIRWAYS CORPORATION

Assistant Secretary's Certificate

I, the undersigned Assistant Secretary of JetBlue Airways Corporation, a Delaware corporation, (the "Company"), do hereby certify that:

The following resolution was adopted by the Board of Directors of the Company on May 18, 2017:

GENERAL CORPORATE RESOLUTION

WHEREAS, the Company is required to execute applications, contracts, leases, loan agreements and other deeds and documents or instruments in the ordinary course of business;

NOW THEREFORE, BE IT:

RESOLVED, that the Chief Executive Officer, the President, the Chief Financial Officer, the General Counsel, the Treasurer, the Controller, any Executive Vice President, any Senior Vice President or any Vice President of the Company be, and they hereby are, authorized to sign and execute in the name of the Company all applications, contracts, leases, loan agreements and other deeds and documents or instruments in writing of whatsoever nature that may be required in the ordinary course of business of the Company and that may be necessary to secure for operation of the corporate affairs, governmental permits and licenses for, and incidental to, the lawful operation of the business of the Company, and to do such acts and things as such officers deem necessary or advisable to fulfill such legal requirements as are applicable to the corporation and its business.

[Remainder of page intentionally left blank]

IN WITNESS WHEREOF, the undersigned has signed this Certificate this 6th day of August 2018.

Dora G. Habachy

Name: DORA G. HABACHY

Title: Assistant Secretary



for Palm Beach County

Request Help Airport Properties
 (mailto:support@jdidata.com?subject=CTraxRequest)

Projects Signatory Airline Agreement

- Dashboard (/Dashboard)
- Projects (/Projects)
- COI Request (/Certificates/Requests)
- Document Library
- Data
- Settings
- Reports

Project Details Documents Risk Profile Import/Review Pending Request Exceptions Auditlog

Pending Review

Showing 0 to 0 of 0 entries

Code	Provider Name	Coverages / LOBs	Requested On	Requested By	Docs	Status
------	---------------	------------------	--------------	--------------	------	--------

No Records Found

Show 5 entries

Previous Next

Coverages

Showing 1 to 8 of 8 entries

Provider Name	LOB	Policy #	Eff Date	Exp Date	Approved On	Approved By	
Jetblue Airways Corporation	WORKERS' COMPENSATION AND EMPLOYERS' LIABILITY	100 0003597 Composite	04/01/2019	04/01/2020	05/20/2019	CT Support	(/Storage/Account/E6F1C
Jetblue Airways Corporation	UMBRELLA LIABILITY	A1AL000033718A	12/01/2018	12/01/2019	05/20/2019	CT Support	(/Storage/Account/E6F1C
Jetblue Airways Corporation	AUTOMOBILE LIABILITY	1000600318191 MA	05/01/2019	05/01/2020	05/20/2019	CT Support	(/Storage/Account/E6F1C
Jetblue Airways Corporation	LIQUOR LIABILITY	JS1816910	12/01/2018	12/01/2019	05/30/2019	CT Support	
Jetblue Airways Corporation	AIRCRAFT LIABILITY	A1AL000033718AM	05/20/2019	05/20/2020	05/30/2019	CT Support	
Jetblue Airways Corporation	WORKERS' COMPENSATION AND EMPLOYERS' LIABILITY	100 0003596 Non-Composite	04/01/2019	04/01/2020	05/20/2019	CT Support	(/Storage/Account/E6F1C
Jetblue Airways Corporation	AUTOMOBILE LIABILITY	1000600317191 AOS	05/01/2019	05/01/2020	05/20/2019	CT Support	(/Storage/Account/E6F1C
Jetblue Airways Corporation	COMMERCIAL GENERAL LIABILITY	A1AL000033718AM		05/20/2020	05/20/2019	CT Support	

Show 10 entries

Previous 1 Next

Rejected Coverages

Showing 0 to 0 of 0 entries

Provider Name	LOB	Policy #	Comments	Rejected On	Rejected By	Docs
---------------	-----	----------	----------	-------------	-------------	------

No Records Found

Show 5 entries

Previous Next

**FOURTH AMENDMENT TO SIGNATORY AIRLINE AGREEMENT BETWEEN
PALM BEACH COUNTY AND JETBLUE AIRWAYS CORPORATION**

THIS FOURTH AMENDMENT TO SIGNATORY AIRLINE AGREEMENT (this "Third Amendment") is made and entered into this August 1, 2019 (the "Effective Date"), by and between Palm Beach County, a political subdivision of the State of Florida ("County"), and JetBlue Airways Corporation, a Delaware corporation, having its office and principal place of business at 27-01 Queens Plaza North, Long Island City, New York 11101 ("Airline").

WITNESSETH:

WHEREAS, County, by and through its Department of Airports (the "Department"), owns and operates the Palm Beach International Airport, located in Palm Beach County, Florida; and

WHEREAS, pursuant to the Signatory Airline Agreement between County and Airline dated November 18, 2014 (R2014-1719, as amended) (the "Agreement"), Airline leases various terminal facilities and equipment at the Airport in connection with its operations as a commercial air carrier; and

WHEREAS, the Director of the Department has been delegated the authority to execute certain amendments to the Agreement pursuant to County Resolution No. 2014-1033; and

WHEREAS, the parties desire to amend the Agreement as provided for herein.

NOW, THEREFORE, in consideration of the premises and of the mutual covenants herein contained, and for other good and valuable consideration, the receipt of which the parties hereby expressly acknowledge, the parties hereto covenant and agree to the following terms and conditions:

1. The foregoing recitals are true and correct and are hereby incorporated herein by reference and made a part hereof. Terms not defined herein shall have the meaning ascribed to them in the Agreement.
2. Exhibit "B" (Preferential Use Premises (Terminal Areas)) to the Agreement is hereby deleted in its entirety and replaced with Exhibit "B" (Preferential Use Premises (Terminal Areas)) attached to this Fourth Amendment, and incorporated herein.
3. Except as specifically modified herein, all of the terms and conditions of the Agreement shall remain unmodified and in full force and effect and are hereby ratified and confirmed by the parties hereto.
4. This Fourth Amendment shall become effective when signed by both parties hereto and approved by Palm Beach County.

(Remainder of page intentionally left blank)

IN WITNESS WHEREOF, the parties hereto have duly executed this Fourth Amendment as of the day and year first above written.

Signed, sealed and delivered in the presence of two (2) witnesses for County:

[Signature]
Signature

Stevenson, Sellamy
Print Name

[Signature]
Signature

Shakira Kolb
Print Name

PALM BEACH COUNTY, a political subdivision of the State of Florida

BY: [Signature]
Director, Department of Airports

APPROVED AS TO FORM & LEGAL SUFFICIENCY:

[Signature]
County Attorney

Signed, sealed and delivered in the presence of two (2) witnesses for Airline:

[Signature]
Signature

FRANK MANFREDIWI
Print Name

[Signature]
Signature

Mary Lou Richards
Print Name

Airline: JetBlue Airways Corporation

By: [Signature]

LISA REIFER
Typed or printed name of Corporate Officer

Title: VP, Infrastructure, Properties & DEVELOPMENT

(Seal)

**EXHIBIT "B" – Preferential Use Premises (Terminal Areas)
JetBlue Airways Corporation**

First Level Plan – Palm Beach International Airport Main Terminal

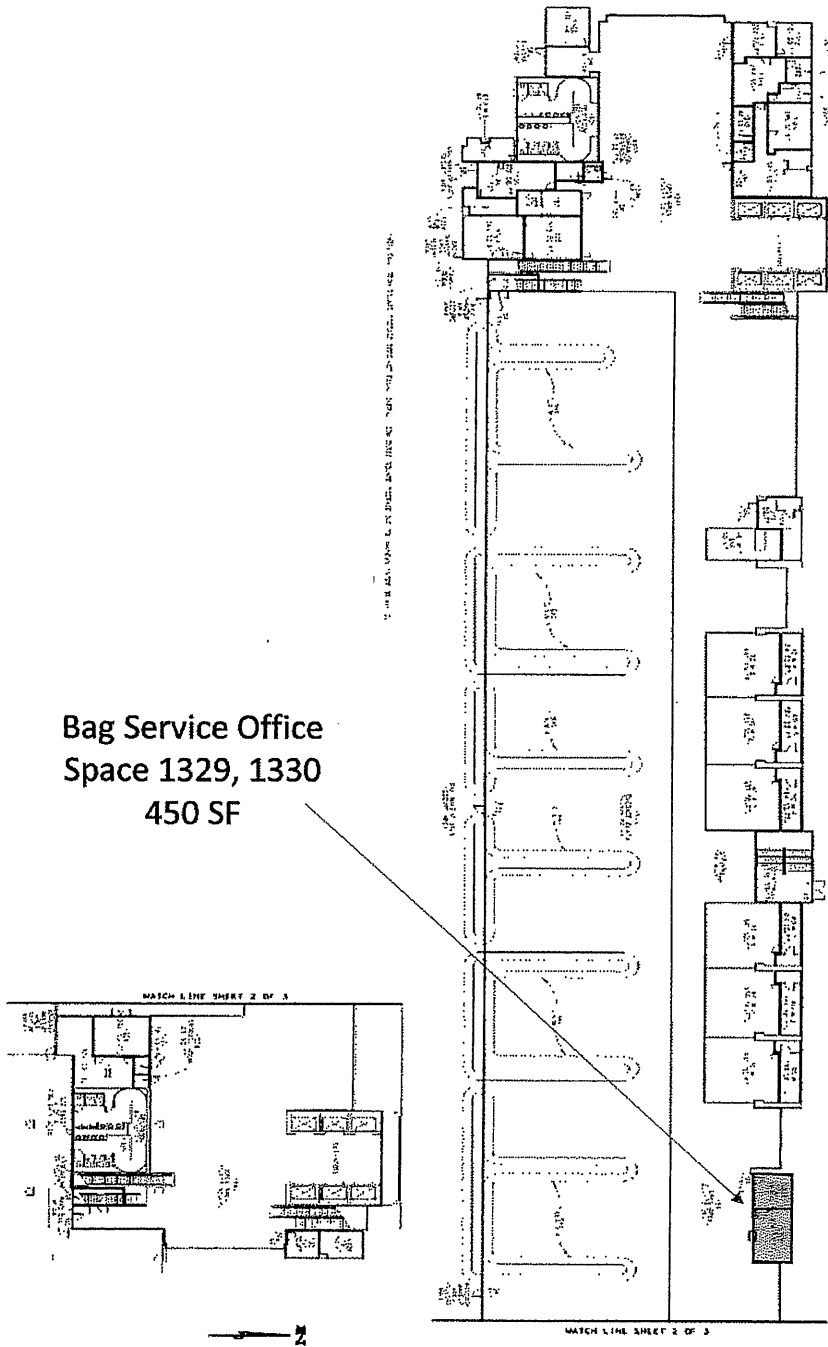

**Bag Service Office
Space 1329, 1330
450 SF**

**EXHIBIT "B" – Preferential Use Premises (Terminal Areas)
JetBlue Airways Corporation**

First Level Plan – Palm Beach International Airport Concourse "C"

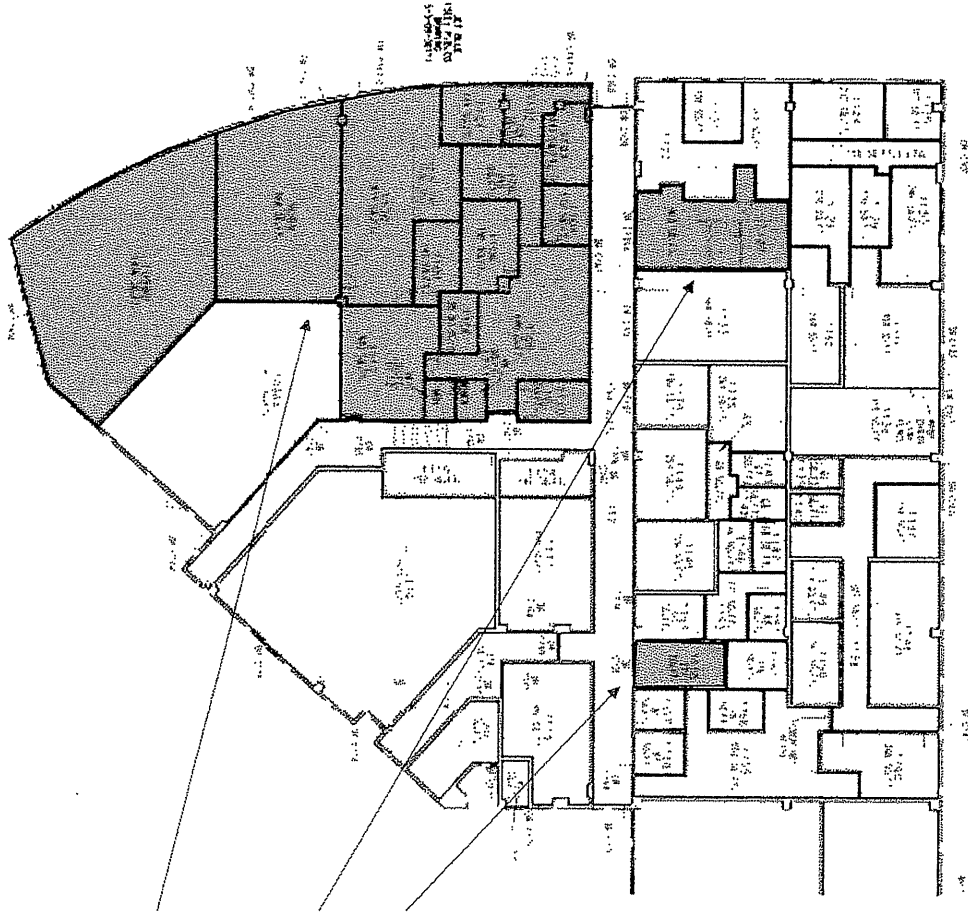

**Operations Area
6,356 SF**

**EXHIBIT "B" – Preferential Use Premises (Terminal Areas)
JetBlue Airways Corporation**

Second Level Plan – Palm Beach International Airport

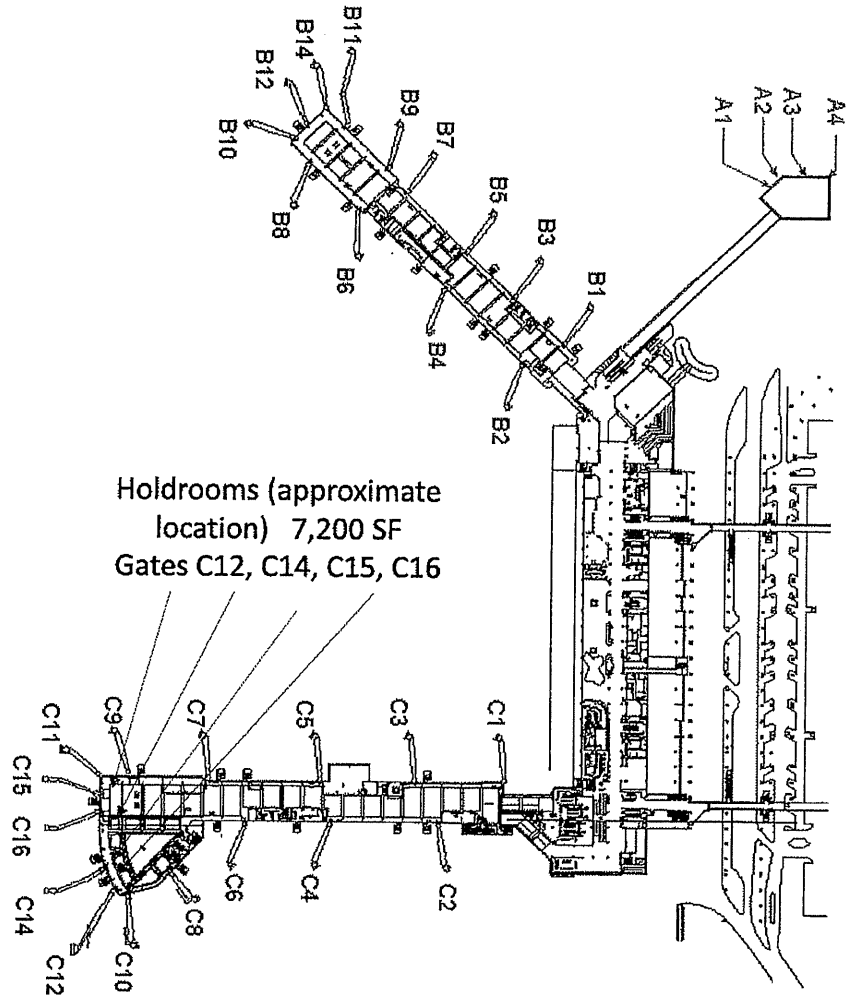

EXHIBIT "B" - Preferential Use Premises (Terminal Areas)
JetBlue Airways Corporation

Third Level Plan - Palm Beach International Airport Main Terminal

Curbside Office
Space 3143, 3144
177 SF

Kiosk
Area
226 SF

Ticket Counter
1,459 SF (detail
on next page)

Ticket Office
1,122 SF (detail
on next page)

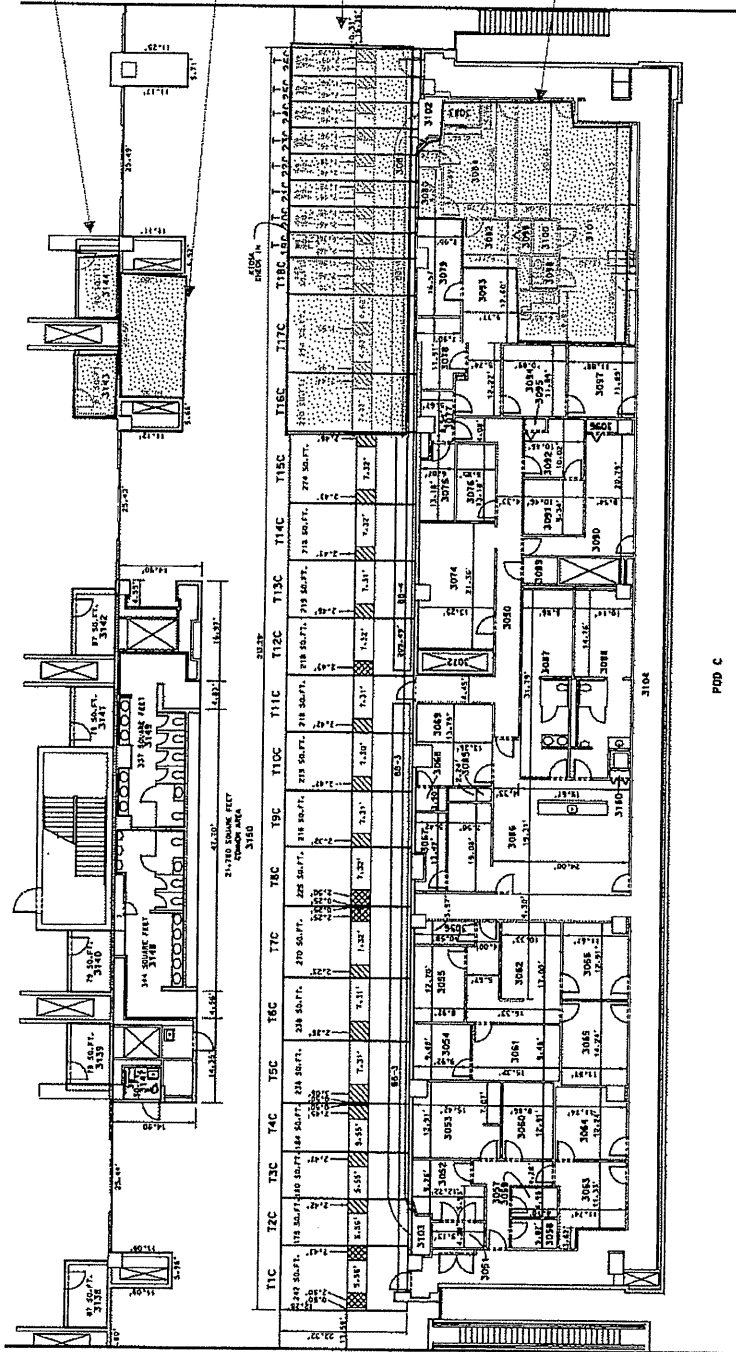

POD C

**EXHIBIT "B" - Preferential Use Premises (Terminal Areas)
JetBlue Airways Corporation**

Third Level Plan (In Detail) - Palm Beach International Airport Main Terminal

KIOSK CHECK IN		T16C	T17C	T18C	T19C	T20C	T21C	T22C	T23C	T24C	T25C	T26C
		220 SQ.FT.	294 SQ.FT.	143 SQ.FT.	99 SQ.FT.	99 SQ.FT.	99 SQ.FT.	99 SQ.FT.	99 SQ.FT.	99 SQ.FT.	99 SQ.FT.	109 SQ.FT.
		2.44' 1.95'	1.95'	1.96' 2.46' 1.96'	2.46' 1.96'	2.46' 1.95'	2.46' 1.98'	2.46' 1.98'	2.46' 1.96'	2.46' 1.96'	2.46' 1.96'	2.46' 2.09' 12.28'
		7.32'	4.62'	4.62'								
				BB-4				308				

