

**PALM BEACH COUNTY  
BOARD OF COUNTY COMMISSIONERS**

**AGENDA ITEM SUMMARY**

**Meeting Date:** 01/07/2020

**Consent**

**Regular**

**Ordinance**

**Public Hearing**

**Department:** Supervisor of Elections

**Submitted By:** Wendy Sartory Link

**I. EXECUTIVE BRIEF**

**Motion and Title:** Staff recommends motion to approve: 3 precinct boundary changes, submitted by Wendy Sartory Link, Supervisor of Elections, as required by section 101.001(1), Florida Statutes.

**Summary:** 3 Precinct boundary changes are recommended by Wendy Sartory Link, Supervisor of Elections (SOE), due to municipal annexations in Delray Beach and Palm Springs. Districts 3 and 5 (AH)

**Background and Justification:** Florida Statute, section 101.001(1) requires that precinct boundary changes must be approved by a majority of the Board of County Commissioners, upon recommendation and approval of the SOE. Due to municipal annexations in Delray Beach and Palm Springs, the SOE is recommending a change to the size of 3 precincts. A description of the changed boundaries is more particularly described in the attachments.

**Attachments:**

1. List of precinct changes
2. Precinct Maps showing the areas affected
3. Legal Descriptions of the precincts

**Recommended by:** Wendy Sartory Link \_\_\_\_\_ **Date**  
**Department Director**  
 WENDY SARTORY LINK, SUPERVISOR OF ELECTIONS

**Approved By:** Phil A. Ben \_\_\_\_\_ **Date**  
 County/Deputy/Assistant County Administrator



**PRECINCT BOUNDARY CHANGES SUBMITTED TO  
THE BOARD OF COUNTY COMMISSIONERS**

**PRECINCT BOUNDARY CHANGES – DUE TO MUNICIPAL ANNEXATIONS**

3070 – 3072 – 5082

(3 PRECINCTS)

Pct 3070 – 3072

UNICORPORATED  
→ PS

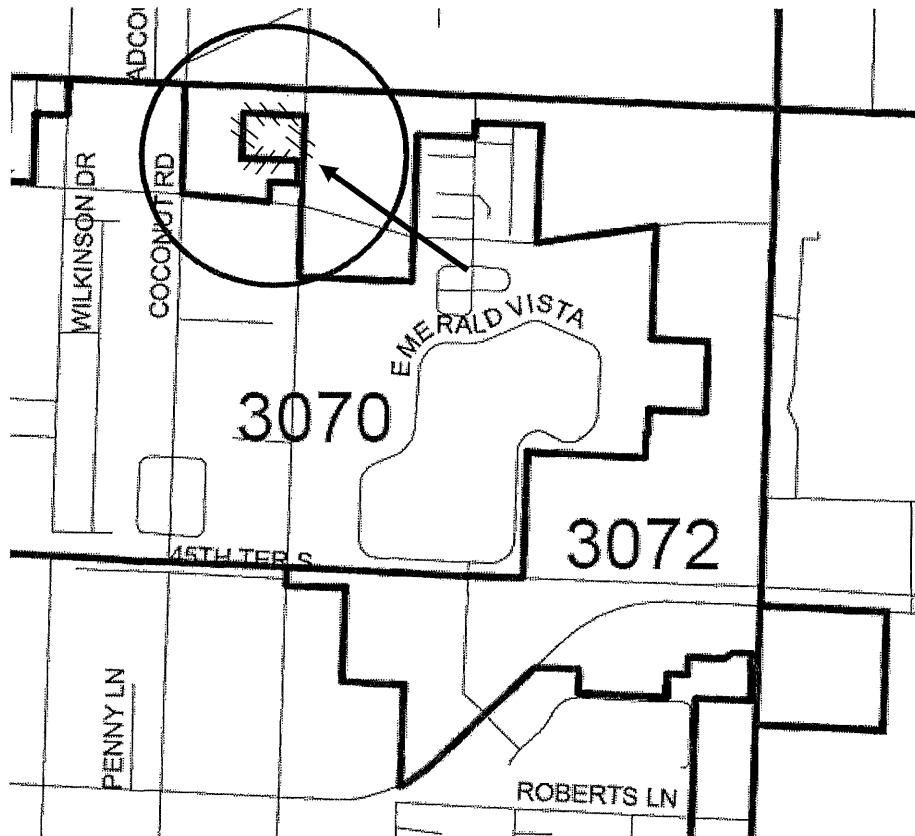

Pct 5082 – NP

UNICORPORATED  
→ DB

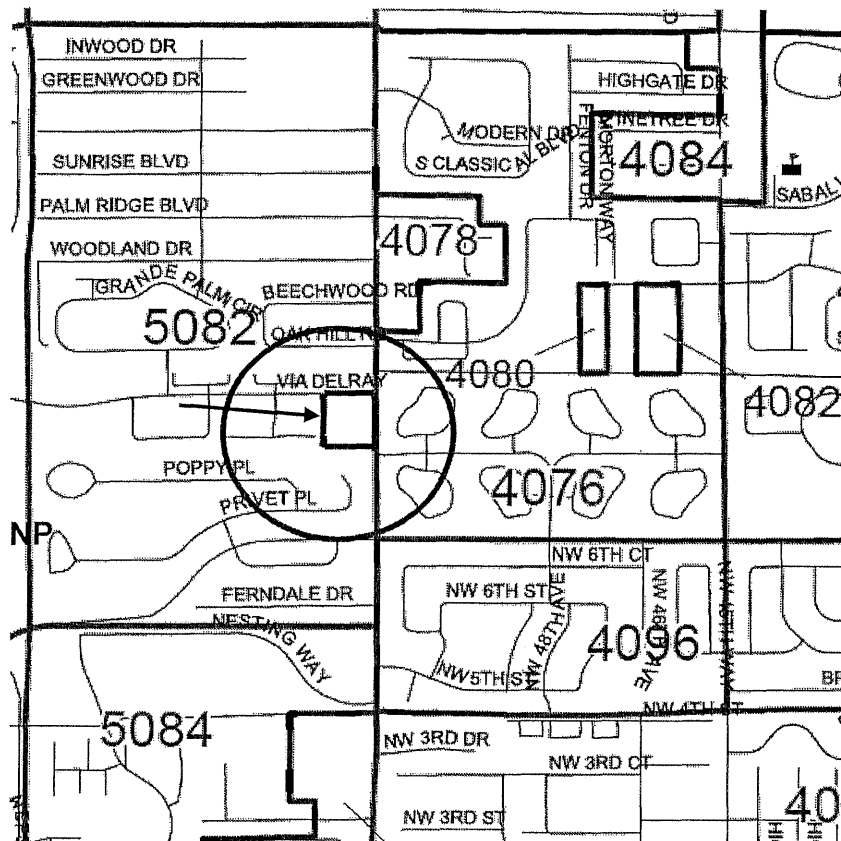

THE BOUNDARIES OF ELECTION PRECINCT NO. 3070 SHALL BE AS FOLLOWS:

BEING ALL THAT UNINCORPORATED AREA OF PALM BEACH COUNTY LYING: NORTH OF THE LAKE WORTH DRAINAGE DISTRICT CANAL L-13; SOUTH OF LAKE WORTH ROAD; EAST OF SOUTH MILITARY TRAIL; AND WEST OF SOUTH CONGRESS AVENUE. EXCLUDING ALL THAT INCORPORATED AREA OF THE VILLAGE OF PALM SPRINGS WEST OF CONGRESS AVENUE AND NORTH OF THE LAKE WORTH DRAINAGE DISTRICT CANAL L-13.

(COURSES ALONG ROADS, RAILROADS, CANALS AND WATERWAYS ARE INTENDED TO BE ALONG THE CENTERLINES OF SAID THOROUGHFARES.)

MAY, 2012:	PRECINCT CREATED
JANUARY, 2017:	BOUNDARY CHANGE DUE TO MUNICIPAL ANNEXATION; CHANGE IN LEGAL DESCRIPTION
MAY, 2018:	BOUNDARY CHANGE DUE TO MUNICIPAL ANNEXATION
NOVEMBER, 2019:	BOUNDARY CHANGE DUE TO MUNICIPAL ANNEXATION

THE BOUNDARIES OF ELECTION PRECINCT NO. 3072 SHALL BE AS FOLLOWS:

BEING ALL THAT AREA WITHIN THE CORPORATE LIMITS OF THE VILLAGE OF PALM SPRINGS LYING: SOUTH OF LAKE WORTH ROAD; WEST OF SOUTH CONGRESS AVENUE; NORTH OF LAKE WORTH DRAINAGE DISTRICT CANAL L-14; AND EAST OF COCONUT ROAD AND ITS SOUTHERN EXTENSION. EXCLUDING ALL THAT UNINCORPORATED AREA EAST OF COCONUT ROAD AND ITS SOUTHERN EXTENSION; WEST OF SOUTH CONGRESS AVENUE AND NORTH OF LAKE WORTH DRAINAGE DISTRICT CANAL L-14.

(COURSES ALONG ROADS, RAILROADS, CANALS AND WATERWAYS ARE INTENDED TO BE ALONG THE CENTERLINES OF SAID THOROUGHFARES.)

- MAY, 2012:           PRECINCT CREATED
- JANUARY, 2017:   BOUNDARY CHANGE DUE TO MUNICIPAL ANNEXATION
- MAY, 2018:        BOUNDARY CHANGE DUE TO MUNICIPAL ANNEXATION
- NOVEMBER, 2019:  BOUNDARY CHANGE DUE TO MUNICIPAL ANNEXATION

THE BOUNDARIES OF ELECTION PRECINCT NO. 5082 SHALL BE AS FOLLOWS:

BEING ALL THAT UNINCORPORATED AREA OF PALM BEACH COUNTY LYING: SOUTH OF THE LAKE DRAINAGE DISTRICT CANAL L-30; EAST OF THE LAKE WORTH DRAINAGE DISTRICT CANAL E-3; WEST OF SOUTH MILITARY TRAIL; AND NORTH OF BLOCK 4006B OF CENSUS TRACT 0059.30. EXCLUDING: ALL THAT AREA OF THE CORPORATE LIMITS OF THE CITY OF DELRAY BEACH WEST OF SOUTH MILITARY TRAIL AND SOUTH OF VIA DELRAY.

(COURSES ALONG ROADS, RAILROADS, CANALS AND WATERWAYS ARE INTENDED TO BE ALONG THE CENTERLINES OF SAID THOROUGHFARES.)

MAY, 2012:           PRECINCT CREATED

NOVEMBER, 2019:   BOUNDARY CHANGE DUE TO MUNICIPAL ANNEXATION.