

Palm Beach County
2019 NOFA Impact Fee Affordable Housing Assistance Program
Riviera Hankinhomes Land Trust, HRY Development LLC as Trustee
Project Sites

District	Address	Property Control Number (PCN)	Impact Fee Assistance	Total
7	W. 31 st Street, Riviera Beach	56-43-42-29-03-015-0100	Zone 1 Roads \$4,717 Public Buildings \$194	\$4,911
7	1132 W. 31 st Street, Riviera Beach	56-43-42-29-09-003-0410	Zone 1 Roads \$4,717 Public Buildings \$194	\$4,911
7	W. 32 nd Street, Riviera Beach	56-43-42-29-09-002-0430	Zone 1 Roads \$4,717 Public Buildings \$194	\$4,911
7	1580 W. 32 nd Street Riviera Beach	56-43-42-29-02-021-0220	Zone 1 Roads \$4,717 Public Buildings \$194	\$4,911
7	1400 W. 30 th Street, Riviera Beach	56-43-42-29-03-015-0490	Zone 1 Roads \$4,717 Public Buildings \$194	\$4,911
7	141 W. 16 th Street, Riviera Beach	56-43-42-33-04-002-0060	Zone 1 Roads \$4,717 Public Buildings \$194	\$4,911
7	316 W. 15 th Street, Riviera Beach	56-43-42-28-08-005-0030	Zone 1 Roads \$4,717 Public Buildings \$194	\$4,911
7	1101 W. 33 rd Street, Riviera Beach	56-43-42-29-09-002-0010	Zone 1 Roads \$4,717 Public Buildings \$194	\$4,911
7	1090 W. 28 th Street, Riviera Beach	56-43-42-19-05-006-0190	Zone 1 Roads \$4,717 Public Buildings \$194	\$4,911
7	1564 W. 34 th Street, Riviera Beach	56-43-42-29-02-019-0380	Zone 1 Roads \$4,717 Public Buildings \$194	\$4,911

Location Map



W. 31st Street

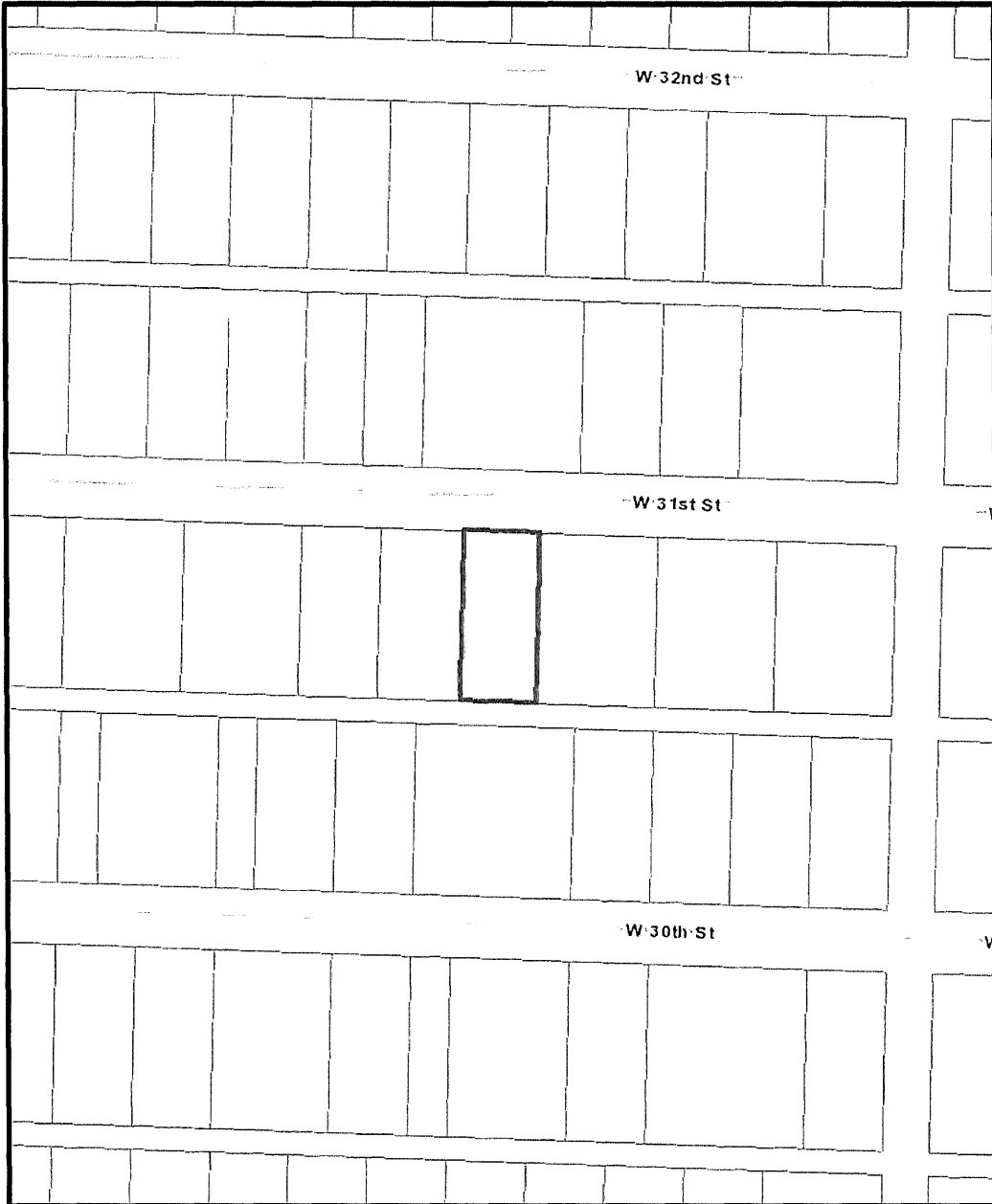

Location Map



1132 W. 31st Street

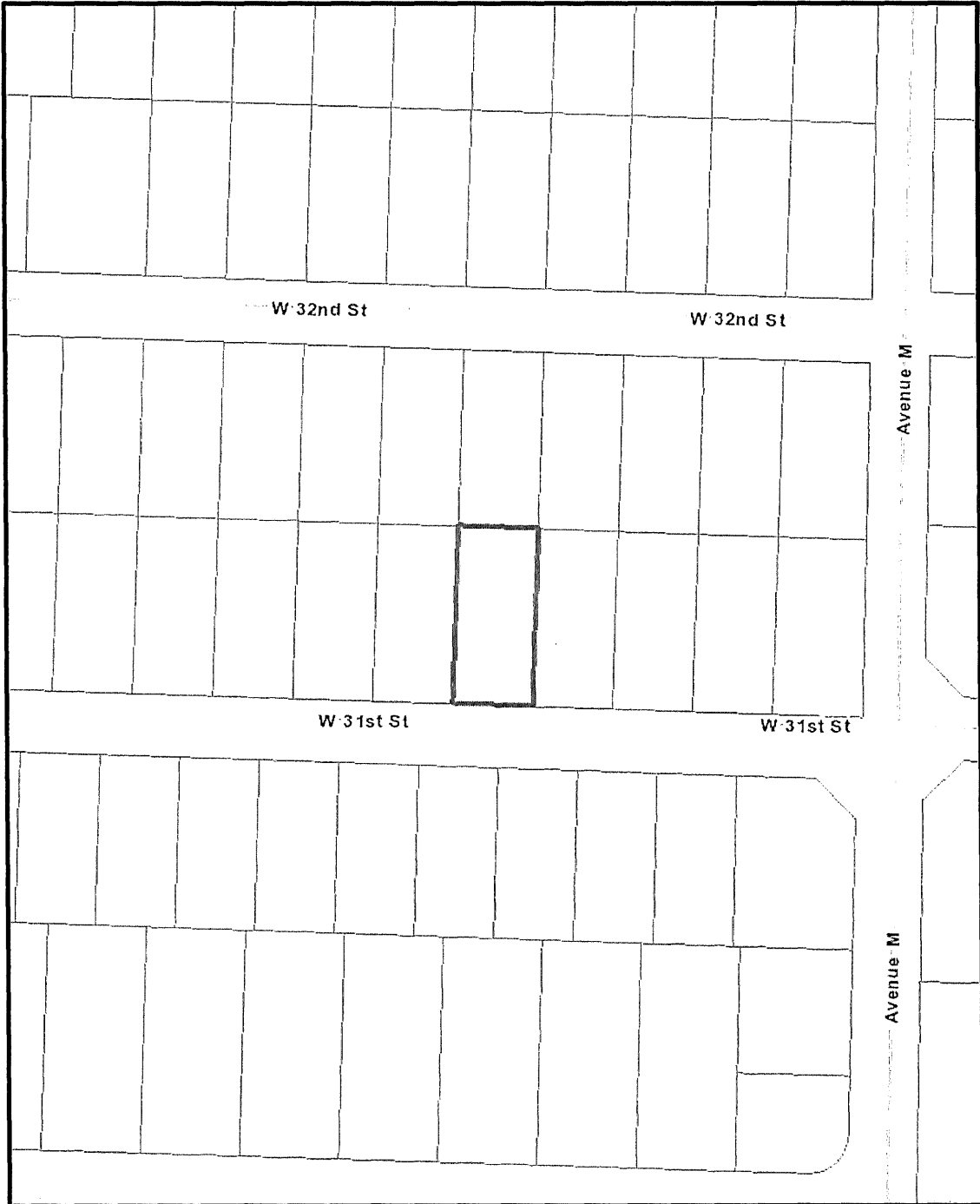

Location Map



W. 32nd Street

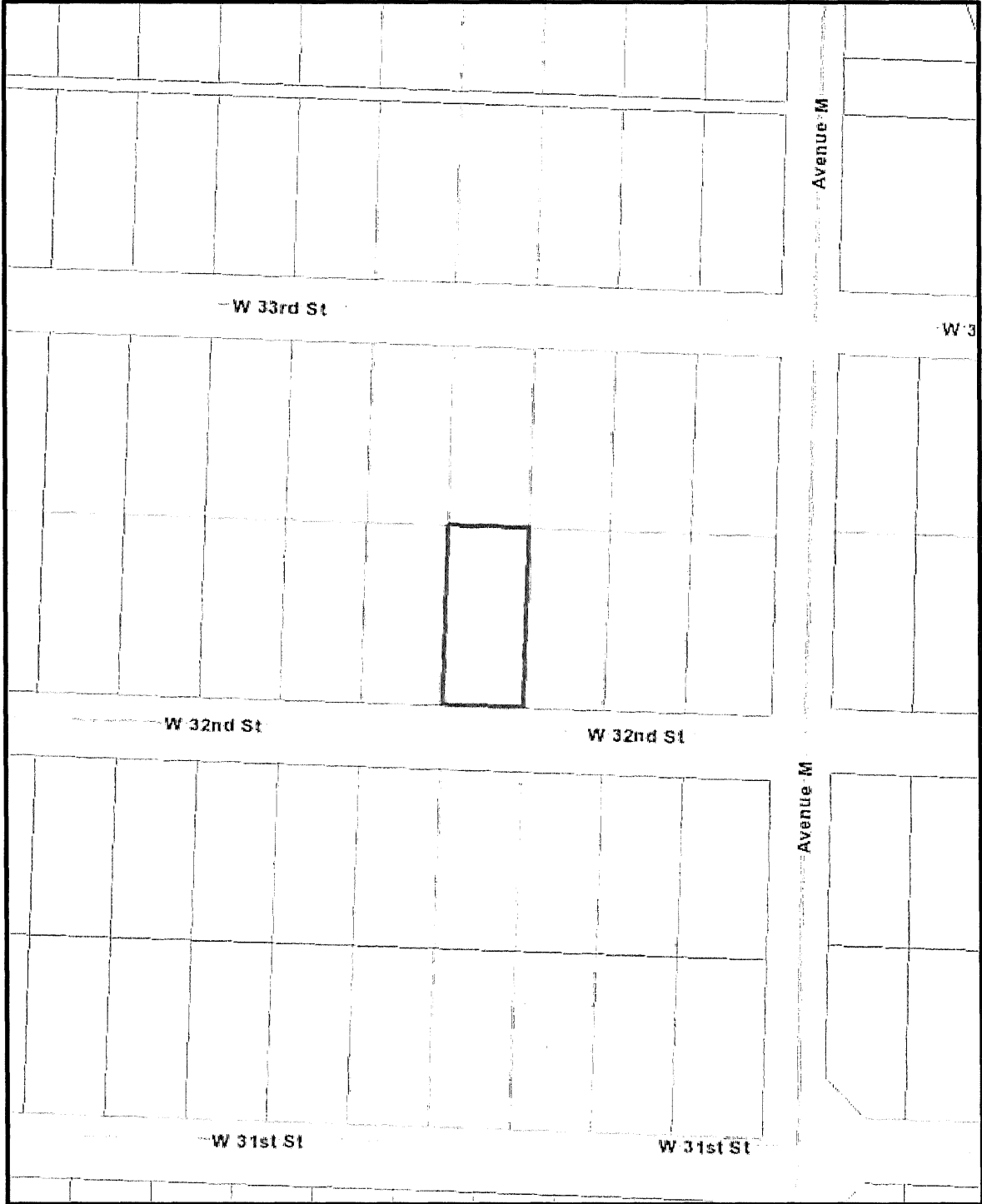

Location Map



1580 W. 32nd Street

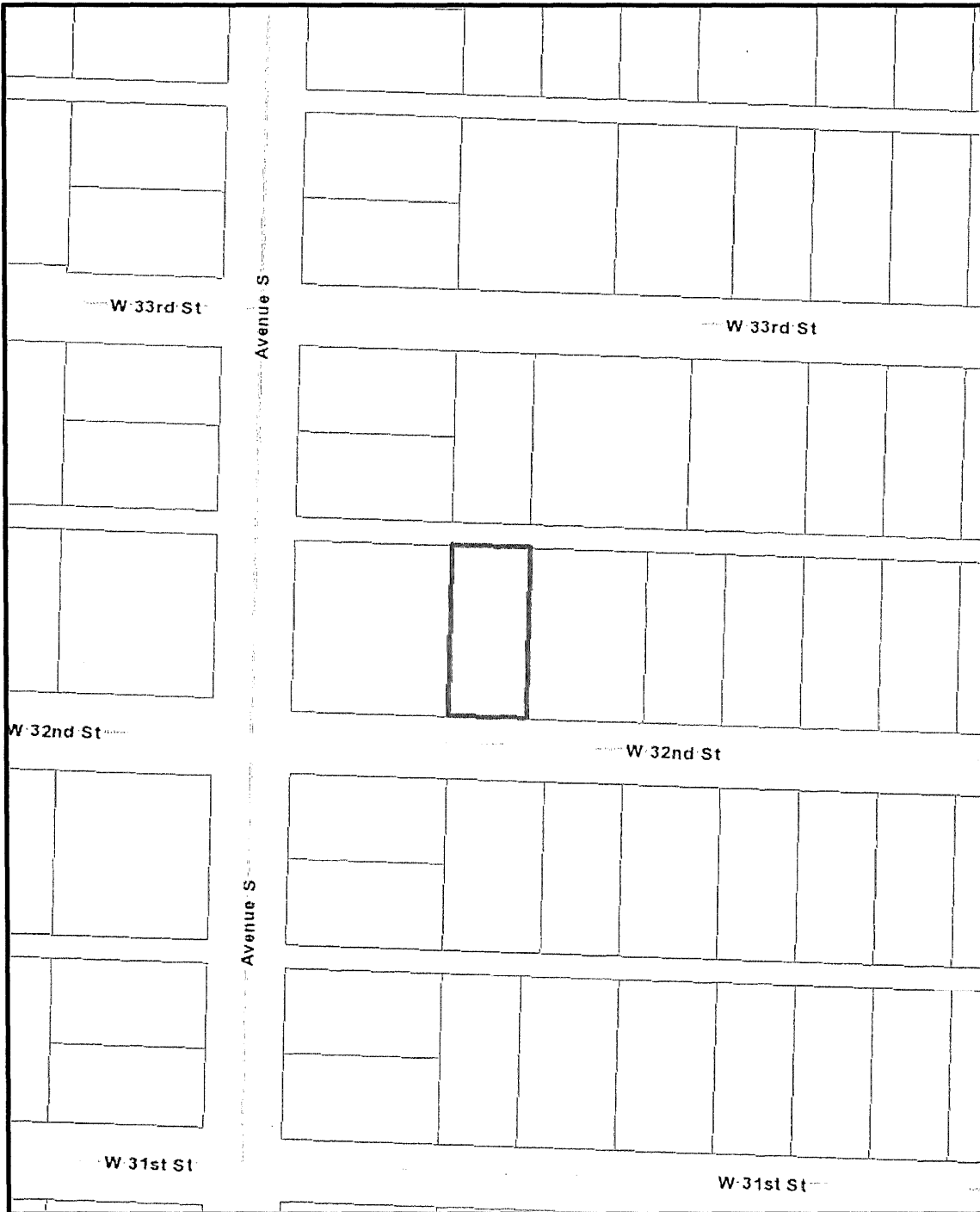

Location Map



1400 W. 30th Street

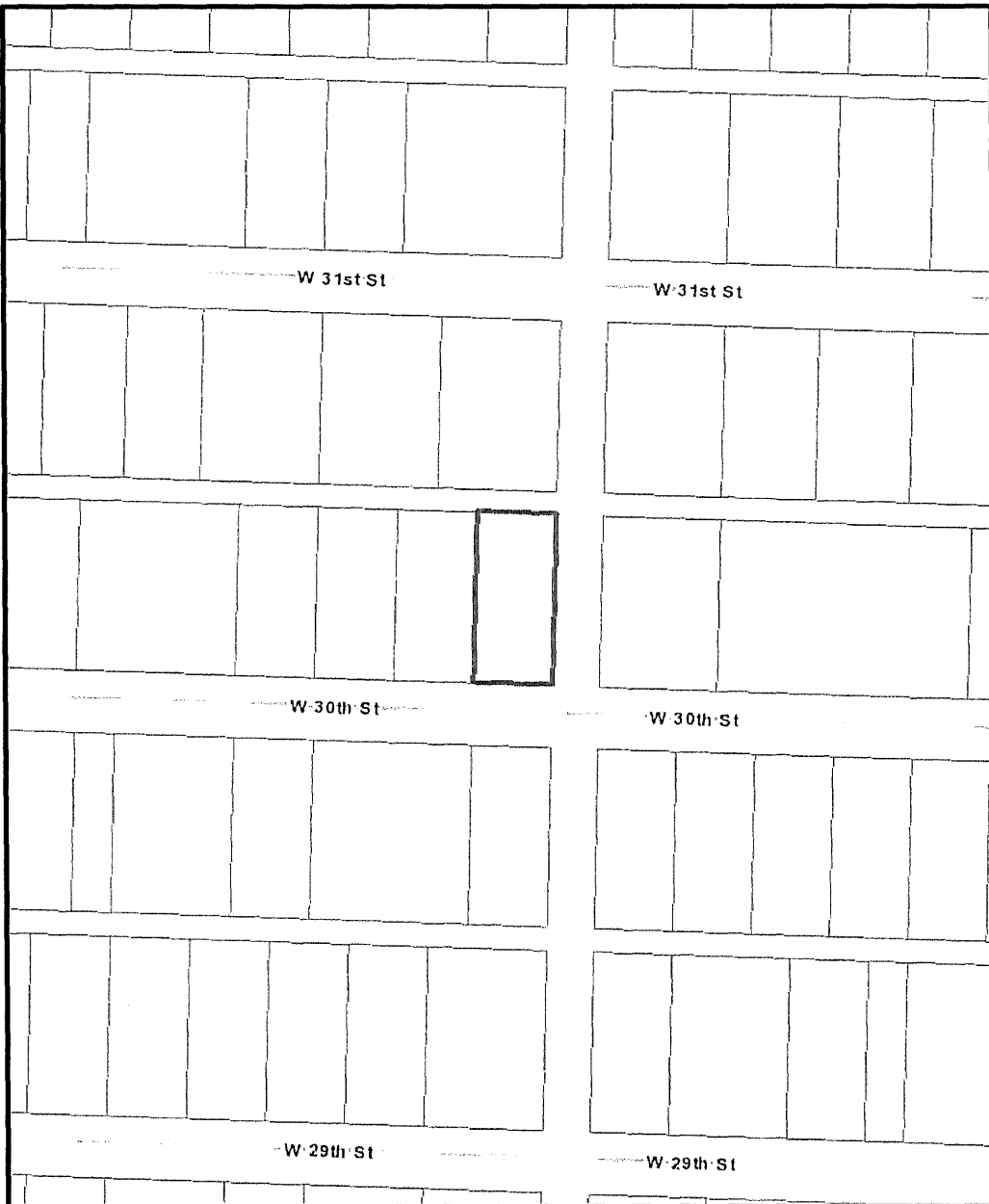

Location Map



141 W. 16th Street

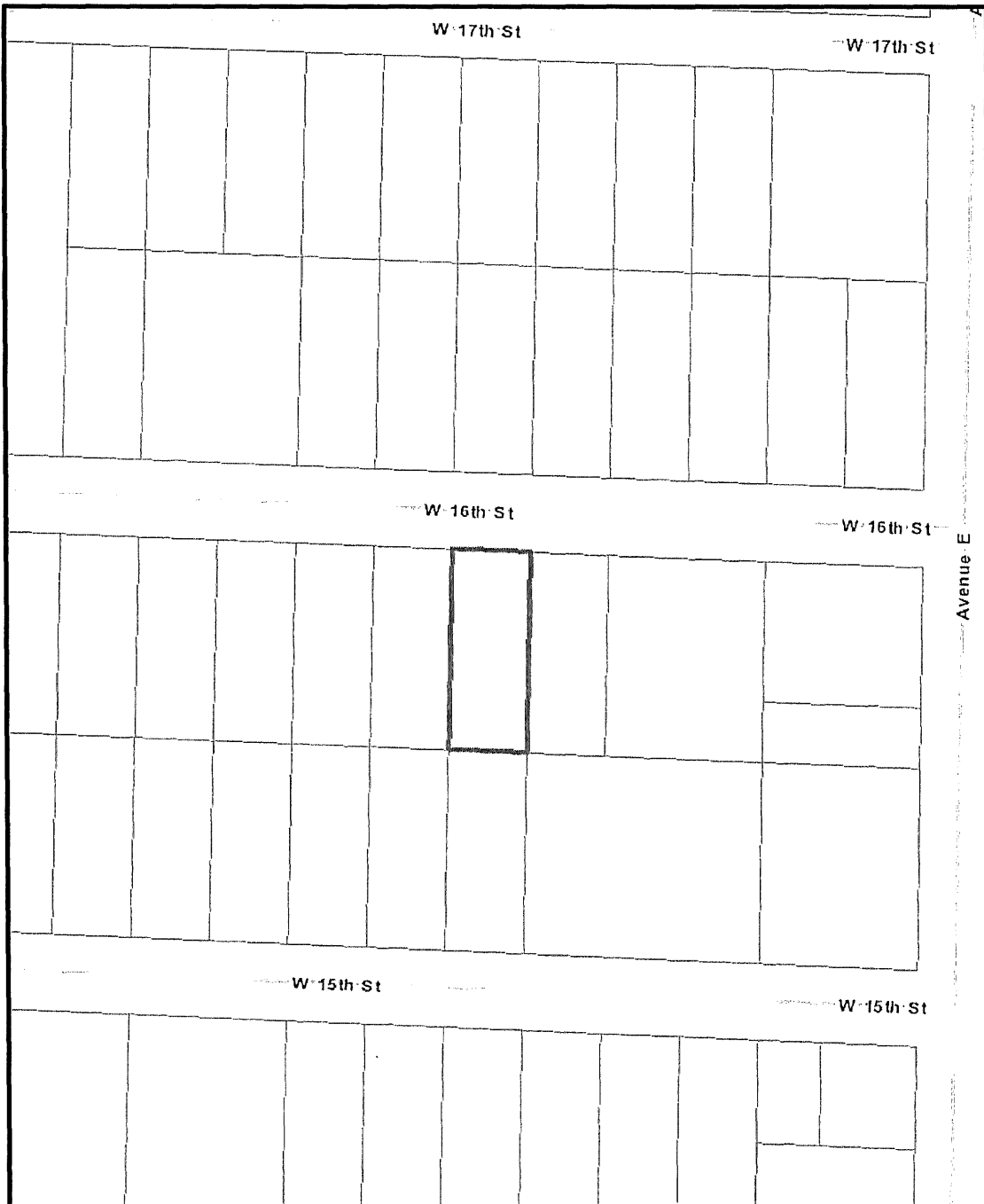

Location Map



316 W. 15th Street



Location Map



1101 W. 33rd Street

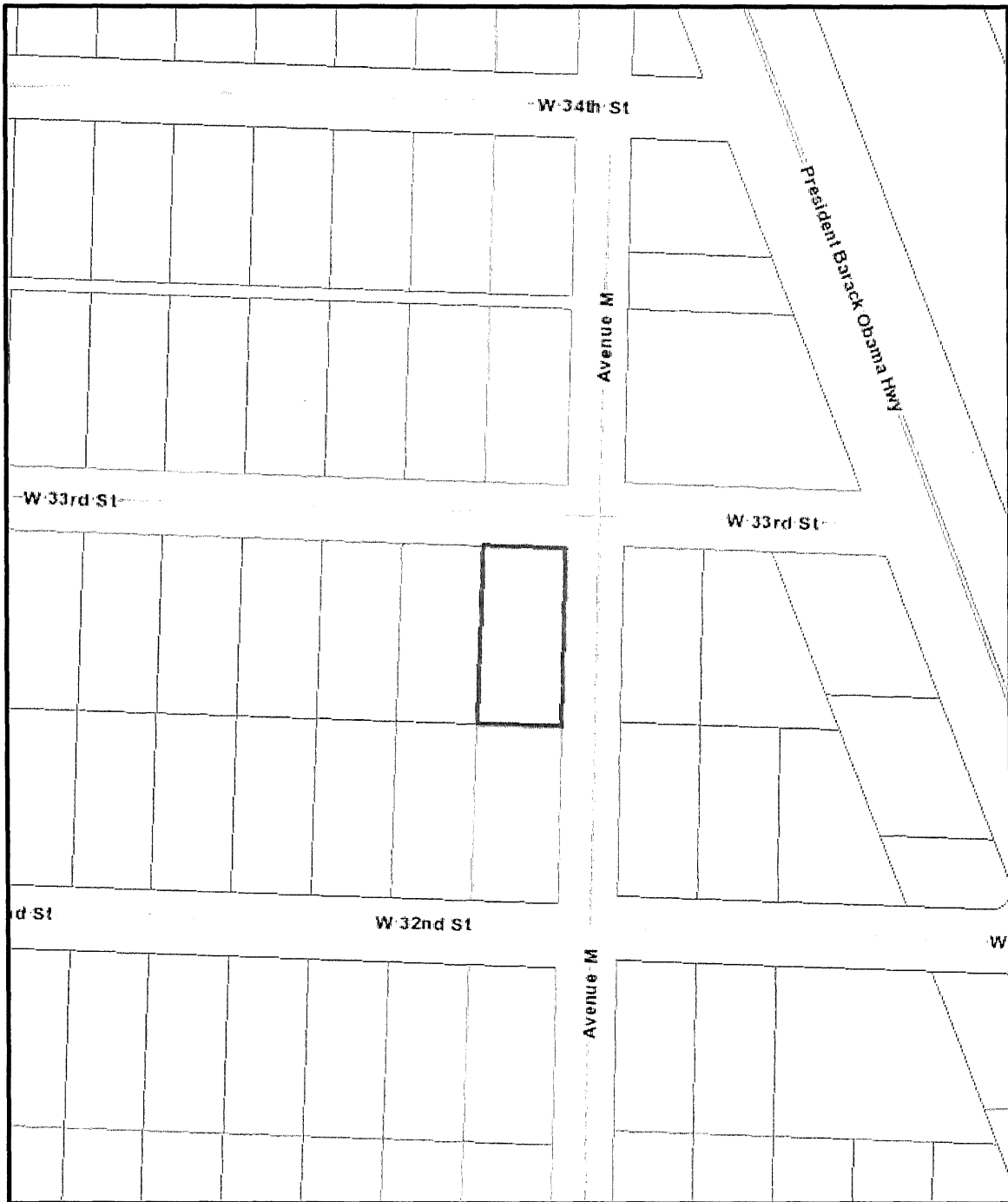

Location Map



1090 W 28th Street

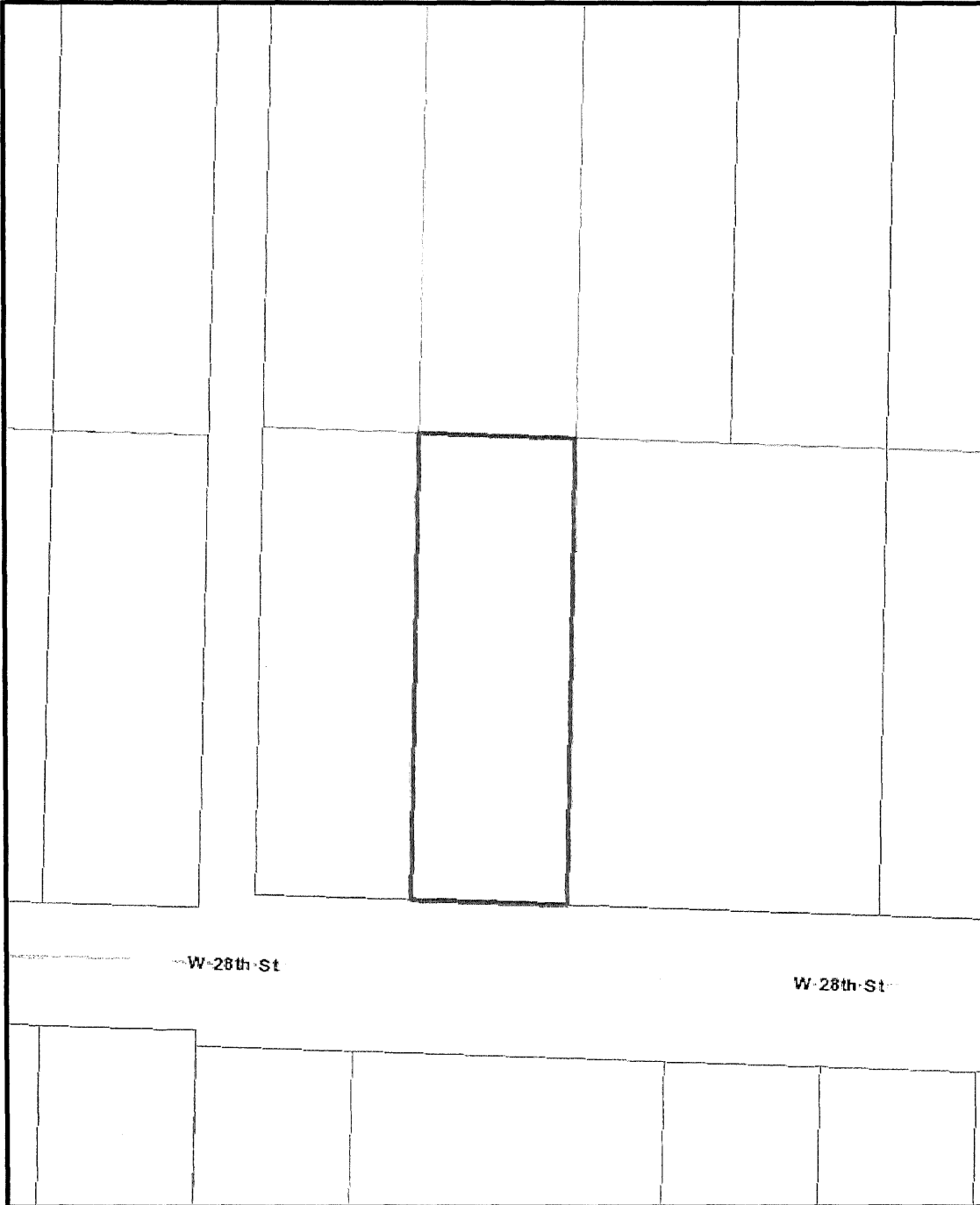

Location Map



1564 W 34th Street

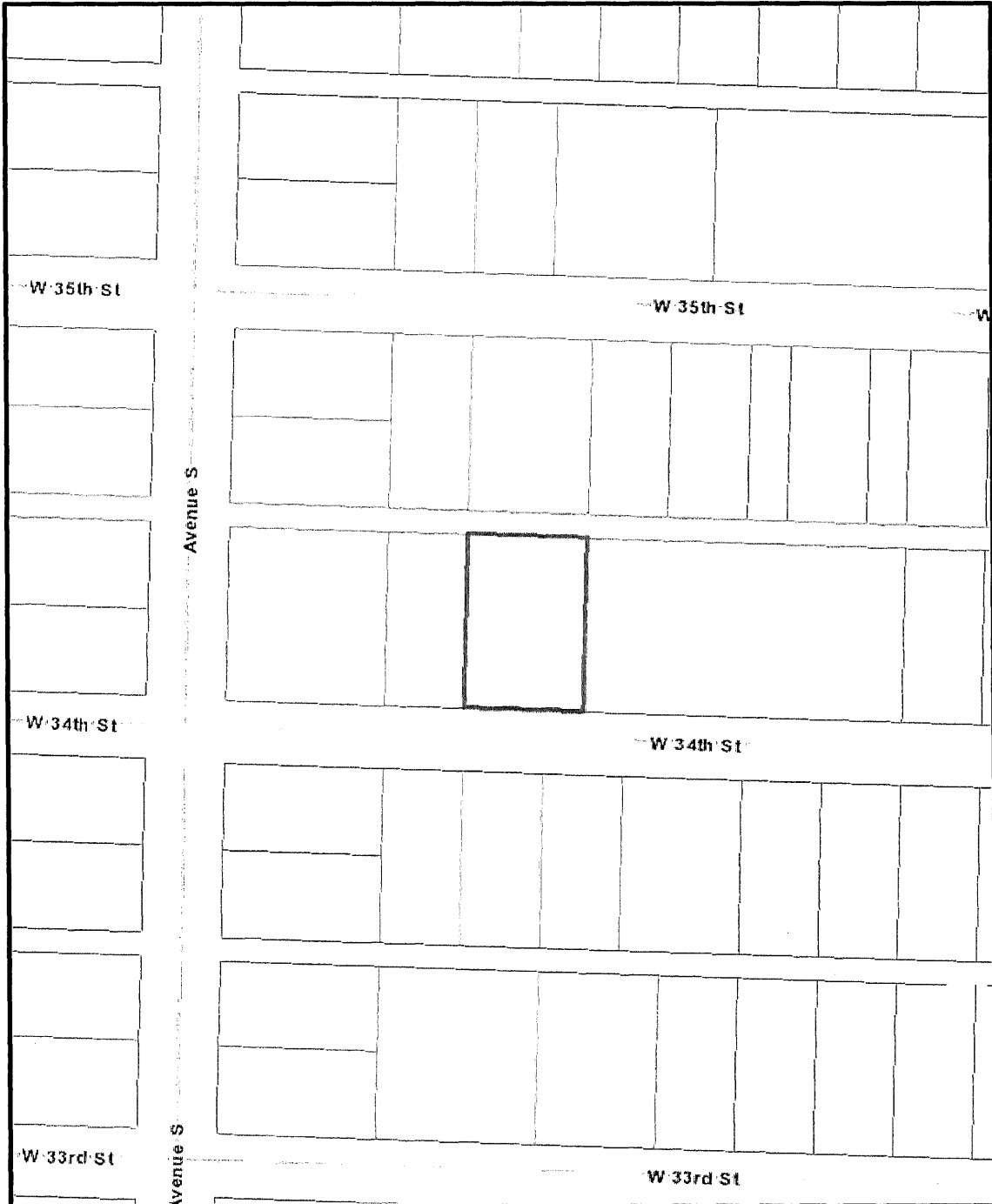

21- 0368

BOARD OF COUNTY COMMISSIONERS
PALM BEACH COUNTY, FLORIDA
BUDGET TRANSFER

Page 1 of 1

BGEX-143-12172000000481

FUND 3531-Impact Fee Assistance Program - Roads Zone 1

Use this form to provide budget for items not anticipated in the budget.

ACCOUNT NUMBER	ACCOUNT NAME	ORIGINAL BUDGET	CURRENT BUDGET	INCREASE	DECREASE	ADJUSTED BUDGET	EXPENDED/ ENCUMBERED 12/11/20	REMAINING BALANCE
EXPENDITURES								
143-1485-8201	Contributions - Non Governmental Agency	0	0	47,170	0	47,170	0	47,170
821-9705-9902	Operating Reserves	457,900	135,710	0	47,170	88,540	0	88,540
TOTAL EXPENDITURES				47,170	47,170			

Department of Housing and Economic Sustainability

INITIATING DEPARTMENT/DIVISION

Administration/Budget Department Approval

OFMB Department - Posted

Signatures

[Handwritten Signature]

[Handwritten Signature]

Date

1-7-21

1/12/21

By Board of County Commissioners

At Meeting of :

February 9, 2021

Deputy Clerk to the

Board of County Commissioners

21- 0369

BOARD OF COUNTY COMMISSIONERS
PALM BEACH COUNTY, FLORIDA
BUDGET TRANSFER

Page 1 of 1
BGEX-143-12172000000482

FUND 3815 -Impact Fee Assistance Program - Public Building

Use this form to provide budget for items not anticipated in the budget.

ACCOUNT NUMBER	ACCOUNT NAME	ORIGINAL BUDGET	CURRENT BUDGET	INCREASE	DECREASE	ADJUSTED BUDGET	EXPENDED/ ENCUMBERED 12/11/20	REMAINING BALANCE
EXPENDITURES								
143-1485-8201	Contributions - Non Governmental Agency	0	0	1,940	0	1,940	0	1,940
821-9705-9902	Operating Reserves	90,637	36,875	0	1,940	34,935	0	34,935
TOTAL EXPENDITURES				1,940	1,940			

Department of Housing and Economic Sustainability
INITIATING DEPARTMENT/DIVISION
Administration/Budget Department Approval
OFMB Department - Posted

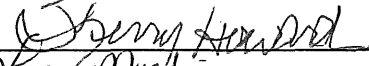
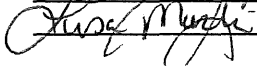
Signatures



Date
1-7-21
1/12/21

By Board of County Commissioners
At Meeting of :
February 9, 2021
Deputy Clerk to the
Board of County Commissioners