



**II. FISCAL IMPACT ANALYSIS**

**A. Five Year Summary of Fiscal Impact:**

Fiscal Years	2021	2022	2023	2024	2025
Capital Expenditures	\$225,000	-0-	-0-	-0-	-0-
Operating Costs	-0-	-0-	-0-	-0-	-0-
External Revenues	-0-	-0-	-0-	-0-	-0-
Program Income (County)	-0-	-0-	-0-	-0-	-0-
In-Kind Match (County)	-0-	-0-	-0-	-0-	-0-
<b>NET FISCAL IMPACT</b>	<b>\$225,000</b>	<b>-0-</b>	<b>-0-</b>	<b>-0-</b>	<b>-0-</b>
# ADDITIONAL FTE POSITIONS (Cumulative)					

Is Item Included in Current Budget? Yes X No  
 Does this item include the use of federal funds? Yes No X

Budget Account No:  
 Fund 3505 Dept 361 Unit 1975 Object 6505



Recommended Sources of Funds/Summary of Fiscal Impact:  
 Road Impact Fee Fund - Zone 5  
 Clint Moore Rd. & SR 7 Intersection Improvements

New Task Authorization	
Basic Services	\$120,839.88
Reimbursables	\$ 28,995.95
Optional Services	\$ 8,217.30
Total Task Authorization	\$158,053.13
Contingency	\$ 3,723.87
Staff Charges	
Roadway Production	\$ 31,611.00
Right of Way	\$ 7,903.00
Survey	\$ 7,903.00
Traffic	\$ 15,806.00
Fiscal Impact	\$225,000.00

C. Departmental Fiscal Review: 

**III. REVIEW COMMENTS**

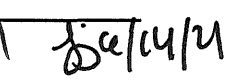
**A. OFMB Fiscal and/or Contract Dev. and Control Comments:**

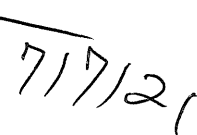
 OFMB   Contract Dev. and Control 

**B. Approved as to Form and Legal Sufficiency:**

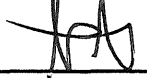
 for L. Herman. 7/12/21  
 Assistant County Attorney

**C. Other Department Review:**

\_\_\_\_\_  
 Department Director

This summary is not to be used as a basis for payment.

PROJECT LOCATION

CLINT MOORE ROAD AND SR 7 INTERSECTION IMPROVEMENTS

Palm Beach County Project #2021101

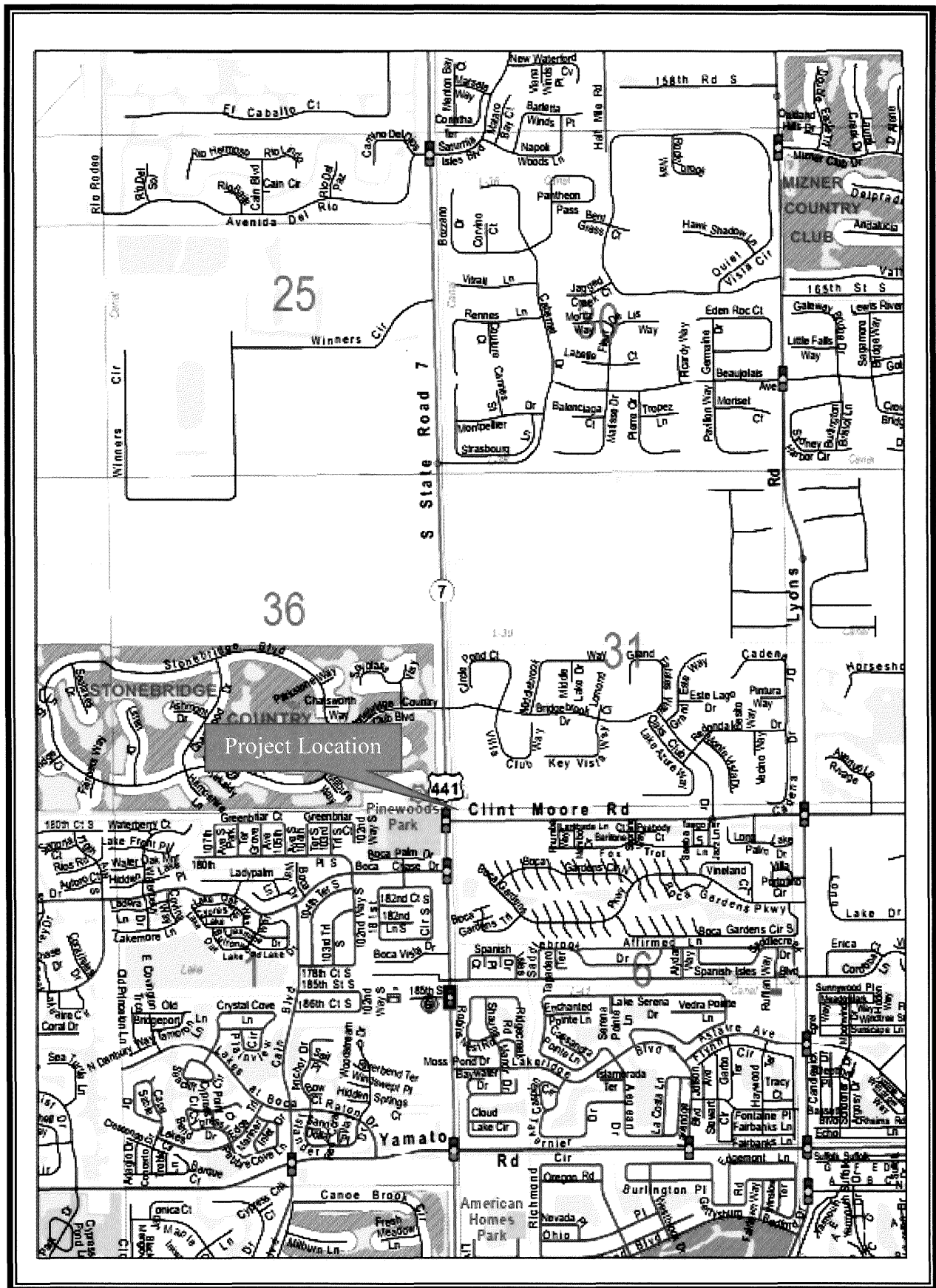

LOCATION MAP

**WORK TASK ORDER TO THE  
ANNUAL INTERSECTION PROFESSIONAL SERVICES CONTRACT  
BY AND BETWEEN PALM BEACH COUNTY  
AND PROPEL ENGINEERING, INC. FOR  
CLINT MOORE ROAD AND SR 7 INTERSECTION IMPROVEMENTS  
PROJECT # 2021100**

This Work Task Order to the Annual Intersection Professional Services Contract (R2020-0542), dated June 2, 2020 (ANNUAL CONTRACT), is made and entered into the \_\_\_\_\_ day of \_\_\_\_\_, 20\_\_\_\_, by and between Palm Beach County, a political subdivision of the State of Florida, by and through its Board of County Commissioners (COUNTY) and Propel Engineering, Inc., a for profit corporation (CONSULTANT) whose Federal ID is 46-3316950 (individually Party and collectively Parties).

**WITNESSETH**

WHEREAS, the COUNTY and CONSULTANT entered into the ANNUAL CONTRACT on June 2, 2020 (R2020-0542); and

WHEREAS, the COUNTY intends to construct the Clint Moore Road and SR 7 Intersection Improvements, Project No. **2021100** (PROJECT); and

WHEREAS, the COUNTY desires the CONSULTANT to perform professional services for the PROJECT; and

WHEREAS, the CONSULTANT agrees to prepare the design plans and construction bid documents, including related documents as required for the PROJECT; and

WHEREAS, the following fee has been negotiated and found to be reasonable compensation for these professional services to be performed by the CONSULTANT:

Basic Services in a lump sum fee of \$120,839.88  
Reimbursable Expenses capped at \$28,995.95  
Optional Services capped at \$8,217.30  
Totaling **\$158,053.13**

NOW, THEREFORE, THIS INDENTURE WITNESSETH: That for and in consideration of the mutual benefits to flow from each to the other, the Parties hereto agree as follows:

*Project # 2021100*

The above recitals are true and correct and are incorporated herein.

The following Exhibits are attached to and made a part of this Work Task Order.

**Exhibit A** - Scope of Work including Work Schedule

**Exhibit B** - Fee Schedule

**Exhibit C** – OEBO Schedules 1 and 2

**Exhibit D** – Work Task Order History

The COUNTY agrees to pay the CONSULTANT a fee of One Hundred Fifty Eight Thousand Fifty Three Dollars and Thirteen Cents (\$158,053.13) for this Work Task Order.

Except as hereby amended, changed or modified, all other provisions of the ANNUAL CONTRACT, shall remain in full force and effect.

REMAINDER OF PAGE LEFT BLANK INTENTIONALLY

IN WITNESS WHEREOF, the Board of County Commissioners of Palm Beach County, Florida, has made and executed this Work Task Order for the PROJECT, pursuant to the ANNUAL CONTRACT, on behalf of the COUNTY, and CONSULTANT has hereunto set its hand the day and year above written.

**OWNER:**

APPROVED AS TO TERMS  
AND CONDITIONS

By: *Kurt J. Jwell*  
for Morton L. Rose, P.E.  
Director of Roadway Production

**CONSULTANT:**

Propel Engineering, Inc.

*Maj*  
Mr. Majharul Alam, President

**ATTEST WITNESS:**

*Encka Taylor Moran*  
Signature

Encka Taylor Moran  
Name (type or print)

*Michelle Zhao*  
Signature

Michelle Zhao  
Name (type or print)



{SIGNATURE PAGES CONTINUED}

**ATTEST:**

Joseph Abruzzo  
Clerk of the Circuit Court & Comptroller

By: \_\_\_\_\_  
Deputy Clerk

**COUNTY:**

**Palm Beach County**, a Political Subdivision of the  
State of Florida, by and through its Board of County  
Commissioners

By: \_\_\_\_\_  
Dave Kerner, Mayor

APPROVED AS TO FORM  
AND LEGAL SUFFICIENCY

(Seal)

By:  \_\_\_\_\_  
Yelzaveta B. Herman  
Assistant County Attorney

DL Sandra Milens Dupin 4/26/2021



**PROPEL**  
ENGINEERING

*Change in name only  
K. J. [Signature] 4/26/21*

# Clint Moore Rd. & SR 7 Intersection Improvements

Palm Beach County Project No. 2021100

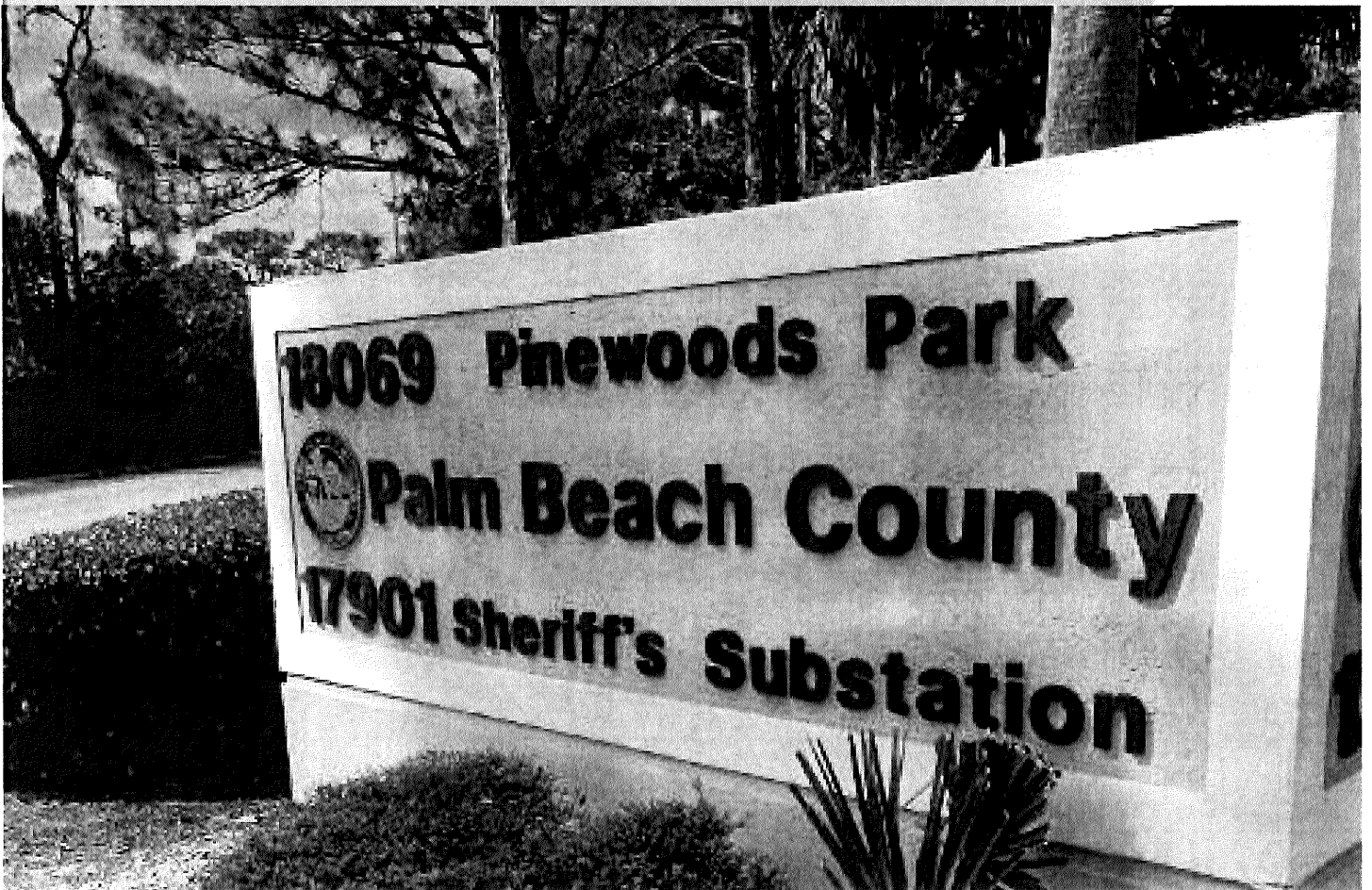

SCOPE AND FEES

02/05/2021

Revised: 03/09/2021, 04/05/2021, 04/07/2021, 04/20/21





### SCOPE OF SERVICES

Date: 02/05/2021 (Revised 03/09/2021, 04/05/2021, 04/07/2021, 04/20/2021)

#### **Clint Moore Rd. & SR 7 Intersection Improvements Palm Beach County Project #2021100**

#### **PROJECT LIMITS**

Propel Engineering, Inc., will provide engineering and surveying services required in connection with the proposed improvements to Clint Moore Road at SR 7 Intersection. The limits of the project will be as follow:

- Clint Moore Road from approximately six hundred fifty feet (650') east of SR 7 to three hundred feet (300') west of SR 7.

#### **PROJECT DESCRIPTION**

Services will include preparation of complete roadway construction plans. Services will also include drainage, curb and gutter, sidewalk, and signing and pavement marking.

The scope consists of the following improvements:

1. For the west leg of the intersection, keep the existing pavement along the Park Entrance and convert both lanes for the eastbound traffic only (one lane for a shared eastbound to northbound left and eastbound through lane and another lane for an eastbound to southbound right turn only lane). Construct a landscape median island to keep most of the existing trees and park sign structures and propose an 18 ft westbound through lane (due to consideration for truck use) with a 5 ft outside shoulder.
2. For the east leg of the intersection, develop two alternatives during the master plan stage and only one of the alternatives will be carried through the final design.
  - a. Option 1: Convert the existing unused striped lane to a shared westbound to southbound left and westbound through lane. With this conversion, there will be three westbound to southbound left turn lanes and one lane will be a shared through lane with the outmost left turn lane. This will require widening along SR 7 to receive three left turn lanes to satisfy FDOT's requirement. The existing westbound to northbound right turn lane will be maintained as-is.
  - b. Option 2: Convert the existing unused striped lane to a shared westbound to northbound right and westbound through lane. With this conversion, there will be two westbound to southbound left turn lane and two westbound to northbound right turn lane and one will be a shared through lane with the inner right turn lane.
3. Mill and resurface the existing Clint Moore Road lanes within the project limits.

Plans will be prepared in accordance with the following standards:

- Palm Beach County Thoroughfare Roadway Design Procedures (January 2019)
- Palm Beach County Thoroughfare Roads Typical Sections (April 2018)
- Palm Beach County Typical for Pavement Markings, Signing & Geometrics, (No. T-P-18)
- FDOT Design Manual (2020 FDM)
- AASHTO "Geometrics Design of Highway and Streets", dated 2011



- Florida Greenbook, 2016 Edition.
- FDOT Drainage Manual 2018.
- MUTCD, 2009 WITH REVISION 1&2, May 2012

## BASIC SERVICES

### 1 **Plans Preparation.**

Roadway plans with aerial background will be prepared in accordance with the approved Typical Section, and the approved Master Plan.

Construction plans will be prepared on 11" x 17" at 1" = 40' scale for the horizontal and 1" = 4' for the vertical. Separate plan and profile sheets will be prepared.

The following plan sheets are anticipated:

- 1- Cover Sheet
- 2- Drainage Map
- 3- General Notes
- 4- Typical Sections
- 5- Miscellaneous Details
- 6- Summary of Pay Item
- 7- Reference Points
- 8- Project Network Control Sheets
- 9- Roadway Plans
- 10- Roadway Profiles
- 11- Drainage Structures
- 12- Cross Sections

The following plan submittals will be included: Master Plan, 35%, 65%, 96%, 100% and Final. Plan submittal will include PDF, four hard copies and all electronic files.

### 2 **Permitting**

PROPEL will prepare and process needed documents for permitting from the following agencies:

- South Florida Water Management District – drainage permit
- Florida Department of Transportation (FDOT)

### 3 **Utilities Coordination**

Propel Engineering, Inc. will assist Palm Beach County in the utility coordination effort as follows:

- 1- Palm Beach County will distribute Approved Survey Plans to Utility Agency Owners for Utility Coordination.
- 2- Attend two utility coordination meetings, prepare meeting minutes and follow up on action items.
- 3- Plot utility information on plans for inclusion in the construction plan package.
- 4- Prepare utility conflict matrix.



- 4 **Drainage Design**  
 The design and preparation of drainage plans will be accomplished in substantial conformance with SFWMD requirements. A drainage report will be prepared to document the design. Permit packages will be prepared by The Consultant with provisions for responses to a Request for Additional Information (RAI) from reviewing agencies. The drainage design will be based on the following:
- 1- Water quantity and quality will generally be provided using exfiltration trenches.
  - 2- Provide drainage report documenting the design for County and permitting agency use.
  - 3- Prepare drainage structure sheets.
  - 4- Prepare Summary of Drainage Structures sheets.
  - 5- Include drainage maps without aerial background in the roadway plans.
  - 6- Prepare exfiltration trenches details
- 5 **Pavement Marking and Signing Plans**  
 Pavement Marking and Signing Plans will be prepared to conform to the proposed roadway improvements in accordance with Palm Beach County Standards. These plans will be prepared as a separate set of documents and include:
- 1- Cover sheet.
  - 2- General notes
  - 3- Summary of quantity sheets
  - 4- Plan sheets
  - 5- One signing and pavement marking detail
- 6 **Signal Design Services**  
 Pedestrian signals modifications to accommodate the widening at the east leg of the Clint Moore at SR 7 intersection.
- 7 **Lighting Design Services**  
 Relocate the impacted lighting poles due to widening. Provide pedestrian retrofit lighting at the intersection of Clint Moore at SR 7 per FDOT requirements.
- 8 **Meetings**  
 The following meetings are anticipated throughout the design duration:
- 1- Two progress meetings with County for Project Manager
  - 2- One pre-application meeting with SFWMD
  - 3- Two meetings for Utility Coordination

## Reimbursable Services

- 1 **Survey Services**  
 The survey services will be conducted by Brown & Phillips, Inc. See attached scope of services from Brown & Phillips, Inc.



2 **Geotechnical Services**

The geotechnical services will be conducted by Tierra South Florida, Inc. PROPEL will coordinate the needed services for both the roadway borings and the signal Standard Penetration Test (SPT). Hydraulic conductivity tests will be also part of the services. See attached scope of services from Tierra South Florida, Inc.

**Optional Services**

1 **Post Design Services.**

PROPEL will provide post design services as needed during the construction phase.

**PBC Project 2021100 - Clint Moore Rd. & SR 7 Intersection Improvements**

ID	Task Name	Duration	Start	Finish	2021			2022				2023				
					Apr	Jul	Oct	Jan	Apr	Jul	Oct	Jan	Apr	Jul	Oct	Jan
1	<b>PBC 2021100 Clint Moore Rd at SR 7 Intersection Improvements</b>	<b>657 days</b>	<b>Tue 6/8/21</b>	<b>Wed 12/13/23</b>												
2	Notice to Proceed (NTP)	1 day	Tue 6/8/21	Tue 6/8/21												
3	Perform Field Survey	65 days	Wed 6/9/21	Tue 9/7/21												
4	Submit Design Survey for PBC Comments	21 days	Wed 9/8/21	Wed 10/6/21												
5	Implement PBC Design Survey Comments	10 days	Thu 10/7/21	Wed 10/20/21												
6	PBC Review and Approve Survey	21 days	Thu 10/21/21	Thu 11/18/21												
7	<b>Phase I</b>	<b>142 days</b>	<b>Fri 11/19/21</b>	<b>Mon 6/6/22</b>												
8	Phase IA - Initial Utility Contact Plans	10 days	Fri 11/19/21	Thu 12/2/21												
9	Phase IB - Typical Section	10 days	Fri 11/19/21	Thu 12/2/21												
10	PBC Review and Approve Phase IB - Typical Section	21 days	Fri 12/3/21	Fri 12/31/21												
11	Phase IC - Master Plan	50 days	Fri 11/19/21	Thu 1/27/22												
12	PBC Review and Approve Phase IC - Master Plan	21 days	Fri 1/28/22	Fri 2/25/22												
13	Phase ID - 35% Plans	50 days	Mon 2/28/22	Fri 5/6/22												
14	PBC Review and Approve Phase ID - 35% Plans	21 days	Mon 5/9/22	Mon 6/6/22												
15	<b>Phase II</b>	<b>204 days</b>	<b>Tue 6/7/22</b>	<b>Fri 3/17/23</b>												
16	Phase IIA - Utility Pothole Coordination Plans	10 days	Tue 6/7/22	Mon 6/20/22												
17	Phase IIB - First Utility Coordination Plans	10 days	Tue 6/7/22	Mon 6/20/22												
18	Phase IIC - Pothole Underground Utilities at Possible Conflict Points	10 days	Tue 6/21/22	Mon 7/4/22												
19	Phase IID - 65% Plans	40 days	Tue 7/5/22	Mon 8/29/22												
20	PBC Review and Approve Phase IID - 65% Plans	21 days	Tue 8/30/22	Tue 9/27/22												
21	Phase IIE - Stake Existing and Proposed Right-of-Way	10 days	Wed 9/28/22	Tue 10/11/22												



Task		External Milestone		Manual Summary Rollup		Path Predecessor Summary Task	
Split		Inactive Task		Manual Summary		Path Predecessor Normal Task	
Milestone		Inactive Milestone		Start-only		Critical	
Summary		Inactive Summary		Finish-only		Critical Split	
Project Summary		Manual Task		Deadline		Progress	
External Tasks		Duration-only		Path Predecessor Milestone Task			

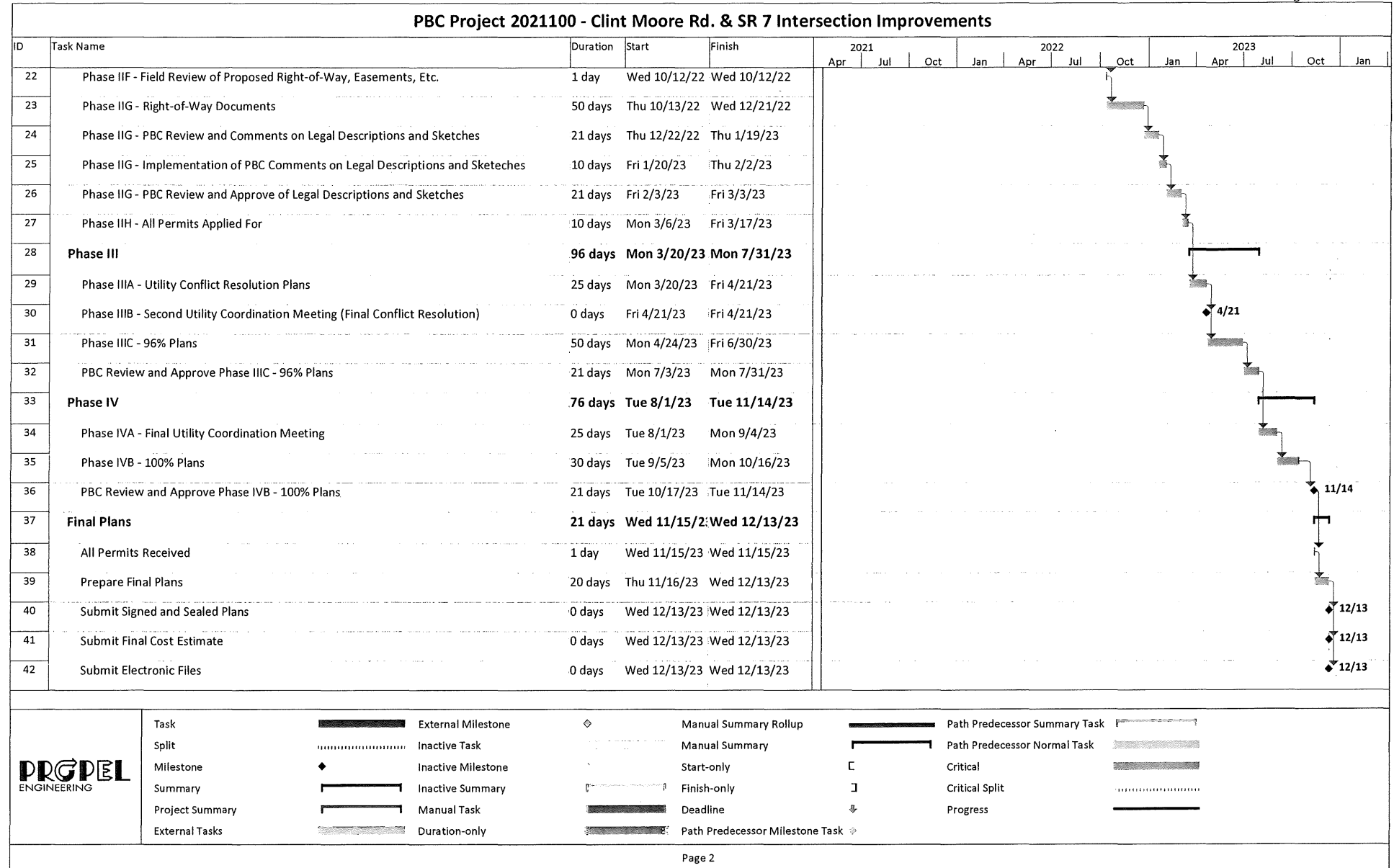

**ESTIMATE OF WORK EFFORT AND COST - PRIME CONSULTANT**

Name of Project:  
County:  
PBC Project Number

Clint Moore Rd. & SR 7 Intersection Improvements  
Palm Beach  
PBC#2021100

Consultant Name: Propel Engineering, Inc.  
Consultant No.: 1930010904  
Estimator: MA

Staff Classification	Total Staff Hours From "SH" Summary -	Project Manager	Senior Engineer	Project Engineer	Engineering Intern	CADD/Computer Technician	SH By Activity	Salary Cost By Activity	Average Rate Per Task
		\$67.00 ✓	\$62.00 ✓	\$47.00 ✓	\$33.00 ✓	\$30.00 ✓			
4. Roadway Analysis	188	38	47	66	19	18	188	\$9,729	\$51.75
5. Roadway Plans	145	15	36	64	15	15	145	\$7,190	\$49.59
6a. Drainage Analysis	48	10	12	16	5	5	48	\$2,481	\$51.69
6b. Drainage Plans	36	4	9	16	4	3	36	\$1,800	\$50.00
7. Utilities	45	4	11	21	4	5	45	\$2,219	\$49.31
8. Environmental Permits	92	9	23	42	9	9	92	\$4,570	\$49.67
19. Signing & Pavement Marking Analysis	30	3	8	14	3	2	30	\$1,514	\$50.47
20. Signing & Pavement Marking Plans	29	3	7	13	3	3	29	\$1,435	\$49.48
21. Signalization Analysis	72	7	18	33	7	7	72	\$3,577	\$49.68
22. Signalization Plans	26	2	7	11	3	3	26	\$1,274	\$49.00
23. Lighting Analysis	68	7	17	30	7	7	68	\$3,374	\$49.62
24. Lighting Plans	39	4	10	17	4	4	39	\$1,939	\$49.72
<b>Total Staff Hours</b>	818	106	205	343	83	81	818		
<b>Total Staff Cost</b>		\$7,102.00	\$12,710.00	\$16,121.00	\$2,739.00	\$2,430.00		\$41,102.00 ✓	\$50.25

✓ ✓ ✓ ✓ ✓  
 Raw Labor Cost = \$41,102.00 ✓  
 Approved Multiplier = \$2.94 ✓  
 Total Staff Cost with Multiplier = \$120,839.88 ✓

<u>Basic Services</u>		
Prime (for Management, Roadway, Drainage, Utility, Permitting, Signing & Pavement Marking, Signal, & Lighting):	Propel Engineering, Inc.	\$120,839.88
<b>TOTAL BASIC SERVICES ESTIMATED FEES:</b>		<b>\$120,839.88</b> ✓

<u>Reimbursables</u>		
Prime (for Permit Fees):	Propel Engineering, Inc.	\$2,000.00 ✓
Subconsultant (for Surveying):	Brown & Phillips, Inc.	\$12,390.95 ✓
Subconsultant (for Geotechnical - Roadway and Drainage):	Tierra South Florida, Inc.	\$8,300.00 ✓
Subconsultant (for Geotechnical- Signalization):	Tierra South Florida, Inc.	\$6,305.00 ✓
<b>TOTAL REIMBURSABLES ESTIMATED FEES:</b>		<b>\$28,995.95</b> ✓

<u>Optional Services</u>		
Prime (for Post Design):	Propel Engineering, Inc.	\$8,217.30 ✓
<b>TOTAL OPTIONAL SERVICES ESTIMATED FEES:</b>		<b>\$8,217.30</b> ✓

**\$158,053.13** ✓

**Project Activity 4: Roadway Analysis** ✓

Estimator: MA

Clint Moore Rd. & SR 7 Intersection Improvements

PBC#2021100

Task No.	Task	Units	No of Units	Hours/ Unit	Total Hours	Comments
4.1	Typical Section Package	EA	4	4	16 ✓	4-Typicals: one for the Park Entrance, two for the Clint Moore Rd (one for each alternatives), and one for SR 7 south leg 4*6 hrs = 24 hrs
4.5	Horizontal /Vertical Master Design Files	LS	1	79	79	0.23 mile of roadway design = 300 hrs x 0.23 + 10 hours for the Intersections= 79 hrs
4.9	Cross Section Design Files	LS	1	13	13	40 scale 100 ft interval for 0.23 miles X 5280 = 13 x-sections X 1 hours = 13 hrs
4.15	Design Report	LS	1	16	16	1 design report.
4.16	Quantities	LS	1	20	20	Develop quantites
4.17	Cost Estimate	LS	1	24	24	1initial @8hrs + 4 updates (65%, 96%, 100%, & Final@ 4hrs each =24 hrs
<b>Roadway Analysis Technical Subtotal</b>					<b>168 ✓</b>	
4.20	Field Reviews	LS	1	12	12	2 field reviews x 2 attendees x ( 3 hr rev)
4.22	Technical Meetings	LS	1	8	8	Meetings are listed below
<b>Roadway Analysis Nontechnical Subtotal</b>					<b>20</b>	
<b>4. Roadway Analysis Total</b>					<b>188 ✓</b>	

Technical Meetings	Units	No of Units	Hours/ Unit	Total Hours	
<b>Subtotal Technical Meetings</b>					
Phase Review Meetings	EA	2	4	8	
<b>Total Meetings</b>				<b>8 ✓</b>	



**Project Activity 5: Roadway Plans** ✓

Estimator: MA

Clint Moore Rd. & SR 7 Intersection Improvements

PBC#2021100

Task No.	Task	Scale	Units	No. of Units or Sheet	Hours/ Unit or Sheet	Total Hours	Comments
5.1	Key Sheet		Sheet	1	4	4	One Roadway Keysheet
5.2	Summary of Pay Items Including Quantity Input		Sheet	1	8	8	One sheet
5.3.1	Typical Sections		EA	2	1	2	
5.3.2	Typical Section Details		EA	2	4	8	Overbuild and u-turn details
5.4	General Notes/Pay Item Notes		Sheet	1	8	8	One project specific general notes
5.5	Summary of Quantities Sheets (Combook)		Sheet	5	4	20	total 5 sheets estimated for Earthwork, SOD, miscellaneous pavement, mowing & litter removal, curb and gutter, sidewalk, and detectable warnings, turnouts -- summary boxes for all components
5.8	Profile Sheet	40 scale	Sheet	3	8	24	40 Scale required 3 sheets
5.9	Plan Sheet	40 scale	Sheet	3	8	24	40 Scale required 3 sheets
5.15	Special Details		EA	1	4	4	Estimated one special detail
5.18	Cross Sections		EA	13	2	26	at 100 ft spacing
5.22	Utility Adjustment Sheets		Sheet	3	4	12	Match roadway sheets
5.23	Project Network Control Sheet(s)		Sheet	1	1	1	Provided by survey
5.25	Utility Verification Sheet(s) (SUE Data)		Sheet	1	4	4	one sheet
<b>Roadway Plans Technical Subtotal</b>						<b>145</b> ✓	
<b>5. Roadway Plans Total</b>						<b>145</b> ✓	

**Project Activity 6a: Drainage Analysis ✓**

Estimator: MA

Clint Moore Rd. & SR 7 Intersection Improvements

PBC#2021100

Task No.	Task	Units	No of Units	Hours/ Unit	Total Hours	Comments
6a.7	Design of Stormwater Management Facility (Roadside Treatment Swales and Linear Ponds)	Per Cell	2	6	12	estimate 2 cells
6a.11	French Drain Systems	Per Cell	2	8	16	estimated 2 cell required French Drain
6a.13	Drainage Design Documentation Report	LS	1	20	20	
<b>Drainage Analysis Technical Subtotal</b>					<b>48 ✓</b>	
<b>6a. Drainage Analysis Total</b>					<b>48 ✓</b>	

**6b. Drainage Plans** ✓

Estimator: MA

Clint Moore Rd. & SR 7 Intersection Improvements

PBC#2021100

<b>Task No.</b>	<b>Task</b>	<b>Scale</b>	<b>Units</b>	<b>No. of Units or Sheet</b>	<b>Hours/ Unit or Sheet</b>	<b>Total Hours</b>	<b>Comments</b>
6b.1	Drainage Map		Sheet	1	16	16	
6b.5	Drainage Structure Sheet(s) (Per Structure)		EA	4	3	12	
6b.6	Miscellaneous Drainage Detail Sheets		Sheet	1	8	8	
<b>Drainage Plans Technical Subtotal</b>						<b>36 ✓</b>	
<b>6. Drainage Plans Total</b>						<b>36 ✓</b>	

**Project Activity 7: Utilities ✓**

Estimator: MA

Clint Moore Rd. & SR 7 Intersection Improvements  
PBC#2021100

Task No.	Task	Units	No of Units	Hours/ Unit	Total Hours	Comments
7.2	Identify Existing Utility Agency Owners (UAO(s))	LS	1	8	8	Identified all existing UAOs
7.3	Make Utility Contacts	LS	1	0	0	PBC will do this task
7.6	Individual/Field Meetings	LS	1	4	4	(1) Pre-Mtg Prep + (0) Travel Time + (1) Meeting Duration + (2) Prep. of Minutes = 4 Hours X (2) Meetings = <b>8 Hours</b>
7.7	Collect and Review Plans and Data from UAO(s)	LS	1	4	4	
7.9	Utility Design Meeting and potholes	LS	1	8	8	(1) Pre-Mtg Prep + (0) Travel Time + (2) Meeting Duration + (1) Preparation of Minutes + 2 hrs for follow up = <b>6 Hours</b> + 2hrs
7.10	Review Utility Markups & Work Schedules, and draw them in the plans	LS	1	21	21	(3) hours X (7) utility documents = <b>21 Hours</b> Assist PBC Utility Coordinator
7.11	Utility Coordination/Followup	LS	0	0	0	PBC will do this task
7.15	Contract Plans to UAO(s)	LS	0	0	0	PBC will do this task
7.16	Certification/Close-Out	LS	0	0	0	PBC will do this task
<b>7. Utilities Total</b>					<b>45 ✓</b>	

**Project Activity 8: Environmental Permits** ✓

Estimator: MA

Clint Moore Rd. & SR 7 Intersection Improvements

PBC#2021100

Task No.	Task	Units	No. of Units	Hours/ Units	Total Hours	Comments
<b>Environmental Permits, Compliances and Clearances</b>						
8.1	Preliminary Project Research	LS	1	4	4	Review existing permits
<b>Permits</b>						
8.2	<b>Field Work</b>					
8.2.1	SFWMD Permit	LS	1	40	40	
8.2.2	Pre-Application Meeting with SFWMD and LWDD	EA	2	4	8	
8.3	FDOT Permit	LS	1	32	32	
8.4	FDOT 4f Coordination	LS	1	8	8	
<b>Environmental Permits, Compliance, and Clearances/Reevaluations Technical Subtotal</b>					<b>92</b> ✓	

**Project Activity 19: Signing and Pavement Marking Analysis** ✓

Estimator: MA

Clint Moore Rd. & SR 7 Intersection Improvements

PBC#2021100

<b>Task No.</b>	<b>Task</b>	<b>Units</b>	<b>No. of Units</b>	<b>Hours/ Units</b>	<b>Total Hours</b>	<b>Comments</b>
19.3	Reference and Master Design File	LS	1	24	24	
19.7	Quantities	LS	1	6	6	2 hours per sheet * 3 sheets = 6 hours
<b>Signing and Pavement Marking Analysis Technical Subtotal</b>					<b>30</b> ✓	
<b>19. Signing and Pavement Marking Analysis Total</b>					<b>30</b> ✓	

**Project Activity 20: Signing and Pavement Marking Plans** ✓

Estimator: MA

Clint Moore Rd. & SR 7 Intersection Improvements

PBC#2021100

Task No.	Task	Scale	Units	No of Units	Hours/ Unit	No. of Sheets	Total Hours	Comments
20.1	Key Sheet		Sheet	1	4	1	4	One keysheet
20.3	Tabulation of Quantities		Sheet	1	8	1	8	8 Hrs for 1st Tabulation sheet = 8 Hrs
20.4	General Notes/Pay Item Notes		Sheet	1	4	1	4	One general notes
20.6	Plan Sheet		Sheet	3	3	3	9	3 plan sheets using 40 scale
20.7	Typical Details		EA	1	4		4	one estimated
<b>Signing and Pavement Marking Plans Technical Subtotal</b>						<b>6</b>	<b>29 ✓</b>	
<b>20. Signing and Pavement Marking Plans Total</b>						<b>6</b>	<b>29 ✓</b>	

**Project Activity 21: Signalization Analysis ✓**

Estimator: JV

Clint Moore Rd. & SR 7 Intersection Improvements

PBC#2021100

Task No.	Task	Units	No. of Units	Hours/ Units	Total Hours	Comments
21.2	Traffic Data Analysis	PI	1	6	6	One intersection
21.5	Reference and Master Signalization Design File	PI	1	24	24	One intersection - Ped Signal and signal head relocation only
21.6	Reference and Master Interconnect Communication Design File	LS	1	6	6	signal interconnect design and integrate the intersection into the signal coordination plan . PBC provide the mark up. <b>Propel to draw them</b>
21.10	Quantities	LS	1	8	8	1 intersection
21.12	Technical Special Provisions	LS	1	12	12	If needed will be added as an SA
<b>Signalization Analysis Technical Subtotal</b>					<b>56 ✓</b>	
21.14	Field Reviews	LS	1	12	12	three field reviews: 1 Initial Field Review, 1 at 65% and 1 at 100%, 2 people per review, 3X2X2=12 hrs
21.15	Technical Meetings	LS	1	4	4	Meetings are listed below
<b>Signalization Analysis Nontechnical Subtotal</b>					<b>16 ✓</b>	
<b>21. Signalization Analysis Total</b>					<b>72 ✓</b>	

Technical Meetings	Units	No of Units	Hours/ Unit	Total Hours	
Palm Beach Traffic Design	EA	1	4	4	
Power Company (service point coordination)	EA	0	0	0	
<b>Subtotal Technical Meetings</b>				<b>4 ✓</b>	
<b>Total Meetings</b>				<b>4 ✓</b>	



**Project Activity 22: Signalization Plans ✓**

Estimator: JV

Clint Moore Rd. & SR 7 Intersection Improvements

PBC#2021100

Task No.	Task	Scale	Units	No of Units	Hours/ Unit	No. of Sheets	Total Hours	Comments
22.1	Key Sheet		Sheet	1	4	1	4	
22.3	Tabulation of Quantities		Sheet	1	8	1	8	
22.4	General Notes/Pay Item Notes		Sheet	1	4	1	4	
22.5	Plan Sheet		Sheet	1	6	1	6	One intersection at School
22.6	Interconnect Plans		Sheet	1	4	1	4	
<b>Signalization Plans Technical Subtotal</b>						<b>5</b>	<b>26 ✓</b>	
<b>22. Signalization Plans Total</b>						<b>5</b>	<b>26 ✓</b>	

**Project Activity 23: Lighting Analysis ✓**

Estimator: JV

Clint Moore Rd. & SR 7 Intersection Improvements

PBC#2021100

Task No.	Task	Units	No. of Units	Hours/ Units	Total Hours	Comments
23.2	Lighting Design Analysis Report	LS	1	8	8	retrofit one intersection. Report to include photometrics, luminaire type and recommendations, light pole layout.
23.3	Aeronautical Evaluation	LS	1	12	12	Coordination with Boca Airport & FAA for new light poles
23.4	Voltage Drop Calculations	EA	4	3	12	Voltage drop calculations to determine if the new lighting system can tie into the existing circuitry four circuits
23.6	Reference and Master Design Files	LS	1	16	16	retrofit one intersection, large and complex intersections, 16 hrs/ intersection X 1 = 16 hours
23.9	Quantities	LS	1	3	3	1 plan sheet
23.10	Cost Estimate	LS	1	1	1	N/A
<b>Lighting Analysis Technical Subtotal</b>					<b>52 ✓</b>	
23.13	Field Reviews	LS	1	8	8	2 field reviews, 2 people @ 2 hrs
23.14	Technical Meetings	LS	1	8	8	
<b>Lighting Analysis Nontechnical Subtotal</b>					<b>16 ✓</b>	
<b>23. Lighting Analysis Total</b>					<b>68 ✓</b>	

Technical Meetings	Units	No of Units	Hours/ Unit	Total Hours	
FDOT Lighting Design	EA	1	4	4	
FDOT Traffic Design	EA	0	0	0	
Power Company (service point coordination)	EA	1	4	4	
<b>Subtotal Technical Meetings</b>				<b>8 ✓</b>	
<b>Total Meetings</b>				<b>8 ✓</b>	

**24. Lighting Plans ✓**

Estimator: JV

Clint Moore Rd. & SR 7 Intersection Improvements

PBC#2021100

Task No.	Task	Scale	Units	No. of Units	Hours/ Unit	No. of Sheets	Total Hours	Comments
24.1	Key Sheet		Sheet	1	4	1	4	
24.3	Tabulation of Quantities		Sheet	1	10	1	10	one tabulation sheet
24.4	General Notes/Pay Item Notes		Sheet	1	3	1	3	
24.5	Pole Data, Legend and Criteria		Sheet	1	10	1	10	10 hrs first sheet
24.6	Service Point Details		Sheet	1	8	1	8	
24.8	Plan Sheet		Sheet	1	4	1	4	
<b>Lighting Plans Technical Subtotal</b>						<b>6</b>	<b>39 ✓</b>	
<b>24. Lighting Plans Total</b>						<b>6</b>	<b>39 ✓</b>	

**Reimbursable Fees**  
**Propel Engineering, Inc.**

**PERMIT APPLICATION FEE SCHEDULE**

(Effective 8/7/2016)

**Environmental Resource Permits**

**New Individual or Conceptual Permit (excludes Agriculture, Mitigation Bank)**

- Project area < 10 acres; no wetlands or surface waters; no boat slips..... \$ 2,000 ✓
- Project area < 10 acres; < 1 acre wetland or surface water; < 10 boat slips..... \$ 3,500
- Project area < 40 acres; < 3 acres wetlands or surface waters; < 30 boat slips..... \$ 5,500
- Project area < 100 acres; < 10 acres wetlands or surface waters; < 50 boat slips..... \$ 7,500
- Project area < 640 acres; < 50 acres wetlands or surface waters; < 50 boat slips..... \$ 13,125
- Project area > 640 acres; > 50 acres wetlands or surface waters; > 50 boat slips..... \$ 25,000

**New Individual Agriculture or Silviculture Permit**

- Project area < 10 acres; < 1 acre wetland or surface water..... \$ 859
- Project area < 40 acres; < 3 acres wetlands or surface waters..... \$ 2,444
- Project area < 100 acres; < 10 acres wetlands or surface waters..... \$ 4,029
- Project area < 640 acres; < 50 acres wetlands or surface waters..... \$ 5,284
- Project area > 640 acres; > 50 acres wetlands or surface waters..... \$ 6,605

**Individual or Conceptual Permit Major Modification (excludes Agriculture, Mitigation Banks)**

- Project area < 10 acres; no wetlands or surface waters; no boat slips..... \$ 1,200
- Project area < 10 acres; < 1 acre wetland or surface waters; < 10 boat slips..... \$ 2,100
- Project area < 40 acres; < 3 acres wetlands or surface waters; < 30 boat slips..... \$ 3,300
- Project area < 100 acres; < 10 acres wetlands or surface waters; < 50 boat slips..... \$ 4,500
- Project area < 640 acres; < 50 acres wetlands or surface waters; < 50 boat slips..... \$ 7,875
- Project area > 640 acres; > 50 acres wetlands or surface waters; > 50 boat slips..... \$ 15,000

**Individual Agriculture or Silviculture Permit Major Modification**

- Project area < 10 acres; < 1 acre wetland or surface water..... \$ 515
- Project area < 40 acres; < 3 acres wetlands or surface waters..... \$ 1,466
- Project area < 100 acres; < 10 acres wetlands or surface waters..... \$ 2,417
- Project area < 640 acres; < 50 acres wetlands or surface waters..... \$ 3,170
- Project area > 640 acres; > 50 acres wetlands or surface waters..... \$ 3,963

**Individual or Conceptual Permit Minor Modification (includes Mitigation Banks)**

- Time Extension of Permit (not associated with SB/HB)..... \$ 500
- Time Extension of Permit (associated with SB/HB)..... \$ 0
- Minor errors not requiring technical review..... \$ 0
- Transfer of ownership..... \$ 0
- Transfer from construction to operation phase..... \$ 0
- All other minor modifications (Letter Modification)..... \$ 250

**New Individual or Conceptual Permit for a Mitigation Bank**

- Permit area < 100 acres..... \$ 7,500

## Optional Services Fees and Scope Propel Engineering



## **SCOPE OF SERVICES**

### **For Post Design**

#### **Clint Moore Rd. & SR 7 Intersection Improvements Palm Beach County Project #2021100**

Propel Engineering, Inc. proposes to provide additional professional services required in connection with the Post Design Services for the above project. It shall be Propel's responsibility to utilize appropriate engineering judgment, practices, and principles during the prosecution of the work. These services are intended to provide construction support including engineering assistance, shop drawing reviews, responses to Requests for Information (RFI), site visits, and meetings, which will be required to satisfactorily complete construction. Propel will also provide as-built plans for signalization plans.

**OPTIONAL SERVICES ESTIMATE OF FEES FOR POST DESIGN**

Name of Project:  
County:  
PBC Project Number:

Clint Moore Rd. & SR 7 Intersection Improvements  
Palm Beach  
PBC#2021100

Consultant Name: Propel Engineering, Inc.  
Consultant No.: 1930010904

Staff Classification	Total Staff Hours	Project Manager	Senior Engineer	Project Engineer	Engineering Intern	CADD/Computer Technician	SH	Salary	Average
		\$67.00 ✓	\$62.00 ✓	\$47.00 ✓	\$33.00 ✓	\$30.00 ✓	By Activity	Cost By Activity	Rate Per Task
Post Design Services for roadway, drainage, signal, and lighting	40	8	10	14	4	4	40	\$2,066	\$51.65
Signalization As-built Plans	16	2	2	6	3	3	16	\$729	\$45.56
<b>Total Staff Hours</b>	56	10	12	20	7	7	56		
<b>Total Staff Cost</b>		\$670.00 ✓	\$744.00 ✓	\$940.00 ✓	\$231.00 ✓	\$210.00 ✓		\$2,795.00 ✓	\$49.91 ✓

Raw Labor Cost = \$2,795.00 ✓  
 Approved Multiplier = \$2.94 ✓  
 Total Staff Cost with Multiplier = \$8,217.30 ✓



**Survey Scope and Fees**  
**Brown & Phillips, Inc.**



February 1, 2021

Mr. Maj Alam, P.E.  
Propel Engineering, Inc.  
2711 Vista Parkway, Suite B-7  
West Palm Beach, FL 33411

**Re: Clint Moore Rd. & SR 7 Intersection Improvements – Roadway Design Survey  
Palm Beach County Project No. 2021100**

Dear Maj:

Thank you for the opportunity to provide you with the following services for the subject site. This proposal is based on documentation and information provided by your office. The scope of services is as follows:

### **SCOPE OF SERVICES**

We will perform a specific purpose/topographic survey under this project and the survey work will be performed in accordance with the current Standards of Practice and Palm Beach County Roadway Design Procedures dated January 2019, and all Palm Beach County requirements. All survey work done will result in a signed and sealed survey drawing in accordance with all applicable requirements, codes, rules, and Statutes governing Surveying and Mapping.

#### **I. HORIZONTAL PROJECT NETWORK CONTROL**

Using the information supplied by Palm Beach County, we will establish the Right-of-Way for Clint Moore Rod and SR 7. A traverse will be run through the route and found monumentation will be tied in. The survey will be oriented to Palm Beach County horizontal control (NAD 83/11 Adjustment). We will obtain the sectional and geodetic control information from the Palm Beach County Survey Department.

The survey will begin west of the SR 7 intersection, where the Park Entrance meets the road running north to south and extend 100' to the north. The survey will end about 650' east of the SR 7 intersection. The survey will extend 25' past the right-of-way line on the south side and up to the canal bank on the north side. Along SR 7, the survey limits will be 200' north and 300' south.

#### **II. RIGHT-OF-WAY**

We will review and compile any title information furnished to us for the rights-of-way (R/W), abutting properties, easements, and restrictions. No search of the Public Records will be performed by Brown & Phillips. We will review the title package and plot all right-of-way documents and easements on the Survey and alert the County of any missing R/W segments that make up the entire R/W corridor. All gaps or overlaps will be brought to the County's attention.

#### **III. VERTICAL PROJECT NETWORK CONTROL**

A level run will be performed along the route using the existing Palm Beach County benchmarks (NAVD 1988). Benchmarks will be set along the route, not exceeding 600 feet apart. All benchmarks will be set outside of the proposed limits of construction.

1860 Old Okeechobee Road • Suite 509 • West Palm Beach, Florida 33409  
(561) 615-3988 • Fax (561) 615-3991

M:\PROPOSALS BY COMPANY\Propel\Clint Moore Road at SR 7 Intersection\Clint Moore Road and SR 7 Roadway Design Survey Proposal.doc

Alam  
February 1, 2021

#### **IV. BASELINE LAYOUT**

We will lay out the baseline at 100-foot intervals setting appropriate points at each station. The baseline will be laid out within the limits of the 1300'± route. These baseline points will be used in the topographic and cross section phase to locate features and facilitate checks.

#### **V. HORIZONTAL CONTROL POINTS**

The historic baseline of survey (if available) will be tied to a pair of PBCo. Horizontal Control Points at each end of the baseline. Stations and offsets and State Plane Coordinates and monumentation will be labeled at begin and end of historic baseline as well as PI's, PC's, PT's, PRC's and PCC's along the baseline not to exceed 1000 feet between control stations. All monumentation along the historic baseline will be referenced to the intervisible random project control monumentation. We propose to set three (3) horizontal control points.

#### **VI. SECTION TIES AND PROPERTY TIES**

We will tie in section corners and property corners along the route to check the present alignment of Clint Moore Road and SR 7. We will try to locate as many corners as possible to positively establish the current rights of way. We will tie in a minimum of two (2) Palm Beach County geodetic points to meet County requirements. Subdivision corners, section corners and other existing control monumentation that will assist in the establishment of the R/W will be located and shown on the Survey.

#### **VII. TOPOGRAPHY**

A topographic survey will be performed along this well-traveled route (heavy traffic). This survey will tie in all visible features such as, but not limited to, signs, light poles, guardrails, utilities, walks, edge of pavement, curbing, drainage structures, striping, etc. These locations will show all features within the corridor from right of way to right of way extending to 25 feet outside the proposed right of way (if provided prior to start of the field work).

#### **VIII. CROSS SECTIONS and TIN CREATION (DTM)**

Cross sections will be done along the route at 100-foot intervals. These cross sections will cover the roadway to the right of way lines and extend to 25 feet outside of the right of way (if provided prior to start of the field work). In addition, we will prepare a TIN file and all the corresponding break lines for the design of the roadway. Since a TIN is required this will entail additional shots to be taken on the cross sections to accurately depict the existing conditions. No soundings are proposed.

#### **IX. AS-BUILTS**

We will attempt to get as-built information on all the pipes leading out of any storm structures found. We will show invert elevations, pipe sizes and materials for all pipes located including outfall pipes.

#### **X. TREE LOCATIONS**

We will locate all the trees (4" and larger measured at breast height) and shrubs/hedges within the right of way and extending to 25 feet outside the rights of way of Clint Moore Road and SR 7. These will be shown on the CADD file with types and caliper sizes. Not a tree survey.

Alam  
February 1, 2021

**XI. CLOSURE**

A certified signed and sealed Topographic Survey (11" x 17" sheets on a 1" = 40' scale) will be prepared and delivered, to be included with the engineering plans (sheets SURX-SURXX) showing the existing right-of-way and supporting record information in addition to all improvements as outlined. We will also provide a printout of the right-of-way information in hard copy and digital format (CAD and PDF), as part of the approved survey plan submittal, showing labels referencing each document used to plot the right-of-way. We propose to provide Propel Engineering, Inc., and Palm Beach County Survey Section with 1 set certified, signed & sealed, of the Survey, 1 set in PDF digitally signed and CAD files in the version requested. Any additional work will be done on an hourly basis as approved by you. We will perform the scope of services for a **lump sum fee of \$12,390.95** (see Table 'A' for an hourly breakdown). Please do not hesitate to call me with any questions you might have regarding this proposal. We look forward to working with you on this project.

Sincerely,

**Brown & Phillips, Inc.**

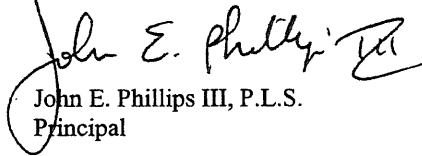

John E. Phillips III, P.L.S.  
Principal

JEP/mb



TABLE 'A'

Clint Moore Rd. & SR 7 Intersection Improvements  
 Palm Beach County Project No. 2021100

Type of Survey: Specific Purpose  
 Size: 1300'±  
 Date: February 1, 2021

TASK	3 MAN CREW	CADD TECH	SURVEY TECH	PLS	COMMENTS
Meetings and Coordination				2	
Horizontal Project Network Control	2				Establish control
Title Review			12	2	Review/compile furnished right-of-way
Vertical Project Network Control	6		1		Set benchmarks along corridor
Baseline Layout	2		0.5		Layout baseline at 100' intervals
Reference Points	3		1		Set references and prepare PNC Sheet
Section Ties	2		0.5		Tie in PBCo. Horizontal control
Subdivision & Property Ties	5		4	1	Tie in adjoining property corners
Topography and Cross Sections	18		3		Locate all above ground features 100' cross sections, TIN file
As-builts	1				As-built storm structures
Tree Locations	0.5				Locate native trees in R/W to 25' outside R/W (4" or greater)
Specific Purpose Survey		20	3	2	Prepare drawing of Specific Purpose Survey
Address Comments		4	6	1	
Total Hours:	39.5 ✓	24 ✓	31 ✓	8 ✓	
Rate/Hour	\$54.17 ✓	\$30.12 ✓	\$30.12 ✓	\$41.75 ✓	unloaded rates
Subtotal:	\$2,139.72 ✓	\$722.88 ✓	\$933.72 ✓	\$334.00 ✓	
Total Labor Cost (unloaded):					\$4,130.32 ✓
Multiplier:					3.00 ✓
Total Labor Cost (loaded):					\$12,390.95 ✓

TOTAL PRICE

\$12,390.95 ✓



**Geotechnical Scope and Fees**  
**Tierra South Florida, Inc.**



Revised April 16, 2021  
January 27, 2021

**Propel Engineering, Inc.**  
2711 Vista Parkway, Suite B-7  
West Palm beach, Florida 33411

Attn: Mr. Maj Alam, P.E., PMP

**Re: Proposal for Geotechnical Engineering Study  
Clint Moore Rd. & SR-7 Intersection Improvements  
Palm Beach County, Florida  
PBC Project No. 2021100  
TSF Proposal No.: 2101-062**

Dear Maj:

As requested, TSF is pleased to submit this proposal for the above-referenced project. The proposal is based on a scope meeting on 1/26/21. This proposal includes an outline of our understanding of the project, our proposed scope of work, an estimate of the total fees, and our anticipated schedule for completion of the work.

#### **PROPOSED SCOPE OF WORK**

All work performed by TSF will be in general accordance with Palm Beach County (PBC) standards. Our understanding of the project is as follows:

1. Clint Moore Road will be extended west bound about 250 feet west of SR-7 (West bound through lane);
2. South bound SR-7, about 300 feet south of Clint Moore Road will be widened on the west side; and
3. New Mast Arms at the intersection.

As directed by PBC, our scope of work is provided in Table 1 below.

<b>Table 1 – Proposed Field Testing</b>	
<b>Location</b>	<b>Proposed Services</b>
Clint Moore Road Extension	Three (3) Auger Borings to 10 feet
SR-7 Widening	Three (3) Auger Borings to 10 feet
Drainage Areas	Two (2) Borehole Permeability Tests
Mast Arms	Two (2) Standard Penetration Test (SPT) borings to 30 feet.



**Propel Engineering, Inc.**  
**TSF Proposal No. 2101-062**

Boring locations will be approximately located in the field by our personnel by measuring distances with a tape from known reference points. Elevations at boring locations can be interpreted from topographic plans if furnished by others.

Prior to drilling at the project site, TSF will notify the local utility companies and request that underground utilities be marked. Our experience, however, is that the utility companies will not mark privately owned utilities. Our proposal assumes that private utility lines will be located in the field by others prior to mobilization of the drill rig.

Upon completion of the field exploration, laboratory testing will be performed on selected samples. The study will be summarized in accordance with the FDOT's Soil and Foundation Handbook.

A geotechnical engineer will evaluate the results of all drilling and laboratory testing. A report will be issued that contains the exploration data, a discussion of the site and subsurface conditions, geotechnical subgrade recommendations for pavement design, soil parameters for drilled shaft design, and a discussion of some construction considerations.

### **ESTIMATED FEES**

It is proposed that the fee for the performance of the services outlined above be determined on a unit price basis in accordance with the attached Fee Schedule incorporated into this proposal.

Our fee is based on the assumption that boring locations are open and accessible to our truck mounted drill rig.

Our estimate covers the work needed to present our findings and recommendations in a formal report. Not included are reviews of drawings, preparation of construction specifications, special conferences and any other work requested after submittal of our report.

### **SCHEDULE AND AUTHORIZATION**

TSF will proceed with the work after receipt of a signed copy of this proposal. With our present schedule, we can commence work within several days of project approval (weather permitting and permit approval). The fieldwork will take about 3 days to complete. The written report can be submitted about three weeks after completion of the field exploration, depending on the extent of the laboratory-testing program. Verbal preliminary recommendations can be made to appropriate parties prior to submittal of the written report.

**Propel Engineering, Inc.**  
**TSF Proposal No. 2101-062**

We at TSF appreciate the opportunity to submit this proposal and look forward to working with you on this project. If you should have any questions concerning our proposal, please contact our office.

Respectfully submitted,

***TIERRA SOUTH FLORIDA, INC.***

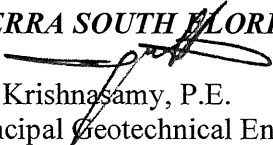
  
Raj Krishnasamy, P.E.  
Principal Geotechnical Engineer/ President

  
Ramakumar Vedula, P.E.  
Principal Engineer

Attachments:

1. Fee Estimate

TIERRA SOUTH FLORIDA, INC.

2101-062. Clint Mooe Rd. & SR-7 Intersection Improvements (Roadway)

	Unit	# of Units	Unit Price		Total
<b>I. FIELD INVESTIGATION</b>					
Mobilization of Men and Equipment Truck	Trip	1	\$	350.00	\$ 350.00 ✓
Roadway Auger Borings	L.F.	60	\$	10.00	\$ 600.00 ✓
Percolation Test	Each	2	\$	300.00	\$ 600.00 ✓
<b>II. LABORATORY TESTING</b>					
Visual Examination by Staff Engineer	Hour	4	\$	110.00	\$ 440.00 ✓
Natural Moisture Content Tests	Test	6	\$	20.00	\$ 120.00 ✓
Grain-Size Analysis - Full Gradation	Test	6	\$	75.00	\$ 450.00 ✓
Corrosion Test	Test	1	\$	190.00	\$ 190.00 ✓
Organic Content Tests	Test	6	\$	50.00	\$ 300.00 ✓
<b>III. FIELD ENGINEERING AND TECHNICAL SERVICES</b>					
Site Recon./Utility Coordination/MOT Sr. Engineering Technician	Hour	8	\$	80.00	\$ 640.00 ✓
<b>IIIA. ENGINEERING AND TECHNICAL SERVICES</b>					
Principal Engineer	Hour	2	\$	185.00	\$ 370.00 ✓
Senior Geotechnical Engineer	Hour	8	\$	175.00	\$ 1,400.00 ✓
Project Engineer	Hour	16	\$	145.00	\$ 2,320.00 ✓
Drafter/CADD	Hour	8	\$	65.00	\$ 520.00 ✓
<b>TOTAL FEE FOR GEOTECHNICAL SERVICES (ROADWAY) =</b>					<b>\$ 8,300.00 ✓</b>

TIERRA SOUTH FLORIDA, INC.

2101-062. Clint Moore Rd. & SR-7 Intersection Improvements (Mast Arms)

	Unit	# of Units	Unit Price		Total
<b>I. FIELD INVESTIGATION</b>					
Mobilization of Men and Equipment Truck	Trip	1	\$	350.00	\$ 350.00 ✓
SPT Borings 0 - 50 ft depth	L.F.	60	\$	13.00	\$ 780.00 ✓
Grout Boreholes 0 - 50 ft depth	L.F.	60	\$	6.00	\$ 360.00 ✓
Casing Allowance 0 - 50 ft depth	L.F.	60	\$	7.00	\$ 420.00 ✓
MOT MOT could entail a 2-man crew with equipment such as cones, barricades, portable signs, and support vehicle. Lane closures are expected at pavement core locations and where there will be access or utility conflict issues.	Each	1	\$	1200.00	\$ 1,200.00 ✓
<b>II. LABORATORY TESTING</b>					
Visual Examination by Staff Engineer	Hour	2	\$	110.00	\$ 220.00 ✓
Corrosion Test	Test	2	\$	190.00	\$ 380.00 ✓
<b>III. FIELD ENGINEERING AND TECHNICAL SERVICES</b>					
Site Recon./Utility Coordination/MOT Sr. Engineering Technician	Hour	8	\$	80.00	\$ 640.00 ✓
<b>IIIA. ENGINEERING AND TECHNICAL SERVICES</b>					
Principal Engineer	Hour	1	\$	185.00	\$ 185.00 ✓
Senior Geotechnical Engineer	Hour	2	\$	175.00	\$ 350.00 ✓
Project Engineer	Hour	8	\$	145.00	\$ 1,160.00 ✓
Drafter/CADD	Hour	4	\$	65.00	\$ 260.00 ✓
<b>TOTAL FEE FOR GEOTECHNICAL SERVICES (MAST ARMS) =</b>					<b>\$ 6,305.00 ✓</b>

### OEBO SCHEDULE 1

#### LIST OF PROPOSED CONTRACTOR/CONSULTANT AND SUBCONTRACTOR/SUBCONSULTANT PARTICIPATION

**SOLICITATION/PROJECT/BID NAME:** Clint Moore Rd. & SR 7 Intersection Improvements      **SOLICITATION/PROJECT/BID No.:** 2021100  
**NAME OF PRIME RESPONDENT/BIDDER:** Propel Engineering, Inc.      **ADDRESS:** 2711 Vista Parkway, Suite B-7, West Palm Beach, FL 33411  
**CONTACT PERSON:** Majharul Alam, PE, PMP      **PHONE NO.:** 561-866-5730      **E-MAIL:** maj@propel-engineering.com  
**SOLICITATION OPENING/SUBMITTAL DATE:** September 17, 2019      **DEPARTMENT:** Engineering & Public Works

**PLEASE LIST THE DOLLAR AMOUNT OR PERCENTAGE OF WORK TO BE COMPLETED BY THE PRIME CONTRACTOR/CONSULTANT ON THIS PROJECT. PLEASE ALSO LIST THE DOLLAR AMOUNT OR PERCENTAGE OF WORK TO BE COMPLETED BY ALL SUBCONTRACTORS/SUBCONSULTANTS ON THE PROJECT.**

Name, Address and Phone Number	(Check all Applicable Categories)			DOLLAR AMOUNT OR PERCENTAGE OF WORK				
	Non-SBE	M/WBE	SBE	Black	Hispanic	Women	Caucasian	Other (Please Specify)
		Minority/Women Business	Small Business					
1. Propel Engineering, Inc. 2711 Vista Parkway, Suite B-7, West Palm Beach, FL 33411 (561) 866-5730	<input type="checkbox"/>	<input checked="" type="checkbox"/>	<input checked="" type="checkbox"/>	_____	_____	_____	_____	\$131,057.18 (Asian)
2. Tierra South Florida, Inc. 2765 Vista Parkway, Suite 10 West Palm Beach, FL 33411 (561) 687-8536	<input checked="" type="checkbox"/>	<input type="checkbox"/>	<input type="checkbox"/>	_____	_____	_____	_____	\$14,605.00 (Asian)
3. Brown & Phillips, Inc. 1860 Old Okeechobee Road, Suite 509 West Palm Beach, FL 33409 (561) 615-3988	<input type="checkbox"/>	<input checked="" type="checkbox"/>	<input checked="" type="checkbox"/>	\$12,390.95	_____	_____	_____	_____
4.	<input type="checkbox"/>	<input type="checkbox"/>	<input type="checkbox"/>	_____	_____	_____	_____	_____
5.	<input type="checkbox"/>	<input type="checkbox"/>	<input type="checkbox"/>	_____	_____	_____	_____	_____
(Please use additional sheets if necessary)				<b>Total</b>	\$12,390.95	_____	_____	\$145,662.18
<b>Total Bid Price \$</b> <u>158,053.13</u>				<b>Total SBE - M/WBE Participation</b> <u>\$143,448.13</u>				

**I hereby certify that the above information is accurate to the best of my knowledge:** Majharul Alam      President  
2021.04.23 13:04:58 -04'00'      Signature      Title

- Note:**
1. The amount listed on this form for a Subcontractor/subconsultant must be supported by price or percentage listed on the properly executed Schedule 2 or attached signed proposal.
  2. Firms may be certified by Palm Beach County as an SBE and/or an M/WBE. If firms are certified as both an SBE and/or M/WBE, please indicate the dollar amount under the appropriate category.
  3. Modification of this form is not permitted and will be rejected upon submittal.

OEBO LETTER OF INTENT – SCHEDULE 2

A completed Schedule 2 is a binding document between the Prime Contractor/consultant and a Subcontractor/subconsultant (for any tier) and should be treated as such. The Schedule 2 shall contain bolded language indicating that by signing the Schedule 2, both parties recognize this Schedule as a binding document. All Subcontractors/subconsultants, including any tiered Subcontractors/subconsultants, must properly execute this document. Each properly executed Schedule 2 must be submitted with the bid/proposal.

SOLICITATION/PROJECT NUMBER: 2020100

SOLICITATION/PROJECT NAME: Clint Moore Rd. & SR 7 Intersection Improvements

Prime Contractor: Propel Engineering, Inc. Subcontractor: N/A

(Check box(s) that apply)

SBE  WBE  MBE  M/WBE  Non-S/M/WBE Date of Palm Beach County Certification (if applicable): 04/12/2020

The undersigned affirms they are the following (select one from each column if applicable):

<b>Column 1</b>	<b>Column 2</b>	<b>Column 3</b>
<input checked="" type="checkbox"/> Male <input type="checkbox"/> Female	<input type="checkbox"/> African-American/Black <input checked="" type="checkbox"/> Asian American <input type="checkbox"/> Caucasian American	<input type="checkbox"/> Supplier
	<input type="checkbox"/> Hispanic American <input type="checkbox"/> Native American	

**S/M/WBE PARTICIPATION** – S/M/WBE Primes must document all work to be performed by their own work force on this form. Failure to submit a properly executed Schedule 2 for any S/M/WBE participation may result in that participation not being counted. Specify in detail, the scope of work to be performed or items supplied with the dollar amount and/or percentage for each work item. S/M/WBE credit will only be given for the areas in which the S/M/WBE is certified. A detailed proposal may be attached to a properly executed Schedule 2.

Line Item	Item Description	Unit Price	Quantity/ Units	Contingencies/ Allowances	Total Price/Percentage
1	3.02 General Highway Design and 3.06 Traffic Operation Design	\$131,057.18	1	N/A	\$131,057.18

The undersigned Subcontractor/subconsultant is prepared to self-perform the above-described work in conjunction with the aforementioned project at the following total price or percentage: \$131,057.18

If the undersigned intends to subcontract any portion of this work to another Subcontractor/subconsultant, please list the business name and the amount below accompanied by a separate properly executed Schedule 2.

\_\_\_\_\_ Price or Percentage: \_\_\_\_\_

Name of 2<sup>nd</sup>/3<sup>rd</sup> tier Subcontractor/subconsultant

Propel Engineering, Inc.  
 Print Name of Prime  
 Majharul Alam  
 By: 2021.04.23 13:06:28 -04'00'  
 \_\_\_\_\_  
 Authorized Signature  
Majharul Alam  
 Print Name  
President  
 Title  
 Date: 04/23/2021

N/A  
 Print Name of Subcontractor/subconsultant  
 By: N/A  
 \_\_\_\_\_  
 Authorized Signature  
N/A  
 Print Name  
N/A  
 Title  
 Date: N/A

OEBO LETTER OF INTENT – SCHEDULE 2

A completed Schedule 2 is a binding document between the Prime Contractor/consultant and a Subcontractor/subconsultant (for any tier) and should be treated as such. The Schedule 2 shall contain bolded language indicating that by signing the Schedule 2, both parties recognize this Schedule as a binding document. All Subcontractors/subconsultants, including any tiered Subcontractors/subconsultants, must properly execute this document. Each properly executed Schedule 2 must be submitted with the bid/proposal.

SOLICITATION/PROJECT NUMBER: 2021100

SOLICITATION/PROJECT NAME: Clint Moore Rd. & SR 7 Intersection Improvements

Prime Contractor: Propel Engineering, Inc. Subcontractor: Tierra South Florida, Inc.

(Check box(s) that apply)

SBE  WBE  MBE  M/WBE  Non-S/M/WBE Date of Palm Beach County Certification (if applicable): \_\_\_\_\_

The undersigned affirms they are the following (select one from each column if applicable):

<b>Column 1</b>	<b>Column 2</b>	<b>Column 3</b>
<input checked="" type="checkbox"/> Male <input type="checkbox"/> Female	<input type="checkbox"/> African-American/Black <input checked="" type="checkbox"/> Asian American <input type="checkbox"/> Caucasian American	<input type="checkbox"/> Supplier
	<input type="checkbox"/> Hispanic American <input type="checkbox"/> Native American	

**S/M/WBE PARTICIPATION** – S/M/WBE Primes must document all work to be performed by their own work force on this form. Failure to submit a properly executed Schedule 2 for any S/M/WBE participation may result in that participation not being counted. Specify in detail, the scope of work to be performed or items supplied with the dollar amount and/or percentage for each work item. S/M/WBE credit will only be given for the areas in which the S/M/WBE is certified. A detailed proposal may be attached to a properly executed Schedule 2.

Line Item	Item Description	Unit Price	Quantity/ Units	Contingencies/ Allowances	Total Price/Percentage
	Geotechnical Engineering				\$14,605.00

The undersigned Subcontractor/subconsultant is prepared to self-perform the above-described work in conjunction with the aforementioned project at the following total price or percentage: \$14,605.00

If the undersigned intends to subcontract any portion of this work to another Subcontractor/subconsultant, please list the business name and the amount below accompanied by a separate properly executed Schedule 2.

\_\_\_\_\_ Price or Percentage: \_\_\_\_\_

Name of 2<sup>nd</sup>/3<sup>rd</sup> tier Subcontractor/subconsultant

**Propel Engineering, Inc.**

Print Name of Prime  
Majharul Alam  
By: 2021.04.26 08:03:21 -04'00'  
\_\_\_\_\_  
Authorized Signature

**Majharul Alam**  
\_\_\_\_\_  
Print Name

**President**  
\_\_\_\_\_  
Title

Date: **04/26/2021**  
\_\_\_\_\_

**Tierra South Florida, Inc.**

Print Name of Subcontractor/subconsultant  
Rajan Krishnasamy  
By: 2021.04.20 09:51:00 -04'00'  
\_\_\_\_\_  
Authorized Signature

**Raj Krishnasamy, PE**  
\_\_\_\_\_  
Print Name

**President**  
\_\_\_\_\_  
Title

Date: **4/20/2021**  
\_\_\_\_\_

OEBO LETTER OF INTENT – SCHEDULE 2

A completed Schedule 2 is a binding document between the Prime Contractor/consultant and a Subcontractor/subconsultant (for any tier) and should be treated as such. The Schedule 2 shall contain bolded language indicating that by signing the Schedule 2, both parties recognize this Schedule as a binding document. All Subcontractors/subconsultants, including any tiered Subcontractors/subconsultants, must properly execute this document. Each properly executed Schedule 2 must be submitted with the bid/proposal.

SOLICITATION/PROJECT NUMBER: 2021100

SOLICITATION/PROJECT NAME: Clint Moore Rd. & SR 7 Intersection Improvements

Prime Contractor: Propel Engineering, Inc. Subcontractor: Brown & Phillips, Inc.

(Check box(s) that apply)

SBE  WBE  MBE  M/WBE  Non-S/M/WBE Date of Palm Beach County Certification (if applicable): 1/31/19-1/30/22

The undersigned affirms they are the following (select one from each column if applicable):

<b>Column 1</b>	<b>Column 2</b>	<b>Column 3</b>
<input checked="" type="checkbox"/> Male <input type="checkbox"/> Female	<input checked="" type="checkbox"/> African-American/Black <input type="checkbox"/> Asian American <input type="checkbox"/> Caucasian American <input type="checkbox"/> Hispanic American <input type="checkbox"/> Native American	<input type="checkbox"/> Supplier

**S/M/WBE PARTICIPATION** – S/M/WBE Primes must document all work to be performed by their own work force on this form. Failure to submit a properly executed Schedule 2 for any S/M/WBE participation may result in that participation not being counted. Specify in detail, the scope of work to be performed or items supplied with the dollar amount and/or percentage for each work item. S/M/WBE credit will only be given for the areas in which the S/M/WBE is certified. A detailed proposal may be attached to a properly executed Schedule 2.

Line Item	Item Description	Unit Price	Quantity/Units	Contingencies/Allowances	Total Price/Percentage
1	5.02 Engineering Surveying	\$12,390.95	1	N/A	\$12,390.95

The undersigned Subcontractor/subconsultant is prepared to self-perform the above-described work in conjunction with the aforementioned project at the following total price or percentage: \$12,390.95

If the undersigned intends to subcontract any portion of this work to another Subcontractor/subconsultant, please list the business name and the amount below accompanied by a separate properly executed Schedule 2.

\_\_\_\_\_ Price or Percentage: \_\_\_\_\_

Name of 2<sup>nd</sup>/3<sup>rd</sup> tier Subcontractor/subconsultant

**Propel Engineering, Inc.**

Print Name of Prime

Majharul Alam  
By: 2021.04.23 13:05:49 -04'00'

Authorized Signature

**Majharul Alam**

Print Name

**President**

Title

Date: **04/23/2021**

**Brown & Phillips, Inc.**

Print Name of Subcontractor/subconsultant

John E Phillips  
By: Digitally signed by John E Phillips  
Date: 2021.04.19 08:03:47 -04'00'

Authorized Signature

**John E. Phillips**

Print Name

**President**

Title

Date: **04/19/2021**





Search

Insured Name

Propel Engineering, Inc. (000001221)

Propel Engineering, Inc. (000001221)

Action Accounts Only

Admin Search

Home Insured Tasks View Insured

Insured

Name: Propel Engineering, Inc.

Account Number: 000001221

Address:

Status: Currently in Compliance

Insured Tasks Admin Tools

- View
- Insured
- Notes
- History
- Definitions
- Navigation
- Requestments
- Control Screen
- Add
- Edit
- Help
- Video Tutorials

Insured

Business Unit(s) DBA Number Print Insured Info Print Compliance Report

Account Information

Account Number: 000001221

Plan Type: Standard - Professional Services

Do Not Call: Address Updated

Address Information

Building Address: Physical Address

Insured: Propel Engineering, Inc.

Address 1:

Address 2:

City:

State:

Zip:

Country:

Contract Information

Contract Number:

Contract Start Date: Contract End Date:

Contract Effective Date: Contract Expiration Date:

Description of Services: R0000-0542-Havenhill Road B. of Century Ave. to N. of Century Blvd. Underpasses Annual Safety Form B: No

Contact Information

Contact Name: Maj Alam Misc:

Phone Number: 5818885730 All Phone Number:

Fax Number:

E-Mail Address: maj@propel-engineering.com

Approval Date:

Main: No

Contract on File: No

Certificate Renewal: No

Indemnification Agreement: No

Fax ID:

New Account created by UV on 10/23/2020