

**PALM BEACH COUNTY  
BOARD OF COUNTY COMMISSIONERS  
AGENDA ITEM SUMMARY**

<b>Meeting Date:</b>	July 12, 2022	<input checked="" type="checkbox"/> <b>Consent</b>	<input type="checkbox"/> <b>Regular</b>
		<input type="checkbox"/> <b>Ordinance</b>	<input type="checkbox"/> <b>Public Hearing</b>
<b>Department:</b>	Engineering & Public Works		
<b>Submitted By:</b>	Engineering & Public Works		
<b>Submitted For:</b>	Traffic Division		

**I. EXECUTIVE BRIEF**

**Motion and Title: Staff recommends motion to approve:**

- A) a work order in the amount of \$325,811.80 to Palm Beach County’s (County) annual traffic signal contract dated September 10, 2019 (R2019-1260), as amended on July 7, 2020 (R2020-0759) with Gerelco Traffic Controls, Inc. (Gerelco) to construct a new mast arm traffic signal at the intersection of Silver Beach Road and Avenue S, County Intersection ID Number 19055 (Project); and
- B) a budget amendment of \$116,734 in the Road Impact Fee Zone 1 Fund to recognize reimbursement funding from the developer and appropriate it to the Project.

**SUMMARY:** Approval of this work order will allow Gerelco to construct the Project. Per County PPM CW-F-050, this work order exceeds the threshold relating to staff approvals of work orders to annual contracts, thus requiring approval from the Board of County Commissioners (BCC). Prior to this work order, \$1,223,785.03 of Gerelco’s \$9,000,000 contract has been spent or encumbered. The Office of Equal Business Opportunity has granted a waiver of the Affirmative Procurement Initiatives based on the limited availability of highly specialized and qualified small, minority, and woman owned businesses to perform the specialized construction of traffic signals. On September 10, 2019, the BCC approved the annual traffic signal contract with Gerelco to provide for and install various signal components for traffic control devices. On July 7, 2020, the BCC approved the first amendment to the contract, which increased the amount to \$9,000,000 and extended the expiration date until September 9, 2022. District 7 (YBH)

**Background and Justification:** The County is now requesting that Gerelco construct the Project in accordance with the work order. The estimated construction cost is \$271,509.83 with a contingency of \$54,301.97. The Engineering & Public Works Department recommends BCC approval.

**Attachments:**

- 1. Location Sketch
- 2. Work Order with Exhibits A and B
- 3. Office of Equal Business Opportunity Waiver
- 4. Budget Amendment

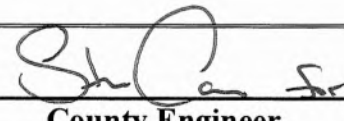
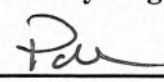
<b>Recommended By:</b>	<i>ma</i> 	<i>6/6/22</i>
YBH/TEL	County Engineer	Date
<b>Approved By:</b>		<i>7/5/22</i>
	Assistant County Administrator	Date

**II. FISCAL IMPACT ANALYSIS**

**A. Five Year Summary of Fiscal Impact:**

Fiscal Years	2022	2023	2024	2025	2026
Capital Expenditures	<u>\$390,812</u>	<u>-0-</u>	<u>-0-</u>	<u>-0-</u>	<u>-0-</u>
Operating Costs	<u>-0-</u>	<u>-0-</u>	<u>-0-</u>	<u>-0-</u>	<u>-0-</u>
External Revenues	<u>(\$116,734)</u>	<u>-0-</u>	<u>-0-</u>	<u>-0-</u>	<u>-0-</u>
Program Income (County)	<u>-0-</u>	<u>-0-</u>	<u>-0-</u>	<u>-0-</u>	<u>-0-</u>
In-Kind Match (County)	<u>-0-</u>	<u>-0-</u>	<u>-0-</u>	<u>-0-</u>	<u>-0-</u>
NET FISCAL IMPACT	<u>\$274,078</u>	<u>-0-</u>	<u>-0-</u>	<u>-0-</u>	<u>-0-</u>
# ADDITIONAL FTE					
POSITIONS (Cumulative)					

Is Item Included in Current Budget? Yes X No  
 Does this item include the use of federal funds? Yes No X

**Budget Account No:**

Fund 3501 Dept 361 Unit 0994 Object 6408/6693

**Recommended Sources of Funds/Summary of Fiscal Impact:**

Road Impact Fee Zone 1 Fund  
 Silver Beach Road /East of Congress Ave to Old Dixie Highway

Construction Contract	\$271,509.83
Contingency	\$ 54,301.97
Traffic Operation Cost	\$ 65,000.00
Total Construction Cost	\$390,811.80
Funding ASVRF Silver Beach Rd LLC	<\$116,733.25>
Fiscal Impact	\$274,078.55

**C. Departmental Fiscal Review:**

  
 \_\_\_\_\_

**III. REVIEW COMMENTS**

**A. OFMB Fiscal and/or Contract Dev. and Control Comments:**

ASD/CLM 6/10/22  
 6/9/22 OFMB JH 6-8-22

J. J. Jacobus 6/24/22  
 Contract Dev. and Control  
 6-24-22 TW

**B. Approved as to Form and Legal Sufficiency:**

MB Heron 6/30/22  
 Assistant County Attorney

**C. Other Department Review:**

\_\_\_\_\_  
 Department Director

**This summary is not to be used as a basis for payment.**

# Proposed Traffic Signal # 19055

## Silver Beach Road and Avenue S

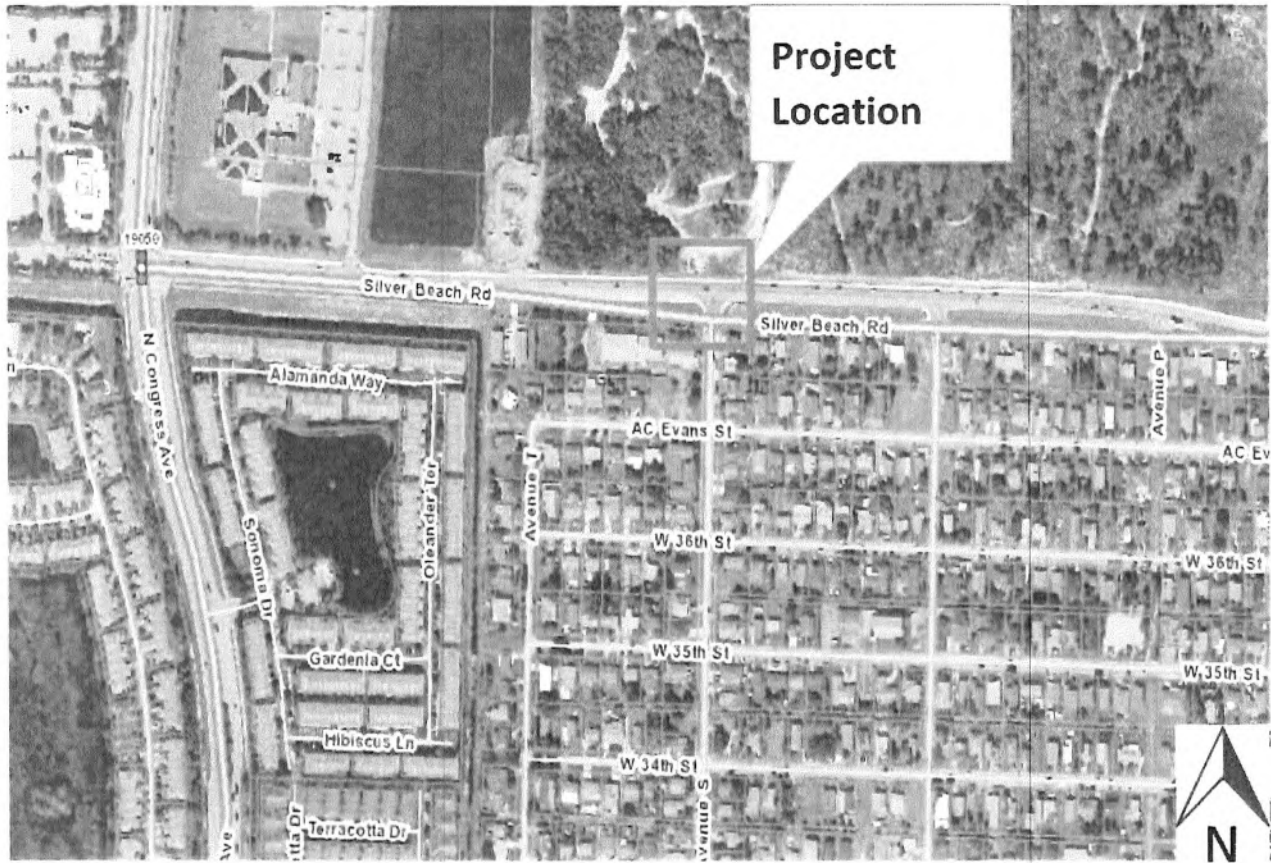

**WORK ORDER TO THE ANNUAL TRAFFIC SIGNAL CONTRACT (R2019-1260), AS AMENDED (R2020-0759), BETWEEN PALM BEACH COUNTY AND GERELCO TRAFFIC CONTROLS, INC. TO CONSTRUCT A MAST ARM TRAFFIC SIGNAL AT THE INTERSECTION OF SILVER BEACH ROAD AND AVENUE S, PALM BEACH COUNTY INTERSECTION ID NUMBER 19055, SIGNAL PROJECT NUMBER 2020-10, PALM BEACH COUNTY PROJECT NUMBER 2003514, PALM BEACH COUNTY, FLORIDA**

**THIS WORK ORDER TO THE ANNUAL TRAFFIC SIGNAL CONTRACT DATED SEPTEMBER 10, 2019 (2019-1260), AS AMENDED ON JULY 7, 2020 (R2020-0759), is made and entered into this \_\_\_\_ day of \_\_\_\_\_, 2022, by and between Palm Beach County, a political subdivision of the State of Florida, by and through its Board of County Commissioners (COUNTY), and GERELCO TRAFFIC CONTROLS, INC., a Florida corporation with an address of 560 NW Enterprise Drive, Port Saint Lucie, FL 34986 (CONTRACTOR).**

**WITNESSETH**

**WHEREAS, on September 10, 2019, COUNTY and CONTRACTOR entered into an Annual Contract (R2019-1260) that was then amended on July 7, 2020 (R2020-0759), (CONTRACT) to provide for the furnishing and installation of various signal components for traffic control devices on a work order basis; and**

**WHEREAS, COUNTY desires CONTRACTOR to construct a mast arm traffic signal at the intersection of Silver Beach Road and Avenue S, Palm Beach County Intersection ID Number 19055, (PROJECT); and**

**WHEREAS, CONTRACTOR agrees to construct the PROJECT in accordance with the terms and conditions of the CONTRACT, as amended, and as directed and accepted by the COUNTY; and**

**WHEREAS, pursuant to the CONTRACT, a cost not to exceed \$325,811.80 has been calculated by COUNTY and found to be appropriate compensation for the services to be performed by CONTRACTOR to construct the PROJECT.**

**NOW, THEREFORE, THIS INDENTURE WITNESSETH:** That for and in consideration of the mutual benefits to flow from each to the other, the parties hereto agree as follows:

1. The above recitals are true and correct and incorporated herein.
2. **CONTRACTOR** agrees to provide services for the **PROJECT** in accordance with the **CONTRACT**, as amended, and as further described in **Exhibits A and B**.

3. COUNTY agrees to pay the CONTRACTOR a fee not to exceed \$325,811.80 to construct the PROJECT. Final payment shall be per documented quantities installed.

IN WITNESS WHEREOF, the Board of County Commissioners of Palm Beach County, Florida, has made and executed this Work Order for the PROJECT, pursuant to the CONTRACT, as amended, on behalf of the COUNTY, and CONTRACTOR has hereunto set its hand the day and year above written.

OWNER:

Palm Beach County, a political subdivision of the State of Florida by and through its Board of County Commissioners

BY

Robert S. Weinroth, Mayor

ATTEST:

Joseph Abruzzo  
Clerk of the Circuit Court & Comptroller

BY

Deputy Clerk

COUNTY SEAL

APPROVED AS TO TERMS AND CONDITIONS

BY:

Motasem Al-Turk  
Traffic Division, Director

APPROVED AS TO FORM & LEGAL SUFFICIENCY:

BY:

Yelizaveta Herman  
Assistant County Attorney

CONTRACTOR:

Gerelco Traffic Controls, Inc., a Florida Corporation

BY:

Kenneth A. Geremia, Jr.  
President

CORPORATE SEAL

WITNESS:

BY:

O'teaka Lilly

(Printed Name)

BY:

Maria Enriquez

(Printed Name)

PALM BEACH COUNTY ENGINEERING & PUBLIC WORKS  
TRAFFIC DIVISION WORK ORDER / ANNUAL CONTRACT R2019-1260

PROJECT NAME: Silver Beach Road and Avenue S

(PBC Intersection 19055)

BUDGET LINE ITEM: 3501-361-0994-XXXXXX

KDO NUMBER: EN XXXXX

PBC ENGINEERING ANNUAL SIGNAL CONTRACT NUMBER: 2019-050

PBC ENGINEERING PROJECT NUMBER: 2003514

PBC TRAFFIC DIVISION SIGNAL PROJECT NUMBER: 2020-10

WORK ORDER NUMBER: G-03

DATE: \_\_\_\_\_ COMMISSION DISTRICT: 7

TO: Kenneth A. Geremia, Jr., Gerelco Traffic Controls, Inc.

In accordance with the terms of your contract dated September 10, 2019, you are directed to provide the following supplies and services: Provide for the furnishing and installation of a mast arm traffic signal as shown on the Signal Plan on sheet 03 thru sheet 05, and Bidtab, dated 01/05/2022.

The above work shall be performed at: Silver Beach Road and Avenue S (PBC Intersection 19055).

STARTING: The contract duration for this work is 240 days. A separate Notice to Proceed ("NTP") letter will be issued directing the contractor to commence work within the time specified in the NTP letter. The total amount of this Work Order, at the contract prices, is estimated to be \$325,811.80, which includes \$54,301.97 contingency (see attached Bidtab for quantities). The Office of Equal Business Opportunity waived the API Requirements (see attached.)

This work shall be coordinated by, (48 hours prior notice to commencement of work):

Fattoush Jafar, P.E., Ph.D.      Traffic Engineering & Operations Manager      (561) 684-4030  
Name                                      Title                                      Telephone

Please indicate your receipt of this Work Order by signing and returning a duplicate copy.

                      President                      772.340.7474  
Name Kenneth A. Geremia, Jr.      Title                      Telephone

Please sign below and submit with invoice at the completion of the project.  
Project completed in compliance with Contract and Project specifications.

Signature \_\_\_\_\_ Title \_\_\_\_\_ Telephone \_\_\_\_\_



PBCBCC-TRAFFIC DIVISION  
2300 N. JOG ROAD  
W.P.B., FL. 33411-2745  
Phone: (561) 684-4030 Fax: (561) 478-5770

**GERELCO BIDTAB**  
**CONTRACT**  
**#2019050**

**DATE:** 1/5/2022 **SIGNAL PROJECT #:**  
**INTERSECTION:** Silver Beach Road & Avenue S  
**INTERSECTION NO.#** 19055

ITEM NO.#	PRODUCT NAME	QTY	PRICE	LINE TOTAL
102-1-A	GENERAL MAINTENANCE OF TRAFFIC - [HR] [F&I]	16	\$140.00	\$2,240.00
630-2-11-2	2" PVC (SCH 40) UNDERGROUND CONDUIT - [LF] [F&I]	394	\$8.25	\$3,250.50
630-2-12-2-1	1-2" (HDPE SDR 11) UNDER PAVEMENT CONDUIT (DIRECTIONAL BORE) - [LF] [F&I]	135	\$13.65	\$1,842.75
630-2-12-2-2	2-2" (HDPE SDR 11) UNDER PAVEMENT CONDUIT (DIRECTIONAL BORE) - [LF] [F&I]	195	\$17.45	\$3,402.75
630-2-12-2-3	3-2" (HDPE SDR 11) UNDER PAVEMENT CONDUIT (DIRECTIONAL BORE) - [LF] [F&I]	215	\$21.25	\$4,568.75
630-2-12-2-5	5-2" (HDPE SDR 11) UNDER PAVEMENT CONDUIT (DIRECTIONAL BORE) - [LF] [F&I]	240	\$28.80	\$6,912.00
632-7-1-19G	SIGNAL CABLE (SPAN LENGTH 751' - Greater) - [PI] [F&I]	1	\$7,300.00	\$7,300.00
632-7-1-4A	PEDESTRIAN SIGNAL CABLE - 4 CONDUCTOR - [PI] [F&I]	1	\$1,242.00	\$1,242.00
632-7-1-7A	PEDESTRIAN SIGNAL CABLE - 7 CONDUCTOR - [PI] [F&I]	1	\$2,516.00	\$2,516.00
633-1-122-24	FIBER OPTIC CABLE, (FSM) 24-COUNT (UNDERGROUND) - [LF] [F&I]	2780	\$2.47	\$6,866.60
635-2-12-A	PULL BOX (17" x 30" x 12"D) HEAVY DUTY COVERS (TIER 15) - [EA] [F&I]	27	\$796.00	\$21,492.00
635-2-12-C	PULL BOX (30" x 48" x 24"D) HEAVY DUTY SPLIT COVERS (ITS) (TIER 15) - [EA] [F&I]	1	\$1,690.00	\$1,690.00
635-2-12-D	PULL BOX (17" x 30" x 24"D) HEAVY DUTY SPLIT COVERS (ITS) (TIER 15) - [EA] [F&I]	2	\$1,192.00	\$2,384.00
639-1-121	ELECTRICAL POWER SERVICE WITH METER BASE (UNDERGROUND) METER FURNISHED BY POWER COMPANY - [AS] [F&I]	1	\$944.00	\$944.00
639-2-1-3	ELECTRICAL SERVICE WIRE (SINGLE PHASE 3-WIRE, TRIPLEX) - [LF] [F&I]	200	\$2.56	\$512.00
639-3-11	ELECTRICAL SERVICE DISCONNECT (BREAKER BOX, SHEET T 6.2 OF PBC STANDARDS) - [EA] [F&I]	1	\$398.00	\$398.00
641-2-12-12	PRESTRESSED CONCRETE POLE (12' TYPE P-II) - [EA] [F&I]	1	\$827.00	\$827.00
646-1-11	ALUMINUM SIGNALS POLE, PEDESTAL WITH TRANSFORMER BASE (8 FEET ABOVE GROUND) - [EA] [F&I]	6	\$706.00	\$4,236.00
649-22-3L	MAST ARM ASSEMBLY WITH STREET LIGHT, FURNISH AND INSTALL ON EXISTING FOUNDATION, SINGLE ARM 40' (A40/S-P2/S/L) - [EA] [F&I]	2	\$25,346.00	\$50,692.00
649-22-6L	MAST ARM ASSEMBLY WITH STREET LIGHT, FURNISH AND INSTALL ON EXISTING FOUNDATION, SINGLE ARM 50' (A50/S-P3/S/L) - [EA] [F&I]	1	\$28,616.00	\$28,616.00

DATE: 1/5/2022

SIGNAL PROJECT #:

INTERSECTION:	Silver Beach Road & Avenue S
INTERSECTION NO.#	19055

ITEM NO.#	PRODUCT NAME	QTY	PRICE	LINE TOTAL
649-22-15L	MAST ARM ASSEMBLY WITH STREET LIGHT, FURNISH AND INSTALL ON EXISTING FOUNDATION, SINGLE ARM 70' (A70/S-P5/S/L) - [EA] [F&I]	1	\$37,235.00	\$37,235.00
649-2-14-45	DRILLED SHAFT FOUNDATION ASSEMBLY, 14' DEEP AND 4.5' DIAMETER, FURNISH AND INSTALL (DS/14/4.5) - [EA] [F&I]	1	\$11,228.00	\$11,228.00
649-2-16-45	DRILLED SHAFT FOUNDATION ASSEMBLY, 16' DEEP AND 4.5' DIAMETER, FURNISH AND INSTALL (DS/16/4.5) - [EA] [F&I]	2	\$11,971.00	\$23,942.00
649-2-16-50	DRILLED SHAFT FOUNDATION ASSEMBLY, 16' DEEP AND 5.0' DIAMETER, FURNISH AND INSTALL (DS/16/5.0) - [EA] [F&I]	1	\$12,638.00	\$12,638.00
650-1-13	TRAFFIC SIGNAL HEAD ALUMINUM (3-SECTION, 1-WAY) INCLUDES BACKPLATES - [AS] [F&I]	8	\$854.00	\$6,832.00
650-1-14	TRAFFIC SIGNAL HEAD ALUMINUM (4-SECTION, 1-WAY) INCLUDES BACKPLATES - [AS] [F&I]	2	\$1,012.00	\$2,024.00
653-191	PEDESTRIAN SIGNAL - COUNT DOWN (1-WAY) ALUMINUM - [EA] [F&I]	4	\$604.00	\$2,416.00
653-192	PEDESTRIAN SIGNAL - COUNT DOWN (2-WAY) ALUMINUM - [EA] [F&I]	2	\$1,148.00	\$2,296.00
660-2-106-A	LOOP ASSEMBLY ( TYPE F - 26' ). - [EA] [F&I]	2	\$925.00	\$1,850.00
660-2-106-B	LOOP ASSEMBLY ( TYPE F - 46' ). - [EA] [F&I]	4	\$1,500.00	\$6,000.00
670-5-310-A	TRAFFIC CONTROLLER ASSEMBLY (TYPE 6 - INSTALL ONLY) - [AS] [I]	1	\$4,200.00	\$4,200.00
700-5-42	INTERNALLY ILLUMINATED SIGN (8') INSTALL ONLY - [EA] [I]	4	\$815.00	\$3,260.00
715-5-11(A)	LUMINAIRE & BRACKET ARM ALUMINUM (8') - [EA] [F&I]	4	\$1,091.00	\$4,364.00
*650-1-13A	PEDESTRIAN DETECTOR (PUSH BUTTON) - [EA] [I]	8	\$161.56	\$1,292.48
<b>TOTAL:</b>				<b>\$271,509.83</b>

<p><b>Comments:</b> Bid tab = \$271,509.83 + \$54,301.97 (20% contingency) = subtotal \$325,811.80  Traffic Ops (furnish only items) \$50,000.00 staff costs: \$10,000.00 Striping: \$5,000.00  <b>GRAND TOTAL \$390,811.80</b></p>
---



# COUNTY OF PALM BEACH STATE OF FLORIDA

## SIGNALIZATION PLANS

100% PLANS

### SILVER BEACH ROAD AT AVENUE S P.B.C. PROJECT #2003514 P.B.C. INTERSECTION #19055

INDEX OF SHEETS

SHEET No.	DESCRIPTION
T-1	KEY SHEET
T-2	TABULATION OF QUANTITIES
T-3	GENERAL NOTES
T-4 & T-5	SIGNALIZATION PLANS
T-5A	PAVEMENT MARKING PLAN
T-6	MAST ARM TABULATION
T-7	MAST ARM ASSEMBLIES
T-8	SIGNAL DETAILS

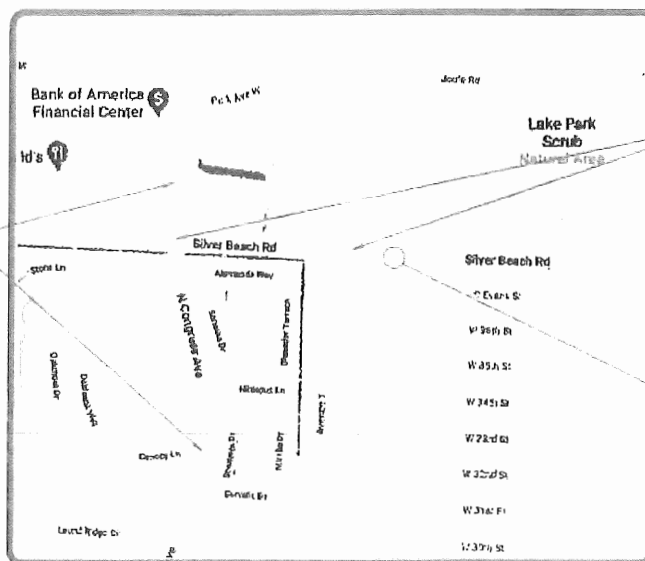

LOCATION MAP  
NOT TO SCALE

SEC. 20&29, TWP. 42S., RGE. 43E.

SILVER BEACH ROAD = 30 M.P.H. SPEED LIMIT

AVENUE S = 25 M.P.H. SPEED LIMIT

PROPOSED PBC-TRAFFIC ITS (BFO) FACILITIES TO BE INCLUDED AS PART OF THE NEW INTERSECTION

SIGNALIZATION SHOP DRAWINGS TO BE SUBMITTED TO:  
SIMMONS & WHITE, INC.  
2581 METROCENTRE BLVD WEST, SUITE 3  
WEST PALM BEACH, FL 33407  
TRICIA@SIMMONSANDWHITE.COM

PLANS PREPARED BY:  
SIMMONS & WHITE, INC.  
2581 METROCENTRE BLVD WEST, SUITE 3  
WEST PALM BEACH, FL 33407

PROJECT LOCATION

NOTE: THE SCALE OF THESE PLANS MAY HAVE CHANGED DUE TO REPRODUCTION.

ENGINEER'S CERTIFICATION

I HEREBY CERTIFY THAT THE ATTACHED PLANS AND DESIGN ARE IN SUBSTANTIAL COMPLIANCE WITH THE DESIGN STANDARDS AND CRITERIA IN EFFECT ON THIS DATE FOR PALM BEACH COUNTY ENGINEERING DEPARTMENT AND THE STATE OF FLORIDA DEPARTMENT OF TRANSPORTATION.

DATE: \_\_\_\_\_ PROFESSIONAL ENGINEER #56925

PATRICIA BARR, P.E.

STANDARDS AND SPECIFICATIONS:  
FLORIDA DEPARTMENT OF TRANSPORTATION, STANDARD PLANS FY2021-2022 EDITION AND STANDARD SPECIFICATIONS FOR ROAD AND BRIDGE CONSTRUCTION JULY 2021, FEBRUARY 2021 PALM BEACH COUNTY TYPICALS FOR PAVEMENT MARKINGS, SIGNING, AND GEOMETRICS, 2019 PALM BEACH COUNTY TRAFFIC SIGNAL INSTALLATION STANDARDS AND DETAILS, AS AMENDED BY CONTRACT DOCUMENTS.

MAINTENANCE OF TRAFFIC:  
FOR INDEX #'S USE F.D.O.T. STANDARD PLANS 102-600, 601, 602, 603, 604, 605, 611, 612, 613, 614, 616, 617 & 680

APPLICABLE DESIGN STANDARDS REVISIONS:  
For Design Standards Modifications click on "Design Standards" at the following web site:  
<https://www.fdot.gov/design/standardplans/current>

  
 PATRICIA MARIE BARR, P.E., STATE OF FLORIDA,  
 PROFESSIONAL ENGINEER, LICENSE NO. 66925  
 THIS ITEM HAS BEEN ELECTRONICALLY SIGNED AND  
 SEALED BY PATRICIA MARIE BARR, P.E. ON 3/9/2022  
 USING A SHA-1 AUTHENTICATION CODE.  
 PRINTED COPIES OF THIS DOCUMENT ARE NOT  
 CONSIDERED SIGNED AND SEALED AND THE SHA-1  
 AUTHENTICATION CODE MUST BE VERIFIED ON ANY  
 ELECTRONIC COPIES.

Digitally signed  
by Patricia Barr  
Date:  
2022.03.09  
13:46:20 -05'00'

  
 SIMMONS & WHITE  
 2581 METROCENTRE BLVD WEST, SUITE 3  
 WEST PALM BEACH, FL 33407  
 (561) 832-1111

DESIGN	BY	CHECKED	APPROVED	DATE
T.S.P.	C.D.	A.L.	R.R.	

**SILVER BEACH ROAD AT AVENUE S**  
**P.B.C. PROJECT #2003514**  
**P.B.C. INTERSECTION #19055**  
**KEY SHEET**

JOB NO. 21-093	DRAWING NO. 21093101	SHEET OF T-1 T-8
-------------------	-------------------------	---------------------

Exhibit A  
Page 4 of 12

# SIGNALIZATION GENERAL NOTES AND PAY ITEM NOTES

Exhibit A  
Page 5 of 12

- 1.) SIGN ASSEMBLY LOCATIONS SHOWN ON PLANS WHICH ARE IN CONFLICT WITH LIGHTING, UTILITIES, DRIVEWAYS, WHEELCHAIR RAMPS, ETC. MAY BE ADJUSTED AS DIRECTED BY THE ENGINEER IN ACCORDANCE WITH THE MANUAL ON UNIFORM TRAFFIC CONTROL DEVICES (MUTCD) FOR STREETS AND HIGHWAYS (U.S. DEPARTMENT OF TRANSPORTATION, FHWA). WARNING SIGN LOCATION CHANGES MUST BE APPROVED BY THE DISTRICT TRAFFIC PLANS AND STANDARDS ENGINEER.
  - 2.) THE CONTRACTOR SHALL REFURBISH EXISTING PAVEMENT MARKINGS DAMAGED DURING CONSTRUCTION.
  - 3.) PRIOR TO EQUIPMENT ORDER, THE CONTRACTOR SHALL SUBMIT FOR APPROVAL TO THE ENGINEER OF RECORD AND PALM BEACH COUNTY EQUIPMENT SPECIFICATIONS OR DESIGN DATA FOR ALL MATERIAL PROPOSED FOR THE PROJECT. THIS SHALL INCLUDE, BUT IS NOT LIMITED TO:
    - I. NON-STRUCTURAL SUBMITTALS
      - ALL GUIDE SIGN LEGENDS (IF DIFFERENT FROM DETAILED)
      - CONTROLLER CABINET AND ASSEMBLY AND VIDEO DETECTION SYSTEM
    - II. STRUCTURAL SUBMITTALS
      - SIGN STRUCTURES, INCLUDING CANTILEVER TRUSSES AND FOUNDATIONS
      - MAST ARM, POLE AND FOUNDATION
  - 4.) SHOP DRAWINGS AND DESIGN DATA SHALL BE SUBMITTED TO THE ENGINEER OF RECORD WITH A COPY OF THE SUBMITTAL LETTER SENT TO THE COUNTY ENGINEER IN CHARGE OF THE PROJECT. ALLOW 30 DAYS TURN AROUND FOR SUBMITTALS.
  - 5.) ALL SUBMITTALS SHOULD BE SENT TO:
 

SIMMONS & WHITE, INC.  
TRICIA@SIMMONSANDWHITE.COM  
TEL: (561) 478-7848
  - 6.) SHOP DRAWINGS AND DESIGN DATAS SHALL BE SUBMITTED ELECTRONICALLY TO THE EOR WITH A COPY SENT TO FATTOUSH JAFAR (FJAFAR@PBCGOV.ORG) AND JEAN MILORD (JMILORD@PBCGOV.ORG). ALLOW 30 DAYS TURN AROUND FOR SUBMITTALS.
  - 7.) ALL SIGNS AND OTHER TRAFFIC CONTROL DEVICES, EXCEPT EQUIPMENT SHOWN OR NOTED ON THE PLAN SHEETS FOR REMOVAL, SHALL BE REMOVED BY THE CONTRACTOR AND STOCKPILED WITHIN THE RIGHT OF WAY 48 HOURS NOTICE TO THE MAINTAINING AGENCY. CONTROL DEVICES SHALL THEN BE REMOVED BY OTHERS FOR DELIVERY TO THE NOTIFIED AGENCY.
    - A.) THE APPROPRIATE UTILITY COMPANIES SHALL BE NOTIFIED BY THE CONTRACTOR TWO (2) BUSINESS DAYS IN ADVANCE OF ANY EXCAVATION INVOLVING ITS UTILITIES SO THAT A COMPANY REPRESENTATIVE CAN BE PRESENT.
- | UTILITY OWNER:  | TELEPHONE NUMBERS:                                 | CONTACT PERSON:   |
|---|--|---|
| SUNSHINE STATE ONE CALL<br>CITY OF RIVERA BEACH SEWER/WATER<br>FP&L                     | 811<br>561-845-4185<br>561-575-6313                | LEIGHTON WALKER<br>WEST-PALM-SERVICE-<br>FLANNING-WB00FPL.COM |
| AT&T/DISTRIBUTION<br>SEACOAST UTILITY AUTHORITY<br>PALM BEACH COUNTY TRAFFIC OPERATIONS | 561-997-0240<br>561-627-2900 X1398<br>561-233-3900 | DINO FARRUGGIO<br>SCOTT SERRA<br>SUPERINTENDENT               |
- 9.) ALL PUBLIC LAND CORNERS AND MONUMENTS WITHIN THE LIMITS OF CONSTRUCTION ARE TO BE PROTECTED BY THE CONTRACTOR AS FOLLOWS: CORNERS AND MONUMENTS IN CONFLICT WITH THE WORK AND IN DANGER OF BEING DAMAGED, DESTROYED OR COVERED HAVE TO BE PROPERLY REFERENCED BY A PROFESSIONAL LAND SURVEYOR. THIS SHALL BE DONE IN ACCORDANCE WITH THE MINIMUM TECHNICAL STANDARDS OF THE FLORIDA BOARD OF PROFESSIONAL LAND SURVEYORS. PRIOR TO BEGINNING WORK AT THE SITE, THE CONTRACTOR SHALL RETAIN A LAND SURVEYOR TO REFERENCE AND RESTORE, UPON COMPLETION OF THE WORK, ALL SUCH CORNERS AND MONUMENTS. THE CONTRACTOR SHALL FURNISH, TO THE DISTRICT LOCATION SURVEYOR, A SIGNED AND SEALED COPY OF THE LAND SURVEYOR'S REFERENCE DRAWING.
  - 10.) ALL SURVEY BENCH MARK MONUMENTS WITHIN THE LIMITS OF CONSTRUCTION SHALL BE PROTECTED AND REFERENCED BY THE CONTRACTOR IN THE SAME WAY AS PUBLIC LAND CORNERS, EXCEPT THAT THE LAND SURVEYOR SHALL NOT BE REQUIRED TO RESTORE THE N.G.V.D. BENCH MARK UPON COMPLETION OF THE WORK. THE CONTRACTOR SHALL PROMPTLY TRANSMIT ALL DISPLACED OR DAMAGED N.G.V.D. DISCS TO THE DISTRICT LOCATION SURVEYOR, WHO WILL NOTIFY THE GEODETIC INFORMATION CENTER.
  - 11.) THE SIGNAL MAINTAINING AGENCY IS PALM BEACH COUNTY TRAFFIC OPERATIONS, SUPERINTENDENT, (561) 233-3900.
  - 12.) DELAY DETECTORS FOR THE RIGHT TURN LANES SHALL OPERATE IN THE NORMAL MODE DURING CORRESPONDING PHASE GREEN AND IN DELAY MODE DURING ALL OTHER INTERVALS.
  - 13.) DELAY DETECTORS FOR THE LEFT TURN LANES SHALL OPERATE IN THE DELAY MODE DURING CORRESPONDING PHASE GREEN AND IN NORMAL MODE DURING ALL OTHER INTERVALS.
  - 14.) THE CONTRACTOR SHALL BE RESPONSIBLE FOR FIELD CHECKING INTERSECTION OPERATIONS AS THEY RELATE TO THE INSTALLATION OF MAST ARMS.
  - 15.) POSITION PULL BOXES, CABINETS, POLES, AND OTHER OBSTRUCTIVE ITEMS CLEAR OF CURB CUT RAMPS.
  - 16.) SPARE CABINET CONDUIT SHALL BE STUBBED AND CAPPED IN THE NEAREST PULL BOXES.
  - 17.) IT SHOULD BE NOTED THAT NO TEST BORINGS WERE MADE WHERE CONDUIT RUNS ARE TO BE INSTALLED BY DIRECTIONAL BORING OR TRENCHING. IT SHALL BE THE CONTRACTOR'S RESPONSIBILITY TO EXAMINE JOB SITE CONDITIONS BEFORE SUBMITTING BID PROPOSALS IN ACCORDANCE WITH SECTION 2-4 OF THE FDOT STANDARD SPECIFICATIONS.
  - 18.) THE CONTRACTOR IS TO USE CAUTION WHEN WORKING IN OR AROUND AREAS OF EXISTING LOOP AND LEAD IN WIRE, OVERHEAD TRANSMISSION LINES, AND UNDERGROUND UTILITIES. THE CONTRACTOR SHALL EXCAVATE BY HAND WHERE CONFLICTS MAY EXIST. DAMAGE TO LOOPS AND ANY SIGNAL EQUIPMENT CAUSED BY CONSTRUCTION OF THIS PROJECT SHALL BE REPAIRED OR REPLACED TO ORIGINAL OR BETTER CONDITION AT NO COST TO PALM BEACH COUNTY.
  - 19.) THE LOCATIONS OF EXISTING UTILITIES SHOWN IN THE PLANS ARE APPROXIMATE. EXACT LOCATIONS SHALL BE DETERMINED BY THE CONTRACTOR DURING CONSTRUCTION.
  - 20.) THE PROPOSED LOCATIONS OF ALL POLES, PEDESTALS, AND OTHER EQUIPMENT REQUIRING EXCAVATION SHALL BE CONSIDERED APPROXIMATE DUE TO THE POTENTIAL OF CONFLICT WITH UNDERGROUND UTILITIES. SLIGHT ADJUSTMENTS DIRECTED BY THE ENGINEER MAY ALSO BE NECESSARY TO SATISFY SAFETY CODES.
  - 21.) CONTRACTOR SHALL CONTACT PALM BEACH COUNTY TRAFFIC OPERATIONS AT 561 233-3900 FORTY-EIGHT (48) HOURS PRIOR TO CONSTRUCTION IF WORK IS BEING DONE WITHIN 10 FEET OF ANY SIGNAL EQUIPMENT OR IN ADVANCE OF ANY SIGNAL RELATED INSTALLATION WORK.
  - 22.) THE CONTRACTOR SHALL SUBMIT IN WRITING TO THE MAINTAINING AGENCY FOR FINAL INSPECTION. ALLOW TWO (2) WEEKS FOR INSPECTION. TO SCHEDULE A SIGNAL INSPECTION, PLEASE EMAIL [ENC-TRAFF-INSPECT@PBCGOV.ORG](mailto:ENC-TRAFF-INSPECT@PBCGOV.ORG).

- 23.) AT THE TIME OF THE FINAL ACCEPTANCE OF THE PROJECT, THE CONTRACTOR SHALL FURNISH PALM BEACH COUNTY WITH TWO (2) COMPLETE SETS OF AS-BUILT PLANS. IN ADDITION, THE CONSULTANT SHALL FURNISH PALM BEACH COUNTY WITH TWO (2) COPIES OF SIGNED AND SEALED PLANS AND ELECTRONIC FILES OF THE PLANS.
- 24.) THE CONTRACTOR SHALL BE RESPONSIBLE FOR COORDINATION AND PERFORMING ALL TREE TRIMMING AND TREE REMOVAL.
- 25.) A 90 DAY BURN-IN PERIOD IS REQUIRED FOR ALL TRAFFIC SIGNAL EQUIPMENT. THE BURN-IN PERIOD WILL COMMENCE UPON A WRITTEN CONDITIONAL ACCEPTANCE BY THE COUNTY AND WILL TERMINATE NINETY (90) CONSECUTIVE DAYS, THEREAFTER, UNLESS AN EQUIPMENT MALFUNCTION OCCURS.
- 26.) THE USE OF "JONES" PLUGS FOR SIGNAL INSTALLATIONS SHALL BE PROHIBITED.
- 27.) PER REQUEST OF CONTRACTOR OR CEI PALM BEACH COUNTY WILL SCHEDULE THE SIGNAL ACTIVATION AFTER THE SIGNAL INSPECTION IS COMPLETED AND ALL OUTSTANDING (PUNCH LIST) ISSUES ARE RESOLVED. CONTRACTOR OR CEI SHALL REQUEST ACTIVATION TWO WEEKS IN ADVANCE.
- 28.) THE CONTRACTOR SHALL BUILD NEW ELECTRICAL POWER SERVICE AND DISCONNECT ON MONUMENT WITH A MINIMUM HEIGHT OF EIGHT (8) FEET.
- 29.) CONTROLLER CABINET - SHALL BE INSTALLED SUCH THAT THE CONTROLLER CABINET DOOR WILL OPEN AWAY FROM THE TRAVEL LANES AND POSITIONED TO ALLOW A TECHNICIAN TO SEE THE INTERSECTION.
- 30.) CONTRACTOR SHOULD REVIEW AND ADHERE TO THE PALM BEACH COUNTY TRAFFIC SIGNAL INSTALLATION STANDARDS AND DETAILS 2018 (OR LATEST REVISED EDITION).
- 31.) DURING DEEP REMOVAL OF MAST ARM FOUNDATION (AND ANY OTHER POLE REMOVAL), IT IS THE CONTRACTOR'S RESPONSIBILITY TO SECURE ANY OTHER FOUNDATION OR STRUCTURE IN THE CLOSE PROXIMITY OF THE FOUNDATION BEING REMOVED. IF THE CONTRACTOR DETERMINES ANY STRUCTURE OR FOUNDATION IN CLOSE PROXIMITY OF FOUNDATION REMOVED COULD POTENTIALLY BE COMPROMISED, THEY SHALL SECURE IT.
- 32.) MAST ARM CONCRETE FOUNDATION SHALL BE POURED IN A SINGLE POUR. FOUNDATIONS THAT DO NOT COMPLY WITH THIS REQUIREMENT SHALL BE COMPLETELY REMOVED AND RE-POURED AT THE CONTRACTOR'S EXPENSE. A DRILL SHAFT INSTALLATION PLAN SHALL BE PART OF THE SHOP DRAWINGS.
- 33.) CONTRACTOR IS RESPONSIBLE FOR THE PROPER BOLT PROJECTION ABOVE FINISHED SIDEWALK GRADE. THE CONTRACTOR SHALL ENSURE THAT THE DRILL SHAFT AND BOLT PATTERNS ARE INSTALLED CORRECTLY SO THAT THE MAST ARM WILL BE ANGGLED AS SHOWN ON THE PLANS.
- 34.) SIGNAL CABLE - CONTRACTOR SHALL INSTALL TRAFFIC SIGNAL CABLE IN ACCORDANCE WITH P.B.C. STANDARDS. THERE SHALL BE NO SPLICING. IF CONTINUOUS RUNS ARE NOT POSSIBLE, THEN TERMINAL BLOCK SHALL BE USED.
- 35.) ALL FIELD WIRING SHALL BE NEATLY BUNDLED AND CLEARLY IDENTIFIED WITH PERMANENT LEGIBLE WEATHERPROOF TAPES THAT ARE SECURELY ATTACHED TO EACH CABLE. THE TAPING SYSTEM PROPOSED SHALL BE SUBMITTED FOR APPROVAL WITH THE OTHER EQUIPMENT SUBMITTALS REQUIRED FOR THIS PROJECT.
- 36.) THE CONTRACTOR SHALL VERIFY COLOR CODES OF SIGNAL CABLE WITH PALM BEACH COUNTY BEFORE ORDERING.
- 37.) THE CONTRACTOR SHALL COORDINATE AND FIELD VERIFY LOCATION(S) OF ELECTRICAL SERVICE POINT PRIOR TO INSTALLING CONDUIT, DISCONNECT SWITCH, TRANSFORMER AND PULL BOXES.
- 38.) ALL PULL BOXES SHALL HAVE 1' WIDE (MIN.) X 6" DEEP CONTINUOUS CONCRETE APRON SLOPED AWAY FROM THE BOX (TYPICALLY 1%).
- 39.) THE DRILL SHAFT FOUNDATION SHALL BE FLUSH WITH THE GROUND ELEVATION OR SIDEWALK, NOT BELOW GROUND LEVEL. DRILL SHAFT MUST NOT EXTEND HIGHER THAN A 2" ELEVATION ABOVE GROUND LEVEL.
- 40.) FOR MAST ARM SIGNAL INSTALLATIONS, THE CONTRACTOR SHALL INSTALL WIRE MESH SUPPORT GRIPS FOR STRAIN RELIEF. ALL SIGNAL CABLE MUST BE HELD BY A STRAIN RELIEF (IE GRAND BC0076PSS) ATTACHED TO THE J HOOK INSIDE OF A MAST ARM. TO USE APPROVED EQUIVALENT, SHOP DRAWINGS SHALL BE SUBMITTED TO PBC ENGINEER FOR PRE-APPROVAL. WRITTEN APPROVAL FOR SHOP DRAWINGS SHALL BE PROVIDED AT TIME OF FINAL SIGNAL INSPECTION.
- 41.) CONTRACTOR TO PROVIDE A MINIMUM 2 FEET CABLE SLACK AT ALL PULL BOXES AND HAND HOLDS.
- 42.) PEDESTRIAN SIGNALS - EACH PEDESTRIAN SIGNAL SHALL BE FED WITH ONE 7 CONDUCTOR CABLE FOR PED SIGNAL HEAD AND ONE 4 CONDUCTOR CABLE FOR THE PED. DETECTOR/PUSH BUTTON. THESE CABLES WILL RUN FROM EACH PEDESTRIAN SIGNAL/DETECTOR DIRECTLY TO CONTROL BOX WITH NO SPLICES.
- 43.) INSTALL PEDESTRIAN SIGNALS PER ADA CLEARANCES, PROVIDING CONTINUOUS UNOBSTRUCTED PEDESTRIAN/WHEELCHAIR CIRCULATION PATH TO PEDESTRIAN AREAS (PUSH BUTTON, RAMP, ETC.).
- 44.) THE T-BASE (PEDESTRIAN PEDESTAL BASE) SHALL BE ORIENTED SO THE TECHNICIAN CAN OPEN THE DOOR AND ALSO SEE ON-COMING TRAFFIC. CAULK AS NEEDED IF THERE IS A LARGE GAP BETWEEN CONCRETE FOUNDATION/SIDEWALK AND THE PEDESTAL BASE.
- 45.) PEDESTAL POLE BASE NUT SHOULD BE LARGE ENOUGH TO COVER HOLE AND WASHER.
- 46.) ALL SET SCREWS MUST BE INSTALLED (NONE SHOULD BE MISSING). MOST MANUFACTURERS HAVE THEM DESIGNED INTO THE PED BASES FROM FACTORY. WHEN PEDESTAL POLE IS SET AT PROPER DIRECTION, DRILL AND TAP HOLE THRU BASE AND ALUMINUM CONDUIT. SET SCREWS SHOULD GO THROUGH SIDE OF BASE INTO PEDESTAL POLE TO PENETRATE W/D PIPE TO KEEP IT FROM ROTATING. USING A 1/2" X 20 SS HEX HEAD BOLT WILL LOCK THE PIPE FROM TURNING.
- 47.) BOLTS SHOULD BE LONG ENOUGH TO PROTRUDE THROUGH THE THREADED HOLE AND HOLD WASHER AND NUT.
- 48.) CAULKING/SEALANT TO BE APPLIED AT ALL SIGNALS FLANGE CONNECTIONS, INCLUDING BUT NOT LIMITED TO THE TOP OF THE FLASHER SIGNAL.
- 49.) THE CONTRACTOR SHALL COORDINATE AND FIELD VERIFY LOCATION(S) OF ELECTRICAL SERVICE POINT PRIOR TO INSTALLING CONDUIT, DISCONNECT SWITCH, TRANSFORMER AND PULL BOXES.
- 50.) POWER SOURCE - ON MODIFICATIONS/UPGRADES TO EXISTING TRAFFIC SIGNALS: A) IF ADDING LOAD, THEN ADD METER. B) IF NOT ADDING LOAD (IE JUST RELOCATING SAME EQUIPMENT) KEEP EXISTING POWER SOURCE. ALL NEW INSTALLED SIGNALS WILL BE METERED. CONTRACTOR SHALL COORDINATE WITH FPL FOR NEW INSTALLATION AS REQUIRED. ELECTRIC SERVICE TO BE SET UP IN CONTRACTOR'S NAME, THEN TRANSFERRED TO PBC TRAFFIC DIVISION AFTER 90 DAY BURN AND FINAL ACCEPTANCE.
- 51.) THE CONTRACTOR SHALL COORDINATE WORK SCHEDULE, COORDINATE TIMING AND AUTHORIZATION OF POWER SERVICE WITH PALM BEACH COUNTY TRAFFIC ENGINEERING. CONTACT TIMING ENGINEER (561-684-4030) 2 WEEKS IN ADVANCE OF CONSTRUCTION AND TO COORDINATE TIMING CHANGES PRIOR TO LOOP DAMAGE. CONTACT PBC TRAFFIC OPERATIONS (561-233-3900) TO COORDINATE REPLACING THE OLD SCHOOL FLASHERS AND RETIMING THE NEW SCHOOL FLASHERS.

## MAINTENANCE OF TRAFFIC:

- 52.) CONTRACTOR MAY BE DIRECTED BY THE PROJECT ENGINEER TO DEVELOP AND IMPLEMENT MODIFICATIONS TO TRAFFIC SIGNAL OPERATION (I.E. TIMING AND PHASING) FOR SIGNALS LOCATED WITHIN THE PROJECT LIMITS SHALL BE NO MORE THAN TOWN (2) HOURS, AND THE CONTRACTOR SHALL RESTORE ALL MALFUNCTIONING TRAFFIC SIGNAL EQUIPMENT TO ITS LEVEL OF OPERATION PRIOR TO MALFUNCTION WITHIN TWENTY-FOUR (24) HOURS. DURING THIS TIME, THE CONTRACTOR SHALL PROVIDE, AT HIS EXPENSE, TEMPORARY TRAFFIC CONTROL DEVICES, FLAGGER PERSONNEL, AND LAW ENFORCEMENT PERSONNEL AS NECESSARY, TO MAINTAIN A SAFE AND EFFICIENT FLOW OF TRAFFIC AT AFFECTED SIGNALIZED AND UNSIGNALIZED INTERSECTIONS. THE ENGINEER SHALL APPROVE ALL MODIFICATIONS PRIOR TO THEIR IMPLEMENTATION.
- 53.) THE CONTRACTOR SHALL INSTALL CONSTRUCTION SIGNING PRIOR TO COMMENCEMENT OF CONSTRUCTION AND SHALL MAINTAIN SIGNING DURING ALL PHASES OF CONSTRUCTION.
- 54.) NOTIFICATION OF PROPOSED LANE CLOSURES OR TEMPORARY DETOURS SHALL BE ACCOMPLISHED, IN WRITING, 14 BUSINESS DAYS IN ADVANCE OF CLOSURE OR DETOUR.
- 55.) AT THE DISCRETION OF THE ENGINEER, IF A LANE CLOSING CAUSES EXTENDED CONGESTION, THE CONTRACTOR SHALL BE DIRECTED TO REOPEN THE CLOSED LANE(S) UNTIL SUCH TIME AS TRAFFIC FLOW HAS RETURNED TO AN ACCEPTABLE LEVEL.
- 56.) THE ALTERATION OF TRAFFIC TRAVEL-WAYS TO CREATE A WORK ZONE SHALL NOT COMMENCE UNTIL ALL LABOR AND MATERIALS ARE READY FOR THE CONSTRUCTION IN THAT ZONE.
- 57.) REGULATORY SPEED DURING CONSTRUCTION SHALL REMAIN AT THE POSTED SPEED.
- 58.) THE CONTRACTOR SHALL REMOVE OR COVER ANY EXISTING OR PROPOSED SIGNS OR PAVEMENT MARKINGS WHICH CONFLICT WITH THE TRAFFIC CONTROL THROUGH THE WORK ZONE. WHEN THE CONFLICT NO LONGER EXISTS, THE CONTRACTOR SHALL RESTORE THE SIGNS OR PAVEMENT MARKINGS TO THEIR ORIGINAL POSITION.
- 59.) THE CONTRACTOR SHALL PREPARE TRAFFIC CONTROL PLANS AND SUBMIT THEM FOR REVIEW AND APPROVAL BY THE ENGINEER OF RECORD AT LEAST TWO (2) BUSINESS DAYS IN ADVANCE OF PROPOSED WORK.
- 60.) VARIABLE MESSAGE SIGNS SHALL BE INSTALLED SEVEN (7) DAYS BEFORE AND SEVEN (7) DAYS AFTER SIGNAL ACTIVATION AS FOLLOWS:

### PRIOR TO SIGNAL ACTIVATION



PANEL 1



PANEL 2  
FLASH

(DATE SHOWN IS AN EXAMPLE ONLY)

### AFTER SIGNAL ACTIVATION



PATRICIA MARIE BARR, P.E., STATE OF FLORIDA  
PROFESSIONAL ENGINEER, LICENSE NO. 56923

THIS ITEM HAS BEEN ELECTRONICALLY SIGNED AND SEALED BY PATRICIA MARIE BARR, P.E. ON 3/6/2022 USING A SHA-1 AUTHENTICATION CODE.

PRINTED COPIES OF THIS DOCUMENT ARE NOT CONSIDERED SIGNED AND SEALED AND THE SHA-1 AUTHENTICATION CODE MUST BE VERIFIED ON ANY ELECTRONIC COPIES.

**SIMMONS & WHITE**  
INCORPORATED 1 PALM BEACH 1 INCORPORATED 1 WINDY HILL  
A Subsidiary, Inc. 2022  
2811 Alderman Blvd. Suite 210, West Palm Beach, Florida 33411-1308 (561) 478-7848

REVISION T.B.	DESIGNED C.O.	CHECKED A.L.	APPROVED R.R.	DATE

**SILVER BEACH ROAD AT AVENUE S**  
P.B.C. PROJECT #2003514  
P.B.C. INTERSECTION #18055  
**GENERAL NOTES**

JOB NO. 21-093	DRAWING NO. 21063T03	SHEET T-3	OF T-8
-------------------	-------------------------	--------------	-----------

PBC PAY ITEM NO.	DESCRIPTION	UNIT	TABULATION OF QUANTITIES						TOTAL THIS SHEET		GRAND TOTAL		REF. SHEET
			1-4		1-5		1-5A		PLAN	FINAL	PLAN	FINAL	
			PLAN	FINAL	PLAN	FINAL	PLAN	FINAL					
100-1	MOBILIZATION/DEMOBILIZATION	LS							1		1		
102-1-A	MOT	LS							1		1		
110-1-1	CLEARING AND GRUBBING	LS							1		1		
630-2-11-2	2" PVC (SCH 40) UNDERGROUND CONDUIT (F & I)	LF	394						394		394		
630-2-12-2-1	1-2" (HDPE SDR 11) UNDER PAVEMENT CONDUIT (DIRECTIONAL BORE) (F & I)	LF	135						135		135		
630-2-12-2-2	2-2" (HDPE SDR 11) UNDER PAVEMENT CONDUIT (DIRECTIONAL BORE) (F & I)	LF	195						195		195		
630-2-12-2-3	3-2" (HDPE SDR 11) UNDER PAVEMENT CONDUIT (DIRECTIONAL BORE) (F & I)	LF	215						215		215		
630-2-12-2-5	5-2" (HDPE SDR 11) UNDER PAVEMENT CONDUIT (DIRECTIONAL BORE) (F & I)	LF	240						240		240		
632-7-1-19G	SIGNAL CABLE (SPAN LENGTH) (751' - GREATER) (F & I)	PI	1						1		1		
632-7-1-4A	PEDESTRIAN SIGNAL CABLE - 4 CONDUCTOR (F & I)	PI	1						1		1		
632-7-1-7A	PEDESTRIAN SIGNAL CABLE - 7 CONDUCTOR (F & I)	PI	1						1		1		
633-1-122-24	FIBER OPTIC CABLE (F & I) (FSM) 24-COUNT (UNDERGROUND)	LF	2780						2780		2780		
635-2-12-A	PULL BOX (17" x 30" x 12"D) HEAVY DUTY COVERS (TIER 15) (F & I)	EA	27						27		27		
635-2-12-C	PULL BOX (30" x 48" x 24"D) HEAVY DUTY SPLIT COVERS (TYS) (TIER 15)	EA	1						1		1		
635-2-12-D	PULL BOX (17" x 30" x 24"D) HEAVY DUTY SPLIT COVERS (TYS) (TIER 15)	EA	2						2		2		
639-1-121	ELECTRICAL POWER SERVICE WITH METER BASE (UNDERGROUND) METER FURNISHED BY POWER COMPANY	AS	1						1		1		
639-2-1-3	ELECTRICAL SERVICE WIRE (SINGLE PHASE 3-WIRE, TRIPLEX) (F & I)	LF	200						200		200		
639-3-11	ELECTRICAL SERVICE DISCONNECT (BREAKER BOX, SHEET T 6.2 OF PBC STANDARD) (F & I)	EA	1						1		1		
641-2-12-12	PRESTRESSED CONCRETE POLE (12' TYPE P-II) (F & I)	EA	1						1		1		
646-1-11	ALUMINUM SIGNALS POLE, PEDESTAL WITH TRANSFORMER BASE (8 FEET ABOVE GROUND) (F & I)	EA	6						6		6		
649-2-14-45	DRILLED SHAFT FOUNDATION ASSEMBLY, 14' DEEP AND 4.5' DIAMETER, FURNISH AND INSTALL (DS/14/4.5)	EA	1						1		1		
649-2-16-45	DRILLED SHAFT FOUNDATION ASSEMBLY, 16' DEEP AND 4.5' DIAMETER, FURNISH AND INSTALL (DS/16/4.5)	EA	2						2		2		
649-2-16-50	DRILLED SHAFT FOUNDATION ASSEMBLY, 16' DEEP AND 5.0' DIAMETER, FURNISH AND INSTALL (DS/16/5.0)	EA	1						1		1		
649-22-3L	MAST ARM ASSEMBLY WITH STREET LIGHT, FURNISH AND INSTALL ON EXISTING FOUNDATION, SINGLE ARM 40' (A40/S-P2/S/L)	EA	2						2		2		
649-22-6L	MAST ARM ASSEMBLY WITH STREET LIGHT, FURNISH AND INSTALL ON EXISTING FOUNDATION, SINGLE ARM 50' (A50/S-P3/S/L)	EA	1						1		1		
649-22-15L	MAST ARM ASSEMBLY WITH STREET LIGHT, FURNISH AND INSTALL ON EXISTING FOUNDATION, SINGLE ARM 70' (A70/S-P5/S/L)	EA	1						1		1		
650-1-13	TRAFFIC SIGNAL HEAD ALUMINUM (3-SECTION, 1-WAY) INCLUDES BACKPLATES	AS			8				8		8		
650-1-14	TRAFFIC SIGNAL HEAD ALUMINUM (4-SECTION, 1-WAY) INCLUDES BACKPLATES	AS			2				2		2		
653-191	PEDESTRIAN SIGNAL - COUNT DOWN (1-WAY) ALUMINUM (F & I)	AS			4				4		4		
653-192	PEDESTRIAN SIGNAL - COUNT DOWN (2-WAY) ALUMINUM (F & I)	AS			2				2		2		
660-1-102	LOOP DETECTOR INDUCTIVE (F & I) (TYPE 2)	EA	6						6		6		
660-2-106-A	LOOP ASSEMBLY (TYPE F 26") (F & I)	EA	2						2		2		
660-2-106-B	LOOP ASSEMBLY (TYPE F 46") (F & I)	EA	4						4		4		
665-1-11	PEDESTRIAN DETECTOR (PUSH BUTTON) (F & I)	EA	8						8		8		
670-5-110-B	TRAFFIC CONTROLLER ASSEMBLY (TYPE 6) AS PER NAZTEC (F & I)	AS	1						1		1		
700-1-11	SINGLE POST SIGN (F & I) (GROUND) (S12 S')	AS			1				1		1		
700-1-60	SINGLE POST SIGN (REMOVE)	AS	1						1		1		
700-3-201	SIGN PANEL (F & I) (OVERHEAD) (S12 SF)	EA			4				4		4		
700-5-22	INTERNALLY ILLUMINATED SIGN (8') FLUORESCENT (F & I)	EA			4				4		4		
711-11-123	THERMOPLASTIC (STD) (WHITE) (SOLID) (12") (F & I)	LF					368		368		368		
711-11-125	THERMOPLASTIC (STD) (WHITE) (SOLID) (24") (F & I)	LF					69		69		69		
711-11-241	THERMOPLASTIC (STD) (YELLOW) (2'-4" DOTTED) (16") (F & I)	LF					0.04		0.04		0.04		
715-5-51	LUMINAIRE AND BRACKET ARM (F & I)	EA	4						4		4		

PAY ITEM NOTES:

- 102-1 INCLUDES COST OF REMOVING ALL CONFLICTING PAVEMENT MARKINGS.
- 630-2-12-2-1 CONSISTS OF THE COST ASSOCIATED WITH FURNISHING AND INSTALLING 1-1" CONDUITS (HDPE SDR II) UNDERPAVEMENT BY DIRECTIONAL BORE.
- 630-2-12-2-2 CONSISTS OF THE COST ASSOCIATED WITH FURNISHING AND INSTALLING 2-2" CONDUITS (HDPE SDR II) UNDERPAVEMENT BY DIRECTIONAL BORE.
- 630-2-12-2-3 CONSISTS OF THE COST ASSOCIATED WITH FURNISHING AND INSTALLING 3-2" CONDUITS (HDPE SDR II) UNDERPAVEMENT BY DIRECTIONAL BORE.
- 630-2-12-2-5 CONSISTS OF THE COST ASSOCIATED WITH FURNISHING AND INSTALLING 5-2" CONDUITS (HDPE SDR II) UNDERPAVEMENT BY DIRECTIONAL BORE.
- 635-2-12-A TYPICAL SIGNAL PULL BOXES SHALL BE 17"x30"x12"D IN DIMENSION AND TIER 15 OR HIGHER. LIDS TO BE MARKED "TRAFFIC SIGNAL".
- 635-2-12-C ITS PULL BOX SHALL BE 30"x48"x24"D IN DIMENSION AND TIER 15 OR HIGHER. LIDS TO BE MARKED "TYS".
- 635-2-12-D ITS PULL BOX SHALL BE 17"x30"x24"D IN DIMENSION AND TIER 15 OR HIGHER. LIDS TO BE MARKED "TYS".
- 640-X-XX-XX AT THE DISCRETION OF THE ENGINEER OF RECORD, FINAL LOCATIONS OF THE MAST ARMS MAY BE ADJUSTED IN THE FIELD IF THERE IS ANY CONFLICT WITH UTILITIES. SIGNAL CONTRACTOR SHALL VERIFY THE PROP. FOUNDATION ELEVATIONS.
- 650-1-13 TRAFFIC SIGNAL HEADS ARE TO BE CAST ALUMINUM. LED MODULES SHALL BE INSTALLED ON ALL SIGNAL DISPLAYS, INCLUDING ARROWS. THESE MODULES SHALL INCLUDE A MANUFACTURER'S WARRANTY OF AT LEAST FIVE YEARS. THE MAXIMUM POWER RATING SHALL BE 10 WATTS FOR RED BALLS, 14 WATTS FOR GREEN BALLS AND 7 WATTS FOR THE ARROWS. ALL SIGNAL HEADS SHALL HAVE TUNNEL VISIONS AND BACKPLATES. COST OF WHICH SHALL BE INCLUDED UNDER THIS PAY ITEM.
- 665-1-11 ALL PEDESTRIAN PUSH BUTTONS SHALL BE ADA COMPLIANT. PBC PREFERS THE BULLDOG III SERIES/BOLJ SERIES PIEZO PUSHBUTTON. COSTS OF PEDESTRIAN SIGN FTP-698-06 SHALL BE INCLUDED IN UNIT PRICE FOR THE PEDESTRIAN DETECTORS.
- 700-5-22 INTERNALLY ILLUMINATED STREET NAME SIGNS SHALL BE DOUBLE SIDED AND FREE SWINGING MOUNTED EXCEPT WHERE NOTED. CONTRACTOR SHALL INSTALL ONE PHOTOCELL PER INTERNALLY ILLUMINATED STREET NAME SIGN. PER THE F.D.O.T. PAY ITEM DETAIL, ALL MOUNTING HARDWARE IS INCLUDED IN THE SIGN PAY ITEM.
- 715-5-XX LUMINAIRE SHALL BE AUTOBAHN SERIES ATB2 LED (P604, R4, 263 WATT, 4000K, MVOLT = 120 VOLTS) AND EACH FIXTURE SHALL BE PROVIDED WITH PHOTOELECTRIC CELL. A SEPARATE CIRCUIT/BREAKER SHALL BE PROVIDED IN SIGNAL DISCONNECT FOR MAST ARMS WITH LUMINAIRES. COST OF WHICH IS INCLUDED UNDER THE PAY ITEM NO.

PATRICIA MARIE BARR, P.E., STATE OF FLORIDA  
PROFESSIONAL ENGINEER, LICENSE NO. 56825

THIS ITEM HAS BEEN ELECTRONICALLY SIGNED AND  
SEALED BY PATRICIA MARIE BARR, P.E. ON 3/6/2022  
USING A SHA-1 AUTHENTICATION CODE.

PRINTED COPIES OF THIS DOCUMENT ARE NOT  
CONSIDERED SIGNED AND SEALED AND THE SHA-1  
AUTHENTICATION CODE MUST BE VERIFIED ON ANY  
ELECTRONIC COPIES.

**SIMMONS & WHITE**  
CORPORATION  
6801 International Drive, Suite 400, Tallahassee, FL 32303-4000  
Phone: 904.202.4000 Fax: 904.202.4001

DESIGN T.B.	DRAWN C.O.	CHECKED A.L.	APPROVED R.R.	DATE
----------------	---------------	-----------------	------------------	------

SILVER BEACH ROAD AT AVENUE S  
P.B.C. PROJECT #2003514  
P.B.C. INTERSECTION #10055  
TABULATION OF QUANTITIES

JOB NO. 21-093	DRAWING NO. 21093T02	SHEET OF T-2 T-8
-------------------	-------------------------	---------------------

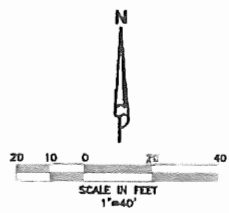
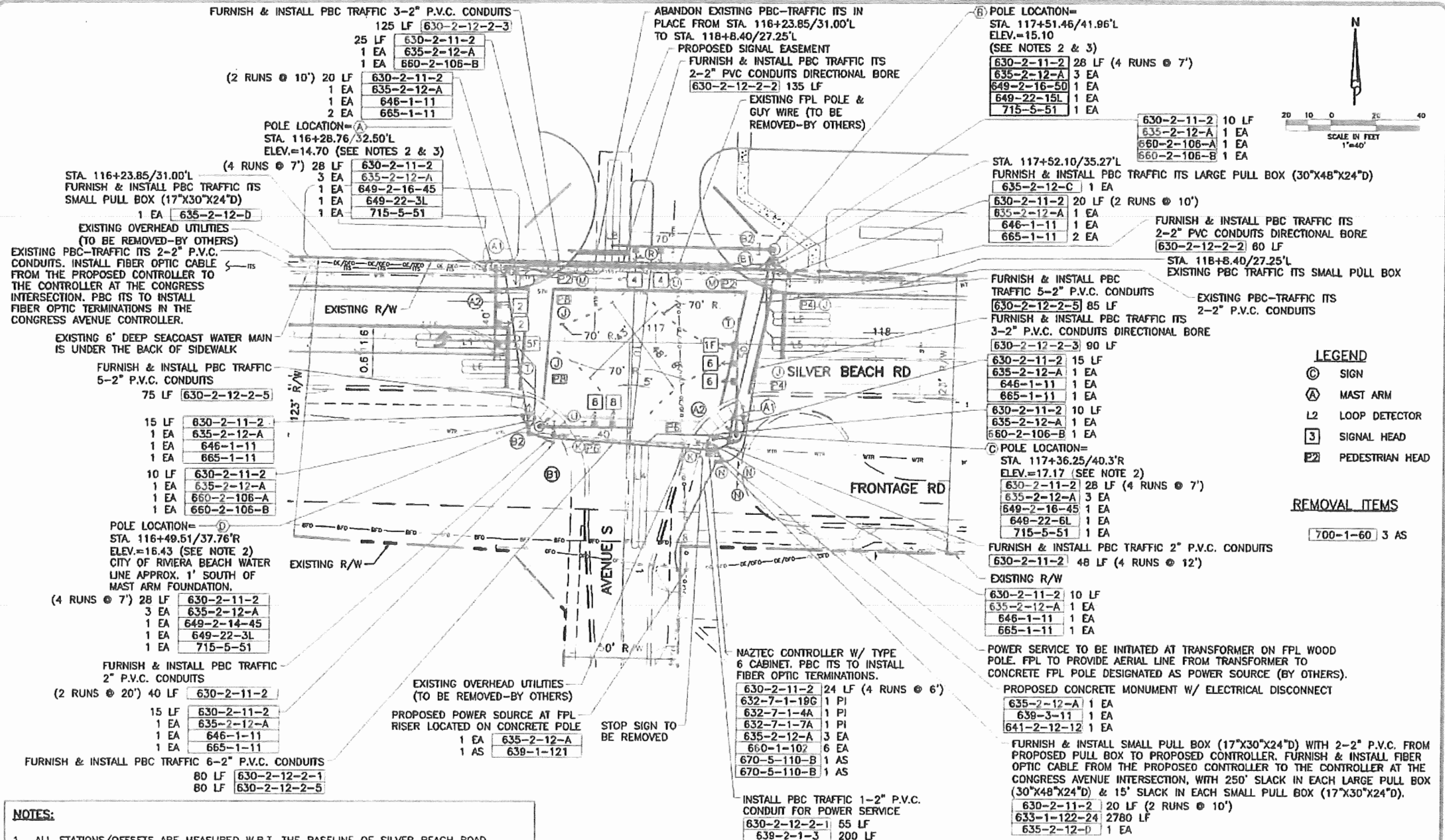

- LEGEND**
- Ⓢ SIGN
  - Ⓐ MAST ARM
  - L2 LOOP DETECTOR
  - Ⓜ SIGNAL HEAD
  - Ⓜ PEDESTRIAN HEAD

- REMOVAL ITEMS**
- 700-1-60 3 AS

- NOTES:**
1. ALL STATIONS/OFFSETS ARE MEASURED W.R.T. THE BASELINE OF SILVER BEACH ROAD.
  2. TOP OF FOUNDATION FOR MAST ARMS A, B, C, & D SHALL BE 2" ABOVE EXISTING GRADE ELEVATION AT CENTER OF PROPOSED FOUNDATION. CONTRACTOR SHALL ADJUST TOP OF FOUNDATION ELEVATION AS NEEDED TO MAINTAIN 2" OFFSET BETWEEN TOP OF FOUNDATION AND EXISTING GRADE.
  3. CONTRACTOR SHALL VERIFY ADJACENT BANK DOES NOT IMPEDE WITH MAST ARM FOUNDATION OR CREATE DRAINAGE ISSUES WITH RESPECT TO FOUNDATION AND MAST ARM.

PATRICIA MARE BARR, P.E., STATE OF FLORIDA  
PROFESSIONAL ENGINEER, LICENSE NO. 56925

THIS ITEM HAS BEEN ELECTRONICALLY SIGNED AND SEALED BY PATRICIA MARE BARR, P.E. ON 3/8/2022 USING A SHA-1 AUTHENTICATION CODE.

PRINTED COPIES OF THIS DOCUMENT ARE NOT CONSIDERED SIGNED AND SEALED AND THE SHA-1 AUTHENTICATION CODE MUST BE VERIFIED ON ANY ELECTRONIC COPIES.

**SIMMONS & WHITE**

REGISTERED PROFESSIONAL ENGINEERS & ARCHITECTS  
1000 N. W. 10th St., Suite 200  
Fort Lauderdale, FL 33304  
Tel: 954-575-1100  
Fax: 954-575-1101

DESIGN: J.R.    DRAWN: C.O.    CHECKED: A.L.    APPROVED: B.R.    DATE: \_\_\_\_\_

**SILVER BEACH ROAD AT AVENUE S**  
P.B.C. PROJECT #2003514  
P.B.C. INTERSECTION #19055  
**SIGNALIZATION PLAN**

JOB NO. 21-093    DRAWING NO. 21093T04    SHEET OF T-4 T-8

SOP 7

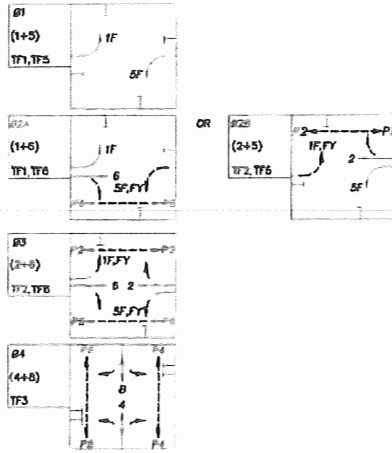

DETAIL OF SIGNAL HEADS  
N.T.S.

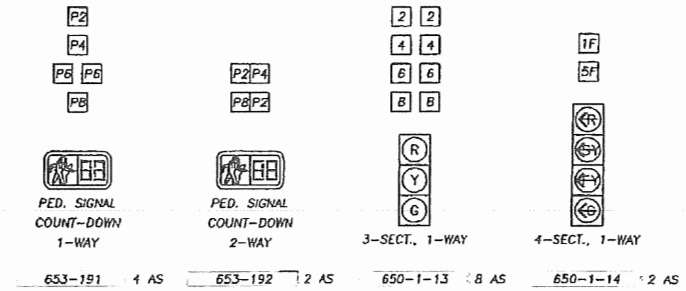

LOOP DETECTOR CONNECTION

DETECTOR UNIT NO.	DETECTOR OPERATION	CONNECTED TO LOOP	CONNECTED TO TIMING FUNCTION
1	DELAY/NORMAL	L1	TF1
2	NORMAL	L2	TF2
3	NORMAL	L4	TF3
4	DELAY/NORMAL	L5	TF5
5	NORMAL	L6	TF6
6	NORMAL	L8	TF3

DETAIL OF STREET NAME SIGNS  
N.T.S.

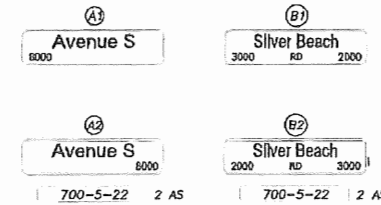

-MAXIMUM SIGN DIMENSION 8' LENGTH MAX. AND 2' HEIGHT  
-SIGNS SHALL MEET PALM BEACH COUNTY TYPICALS & MUTCD. REFER TO PALM BEACH COUNTY TYPICALS FOR DETAILS ON SIGN INSTALLATION, DIMENSION & LETTERING.

DETAIL OF SIGNS  
N.T.S.

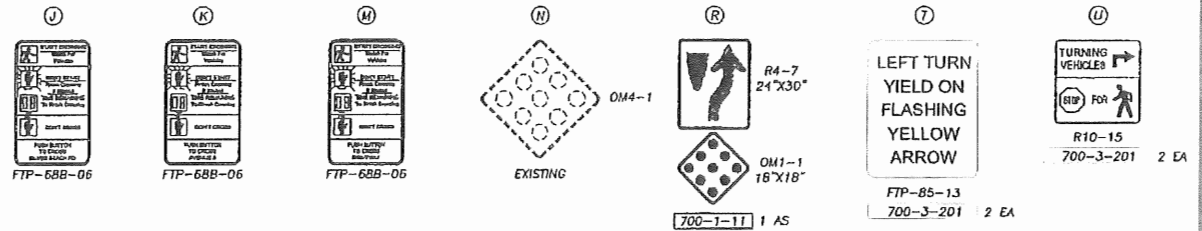

COST OF FTP-688-06 SIGNS SHALL BE INCLUDED UNDER PAY ITEM 665-1-11.

NOTES:

- CONTROLLER OPERATIONS:
  - THE CONTROLLER SHALL OPERATE AS SIGNAL OPERATING PLAN 7.
  - MAJOR STREET IS SILVER BEACH ROAD AND MINOR STREET IS AVENUE S.
  - FLASHING OPERATION TO BE YELLOW FOR MAJOR STREET MOVEMENTS 2 & 6 AND RED FOR ALL OTHER MOVEMENTS.
- ACTUAL SIGNAL TIMINGS AND COORDINATION PLANS ARE TO BE DETERMINED BY THE PALM BEACH COUNTY ENGINEER'S REPRESENTATIVE.
- THE SPEED LIMIT ON SILVER BEACH ROAD IS 30 MPH. THE SPEED LIMIT ON AVENUE S IS 25 MPH.



PATRICIA MARIE BARR, P.E., STATE OF FLORIDA  
PROFESSIONAL ENGINEER, LICENSE NO. 56925  
THIS ITEM HAS BEEN ELECTRONICALLY SIGNED AND  
SEALED BY PATRICIA MARIE BARR, P.E. ON 3/9/2022  
USING A SIM-1 AUTHENTICATION CODE.  
PRINTED COPIES OF THIS DOCUMENT ARE NOT  
CONSIDERED SIGNED AND SEALED AND THE SIM-1  
AUTHENTICATION CODE MUST BE VERIFIED ON ANY  
ELECTRONIC COPIES.

**SIMMONS & WHITE**  
224 S. WASHINGTON ST. PALM BEACH, FL 33480  
TEL: 561-833-1111 FAX: 561-833-1112  
WWW.SWENGINEERS.COM

DESIGN T.E.	DRAWN C.D.	CHECKED A.L.	APPROVED R.H.	DATE
----------------	---------------	-----------------	------------------	------

**SILVER BEACH ROAD AT AVENUE S**  
P.B.C. PROJECT #2003514  
P.B.C. INTERSECTION #18055  
SIGNALIZATION PLAN

JOB NO. 21-093	DRAWING NO. 21093105	SHEET OF T-5 T-8
-------------------	-------------------------	---------------------

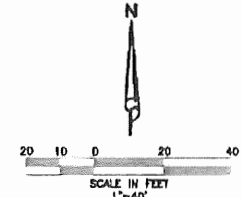
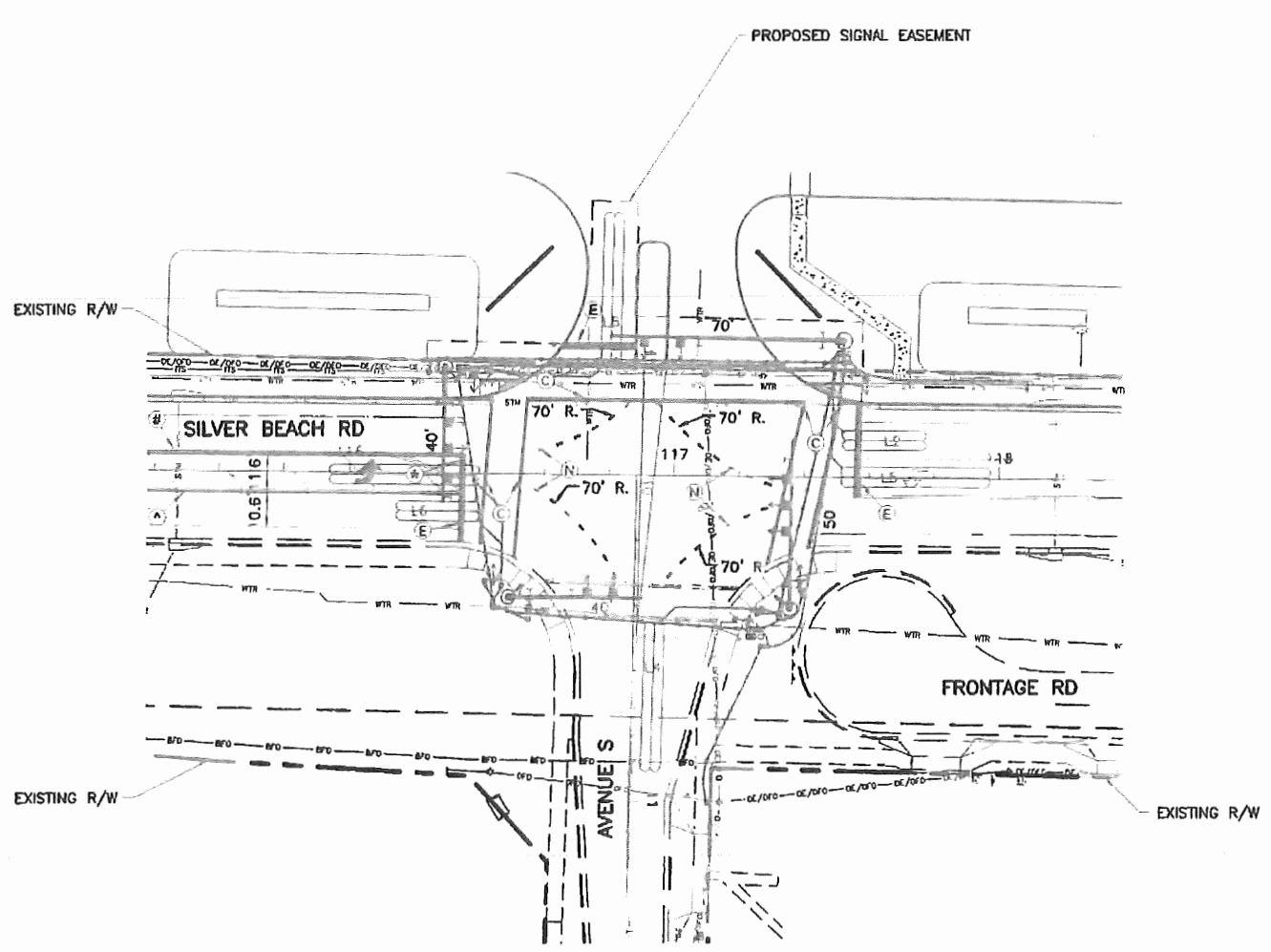

**LEGEND**  
 STRIPING

**STRIPING KEY**

- A - 6" SOLID WHITE
- B - 6" SOLID WHITE
- C - 12" SOLID WHITE
- D - 18" SOLID WHITE
- E - 24" SOLID WHITE
- F - 6" SKIP WHITE TYP. (10'-30')
- G - 6" SKIP WHITE TYP. (6'-10')
- H - 6" SKIP WHITE TYP. (2'-4')
- I - 6" SOLID YELLOW
- J - 18" SOLID YELLOW
- K - 6" DOUBLE YELLOW
- L - 6" SKIP YELLOW TYP. (10'-30')
- M - 6" SKIP YELLOW TYP. (6'-10')
- N - 6" SKIP YELLOW TYP. (2'-4')
- P - R.P.M. BI-DIRECTIONAL AMBER/AMBER
- R - F.D.P. WHITE
- S - F.D.P. YELLOW
- T - R.P.M. BI-DIRECTIONAL WHITE/RED
- U - R.P.M. BI-DIRECTIONAL RED/YELLOW
- \* - 24" SOLID WHITE DONE BY OTHERS. SEE SILVER BEACH INDUSTRIAL PLANS BY LANGAN ENGINEERING AND ENVIRONMENTAL SERVICES, INC.
- # - 6" DOUBLE YELLOW DONE BY OTHERS. SEE SILVER BEACH INDUSTRIAL PLANS BY LANGAN ENGINEERING AND ENVIRONMENTAL SERVICES, INC.
- ^ - 6" SOLID WHITE DONE BY OTHERS. SEE SILVER BEACH INDUSTRIAL PLANS BY LANGAN ENGINEERING AND ENVIRONMENTAL SERVICES, INC.

**NOTES:**  
 1. ALL STATIONS/OFFSETS ARE MEASURED W.R.T THE BASELINE OF SILVER BEACH ROAD.

PATRICIA MARIE BARR, P.E., STATE OF FLORIDA, PROFESSIONAL ENGINEER, LICENSE NO. 56825  
 THIS ITEM HAS BEEN ELECTRONICALLY SIGNED AND SEALED BY PATRICIA MARIE BARR, P.E. ON 3/6/2022 USING A SHA-1 AUTHENTICATION CODE.  
 PRINTED COPIES OF THIS DOCUMENT ARE NOT CONSIDERED SIGNED AND SEALED AND THE SHA-1 AUTHENTICATION CODE MUST BE VERIFIED ON ANY ELECTRONIC COPIES.

**SIMMONS & WHITE**  
 ENGINEERS & PLANNERS  
 2541 International Blvd. Suite 200 West Palm Beach, Florida 33411-4700  
 Telephone: 561-840-1234 Fax: 561-840-1234

DESIGN T.B.	DRAWN C.D.	CHECKED A.L.	APPROVED R.R.	DATE
----------------	---------------	-----------------	------------------	------

**SILVER BEACH ROAD AT AVENUE S**  
 P.B.C. PROJECT #2003514  
 P.B.C. INTERSECTION #19055  
**PAVEMENT MARKING PLAN**

JOB NO. 21-003	DRAWING NO. 2109 ST25A	REVISED BY T-5A T-8
-------------------	---------------------------	------------------------



STANDARD MAST ARM ASSEMBLIES DATA TABLE											TABLE DATE 11-01-16
STRUCTURE ID NUMBERS	DESIGNATION	FIRST ARM		SECOND ARM		UF (deg)	LL (deg)	POLE			DRILLED SHAFT ID
		ARM ID	FAA (ft.)	ARM ID	SAA (ft.)			POLE ID	UAA (ft.)	UB (ft.)	
A	A40/S-P2/S/L-DS/10/4.5	A40/S					45	P2/S/L		22	DS/16/4.5
B	A70/S-P5/S/L-DS/16/5	A70/S					90	P5/S/L		22	DS/16/5
C	A50/S-P3/S/L-DS/16/4.5	A50/S					45	P3/S/L		21	DS/16/4.5
D	A40/S-P2/S/L-DS/14/4.5	A40/S					45	P2/S/L		21	DS/14/4.5

**NOTES** [Notes Date 11-01-16]:

1. If an entry appears in column FAA, a shorter arm is required. This is obtained by removing length from the arm tip and the arm length shortened from FA to FAA. SAA Similar.
2. If an entry appears in column UAA, a shorter pole is required. This is obtained by removing length from the pole tip and the pole height shortened from UA to UAA.
3. Work this sheet with the Signal Designer's "Mast Arm Tabulation". See "Mast Arm Tabulation" for special instructions that include non-standard Handhole location, paint color, terminal compartment requirement, and pedestrian features.
4. Work with Indexes 649-030 and 649-031.

**GEOTECHNICAL NOTES:**

1. The contractor is advised that caving soils will be encountered during excavation of drilled shafts.
2. Drilling mud will be required to stabilized drilled shaft excavations.

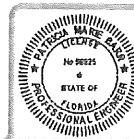

PATRICIA MARIE BARR, P.E., STATE OF FLORIDA,  
PROFESSIONAL ENGINEER, LICENSE NO. 56925

THIS ITEM HAS BEEN ELECTRONICALLY SIGNED AND  
SEALED BY PATRICIA MARIE BARR, P.E. ON 3/8/2022  
USING A SHA-1 AUTHENTICATION CODE.

PRINTED COPIES OF THIS DOCUMENT ARE NOT  
CONSIDERED SIGNED AND SEALED AND THE SHA-1  
AUTHENTICATION CODE MUST BE VERIFIED ON ANY  
ELECTRONIC COPIES.



DESIGN: T.B.    DRAWN: C.O.    CHECKED: A.L.    APPROVED: R.R.    DATE:

SILVER BEACH ROAD AT AVENUE S  
P.B.C. PROJECT #2003514  
P.B.C. INTERSECTION #18055  
MAST ARM ASSEMBLIES

JOB NO. 21-093    DRAWING NO. 21093T01    SHEET OF T-7 T-8





**INCREASE PENALTY RIDER**

No. 2

---

**BOND NO. 0225937**

To be attached and form a part of Bond No. 0225937 dated the 10th day of September, 2019, executed by Berkley Insurance Company as surety, on behalf of Gerelco Traffic Controls, Inc. as current principal of record, and in favor of the Palm Beach County Board of County Commissioners, as Obligee(s), and in the amount of Five Hundred Thousand and 00/100 Dollars (\$500,000.00).

In consideration of the agreed premium charged for this bond, it is understood and agreed that Berkley Insurance Company hereby consents that said bond shall be amended as follows:

**THE BOND PENALTY SHALL BE Increased:**

**BY: Five Hundred Thousand and 00/100 Dollars (\$500,000.00)**

**FROM: One Million and 00/100 Dollars (\$1,000,000.00)**

**TO: One Million Five Hundred Thousand and 00/100 Dollars (\$1,500,000.00)**

The Increase of said bond penalty shall be effective as of the 2nd day of June, 2021, and does hereby agree that the continuity of protection under said bond subject to changes in penalty shall not be impaired hereby, provided that the aggregate liability of the above mentioned bond shall not exceed the amount of liability assumed by it at the time the act and/or acts of default were committed and in no event shall such liability be cumulative.

Signed, sealed and dated this 2nd day of June, 2021.

Gerelco Traffic Controls, Inc.  
PRINCIPAL

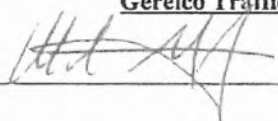
BY: \_\_\_\_\_ 

Berkley Insurance Company  
SURETY

BY: \_\_\_\_\_ 

Brett Rosenhaus, Attorney-in-Fact  
& Florida Licensed Agent

---





Office of  
Equal Business Opportunity  
50 South Military Trail, Suite 202  
West Palm Beach, FL 33415  
(561) 616-6840  
www.pbcgov.com/eobo



Palm Beach County  
Board of County  
Commissioners  
Mack Bernard, Mayor  
Dave Kerner, Vice Mayor  
Hal R. Valente  
Gregg K. Weiss  
Robert S. Weinroth  
Mary Lou Berger  
Melissa McUnlley

County Administrator  
Verdenia C. Baker

"An Equal Opportunity  
Affirmative Action Employer"



INTER-OFFICE MEMORANDUM

Date: Tuesday, February 5, 2019  
To: David Ricks, County Engineer  
Engineering and Public Works  
From: Tonya Davis Johnson, Director *T. Johnson*  
Office of Equal Business Opportunity  
Re: Request for Waiver of API Requirements Project #2019050  
Annual Traffic Signal Construction Contract Renewal

Your Request for Waiver of API Requirements for the above named project was received on January 31, 2019 and has been reviewed. It is the determination of the Office of Equal Business Opportunity (OEBO) that the request for Waiver of API Requirements be denied.

Our determination was made based upon our review of the OEBO database and the limited availability of sufficient and qualified S/M/WBEs providing the goods or services required by the contract.

I will recommend to the Goal Setting Committee the Waiver of API requirements for this renewal at the February 6, 2019 meeting.

If you have any questions, please contact Allen Gray at 561-616-6842 or email at [agray@pcgov.org](mailto:agray@pcgov.org).

Thank you.  
cc: Allen Gray, Manager

Attachment

2022- \_\_\_\_\_

**BOARD OF COUNTY COMMISSIONERS  
PALM BEACH COUNTY  
BUDGET Amendment**

FUND Road Impact Fee Zone 1

BGRV 041422/449  
BGEX 041422/1154

ACCOUNT NUMBER	ACCOUNT NAME	ORIGINAL BUDGET	CURRENT BUDGET	INCREASE	DECREASE	ADJUSTED BUDGET	EXPENDED/ ENCUMBERED AS OF 04/14/2022	REMAINING BALANCE
<b>REVENUES</b>								
<u>Silver Beach Road/ E of Congress-Old Dixie Hwy</u>								
3501-361-0994-6693	Developer Contributions	0	0	116,734	0	116,734		
<b>TOTAL RECEIPTS &amp; BALANCES</b>		50,464,637	49,334,213	116,734	0	49,450,947		
<b>EXPENDITURES</b>								
<u>Silver Beach Road/ E of Congress-Old Dixie Hwy</u>								
3501-361-0994-6408	Signals & Controllers	0	0	116,734	0	116,734	5,760	110,974
<b>TOTAL APPROPRIATIONS &amp; EXPENDITURES</b>		50,464,637	49,334,213	116,734	0	49,450,947		

**SIGNATURE**

**DATE**

By Board of County Commissioners  
At Meeting of 06/14/2022

Engineering & Public Works

*Danny Ramlal Singh*

4/22/22

Administration / Budget Approval

\_\_\_\_\_

\_\_\_\_\_

OFMB Department – Posted

\_\_\_\_\_

\_\_\_\_\_

Deputy Clerk to the  
Board of County Commissioners