

**PALM BEACH COUNTY
BOARD OF COUNTY COMMISSIONERS
AGENDA ITEM SUMMARY**

Meeting Date:	December 6, 2022	<input checked="" type="checkbox"/> Consent	<input type="checkbox"/> Regular
		<input type="checkbox"/> Workshop	<input type="checkbox"/> Public Hearing

Department:	Engineering & Public Works Department
Submitted By:	Engineering & Public Works Department
Submitted For:	Roadway Production Division

I. EXECUTIVE BRIEF

Motion and Title: Staff recommends motion to approve: Supplement No. 2 (Supplement) to the Work Task Order (WTO) dated March 13, 2018 (R2018-0206) under the Structural Annual Services Contract dated February 7, 2017 (R2017-0138) (Contract) with WGI, Inc. (WGI) in the amount of \$125,876.55 for the professional services for Smith Sundry Road over the Lake Worth Drainage District (LWDD) L-33 Canal (Project).

SUMMARY: The bridge on Smith Sundry Road over the LWDD L-33 Canal, at approximately 0.5 miles north of Atlantic Avenue, needs to be replaced. It was determined that the existing bridge would be replaced in-kind to limit the construction impacts to the surrounding agricultural operations. WTO (R2018-0206) was issued on March 13, 2018, to prepare the structural plans to replace the existing bridge with a two-lane bridge, including shoulders on both sides. Several alternatives for construction were prepared by WGI in order to provide the most convenient access during construction. The Engineering and Public Works Department (EPW) evaluated all access options and selected the current design in July 2019. Between July 2019 and April 2021, several delays were addressed, including creation of a revised typical section, unanticipated utility impacts, preparation of Supplement No. 1 and its notice to proceed, review of the 35% plans submittal and their return with comments. In April 2021, EPW reviewed the 65% complete design plans and it became apparent that more detailed construction phasing plans would be required. In the meantime, the Board of County Commissioners approved a maintenance map in June 2021 for additional right-of-way (ROW) along the Smith Sundry corridor that was acquired by EPW.

Approval of this Supplement will provide the professional services necessary to revise the construction plans to add more detailed construction phasing plans to the Project's scope, and to include the additional ROW identified on the maintenance map.

The solicitation for design professionals was advertised on August 7, 2016 and August 14, 2016, prior to the effective date of the Equal Business Opportunity Ordinance and pursuant to the Small Business Enterprise (SBE) Ordinance at the time with final selection taking place on October 19, 2016. The SBE goal for all contracts was 15%. WGI agreed to 15% SBE participation for the Contract. They agreed to 20.73% SBE participation for this Supplement. Their cumulative SBE participation to date for the WTO including this Supplement is 57.92%. WGI has an office located in Palm Beach County. **This Project is included in the Five-Year Road Program and the infrastructure sales tax. District 5 (YBH)**

Background and Justification:

(Continued on Page 3)

Attachments:

1. Location Map
2. Supplement No. 2 with Exhibits A, B, C, D & Ebix Insurance Compliance (2)

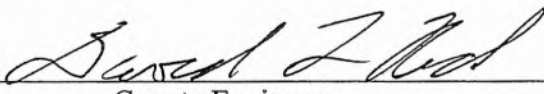
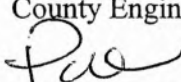
Recommended by:		11/21/22
	County Engineer	Date
Approved By:		11/28/22
	Assistant County Administrator	Date

II. FISCAL IMPACT ANALYSIS

A. Five Year Summary of Fiscal Impact:

Fiscal Years	2023	2024	2025	2026	2027
Capital Expenditures	163,641	-0-	-0-	-0-	-0-
Operating Costs	-0-	-0-	-0-	-0-	-0-
External Revenues	-0-	-0-	-0-	-0-	-0-
Program Income (County)	-0-	-0-	-0-	-0-	-0-
In-Kind Match (County)	-0-	-0-	-0-	-0-	-0-
NET FISCAL IMPACT	163,641	-0-	-0-	-0-	-0-
# ADDITIONAL FTE					
POSITIONS (Cumulative)	-0-	-0-	-0-	-0-	-0-

Is Item Included in Current Budget?

Yes No

Does this item include the use of federal funds?

Yes No

Budget Account No:

Fund 3950 Dept 361 Unit 1521 Object 6505-AE10

Recommended Sources of Funds/Summary of Fiscal Impact:

Local Government One-Cent Infrastructure Surtax
Smith Sundry Rd. over LWDD Lat.33 Canal

Supplement # 2

Basic Services	\$ 111,504.00
Reimbursable	\$ 26,104.47
Total Supplement No.2	\$ 125,876.55
Staff Costs -	
Roadway Production	\$ 25,176.00
Traffic	\$ 12,588.00
Fiscal Impact	\$ 163,640.55

Note: Surtax Funding FY 2019 \$450,000 Smith Sundry Rd. over LWDD Lat.33 Canal

C. Departmental Fiscal Review:

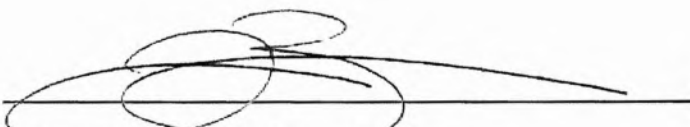

III. REVIEW COMMENTS

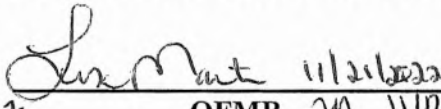
A. OFMB Fiscal and/or Contract Dev. and Control Comments:

(Previous) (del. 3/21/22) #21/22

OFMB JA 11/21

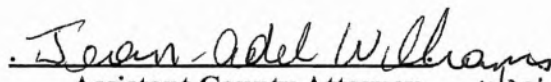
Contract Dev. and Control 11/22/22

B. Approved as to Form and Legal Sufficiency:

Assistant County Attorney 11/28/22

C. Other Department Review:

Department Director

This summary is not to be used as a basis for payment.

Background and Justification: (Continued from Page 1)

On March 13, 2018, the Board of County Commissioners (BCC) approved the WTO with WGI to provide the professional services required for the Project. The fee, as detailed in **Exhibit B** of the attached Supplement, has been negotiated as just and reasonable compensation as follows:

Basic Services (Lump Sum)	\$ 99,772.08	(Roadway Analysis and Plans, Utilities and Coordination Signing and Pavement Marking)
Reimbursable Services (Not to Exceed)	\$ 26,104.47	(Permit Fees, Prints) Design)
Total:	\$ 125,876.55	

After reviewing the attached Supplement and finding it in proper order, the Engineering Department recommends BCC approval.

PROJECT LOCATION

SMITH SUNDY ROAD OVER LWDD L-33 CANAL

Palm Beach County Project #2017514

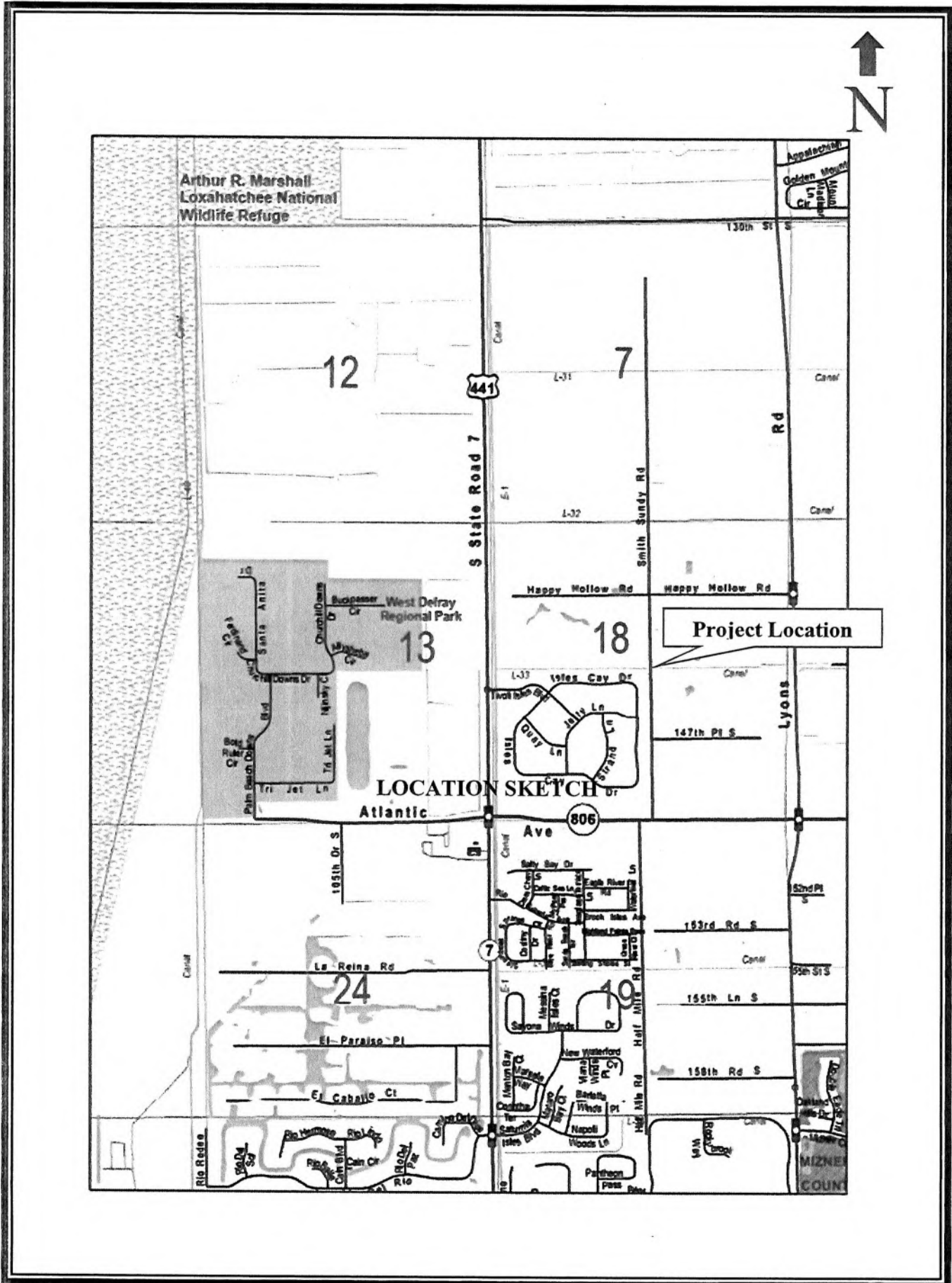

LOCATION SKETCH

**SUPPLEMENT NO. 2 TO THE WORK TASK ORDER
UNDER THE STRUCTURAL ANNUAL SERVICES CONTRACT**

Project Name: **Smith Sundry Road over LWDD L-33 Canal**

Project No: **2017514**

Commission District No.: **5**

SBE Participation for this authorization is **20.73%**

SBE Participation to date for this Contract is **57.92%**

SBE Commitment is **15%**

This authorization is under the SBE Ordinance.

PALM BEACH COUNTY

BOARD OF COUNTY COMMISSIONERS

Account No.: 3950-361-1521-6505-AE10

Supplement No. 2 to a Work Task Order dated March 13, 2018, (R2018-0206) (WTO) to the Structural Annual Contract dated February 7, 2017 (R2017-0138), as amended on December 19, 2017 (R2017-1879), June 5, 2018 (R2018-0819), and December 18, 2018 (R2018-1976) (CONTRACT), between the COUNTY and the CONSULTANT identified herein is for the Additional Services described in **EXHIBIT A** and **EXHIBIT B** for this Supplement.

1. CONSULTANT: WGI, Inc.

2. Address: 2035 Vista Parkway, Suite 100, West Palm Beach, Florida 33411

3. CONSULTANT shall begin work promptly on the requested Additional Services, per the schedule attached as part of **EXHIBIT A**.

4. Scope of Services to be provided by CONSULTANT: Provide professional engineering services to Palm Beach County for the Smith Sundry Road over LWDD L-33 Canal project. Design roadway improvements in accordance with the attached **EXHIBIT A** dated June 8, 2022.

5. The compensation to be paid CONSULTANT for providing the requested services as detailed in **EXHIBIT B** shall be:

<input checked="" type="checkbox"/> Basic Services in a lump sum fee of	\$ 99,772.08
<input checked="" type="checkbox"/> Reimbursable Expenses capped at	\$ 26,104.47
<input checked="" type="checkbox"/> Optional Services capped at	\$ 0.00
Totaling	\$125,876.55

OEBO Schedules 1 & 2 **EXHIBIT C**

WTO History **EXHIBIT D**

6. All terms of the CONTRACT, as amended shall apply to this Supplement.

SUPPLEMENT NO. 2 TO THE WORK TASK ORDER
UNDER THE STRUCTURAL ANNUAL SERVICES CONTRACT

IN WITNESS WHEREOF, this Supplement is accepted as of the date signed by the COUNTY below, subject to the terms and conditions of the aforementioned CONTRACT, as amended.

CONSULTANT: **WGI, Inc.**

Approved as to Terms and Conditions

Federal ID: 65-0271367

Signed: *Kate Fontaine*

Typed Name: Kate Fontaine

Title: Vice President, Administration

Date: 10/3/2022

By: *Morton L. Rose*

Typed Name: Morton L. Rose, P.E.

Title: Division Director



ATTEST WITNESS:

Signed: *Kim E. Droggos*

Typed Name: KIME. DROGGOS

Title: Administrative Assistant

Date: 10/3/2022

SUPPLEMENT NO. 2 TO THE WORK TASK ORDER
UNDER THE STRUCTURAL ANNUAL SERVICES CONTRACT

{SIGNATURE PAGES CONTINUED}

COUNTY: **Palm Beach County**, a Political
Subdivision of the State of Florida, by and
through its Board of County Commissioners

Signed: _____

Typed Name: _____

Title: Mayor

Date: _____

ATTEST:

Joseph Abruzzo
Clerk of the Circuit Court & Comptroller

By: _____

Deputy Clerk

Approved as to Form and Legal Sufficiency

By: _____

ybh/tel
Typed Name: Yelizaveta B. Herman

Title: Assistant County Attorney

F:\ROADWAY\CCNA\ANNUALS\STRUCTURAL\M\G\2017\2017514\Supp2\2017514 Supplement 2.docx



OK Sandra Melon Ospina
8/17/2022

CCMA changes OK
for full DR
8/17/22

December 9, 2021
December 23, 2021
March 10, 2022
April 1, 2022
May 17, 2022
May 24, 2022
June 8, 2022 (Revised)

Palm Beach County Engineering & Public Works
2300 N. Jog Road
West Palm Beach, Florida 33411

Attention: Sandra Ospina, PE, Project Manager

**RE: Smith Sundry Road over LWDD L-33 Canal
Bridge No. PB934411
PBC # 2017514
Additional services proposal #2**

WGI Project: 3183.00

Dear Sandra Ospina,

WGI, Inc. (WGI) is pleased to provide this proposal to the Palm Beach County Engineering Department (CLIENT) for professional services on the design of bridge crossing at the Smith Sundry Road over the LWDD L-33 canal. Our scope of services and corresponding fees are detailed below. WGI will provide the following design services.

SCOPE OF SERVICES

I. DESCRIPTION

The Smith Sundry project is being updated to allow Palm Beach County to update their maintenance map which scope and fee are located on the attached by Mock Roos and Brown and Philips. As the project Prime WGI will be responsible to being PBC's single point of contact and coordinating PBC's requirements to the subconsultants.

Scope of Work – Basic Services

1. Revised roadway Design (see attached scope and fee breakdown from Mock Roos)
2. Updated Survey (see attached scope and fee breakdown from Brown and Philips)
3. Revised Structure (Bridge) and project coordination and plans sheets update.

II. Scope of Basic Services

1. Revised Roadway Design:
 - A. See Mock, Roos and Associates, Inc. (Mock Roos) Scope Attached.

2. Revised survey and TCE's
 - A. See Brown and Philips Scope Attached

3. Revised Structure (Bridge) Design
 - A. Coordinate with the roadway engineer on the PBC requirements.
 - B. Coordinate with the surveyor on the PBC requirements.

The attached description and associated fees.

If you have any questions, please give me a call.

Respectfully submitted,

WGI, INC.

Respectfully,

WGI, INC.



Jeffrey R. Bergmann, PE
Director, Specialty Structures



Chris LaForte, PE
Senior Project Manager

P:\3100\3183.00 Smith Sundry Road Bridge over L-33\Administration\Proposals\Supplement #2\2022.06.08 Supplement #2.docx

Master Summary - Estimate of Work Effort & Fee Proposal

PBC Project No.: 2017514
 WGI Project No.: 3183.00
 Job Description: Smith Sundry Road over LWDD L-33 Canal
 Supplement #2

Consultant: WGI, Inc.

From: L-33 Canal Crossing
 To: N/A

Length: 2657' from 147th Place S. north to Happy Hollow Road

Work Element / Activity	Project Manager		Senior Project Engineer		Project Engineer		Engineer		Engineer Intern		CADD / Computer Technician		Total Man Hours	Salary Cost By Activity
	Staff Hours	Hourly Rate	Man Hours	Hourly Rate	Staff Hours	Hourly Rate	Staff Hours	Hourly Rate	Staff Hours	Hourly Rate	Staff Hours	Hourly Rate		
STRUCTURES COORDINATION WITH SUBCONSULTANTS	70	\$56.00		\$67.36		\$44.04		\$35.00		\$35.00		\$33.33	70	\$3,920.00
Design Phase Totals	70	\$3,920.00	0	\$0.00	0	\$0.00	0	\$0.00	0	\$0.00	0	\$0.00	70	\$3,920.00 ✓
Total 'Basic Services' Burdened Salary Costs By Activity														
STRUCTURE COORDINATION WITH SUBS		\$3,920.00												
Multiplier		3.00												
Total		\$11,760.00												
Subconsultant Basic Services Fees														
ROADWAY DESIGN (Mock, Roos & Associates, Inc.) Item #1		\$59,599.62												
ROADWAY DESIGN (Mock, Roos & Associates, Inc.) Item #2		\$28,412.46												
Total		\$99,772.08												
Reimbursable Services														
SURVEY (BROWN & PHILLIPS, INC.)		\$26,104.47												
Subtotal		\$26,104.47												
Optional Services (Reimbursables)														
Subtotal		\$0.00												
Total		\$26,104.47												
Permit Fees														
Total		\$0.00												
BASIC SERVICES LUMP SUM FEE (WGI, Inc.) \$11,760.00														
BASIC SERVICES LUMP SUM FEE (Mock, Roos & Associates, Inc.) \$88,012.08														
TOTAL LUMP SUM FEE \$99,772.08 ✓														
REIMBURSABLE EXPENSES														
Brown & Phillips, Inc. (Survey) \$26,104.47														
TOTAL REIMBURSABLE EXPENSES \$26,104.47 ✓														
OPTIONAL SERVICES (INCL. REIMBURSABLES) \$0.00														
TOTAL MAXIMUM LIMITING FEE \$125,876.55 ✓														

6/10/2022 , Printed Date



Smith Sundry Road over LWDD L-33 Canal

PBC Project No. 2017514

\$ 67.36 \$ 56.00 \$ 35.00 \$ 33.33 ✓

TASK DESCRIPTION / DESIGN	Senior Project Engineer	Project Manager	Engineer Intern	CADD/Computer Technician	Total Hours	TOTAL
Coordination with Subconsultants		70			70	\$3,920.00
TOTAL HOURS	0	70	0	0	70	
TOTAL FEE	\$0.00	\$3,920.00	\$0.00	\$0.00		\$3,920.00

Raw salary related costs \$3,920.00
 Multiplier: 3.00
 Total \$11,760.00 ✓



December 17, 2021
 Revised March 29, 2022
 Revised April 26, 2022
 Revised May 25, 2022
 Revised June 7, 2022

WGI, Inc.
 2035 Vista Parkway, Suite 100
 West Palm Beach, FL 33411

Ref. No. B6051.04
 Project: Smith Sundry Road over LWDD L-33 Canal
 Palm Beach County Project No. 2017514
 Additional Services Proposal #2

As you are aware, Mock•Roos, as WGI's subconsultant, is currently completing design services for the roadway improvements to Smith Sundry Road at the north and south approaches to the new bridge being designed over the LWDD L-33 Canal. Below is a description of the additional services requested as part of Supplement #2.

Item 1 – Additional Services related to Supplement #1

Palm Beach County previously requested changes to the original plans in order to maintain traffic flow during construction, avoiding a separate detour route alternative. The new bridge is now to be constructed in phases, maintaining traffic flow over the L-33 Canal at all times. As such, multiple modifications to our Scope of Services had been established and approved within Supplement #1 of this project. The resulting additional work has been performed by Mock Roos, reviewed, and approved by County staff. Following review by County staff, it has been discussed that the complexity of the plan revisions necessary to properly represent the complete construction document in accordance with County Standards were much greater in magnitude than had been previously estimated within Supplement #1. Therefore, we are requesting an additional Supplemental Scope of Services and corresponding fee adjustment to account for the underestimated labor required to perform the requested tasks and produce the quantities of additional plan sheets.

The additional Supplemental Scope of Services included work completed in Tasks 2-4 of Supplement #1, specifically:

Task 2. Re-establishment of the Horizontal Geometry – The newly established proposed roadway approach geometry aligned with the new bridge centerline location required the development of two (2) separate additional alignments, terminating with connections to existing pavements to facilitate temporary roadways during construction. Resulting separate geometrics included new pavement edge lines and paved/unpaved shoulder lines, each with individual geometrics. The revised geometry caused the project limits to be extended about 500 feet north and south (1,000 feet total – 600 feet further than anticipated). This resulted in additional plan / profile sheets, further revisions to the drainage map, and additional cross section sheets.

Mock, Roos & Associates, Inc.

5720 Corporate Way, West Palm Beach, Florida 33407-2066, 561-683-3113, www.MockRoos.com

December 17, 2021 Revised March 29, 2022 Revised April 26, 2022 Revised May 25, 2022
 Revised June 7, 2022
 Page 2

Task 3. Prepare Plans for a Temporary Road – The redesign required a complex temporary two-lane approach roadway, with significant geometric implications to both horizontal and vertical alignments for both NB and SB traffic during various phases of the project’s overall construction schedule. These plans included:

- Multiple Typical Sections showing temporary lane and shoulder widths, with extraordinary pavement construction details and pertinent notes due to the introduction of temporary barrier walls and significant elevation differences during various phases of the project construction
- Plan and Profile Sheets increased due to the need of depicting construction activities in three separate temporary construction phases
- Cross Sections showing excavation and fill requirements increased due to the need to show the changing conditions between each of the phases

During this design it has been determined that portions of the temporary road construction are required to be incorporated into the final roadway conditions. To establish this condition, additional final construction details have to be included in construction call-outs, details and notes. This requires the contractor to retain portions of the temporary work to meet the final construction conditions (expected reduction of construction costs). Once again, creating the construction documents to facilitate increased the complexity of this project design.

Additional efforts are also required to prepare final quantities due to the project complexity.

The original estimated additional 40 sheets have increased by 40 construction plan sheets (total of estimated 80 sheets). Therefore, the corresponding additional labor estimated in the original Supplement #1 has been insufficient due the project’s increased complexity.

Task 4. Prepare Revised Construction Plans – The completed portions of final construction elements during the temporary construction phases will affect the work to be defined in the final contract set of plans. This should not affect the final number of sheets in the final plan set. However, the labor required to confirm that all elements have been included in the plan set will need to be carefully reviewed. Additional hours will be required to ensure this task is completed meeting the Standards of Palm Beach County for construction.

Item 2 – Additional Services related to Right-of-Way Maintenance Map Plan revisions

Palm Beach County recently approved a Right-of-Way Maintenance Map Plan (“Plan”) which encompasses this area and requested that Mock•Roos review and evaluate potential impacts of the approved Plan. As such, we have determined that the approved Plan requires changes to the current plans. It is understood that the additional work required to 1) remove the current right-of-way lines which were based on the originally right-of-way package; and 2) incorporate the new right-of-way lines based on the approved Plan will be performed by Brown & Phillips, Inc., as a subconsultant to WGI. These changes in right-of-way linework will however result in required fairly significant changes to our design/construction drawing annotations, including but not limited to, the following required updates/changes:

- *Plan Views*
 - Remove current bearing and station/offset annotations that are based on the existing east right-of-way line per project original survey
 - Add new bearing and station/offset annotations to the approved existing east Plan

December 17, 2021 Revised March 29, 2022 Revised April 26, 2022 Revised May 25, 2022
 Revised June 7, 2022
 Page 3

- Analyze and revise proposed right-of-way takings
 - Revise bearing annotations
 - Revise station/offset annotations
- Analyze and revise proposed Temporary Construction Easements
 - Revise station/offset annotations
- *Section and Driveway Connection Views*
 - Remove offset/elevation annotation for existing east right-of-way line per project survey based on original right-of-way package provided by the County
 - Add offset/elevation annotation for existing east right-of-way line per the approved Plan as provided by the County
 - Revise offset/elevation annotation for proposed right-of-way takings
 - Revise offset/elevation annotation for proposed Temporary Construction Easements

Therefore, based on the above, we are requesting a Supplemental Scope of Services for Mock•Roos to provide the additional Engineering Services for a lump sum fee of ~~\$88,012.08~~ (Item #1 = \$59,599.62 and Item #2 = \$28,412.46). Other applicable provisions and remaining tasks within the basic scope of work to be performed under our agreement with WGI, Inc. shall apply. The work to be performed for this supplemental agreement shall be in accordance with the terms and provisions of the agreement with WGI, Inc. dated July 19, 2018. Any additional services requested by WGI or Palm Beach County beyond this scope of work shall be performed under a separate agreement.

If you have any questions, please contact me at 683-3113, extension 293. Thank you for considering Mock•Roos for this project. We look forward to working with you.

Sincerely,

MOCK, ROOS & ASSOCIATES, INC.



Garry G. Gruber, P.E.
 Senior Vice President

GGG:tsm
 Enclosure
 Copies: Bookkeeping

MOCK, ROOS & ASSOCIATES, INC.
SMITH SUNDY ROAD OVER LWDD L-33 CANAL
Additional Services Proposal #2
ENGINEERING DESIGN & RELATED SERVICES
Palm Beach County Engineering & Public Works Department
Estimate of Staff Requirements & Professional Services Fee

B6051.04

PBC - 2017514

TASK DESCRIPTION	Senior Project Engineer	Project Manager	Project Engineer	Cadd/Computer Technician	Total Hours	Amount
Item #1						
Task 3.6 - Roadway Consultant Project Manager Meetings (ACTIVITY 3)	4				4	\$ 251.00
Task 4.4, 4.10, 4.11 and 4.14 - Roadway Analysis (ACTIVITY 4)	26	48			74	\$ 4,281.58
Task 5.2, 5.5 - 5.7, 5.13, 5.30a, 5.30b, 5.42 - Roadway Plans (ACTIVITY 5)	33	47	55	48	183	\$ 8,361.49
Task 6.4, 6.9 - Drainage Analysis (ACTIVITY 6)	16	20	36	11	83	\$ 4,011.96
Task 7.2, 7.7, 7.9, 7.15 - Utilities (ACTIVITY 7)	8	9	12	19	48	\$ 2,020.49
Task 20.6 - Plan Sheet: Signing and Pavement Marking Plans (ACTIVITY 20)	2	2	10	10	24	\$ 940.02
				TOTAL	416	\$ 19,866.54
Item #2						
Task 5.13A - Plan/Profile Sheet Basemap Review (ACTIVITY 5)		2	6		8	\$ 381.44
Task 5.13C - Plan/Profile Basemap: 16 sheets x 1/hr section (ACTIVITY 5)		2	14		16	\$ 742.80
Task 5.13D - Plan/Profile Sheet: 24 sheet x 2/hr sheet (ACTIVITY 5)		4	44		48	\$ 2,208.32
Task 5.5 - Typical Section Sheets: 4 sheets x 1/hr sheet (ACTIVITY 5)		2	2		4	\$ 200.76
Task 5.30A - Cross Section: 57 Cross-sections x 2/hr section (ACTIVITY 5)	4	30	80		114	\$ 5,520.90
Task 5.30B - Driveways: 4 profiles x 1.0/hr profile (ACTIVITY 5)			4		4	\$ 180.68
Task 5.13B - Plan/Profile Sheet Basemap Coordination (ACTIVITY 5)	2	2			4	\$ 235.92
				TOTAL	198	\$ 9,470.82
Staff Hours	95	168	263	88	614	
Total Staff Costs	\$ 5,961.25	\$ 9,275.28	\$ 11,879.71	\$ 2,221.12		\$ 29,337.36
Raw Labor Rates	\$ 62.75	\$ 55.21	\$ 45.17	\$ 25.24		
ADDITIONAL BASIC SERVICES:					SALARY RELATED COSTS MULTIPLIER	\$ 29,337.36 3.00
					TOTAL ADDITIONAL BASIC SERVICES FEE	\$ 88,012.08
REIMBURSABLES:	Mock-Roos Out-of-Pocket Expenses (reproduction, etc.)				TOTAL ESTIMATED REIMBURSABLES	\$0.00 \$0.00
					TOTAL ADDITIONAL PROFESSIONAL SERVICES FEE	\$ 88,012.08

ESTIMATE OF WORK EFFORT AND COST - ROADWAY DESIGN CONSULTANT - ITEM #1

Name of Project: **Smith Sundry Road Over LWDD L-33 Canal**
 County: **Palm Beach**
 FPN: **2017514**
 FAP No.: **NA**

Consultant Name: **Mock, Roos & Associates, Inc.**
 Consultant No.: **B6051.04**
 Date: **6/7/2022**
 Estimator: **GGG**

Staff Classification	Total Staff Hours From "SH Summary - Firm"	Senior Project Engineer	Project Manager	Project Engineer	CADD/Computer Technician	SH By Activity	Salary Cost By Activity	Average Rate Per Task
		\$62.75	\$55.21	\$45.17	\$25.24			
Project Activity Task 3 - Project General and Project Common Tasks	4	4	0	0	0	4	\$251.00	\$62.75
Project Activity Task 4 - Roadway Analysis	74	26	48	0	0	74	\$4,281.58	\$57.86
Project Activity Task 5 - Roadway Plans	183	33	47	55	48	183	\$8,361.49	\$45.69
Project Activity Task 6 - Drainage Analysis	83	16	20	36	11	83	\$4,011.96	\$48.34
Project Activity Task 7 - Utilities	48	8	9	12	19	48	\$2,020.49	\$42.09
Project Activity Task 20 - Signing and Pavement Marking Plans	24	2	2	10	10	24	\$940.02	\$39.17
Total Staff Hours	416	89	126	113	88	416		
Total Staff Cost		\$5,584.75	\$6,956.46	\$5,104.21	\$2,221.12		19,866.54	\$47.76

ADDITIONAL BASIC SERVICES

SALARY RELATED COSTS:		\$	19,866.54
MULTIPLIER	3.00	\$	59,599.62
TOTAL MOCK ROOS TOTAL BASIC SERVICES FEE:		\$	59,599.62 ✓

Project Activity Task 3: Project General and Project Common Tasks - Item #1

Estimator:
Updated 080818

Smith Sundry Road Over LWDD L-33 Canal
2017514

Task No.	Task	Units	No of Units	Hours/ Unit	Total Hours	Comments
3.6	Roadway Consultant Project Manager Meetings	LS	1	4	4	See listing below
3. Project Common and Project General Tasks Total					4 ✓	

3.6 - List of Roadway Project Manager Meetings

Roadway Analysis	EA	0	0	0	Typical, Master Plan
Progress Meetings	EA	1	2	2	One (1) additional phase review meeting attended by Project Manager
Phase Reviews	EA	1	2	2	
Field Reviews	EA	1	0	0	

Total Roadway Project Manager Meetings 3 4 ✓

Notes:

1. If the hours per meeting vary in length (hours) enter the average in the hour/unit column.
2. Do not double count agency meetings between permitting agencies.
3. Project manager meetings are calculated in each discipline sheet and brought forward to column D except for Photogrammetry.

Project Activity Task 4: Roadway Analysis - Item #1

Estimator:

Smith Sundry Road Over LWDD L-33 Canal
2017514

Task No.	Task	Units	No of Units	Hours/ Unit	Total Hours	Comments
4.4	Modify Horizontal Geometry for Phases	LS	2	9	18	Hor geometryx2 phasesx16hr each=32-14 (Supp. #1)=18 hours
4.10	Computation Book & Quantities for phases	LS	2	12	24	
4.11	Cost Estimate for phases	LS	2	6	12	2 phases, 3 submittals, 2 hr each
4.14	Analysis of Detour Sequencing	LS	2	10	20	
Roadway Analysis Technical Subtotal					74	
Roadway Analysis Nontechnical Subtotal					0	
4. Roadway Analysis Total					74	✓

Project Activity Task 5: Roadway Plans - Item #1

Estimator:

Smith Sundry Road Over LWDD L-33 Canal
2017514

Task No.	Task	Scale	Units	No. of Units	Hours/ Unit	No. of Sheets	Total Hours	Comments
5.2	Summary of Pay Items Including Quantity Input		Sheet	2	8	2	16	
5.5	Typical Section Sheets for each phase		Sheet	3	2	3	6	
5.6	General Notes/Pay Item Notes		Sheet	1	2	1	2	revisions
5.7	Summary of Quantities for each phase		Sheet	2	4	2	8	
5.13	Plan/Profile Sheet for each phase		Sheet	10	4	5	40	
5.30a	Cross Sections		EA	70	1	35	70	
5.30b	Driveways		EA	9	1	5	9	
5.42	Detour Plan Sheets for each phases		Sheet	2	16	2	32	
Roadway Plans Technical Subtotal						55	183	
5. Roadway Plans Total						55	183	✓

Project Activity Task 6: Drainage Analysis - Item #1

Estimator:

Smith Sundry Road Over LWDD L-33 Canal
2017514

Task No.	Task	Units	No of Units	Hours/ Unit	Total Hours	Comments
6.4	Analysis of Roadway Ditches for phases	Per Ditch Mile	2	10	20	modify ditch designs (minus Supp#1 hrs)
6.9	Design of Storm Drains	EA	21	3	63	additional & re-design current structures
Task No.	Task	Units	No of Units	Hours/ Unit	Total Hours	Comments
Drainage Analysis Technical Subtotal					83	
Drainage Analysis Nontechnical Subtotal					0	
6. Drainage Analysis Total					83	✓

Project Activity Task 7: Utilities - Item #1

Estimator:

Smith Sundry Road Over LWDD L-33 Canal
2017514

Task No.	Task	Units	No of Units	Hours/ Unit	Total Hours	Comments
7.2	Identify Existing UAO(s) - Potential conflicts	LS	1	8	8	Additional conflicts
7.7	Review Plans and Data- for each [jase	LS	2	12	24	
7.9	Pothole Utility Meeting - #1 +minutes	LS	1	8	8	
7.15	Final Utility Conflict Resolution - #2	LS	1	8	8	
7. Utilities Total					48	

Project Activity Task 20: Signing and Pavement Marking Plans - Item #1

Estimator:

Smith Sundry Road Over LWDD L-33 Canal
2017514

Task No.	Task	Scale	Units	No of Units	Hours/ Unit	No. of Sheets	Total Hours	Comments
20.6	Plan Sheet		Sheet	6	4	6	24	revised plan sheets
Signing and Pavement Marking Plans Technical Subtotal						8	24	
20. Signing and Pavement Marking Plans Total						8	24	✓

ESTIMATE OF WORK EFFORT AND COST - ROADWAY DESIGN CONSULTANT - ITEM #2

Name of Project: **Smith Sundry Road over LWDD L-33 Canal**
 County: **Palm Beach**
 FPN: **2017514**
 FAP No.: **NA**

Consultant Name: **Mock, Roos & Associates, Inc.**
 Consultant No.: **B6051.04**
 Date: **6/7/2022**
 Estimator: **GGG**

Staff Classification	Hours From "SH" Summary -	Senior Engineer	Project Manager	Project Engineer	Designer/ CADD Tech	SH By Activity	Salary Cost By Activity	Average Rate Per Task
		\$62.75	\$55.21	\$45.17	\$25.24			
Project Activity Task 5.13A - Plan/Profile Sheet Basemap Review	8	0	2	6	0	8	\$381.44	\$47.68
Project Activity Task 5.13C - Plan/Profile Basemap: 16 sheets x 1 hr/section	16	0	2	14	0	16	\$742.80	\$46.43
Project Activity Task 5.13D - Plan/Profile Sheet: 24 sheets x 2/hr sheet	48	0	4	44	0	48	\$2,208.32	\$46.01
Project Activity Task 5.5 - Typical Section Sheets: 4 sheets x 1/hr sheet	4	0	2	2	0	4	\$200.76	\$50.19
Project Activity Task 5.30A - Cross Section: 57 Cross-Sections x 2/hr section	114	4	30	80	0	114	\$5,520.90	\$48.43
Project Activity Task 5.30B - Driveways: 4 profiles x 1.0/hr profile	4	0	0	4	0	4	\$180.68	\$45.17
Project Activity Task 5.13B - Plan/Profile Sheet Basemap Coordination	4	2	2	0	0	4	\$235.92	\$58.98
Total Staff Hours	198	6	42	150	0	198		
Total Staff Cost		\$376.50	\$2,318.82	\$6,775.50	\$0.00		9,470.82	\$47.83

ADDITIONAL BASIC SERVICES

SALARY RELATED COSTS: \$ 9,470.82 ✓
 MULTIPLIER 3.00 \$ 28,412.46 ✓
TOTAL MOCK ROOS TOTAL BASIC SERVICES FEE: \$ 28,412.46 ✓

Project Activity 5: Roadway Plans - Item #2

Estimator:

Smith Sundry Supplement #2 Item #2
2017514

Task No.	Task	Scale	Units	No. of Units	Hours/ Unit	No. of Sheets	Total Hours	Comments
5.5	Typical Section Sheets: 4 sheets x 1/hr sheet: PM/PE		Sheet	4	1	4	4	Update/Replace
5.13A	Plan/Profile Sheet Basemap Review: PM/PE		LS	1	8	0	8	Review and Evaluate Impacts
5.13B	Plan/Profile Sheet Basemap Coordination: SPE/PM		LS	1	4	0	4	Coordinate with WGI and County
5.13C	Plan/Profile Sheet Basemap: 16 sheets x 1/hr sheet: PM/PE		Sheet	16	1	16	16	Update/Replace
5.13D	Plan/Profile Sheet: 24 sheets x 2/hr sheet: PM/PE		Sheet	24	2	24	48	Update/Replace
5.30A	Cross Sections: 57 Cross-Sections x 2/hr section: SPE/PM/PE		EA	57	2	19	114	Update/Replace
5.30B	Driveways: 4 profiles x 1.0/hour profile: PE		EA	4	1	2	4	Update/Replace
Roadway Plans Technical Subtotal						65	198	
5. Roadway Plans Total						65	198	✓



December 22, 2021
Revised March 9, 2022
Revised May 3, 2022
Revised May 19, 2022
Revised June 7, 2022

Mr. Tim DeLand, P.E.
WGJ
2035 Vista Parkway
West Palm Beach, FL 33411

**Re: Smith Sundry Road over LWDD L-33 Canal – PBCo. Project No. 2017514
Canal Scour Analysis–Canal Survey, Survey Revisions to Incorporate Information from
PBCo. Maintenance Map Drawing No. S-3-18-3943.pdf Per Survey Review Comments for
Specific Purpose Survey (approved August 7, 2018) and 65% Roadway & Drainage Plans,
and Optional Legal Descriptions & Sketches and Boundary Surveys**

Dear Tim:

Thank you for the opportunity to provide you with the following services for the subject site. This proposal is based on documentation and information provided by your office. The scope of services is as follows:

SCOPE OF SERVICES

I. CANAL SURVEY

Utilizing the survey control from the survey previously prepared by this office (B&P Project 18-007), we will perform two (2) canal cross sections across the LWDD L-33 Canal as shown on Attachment 'B'. The sections will go from the north canal right-of-way line to the south canal right-of-way line and extend 20' beyond the right-of-way of the canal. We will prepare a drawing which will show the canal cross sections with plan (1" = 20') and profile (1" = 10') views.

II. SURVEY REVISIONS TO INCORPORATE INFORMATION FROM PBCo. MAINTENANCE MAP DRAWING No. S-3-18-3943.pdf

We will revise the survey to incorporate information from PBCo. Maintenance Map Drawing No. S-3-18-3943.pdf in order to address survey review comments dated June 25, 2021, for the Specific Purpose Survey which was previously approved on August 7, 2018, and the 65% Roadway and Drainage Plans. No new topographic features will be addressed.

OPTIONAL SERVICES:

III. LEGAL DESCRIPTIONS & SKETCHES

We will prepare legal descriptions and sketches for temporary construction easements (TCE) and right-of-way takes, as needed. These sketches will be based on record ownership data and record plats provided by Palm Beach County. All sketches will be consistent with the requirements of Palm Beach County and Florida Standards of Practice. We have estimated seven (7) parcels for this project at \$450.00 each totaling \$3,150.00.

DeLand
June 7, 2022
Page 2

**IV. BOUNDARY SURVEYS FOR RIGHT-OF-WAY TAKES AND
TEMPORARY CONSTRUCTION EASEMENTS (TCE)**

For any right-of-way takes and TCEs that go to a condemnation process, we will convert the legal description & sketch into a boundary survey showing existing improvements. The survey will be prepared in accordance with the Standards of Practice in Rule 5J-17.050 – 0.53, Florida Administrative Code, pursuant to Chapter 472.027 of the Florida Statute, for the above referenced site. No vertical work is proposed. We have estimated four (4) parcels for this project at \$1,659.24 each totaling \$6,636.96.

V. RIGHT-OF-WAY PROCUREMENT MAP

We will prepare a Right-of-Way Procurement Map to Palm Beach County thoroughfare design standards for the proposed alignment.

VI. CLOSURE

We propose to provide WGI with hard copies, a digitally signed PDF file, and an AutoCAD file in the version requested. We will perform the scope of services for a **lump sum fee of \$26,104.47** (\$1,948.23 for the Canal Survey, \$9,049.92 to address the Maintenance Map comments from the County, \$3,150.00 for seven (7) optional legal descriptions and sketches, \$6,636.48 for four (4) optional boundary surveys, and \$5,319.84 for a right-of-way procurement map), see Attachment 'A' for an hourly breakdown. Any additional work will be done on an hourly basis as approved by you. Please do not hesitate to call me with any questions you might have regarding this proposal. We look forward to working with you on this project.

Brown & Phillips, Inc.

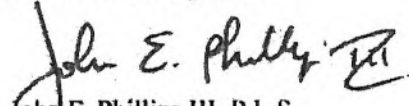
John E. Phillips III, P.L.S.
Principal

Attachment

JEP/mb



ATTACHMENT 'A' (1 of 2)

Smith Sundry Road over LWDD L-33 Canal – PBCo. Project No. 2017514
Canal Scour Analysis–Canal Survey and Survey Revisions to Incorporate Information from
PBCo. Maintenance Map Drawing No. S-3-18-3943.pdf Per Survey Review Comments for
Specific Purpose Survey (approved August 7, 2018) and 65% Roadway & Drainage Plans

Type of Survey: Canal Survey

Size:

Date: June 7, 2022

	SURVEY CREW (3 PERSON)	CADD TECHNICIAN	SURVEY TECHNICIAN	PROFESSIONAL LAND SURVEYOR	COMMENTS
Meetings and Coordination					
Horizontal & Vertical Project Network Control	2		0.5		Recover control
Canal Cross Sections	6		1		(2) canal cross sections
Drawing		4	1	0.5	Add information to existing survey
Total Hours:	8	4	2.5	0.5	
Rate/Hour	\$54.12	\$30.09	\$30.09	\$41.72	unloaded rates
Subtotal:	\$432.96	\$120.36	\$75.23	\$20.86	
Total Labor Cost (unloaded):					\$649.41
Multiplier:					3.00
Total Labor Cost (loaded):					\$1,948.23 ✓

TASK - Survey Revisions to address PBCo. comments	SURVEY CREW (3 PERSON)	CADD TECHNICIAN	SURVEY TECHNICIAN	PROFESSIONAL LAND SURVEYOR	COMMENTS
Meetings and Coordination				2	
Maintenance Map Revisions		8	32	4	Revise approved survey with Maintenance Map
Drawing	8	12	20	4	Add information to existing survey to address new comments & more
Total Hours:	8	20	52	10	
Rate/Hour	\$54.12	\$30.09	\$30.09	\$41.72	unloaded rates
Subtotal:	\$432.96	\$601.80	\$1,564.68	\$417.20	
Total Labor Cost (unloaded):					\$3,016.64
Multiplier:					3.00
Total Labor Cost (loaded):					\$9,049.92 ✓

BP BROWN & PHILLIPS, Inc.
 PROFESSIONAL SURVEYING SERVICES
 ATTACHMENT A (2 of 2)

Smith Sundry Road over LWDD L-33 Canal – PBCo. Project No. 2017514
 Canal Scour Analysis–Canal Survey and Survey Revisions to Incorporate Information from
 PBCo. Maintenance Map Drawing No. S-3-18-3943.pdf Per Survey Review Comments for
 Specific Purpose Survey (approved August 7, 2018) and 65% Roadway & Drainage Plans

Boundary Survey for R/W takes that go to condemnation process

TASK	SURVEY CREW (3 PERSON)	CADD TECHNICIAN	SURVEY TECHNICIAN	PROFESSIONAL LAND SURVEYOR	COMMENTS
Horizontal Project Network Control					Find control
Section/Boundary Ties	2		0.5		Find and locate existing monumentation
Boundary Monumentation	2		0.5		Set property corners
Locations	1				Locate boundary features
Drawing		4	3	1	Prepare boundary survey
Total Hours:	5	4	4	1	hours per parcel
Rate/Hour	\$54.12	\$30.09	\$30.09	\$41.72	unloaded rates
Subtotal:	\$270.60	\$120.36	\$120.36	\$41.72	
Total Labor Cost (unloaded):					\$553.04
Multiplier:					3.00
Total cost for 1 boundary survey (loaded):					\$1,659.12 ✓
					x 4
Total cost for 4 boundary surveys					\$6,636.48 ✓

TASK	SURVEY CREW (3 PERSON)	CADD TECHNICIAN	SURVEY TECHNICIAN	PROFESSIONAL LAND SURVEYOR	COMMENTS
R/W Procurement Map		10	42	5	Prepare Procurement Map with approximately 66 takings
Total Hours:	0	10	42	5	hours per parcel
Rate/Hour	\$54.12	\$30.09	\$30.09	\$41.72	unloaded rates
Subtotal:	\$0.00	\$300.90	\$1,263.78	\$208.60	
Total Labor Cost (unloaded):					\$1,773.28
Multiplier:					3.00
Total Labor Cost (loaded):					\$5,319.84 ✓

Other Direct Costs:	<u>quantity</u>	<u>unit</u>	<u>cost/unit</u>	<u>total</u>	
Legal Description & Sketch	7	each	\$450.00	\$3,150.00	
Prints		sheet	\$1.50	\$0.00	
Shipping		cost x markup	1.20	\$0.00	
Total Other Direct Costs:					\$3,150.00
TOTAL PRICE					\$26,104.47 ✓

OEBO SCHEDULE 1

SOLICITATION/PROJECT/BID NAME: Smith Sundry Road over LWDD L-33 Canal

SOLICITATION/PROJECT/BID NO.: 2017514

SOLICITATION OPENING/SUBMITTAL DATE: 09/06/2016

COUNTY DEPARTMENT: Roadway Production Division

Section A PLEASE LIST THE DOLLAR AMOUNT OR PERCENTAGE OF WORK TO BE COMPLETED BY THE PRIME CONTRACTOR/CONSULTANT* ON THE PROJECT:

NAME OF PRIME RESPONDENT/BIDDER: WGI, Inc. ADDRESS: 2035 Vista Parkway, WPB, FL 33411

CONTACT PERSON: Chris LaForte, PE PHONE NO.: 561-687-2220 E-MAIL: chris.laforte@wginc.com

PRIME'S DOLLAR AMOUNT OR PERCENTAGE OF WORK: \$11,760.00

*SMWBE Prime's must include their percentage or dollar amount in the Total Participation line under section B.

Non-SBE MBE WBE SBE

Section B PLEASE LIST THE DOLLAR AMOUNT OR PERCENTAGE OF WORK TO BE COMPLETED BY ALL SUBCONTRACTORS/SUBCONSULTANTS ON THE PROJECT BELOW:

Subcontractor/Sub consultant Name	(Check all Applicable Categories)				DOLLAR AMOUNT OR PERCENTAGE OF WORK					
	Non-SBE	MBE Minority Business	WBE Women Business	SBE Small Business	Black	Hispanic	Women	Caucasian	Asian	Other
	1. Mock, Roos & Associates, Inc.	<input checked="" type="checkbox"/>	<input type="checkbox"/>	<input type="checkbox"/>	<input type="checkbox"/>				\$88,012.08	
2. Brown & Phillips, Inc.	<input type="checkbox"/>	<input checked="" type="checkbox"/>	<input type="checkbox"/>	<input checked="" type="checkbox"/>	\$26,104.47					
3.	<input type="checkbox"/>	<input type="checkbox"/>	<input type="checkbox"/>	<input type="checkbox"/>						
4.	<input type="checkbox"/>	<input type="checkbox"/>	<input type="checkbox"/>	<input type="checkbox"/>						
5.	<input type="checkbox"/>	<input type="checkbox"/>	<input type="checkbox"/>	<input type="checkbox"/>						

(Please use additional sheets if necessary)

Total \$26,104.47 \$88,012.08

Total Bid/Offer Price \$ 125,876.55 Total Certified S/M/WBE Participation \$ 26,104.47

I hereby certify that the above information is accurate to the best of my knowledge: JEFFREY N. BROPHY JAB 4/16/2022 VP, PLACE

Name & Authorized Signature Title

- Note:**
- The amount listed on this form for a Subcontractor/sub consultant must be supported by price or percentage listed on the properly executed Schedule 2 or attached signed proposal.
 - Only those firms certified by Palm Beach County at the time of solicitation opening or due date are eligible to meet the established OEBO Affirmative Procurement Initiative (API). Please check the applicable box and list the dollar amount or percentage under the appropriate demographic category.
 - Modification of this form is not permitted and will be rejected upon submittal.

OEBO LETTER OF INTENT – SCHEDULE 2

EXHIBIT C-Page 2 of 3

A completed Schedule 2 is a binding document between the Prime Contractor/consultant and a Subcontractor/subconsultant (for any tier) and should be treated as such. The Schedule 2 shall contain bolded language indicating that by signing the Schedule 2, both parties recognize this Schedule as a binding document. All Subcontractors/subconsultants, including any tiered Subcontractors/subconsultants, must properly execute this document. Each properly executed Schedule 2 must be submitted with the bid/proposal.

SOLICITATION/PROJECT NUMBER: 2017514

SOLICITATION/PROJECT NAME: Smith Sundy Road over LWDD L-33 Canal

Prime Contractor: WGI, Inc. Subcontractor: Mock, Roos & Associates, Inc.

(Check box(s) that apply)

SBE WBE MBE M/WBE Non-S/M/WBE Date of Palm Beach County Certification (if applicable): _____

The undersigned affirms they are the following (select one from each column if applicable):

<u>Column 1</u>	<u>Column 2</u>	<u>Column 3</u>
<input checked="" type="checkbox"/> Male <input type="checkbox"/> Female	<input type="checkbox"/> African-American/Black <input type="checkbox"/> Asian American <input checked="" type="checkbox"/> Caucasian American	<input type="checkbox"/> Supplier
	<input type="checkbox"/> Hispanic American <input type="checkbox"/> Native American	

S/M/WBE PARTICIPATION – S/M/WBE Primes must document all work to be performed by their own work force on this form. Failure to submit a properly executed Schedule 2 for any **S/M/WBE** participation may result in that participation not being counted. Specify in detail, the scope of work to be performed or items supplied with the dollar amount and/or percentage for each work item. S/M/WBE credit will only be given for the areas in which the S/M/WBE is certified. A detailed proposal may be attached to a properly executed Schedule 2.

Line Item	Item Description	Unit Price	Quantity/ Units	Contingencies/ Allowances	Total Price/Percentage
1	Modifications to original plans	\$59,599.62	1		\$59,599.62
2	Right of Way Maintenance Plan Revisions	\$28,412.46	1		\$28,412.46

The undersigned Subcontractor/subconsultant is prepared to self-perform the above-described work in conjunction with the aforementioned project at the following total price or percentage: \$88,012.08

If the undersigned intends to subcontract any portion of this work to another Subcontractor/subconsultant, please list the business name and the amount below accompanied by a separate properly executed Schedule 2.

_____ Price or Percentage: _____

Name of 2nd/3rd tier Subcontractor/subconsultant

WGI, Inc.
 Print Name of Prime
 By: 
 Authorized Signature
JEFFREY N. BROPHY
 Print Name
VP, PLACE
 Title
 Date: 6/16/2022

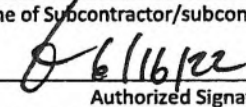
Mock, Roos & Associates, Inc.
 Print Name of Subcontractor/subconsultant
 By: 
 Authorized Signature
Garrytt G. Gruber, P.E.
 Print Name
Senior Vice President
 Title
 Date: June 16, 2022

OEBO LETTER OF INTENT – SCHEDULE 2

A completed Schedule 2 is a binding document between the Prime Contractor/consultant and a Subcontractor/subconsultant (for any tier) and should be treated as such. The Schedule 2 shall contain bolded language indicating that by signing the Schedule 2, both parties recognize this Schedule as a binding document. All Subcontractors/subconsultants, including any tiered Subcontractors/subconsultants, must properly execute this document. Each properly executed Schedule 2 must be submitted with the bid/proposal.

SOLICITATION/PROJECT NUMBER: 2017514

SOLICITATION/PROJECT NAME: Smith Sundry Road over LWDD L-33 Canal

Prime Contractor: WGI, Inc. Subcontractor: Brown & Phillips, Inc.

(Check box(s) that apply)

SBE WBE MBE M/WBE Non-S/M/WBE Date of Palm Beach County Certification (if applicable): 01/31/22-01/30/25

The undersigned affirms they are the following (select one from each column if applicable):

Column 1	Column 2	Column 3
<input checked="" type="checkbox"/> Male <input type="checkbox"/> Female	<input checked="" type="checkbox"/> African-American/Black <input type="checkbox"/> Asian American <input type="checkbox"/> Caucasian American	<input type="checkbox"/> Supplier
	<input type="checkbox"/> Hispanic American <input type="checkbox"/> Native American	

S/M/WBE PARTICIPATION – S/M/WBE Primes must document all work to be performed by their own work force on this form. Failure to submit a properly executed Schedule 2 for any S/M/WBE participation may result in that participation not being counted. Specify in detail, the scope of work to be performed or items supplied with the dollar amount and/or percentage for each work item. S/M/WBE credit will only be given for the areas in which the S/M/WBE is certified. A detailed proposal may be attached to a properly executed Schedule 2.

Line Item	Item Description	Unit Price	Quantity/ Units	Contingencies/ Allowances	Total Price/Percentage
1	Canal Survey	\$1,948.23	1		\$1,948.23
2	Survey Revisions	\$9,049.92	1		\$9,049.92
3	Boundary Survey for R/W	\$1,659.12	4		\$6,636.48
4	R/W Procurement Map	\$5,319.84	1		\$5,319.84
5	Legal Description	\$450.00	7		\$3,150.00

The undersigned Subcontractor/subconsultant is prepared to self-perform the above-described work in conjunction with the aforementioned project at the following total price or percentage: \$26,104.47

If the undersigned intends to subcontract any portion of this work to another Subcontractor/subconsultant, please list the business name and the amount below accompanied by a separate properly executed Schedule 2.

Name of 2nd/3rd tier Subcontractor/subconsultant _____

Price or Percentage: _____

WGI, Inc.

Print Name of Prime

By: _____

[Signature]
Authorized Signature
JEFFREY N. BROPHY

Print Name

VP, PLACE

Title

Date: 6/16/2022

Brown & Phillips, Inc.

Print Name of Subcontractor/subconsultant

By: _____

[Signature]
Authorized Signature
John E. Phillips

Print Name

President

Title

Date: June 16, 2022

PROJECT HISTORY

Smith Sundry Road over LWDD L-33 Canal					
Project# 2017514					
Authorization	Supplement	Date Approved	Total Amount	SBE Amount	SBE %
BCC	Original Contract	3/13/18	\$ 199,324.57	\$ 124,597.79	62.51%
CRC	Supplement #1	5/6/20	\$ 89,497.25	\$ 89,497.25	100.00%
BCC	Supplement #2	Pending	\$ 125,876.55	\$ 26,104.47	20.73%
Project Totals			\$ 414,698.37	\$ 240,199.51	57.92%

Search

Insured Name

WGI Inc. (DX00000510)

WGI Inc. (DX00000510)

Active Records Only

Advance Search

Insured Tasks | **Admin Tools**

View

- Insured
- Notes
- History
- Deficiencies
- Coverages
- Requirements
- Contract Screen
- Add
- Edit
- Help
- Video Tutorials

[Home](#)
[Insured Tasks](#)
[View](#)
[Insured](#)

Insured

Name:	WGI Inc.
Account Number:	DX00000510
Address:	
Status:	Currently in Compliance.

Insured

[Business Unit\(s\)](#)
[DBA Number](#)
[DBA Name](#)
[Print Insured Info](#)
[Print Compliance Report](#)

Account Information

Account Number:	DX00000510
Risk Type:	Standard - Professional Services
Do Not Call:	Address Updated:

Address Information

Mailing Address	Physical Address
Insured:	WGI Inc.
Address 1:	
Address 2:	
City:	
State:	
Zip:	
Country:	

Contract Information

Contract Number:		Contract End Date:	
Contract Start Date:		Contract Expiration Date:	
Contract Effective Date:		Safety Form II:	No
Description of Services:	Structural Engineering Annual Services		

Contact Information

Contact Name:	Kim Draggos	Misc:	
Phone Number:	5616872220	Alt Phone Number:	
Fax Number:			
E-Mail Address:	kim.droggos@wginc.com		

Approval Date:

Rush:	No
Contract on File:	No
Certificate Received:	No
Indemnification Agreement:	No
Tax Id:	

This Account created by e59 on 02/19/2020.