

II. FISCAL IMPACT ANALYSIS

A. Five Year Summary of Fiscal Impact:

Fiscal Years	2024	2025	2026	2027	2028
Capital Expenditures	0	0	0	0	0
Operating Costs	0	0	0	0	0
External Revenues	0	0	0	0	0
Program Income(County)	0	0	0	0	0
In-Kind Match(County)	0	0	0	0	0
NET FISCAL IMPACT	0	0	0	0	0
#ADDITIONAL FTE POSITIONS (CUMULATIVE)	0	0	0	0	0

Is Item Included in Current Budget? Yes ___ No X
 Is this item using Federal Funds? Yes ___ No X
 Is this item using State Funds? Yes ___ No X

Budget Account No:

Fund _____ Dept _____ Unit _____

B. Recommended Sources of Funds/Summary of Fiscal Impact:

There is no fiscal impact to this agenda item. If there is a change to the fiscal impact, a new agenda item will be presented to the Board.

*A. DiPiero, Mgr., F&D,
 OFMB 11/30/23*

C. Departmental Fiscal Review:

Aaron Maharaj
Digitally signed by Aaron Maharaj
 Reason: I am the author of this document
 Date: 2023.11.30 09:16:05'00'

III. REVIEW COMMENTS:

A. OFMB Fiscal and/or Contract Dev. and Control Comments:

Sum Mad 11/30/2023
 MG 11/30 OFMB

A. J. Johnson 11/30/23
 Contract Dev. & Control
 11/30/23

B. Legal Sufficiency

[Signature]
 Assistant County Attorney

C. Other Department Review

 Department Director

(THIS SUMMARY IS NOT TO BE USED AS A BASIS FOR PAYMENT.)

Attachment 1
Village of Wellington Proposed Annexation

Annexation Location Map

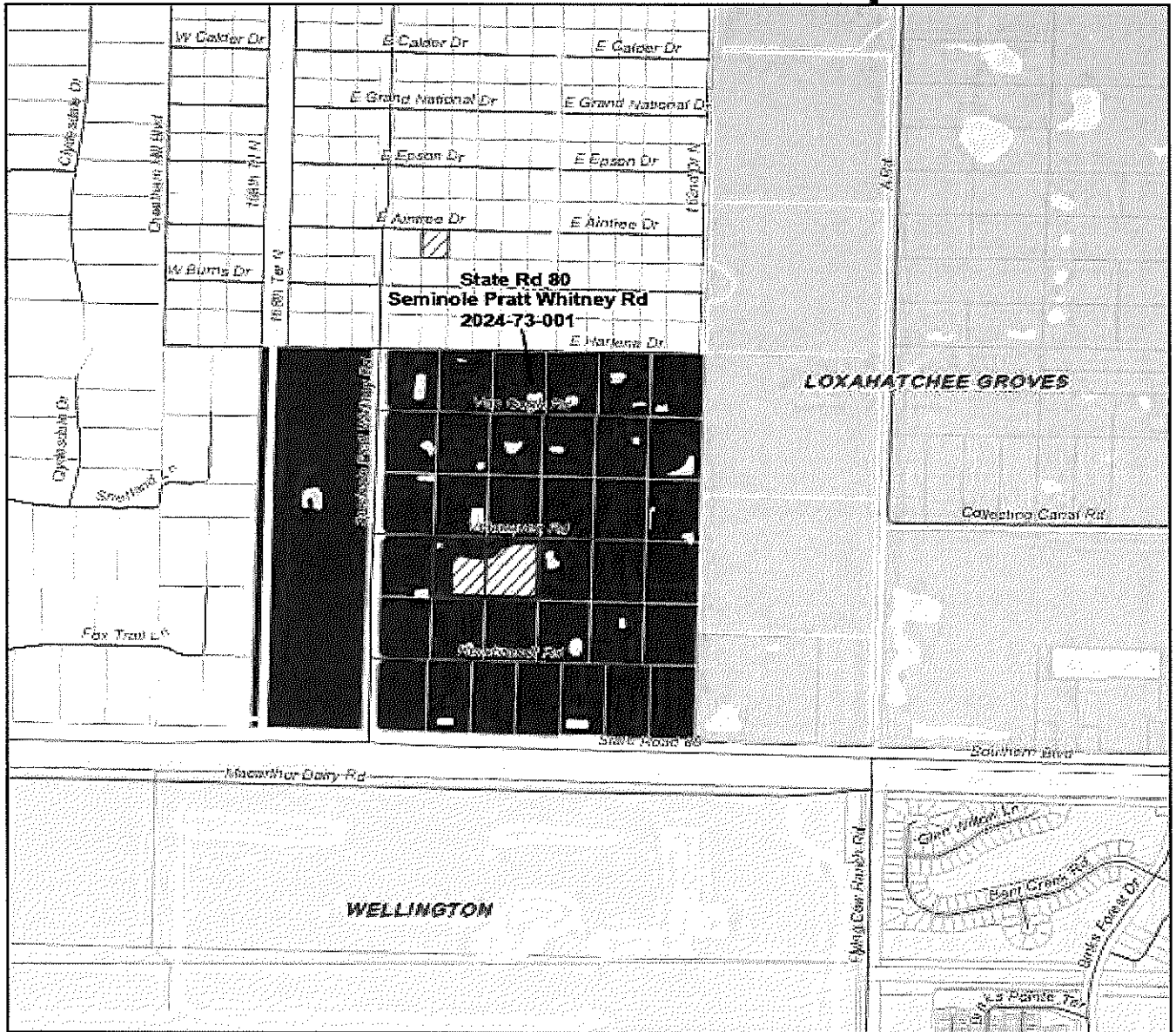

Proposed Annexation	Water	Right-of-Way Maintenance	
Wellington	PBC Owned	County ROW Maintenance	Other ROW Maintenance
Loxahatchee Groves		— County Maintained	— State Maintained
		— Courtesy Maintained	— Other

Updated: 1/11/2024
 Contact: Nicole DeLeon
 Telephone: 561-241-1100/561-241-1101
 Note: Map is not official, for informational purposes only.
 Source: ROW Maintenance Data: PBC Engineering
 Date: 2015 GISPROC SDE GEODATA.CENTRALINE_LIN

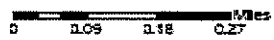

Planning, Zoning & Building
 2280 N. Hwy 1A
 West Palm Beach, FL 33411
 Phone: 561-733-2000



Annexation Location Map



Proposed Annexation

Wellington

Loxahatchee Groves

Water

PBC Owned

Right-of-Way Maintenance

County ROW Maintenance

County Maintained

Courtesy Maintained

Other ROW Maintenance

State Maintained

Other

Project No: 131100014
 Contact: Nicole DeLeon
 Reference: 131100014/FY2014

*Map is not intended for informational purposes only.
 Source: GIS/Map Information Data: PBC Engineering
 Date: 2015 GIS/PROJ 2DC GEODATA CENTERLINE_L4

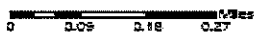

**Fleming, Zering
& Building**
 2200 N. US Hwy 1
 West Palm Beach, FL 33411
 Phone: 561-733-2222

