

**PALM BEACH COUNTY
BOARD OF COUNTY COMMISSIONERS
AGENDA ITEM SUMMARY**

Meeting Date:	January 23, 2024	<input checked="" type="checkbox"/> Consent	<input type="checkbox"/> Regular
		<input type="checkbox"/> Ordinance	<input type="checkbox"/> Public Hearing
Department:	Engineering & Public Works		
Submitted By:	Engineering & Public Works		
Submitted For:	Traffic Division		

I. EXECUTIVE BRIEF

Motion and Title: Staff recommends motion to:

- A) approve** Work Order G-18 for a cost not to exceed \$501,623.16 to the annual traffic signal contract dated August 23, 2022 (R2022-0791) with Gerelco Traffic Controls, Inc. (Gerelco) to construct a mast arm traffic signal at the intersection of Weisman Way and Sansburys Way, Palm Beach County (County) Intersection ID Number 29862 (Project); and
- B) approve** a Budget Amendment of \$450,000 in the County Transport Trust to recognize reimbursement funding from Florida Auto Auction of Orlando, Inc. dba Manheim Palm Beach (Manheim) and appropriate it to the Project.

SUMMARY: Approval of this Work Order will allow Gerelco to construct the Project. Pursuant to Condition E.9 of Resolution R2009-0486, Manheim is required to fund the cost of a mast arm traffic signal if warranted. In 2018 County staff determined the signal is warranted and estimated the Project costs to be \$450,000. Manheim provided the County \$450,000. The Project was then delayed due to utility conflicts and an ongoing project at this location that is anticipated to be completed in early 2024. The current market prices for the related products and services to construct a mast arm traffic signal have increased since 2018. Upon completion of the Project, Manheim will be refunded any excess payment or be billed for any extra costs, depending on the actual Project cost. Per County PPM CW-F-050, this work order exceeds the threshold relating to staff approvals of work orders to annual contracts, thus requiring approval from the Board of County Commissioners (BCC). Prior to this work order, \$2,223,980.19 of Gerelco's \$5,000,000 contract has been spent or encumbered. Gerelco has an office located in the County. On January 20, 2022, the Office of Equal Business Opportunity granted a waiver of the Affirmative Procurement Initiative based upon the determination that sufficient qualified Small/Minority/Women Business Enterprises providing the goods or services required by the contract are unavailable in the County to perform the specialized construction of traffic signals. On August 23, 2022, the BCC approved the annual traffic signal contract with Gerelco to provide for and install various signal components for traffic control devices. District 2 (YBH)

Background and Justification: The County requests Gerelco construct the Project in accordance with the Work Order. The construction cost is not to exceed \$501,623.16, including a contingency of \$83,603.86. The Engineering & Public Works Department recommends BCC approval.

Attachments:

1. Location Sketch
2. Work Order with Exhibits A and B
3. Office of Equal Business Opportunity Waiver
4. Budget Amendment

Recommended By:	<u><i>David Z. Hill</i></u>	<u>12/20/2023</u>
	YBH/TEL County Engineer	Date
Approved By:	<u><i>Pal</i></u>	<u>12/28/23</u>
	Assistant County Administrator	Date

II. FISCAL IMPACT ANALYSIS

A. Five Year Summary of Fiscal Impact:

Fiscal Years	2024	2025	2026	2027	2028
Capital Expenditures	\$ 501,624	-0-	-0-	-0-	-0-
Operating Costs	-0-	-0-	-0-	-0-	-0-
External Revenues	-0-	-0-	-0-	-0-	-0-
Program Income (County)	-0-	-0-	-0-	-0-	-0-
In-Kind Match (County)	-0-	-0-	-0-	-0-	-0-
NET FISCAL IMPACT	\$ 501,624	-0-	-0-	-0-	-0-
# ADDITIONAL FTE POSITIONS (Cumulative)	-0-	-0-	-0-	-0-	-0-

Yes ☐ No ☒

Yes ☐ No ☒

Yes ☐ No ☒

Budget Account No:

Dept 360 **Unit** 3224-178

Object 6408

Recommended Sources of Funds/Summary of Fiscal Impact:

County Transport Trust

Jpa & Developer Agreements/Tranfer

Sansbury's Way/Manheim Palm Beach Auto Auction Traffic Signal

Construction Contract	\$ 418,019.30
-----------------------	---------------

Contingency	\$ 83,603.86
-------------	--------------

Fiscal Impact	\$ 501,623.16
---------------	---------------

C. Departmental Fiscal Review:

III. REVIEW COMMENTS

A. OFMB Fiscal and/or Contract Dev. and Control Comments:

Lisa Monte 12/11/2003
OFMB MD 12/11

Comments:

Dr. G. Jackson 10/21/23

Contract Dev. and Control

7/16/23

**B. Approved as to Form
and Legal Sufficiency:**

Assistant County Attorney 12/27/23

C. Other Department Review:

Department Director

This summary is not to be used as a basis for payment.

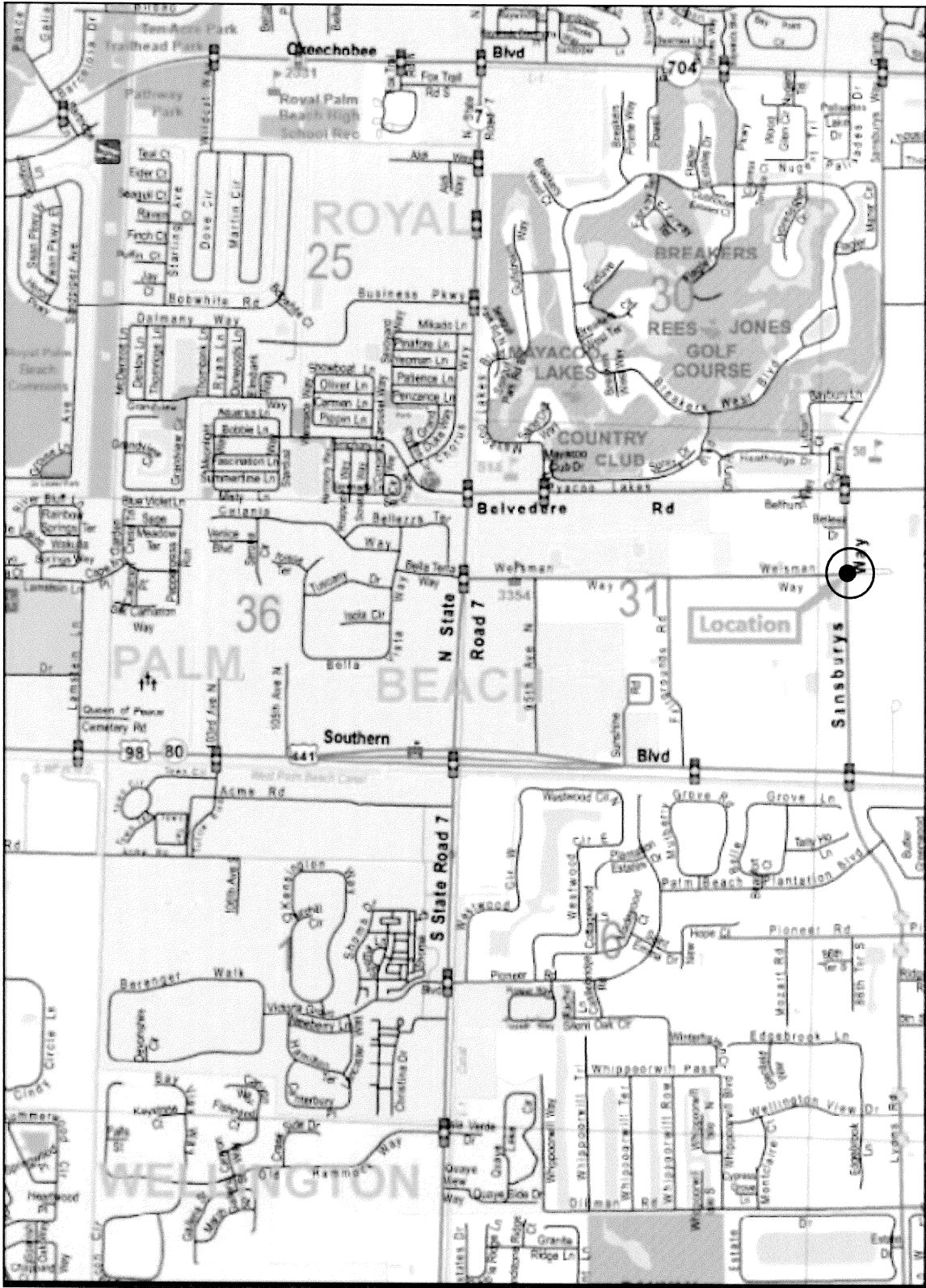

WORK ORDER G-18 TO THE ANNUAL TRAFFIC SIGNAL CONTRACT (R2022-0791) BETWEEN PALM BEACH COUNTY AND GERELCO TRAFFIC CONTROLS, INC. TO CONSTRUCT A MAST ARM TRAFFIC SIGNAL AT THE INTERSECTION OF WEISMAN WAY AND SANSBURYS WAY, PALM BEACH COUNTY INTERSECTION ID NUMBER 29862, SIGNAL PROJECT NUMBER 2018-709, PALM BEACH COUNTY, FLORIDA

THIS WORK ORDER TO THE ANNUAL TRAFFIC SIGNAL CONTRACT DATED AUGUST 23, 2022 (R2022-0791), is made and entered into this ____ day of _____, 2024, by and between Palm Beach County, a political subdivision of the State of Florida, by and through its Board of County Commissioners (**COUNTY**), and **GERELCO TRAFFIC CONTROLS, INC.**, a Florida corporation with an address of 560 NW Enterprise Drive, Port Saint Lucie, FL 34986 (**CONTRACTOR**).

WITNESSETH

WHEREAS, on August 23, 2022, **COUNTY** and **CONTRACTOR** entered into an Annual Contract (R2022-0791) (**CONTRACT**) to provide for the furnishing and installation of various signal components for traffic control devices on a work order basis; and

WHEREAS, **COUNTY** desires **CONTRACTOR** to construct a mast arm traffic signal at the intersection of Weisman Way and Sansburys Way, Palm Beach County Intersection ID Number 29862, (**PROJECT**); and

WHEREAS, **CONTRACTOR** agrees to construct the **PROJECT** in accordance with the terms and conditions of the **CONTRACT**, as directed and accepted by the **COUNTY**; and

WHEREAS, pursuant to the **CONTRACT**, a cost not to exceed \$501,623.16 has been calculated by **COUNTY** and found to be appropriate compensation for the services to be performed by **CONTRACTOR** to construct the **PROJECT**.

NOW, THEREFORE, THIS INDENTURE WITNESSETH: That for and in consideration of the mutual benefits to flow from each to the other, the parties hereto agree as follows:

1. The above recitals are true and correct and incorporated herein.
2. **CONTRACTOR** agrees to provide services for the **PROJECT** in accordance with the **CONTRACT** and as further described in **Exhibits A and B**.
3. **COUNTY** agrees to pay the **CONTRACTOR** a fee not to exceed \$501,623.16 to construct the **PROJECT**. Final payment shall be per documented quantities installed.

IN WITNESS WHEREOF, the Board of County Commissioners of Palm Beach County, Florida, has made and executed this Work Order for the PROJECT, pursuant to the CONTRACT, on behalf of the COUNTY, and CONTRACTOR has hereunto set its hand the day and year above written.

OWNER:

Palm Beach County, a political subdivision of the State of Florida by and through its Board of County Commissioners

BY: _____
Maria Sachs, Mayor

ATTEST:
Joseph Abruzzo
Clerk of the Circuit Court & Comptroller

BY: _____
Deputy Clerk

COUNTY SEAL

APPROVED AS TO TERMS AND CONDITIONS

BY: _____
Motasem Al-Turk
Traffic Division, Director

APPROVED AS TO FORM & LEGAL SUFFICIENCY:

BY: _____
Yelizaveta Herman
Assistant County Attorney

CONTRACTOR:

Gerelco Traffic Controls, Inc., a Florida Corporation

BY: _____
Kenneth A. Geremia, Jr.
President

CORPORATE SEAL

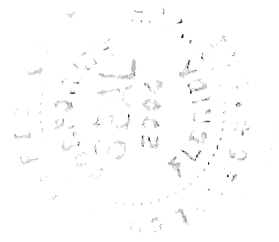

WITNESS:

BY: _____
O'teaka Lilly
(Printed Name)

BY: _____
Maria Enriquez
(Printed Name)

PALM BEACH COUNTY ENGINEERING & PUBLIC WORKS
TRAFFIC DIVISION WORK ORDER / ANNUAL CONTRACT R2022-0791

PROJECT NAME: Weisman Way and Sansburys Way
(PBC Intersection 29862)

BUDGET LINE ITEM:

KDO NUMBER: KDO-361- EN101923*7

PBC ENGINEERING ANNUAL SIGNAL CONTRACT NUMBER: 2022-052

PBC ENGINEERING PROJECT NUMBER: N/A

PBC TRAFFIC DIVISION SIGNAL PROJECT NUMBER: 2018-709

WORK ORDER NUMBER: G-18

DATE: _____ COMMISSION DISTRICT: 2

TO: Kenneth A. Geremia, Jr., Gerelco Traffic Controls, Inc.

In accordance with the terms of your contract dated August 23, 2022, you are directed to provide the following supplies and services: Provide for the furnishing and installation of a mast arm traffic signal as shown on the Signal Plan sheets, and Bidtab, dated 9/15/2023.

The above work shall be performed at: Weisman Way and Sansburys Way (PBC Intersection 29862).

STARTING: The contract duration for this work is 210 days. A separate Notice to Proceed ("NTP") letter will be issued directing the contractor to commence work within the time specified in the NTP letter. The total amount of this Work Order, at the contract prices, is estimated to be \$501,623.16, which includes \$83,603.86 contingency (see attached Bidtab for quantities). The Office of Equal Business Opportunity waived the API Requirements.

This work shall be coordinated by, (48 hours prior notice to commencement of work):

<u>Fattoush Jafar, P.E., Ph.D.</u>	<u>Traffic Engineering & Operations Manager</u>	<u>(561) 684-4030</u>
Name	Title	Telephone

Please indicate your receipt of this Work Order by signing and returning a duplicate copy.

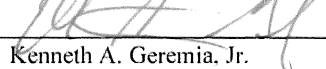
	<u>President</u>	<u>772.340.7474</u>
Name <u>Kenneth A. Geremia, Jr.</u>	Title	Telephone

Please sign below and submit with invoice at the completion of the project.
Project completed in compliance with Contract and Project specifications.

_____ Signature	_____ Title	_____ Telephone
--------------------	----------------	--------------------



PBCBCC-TRAFFIC DIVISION
2300 N. JOG ROAD
W.P.B., FL. 33411-2745
Phone: (561) 684-4030 Fax: (561) 478-5770

GERELCO BIDTAB
CONTRACT
#2022052

DATE: 9/15/2023 SIGNAL PROJECT #: 2018709

INTERSECTION: Weisman Way & Sansburys Way

INTERSECTION NO.# 29862

ITEM NO.#	PRODUCT NAME	QTY	PRICE	LINE TOTAL
102-1-A	GENERAL MAINTENANCE OF TRAFFIC - [HR] [F&I]	16	\$121.00	\$1,936.00
630-2-11-2	2" PVC (SCH 40) UNDERGROUND CONDUIT - [LF] [F&I]	391	\$8.30	\$3,245.30
630-2-12-2-1	1-2" (HDPE SDR 11) UNDER PAVEMENT CONDUIT (DIRECTIONAL BORE) - [LF] [F&I]	515	\$25.00	\$12,875.00
630-2-12-2-2	2-2" (HDPE SDR 11) UNDER PAVEMENT CONDUIT (DIRECTIONAL BORE) - [LF] [F&I]	115	\$29.00	\$3,335.00
630-2-12-2-4	4-2" (HDPE SDR 11) UNDER PAVEMENT CONDUIT (DIRECTIONAL BORE) - [LF] [F&I]	130	\$39.00	\$5,070.00
630-2-12-2-5	5-2" (HDPE SDR 11) UNDER PAVEMENT CONDUIT (DIRECTIONAL BORE) - [LF] [F&I]	365	\$45.00	\$16,425.00
632-7-1-19D	SIGNAL CABLE (SPAN LENGTH 451' - 550') - [PI] [F&I]	1	\$7,200.00	\$7,200.00
632-7-1-4A	PEDESTRIAN SIGNAL CABLE - 4 CONDUCTOR - [PI] [F&I]	1	\$4,500.00	\$4,500.00
632-7-1-7	SIGNAL CABLE - 7 CONDUCTOR - [LF] [F&I]	390	\$5.70	\$2,223.00
632-7-1-7A	PEDESTRIAN SIGNAL CABLE - 7 CONDUCTOR - [PI] [F&I]	1	\$6,250.00	\$6,250.00
635-2-12-A	PULL BOX (17" x 30" x 12"D) HEAVY DUTY COVERS (TIER 15) - [EA] [F&I]	27	\$1,000.00	\$27,000.00
635-2-12-D	PULL BOX (17" x 30" x 24"D) HEAVY DUTY SPLIT COVERS (ITS) (TIER 15) - [EA] [F&I]	1	\$2,200.00	\$2,200.00
639-1-121	ELECTRICAL POWER SERVICE WITH METER BASE (UNDERGROUND) METER FURNISHED BY POWER COMPANY - [AS] [F&I]	1	\$1,325.00	\$1,325.00
639-2-1-3	ELECTRICAL SERVICE WIRE (SINGLE PHASE 3-WIRE, TRIPLEX) - [LF] [F&I]	500	\$5.50	\$2,750.00
639-3-11	ELECTRICAL SERVICE DISCONNECT (BREAKER BOX, SHEET T 6.2 OF PBC STANDARDS) - [EA] [F&I]	1	\$885.00	\$885.00
641-2-12-12	PRESTRESSED CONCRETE POLE (12' TYPE P-II) - [EA] [F&I]	1	\$1,250.00	\$1,250.00
646-1-11	ALUMINUM SIGNALS POLE, PEDESTAL WITH TRANSFORMER BASE (8 FEET ABOVE GROUND) - [EA] [F&I]	8	\$1,580.00	\$12,640.00
649-22-3	MAST ARM ASSEMBLY, FURNISH AND INSTALL ON EXISTING FOUNDATION, SINGLE ARM 40' (A40/S-P2/S) - [EA] [F&I]	1	\$28,841.00	\$28,841.00
649-22-6L	MAST ARM ASSEMBLY WITH STREET LIGHT, FURNISH AND INSTALL ON EXISTING FOUNDATION, SINGLE ARM 50' (A50/S-P3/S/L) - [EA] [F&I]	2	\$39,712.00	\$79,424.00
649-22-15L	MAST ARM ASSEMBLY WITH STREET LIGHT, FURNISH AND INSTALL ON EXISTING FOUNDATION, SINGLE ARM 70' (A70/S-P5/S/L) - [EA] [F&I]	1	\$48,645.00	\$48,645.00

DATE: 9/15/2023 SIGNAL PROJECT #: 2018709

INTERSECTION:	Weisman Way & Sansburys Way
INTERSECTION NO.#	29862

ITEM NO.#	PRODUCT NAME	QTY	PRICE	LINE TOTAL
649-2-16-45	DRILLED SHAFT FOUNDATION ASSEMBLY, 16' DEEP AND 4.5' DIAMETER, FURNISH AND INSTALL (DS/16/4.5) - [EA] [F&I]	3	\$18,500.00	\$55,500.00
649-2-16-45-AD	ADDITIONAL DEPTH FOR DRILLED SHAFT FOUNDATION ASSEMBLY, 16' DEEP AND 4.5' DIAMETER, FURNISH AND INSTALL (DS/16/4.5) - [LF] [F&I]	10.5	\$950.00	\$9,975.00
649-2-16-50	DRILLED SHAFT FOUNDATION ASSEMBLY, 16' DEEP AND 5.0' DIAMETER, FURNISH AND INSTALL (DS/16/5.0) - [EA] [F&I]	1	\$18,500.00	\$18,500.00
649-2-16-50-AD	ADDITIONAL DEPTH FOR DRILLED SHAFT FOUNDATION ASSEMBLY, 16' DEEP AND 5.0' DIAMETER, FURNISH AND INSTALL (DS/16/5.0) - [LF] [F&I]	4.5	\$950.00	\$4,275.00
650-1-13	TRAFFIC SIGNAL HEAD ALUMINUM (3-SECTION, 1-WAY) INCLUDES BACKPLATES - [AS] [F&I]	9	\$1,100.00	\$9,900.00
650-1-14	TRAFFIC SIGNAL HEAD ALUMINUM (4-SECTION, 1-WAY) INCLUDES BACKPLATES - [AS] [F&I]	1	\$1,350.00	\$1,350.00
653-191	PEDESTRIAN SIGNAL - COUNT DOWN (1-WAY) ALUMINUM - [EA] [F&I]	8	\$800.00	\$6,400.00
660-2-106-B	LOOP ASSEMBLY (TYPE F - 46'). - [EA] [F&I]	11	\$2,450.00	\$26,950.00
670-5-310-A	TRAFFIC CONTROLLER ASSEMBLY (TYPE 6 - INSTALL ONLY) - [AS] [I]	1	\$9,500.00	\$9,500.00
700-5-42	INTERNALLY ILLUMINATED SIGN (8') INSTALL ONLY - [EA] [I]	4	\$500.00	\$2,000.00
715-5-32	LUMINAIRE AND BRACKET ARM - GALV STEEL - [EA] [F&I]	3	\$1,350.00	\$4,050.00
665-1-31	Pedestrian Detector (Push Button) - Install Only - [EA] [I]	8	\$200.00	\$1,600.00

TOTAL: \$418,019.30

Comments:	Subtotal: \$418,019.30 + \$83,603.86 (20% contingency)
	GRAND TOTAL: \$501,623.16

OF QUANTITIES
NOTES
ION PLANS
MARKING PLAN
TABULATION
ASSEMBLIES
TAILS

SIGNALIZATION PLANS

**WEISMAN WAY/MANHEIM
AT SANSBURYS WAY**

P.B.C. PROJECT #2018709

P.B.C. INTERSECTION #29862

100% P

PROJECT LOCATION

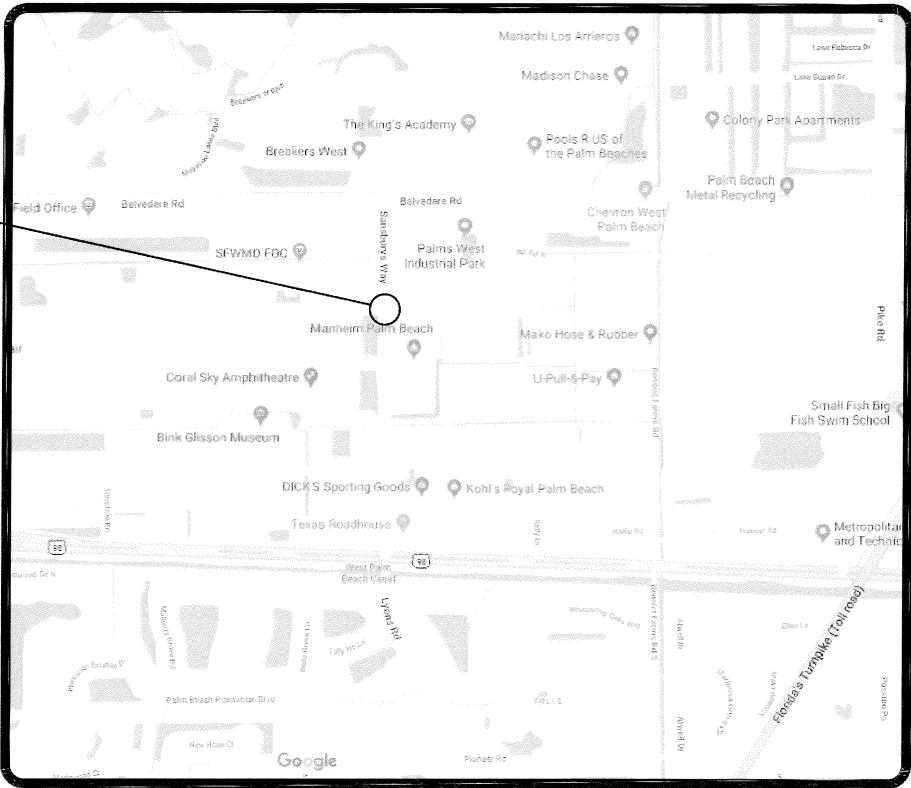

LOCATION MAP
NOT TO SCALE

SEC. 32, TWP. 43S., RGE. 42E.

SANSBURYS WAY = 45 M.P.H. SPEED LIMIT

SIGNA
TO BI

TRICK
FJAFA
JMLC

PLAN:

SIMME
2581
WEST

NOTE: THE SCALE OF THESE P
HAVE CHANGED DUE TO REPRC

ENGINEER'S CERTIFICATION

I HEREBY CERTIFY THAT THE A
IN SUBSTANTIAL COMPLIANCE W
CRITERIA IN EFFECT ON THIS I
ENGINEERING DEPARTMENT AND
DEPARTMENT OF TRANSPORTATI

DATE: _____ PROFESS

PATRICIA BARR

PAVEMENT (1")	SY					1745		1745		1745			
CTION COURSE 1" TRAFFIC C	TN					142		142		142			
ER	LF					312		312		312			
	LF					13		13		13			
	SY					164		164		164			
(F & I)	SF					64		64		64			
GROUND CONDUIT (F & I)	LF	391						391		391			
ER PAVEMENT CONDUIT (DIRECTIONAL BORE) (F	LF	515						515		515			
ER PAVEMENT CONDUIT (DIRECTIONAL BORE) (F	LF	115						115		115			
ER PAVEMENT CONDUIT (DIRECTIONAL BORE) (F	LF	130						130		130			
ER PAVEMENT CONDUIT (DIRECTIONAL BORE) (F	LF	365						365		365			
NGTH) (751' - GREATER) (F & I)	PI	1						1		1			
LE - 4 CONDUCTOR (F & I)	PI	1						1		1			
LE - 7 CONDUCTOR (F & I)	PI	1						1		1			
OUNT - UNDERGROUND (INSTALL ONLY)	LF	1850						1850		1850			
ON (INSTALL TERMINATION)	EA	24						24		24			
1" D) HEAVY DUTY COVERS (TIER 15) (F & I)	EA	27						27		27			
1" D) HEAVY DUTY SPLIT COVERS (ITS) (TIER 15) (F	EA	1						1		1			
VICE WITH METER BASE (ABOVE GROUND)	AS	1						1		1			
OWER COMPANY)													
RE (SINGLE PHASE 3-WIRE, TRIPLEX) (4 AWG) (F &	LF	500						500		500			
CONNECT (BREAKER BOX, SHEET T 6.2 OF PBC	EA	1						1		1			
3 POLE (12' TYPE P-II) (F & I)	EA	1						1		1			
LE, PEDESTAL WITH TRANSFORMER BASE (8 FEET	EA	8						8		8			
ITION ASSEMBLY, 16" DEEP AND 4.5" DIAMETER, (S/16/4.5)	EA	3						3		3			
DRILLED SHAFT ASSEMBLY 16" DEEP AND 4.5" (4.5)	LF	10.5						10.5		10.5			
ITION ASSEMBLY, 16" DEEP AND 5.0" DIAMETER, (S/16/5.0)	EA	1						1		1			
DRILLED SHAFT ASSEMBLY 16" DEEP AND 5.0" (5.0)	LF	4.5						4.5		4.5			
URNISH AND INSTALL ON EXISTING FOUNDATION, (2/5)	EA	1						1		1			
1TH STREET LIGHT, FURNISH AND INSTALL ON SINGLE ARM 50' (A50/S-P3/S/L)	EA	2						2		2			
1TH STREET LIGHT, FURNISH AND INSTALL ON SINGLE ARM 70' (A70/S-P5/S/L)	EA	1						1		1			
LUMINUM (3-SECTION, 1-WAY) INCLUDES	AS			9				9		9			
LUMINUM (4-SECTION, 1-WAY) INCLUDES	AS			1				1		1			
OUNT DOWN (1-WAY) ALUMINUM (F & I)	AS			8				8		8			
N 4 - CAMERA SYSTEM (ITERIS) COMPLETE (F & I)	EA	1						1		1			
(PUSH BUTTON) (F & I)	EA	8						8		8			
SSEMBLY (TYPE 6) AS PER NAZTEC (F & I)	AS	1						1		1			
OCATE)	AS					1		1		1			
OVE)	AS					2		2		2			
RHEAD) (≤12 SF)	EA			2				2		2			
ED SIGN (8") FLUORESCENT (F & I)	EA			4				4		4			
KER (F & I) (TYPE B)	EA					6		6		6			
WHITE) (SOLID) (6")	LF					100		100		100			
WHITE) (SOLID) (12")	LF					541		541		541			
WHITE) (SOLID) (24")	LF					146		146		146			
WHITE) (SOLID) (ARROW)	EA					3		3		3			
YELLOW) (2'-4' SKIP) (6")	GM					0.06		0		0.06			
ISH) (WHITE) (SOLID) (ARROW)	EA					13		13		13			

PAY ITEM NOTES:

102-1-A	INCLUDES COST OF REMOVING ALL CONFLICTING PAVEMENT
110-1-1	INCLUDES TREE REMOVAL.
630-2-12-2-1	CONSISTS OF THE COST ASSOCIATED WITH FURNISHING AND (HDPE SDR II) UNDERPAVEMENT BY DIRECTIONAL BORE.
630-2-12-2-2	CONSISTS OF THE COST ASSOCIATED WITH FURNISHING AND (HDPE SDR II) UNDERPAVEMENT BY DIRECTIONAL BORE. FU STANDARD BENDS/SWEEP PER SIGNAL DETAILS SHEET T-8 PULL BOXES.
630-2-12-2-3	CONSISTS OF THE COST ASSOCIATED WITH FURNISHING AND (HDPE SDR II) UNDERPAVEMENT BY DIRECTIONAL BORE.
630-2-12-2-4	CONSISTS OF THE COST ASSOCIATED WITH FURNISHING AND (HDPE SDR II) UNDERPAVEMENT BY DIRECTIONAL BORE.
630-2-12-2-5	CONSISTS OF THE COST ASSOCIATED WITH FURNISHING AND (HDPE SDR II) UNDERPAVEMENT BY DIRECTIONAL BORE.
635-2-12-A	TRAFFIC SIGNAL PULL BOXES SHALL BE 17"x30"x12"D IN , 15 OR HIGHER. LIDS TO BE MARKED "TRAFFIC SIGNAL".
635-2-12-D	ITS PULL BOX SHALL BE 17"x30"x24"D IN DIMENSION AND LIDS TO BE MARKED "ITS".
639-2-1-3	ELECTRICAL SERVICE WIRE SHALL BE 4 AWG.
649-2-XX-XX 649-XX-XX	AT THE DISCRETION OF THE ENGINEER OF RECORD AND W/ TRAFFIC ENGINEERING, FINAL LOCATIONS OF THE MAST ARM IF THERE IS ANY CONFLICT WITH UTILITIES. SIGNAL CONTRA FOUNDATION ELEVATIONS.
650-1-13 650-1-14	TRAFFIC SIGNAL HEADS ARE TO BE CAST ALUMINUM. LED & ALL SIGNAL DISPLAYS, INCLUDING ARROWS. THESE MODULE. MANUFACTURER'S WARRANTY OF AT LEAST FIVE YEARS. THE BE 10 WATTS FOR RED BALLS, 14 WATTS FOR GREEN BAL ARROWS. ALL SIGNAL HEADS SHALL HAVE TUNNEL VISORS
660-4-XX	CONTRACTOR SHALL INSTALL ALL VIDEO CAMERA COMPONE INTERSECTION HAS THE APPROPRIATE COMMUNICATION MEDI MONITOR TRAFFIC FLOW. INCLUDES COSTS OF ALL NECESSA OPERATE THE CAMERA. COAX AND THE POWER CABLES TO BE IN SAME JACKETED CABLE AND SHOULD BE RUN IN A BOXES WITH NO SPLICES. INITIAL AND FINAL DETECTION ZC BEACH COUNTY TRAFFIC ENGINEERING. INSTALLATION SHALL ALL NECESSARY HARDWARE. PBC USES ITERIS SYSTEM; OB PURCHASING SYSTEM.
665-1-11	ALL PEDESTRIAN PUSH BUTTONS SHALL BE ADA COMPLIAN; FTP-68B-06 SHALL BE INCLUDED IN UNIT PRICE FOR PEL
700-5-22	INTERNALLY ILLUMINATED STREET NAME SIGNS SHALL BE DI MOUNTED EXCEPT WHERE NOTED. CONTRACTOR SHALL INST INTERNALLY ILLUMINATED STREET NAME SIGN. PER THE F.D. MOUNTING HARDWARE IS INCLUDED IN THE SIGN PAY ITEM. TRANSLUCENT FILM FOR SIGN PANEL.

IT MARKINGS DAMAGED DURING CONSTRUCTION.
SUBMIT FOR APPROVAL TO THE ENGINEER OF
JNS OR DESIGN DATA FOR ALL MATERIAL PROPOSED
ED TO:

' DETAILED)

SSSES AND FOUNDATIONS

ED TO THE ENGINEER OF RECORD WITH A COPY OF
CHARGE OF THE PROJECT. ALLOW 30 DAYS TURN

D ELECTRONICALLY TO THE ENGINEER OF RECORD
) AND JEAN MILORD (Jmilord@pbcgov.org). ALLOW 30

Y TRAFFIC OPERATIONS AT 561 233-3900
RK IS BEING DONE WITHIN 10 FEET OF ANY SIGNAL
LATION WORK.
- BE PROVIDED WITH SHOP DRAWINGS AND

CEPT EQUIPMENT SHOWN OR NOTED ON THE PLAN
THE CONTRACTOR AND STOCKPILED WITHIN THE
VTAINING AGENCY. CONTROL DEVICES SHALL THEN BE
ICY.

r 2555 VISTA PARKWAY WEST PALM BEACH FL -
VCRETE POLES CAN BE DISCARDED/PROPERLY

FIED BY THE CONTRACTOR TWO (2) BUSINESS DAYS
O THAT A COMPANY REPRESENTATIVE CAN BE

NE NUMBERS:	CONTACT PERSON:
7-5016	JORDAN SANCHEZ
3-1820	BILL RODRIGUEZ
1-6014	JULIO MARQUES
3-6116	JACKIE MICHELS
3-3900	SUPERINTENDENT
1-4365	DANIEL RODRIGUEZ
7-0240	DINO FARRUGGIO

AND ANY OTHER POLE REMOVAL), IT IS THE
NDATION OR STRUCTURE IN THE CLOSE PROXIMITY
DETERMINES ANY STRUCTURE OR FOUNDATION IN
IALLY BE COMPROMISED, THEY SHALL SECURE IT.
CHECKING INTERSECTION OPERATIONS AS THEY

HICLE DETECTION WILL BE IMPACTED AND OUT OF
TECTION OUT OF SERVICE FOR MORE THAN 3 DAYS

THE LIMITS OF CONSTRUCTION ARE TO BE
VD MONUMENTS IN CONFLICT WITH THE WORK AND IN
E TO BE PROPERLY REFERENCED BY A
COORDINANCE WITH THE MINIMUM TECHNICAL
D SURVEYORS. PRIOR TO BEGINNING WORK AT THE
O REFERENCE AND RESTORE, UPON COMPLETION OF
VTRACTOR SHALL FURNISH, TO THE DISTRICT
LAND SURVEYOR'S REFERENCE DRAWING.
IMITS OF CONSTRUCTION SHALL BE PROTECTED
AS PUBLIC LAND CORNERS, EXCEPT THAT
E THE N.G.V.D. BENCH MARK UPON
PTLY TRANSMIT ALL DISPLACED OR
YOR, WHO WILL NOTIFY THE GEODETIC

JNTY TRAFFIC OPERATIONS, SUPERINTENDENT,

TO BE IN GOOD WORKING ORDER UNLESS PBCTED
, ANY SUBSEQUENT DAMAGE TO THE SIGNAL

- 25.) THE LOCATIONS OF EXISTING UTILITIES SHOWN IN THE PLANS ARE APPROXIMATE. EXACT LOCATIONS SHALL BE DETERMINED BY THE CONTRACTOR DURING CONSTRUCTION.
- 26.) THE PROPOSED LOCATIONS OF ALL POLES, PEDESTALS, AND OTHER EQUIPMENT REQUIRING EXCAVATION SHALL BE CONSIDERED APPROXIMATE DUE TO THE POTENTIAL OF CONFLICT WITH UNDERGROUND UTILITIES. SLIGHT ADJUSTMENTS DIRECTED BY THE ENGINEER MAY ALSO BE NECESSARY TO SATISFY SAFETY CODES.
- 27.) MAST ARM CONCRETE FOUNDATION SHALL BE POURED IN A SINGLE POUR; FOUNDATIONS THAT DO NOT COMPLY WITH THIS REQUIREMENT SHALL BE COMPLETELY REMOVED AND RE-POURED AT THE CONTRACTOR'S EXPENSE. A DRILL SHAFT INSTALLATION PLAN SHALL BE PART OF THE SHOP DRAWINGS.
- 28.) CONTRACTOR IS RESPONSIBLE FOR THE PROPER BOLT PROJECTION ABOVE FINISHED SIDEWALK GRADE. THE CONTRACTOR SHALL ENSURE THAT THE DRILL SHAFT AND BOLT PATTERNS ARE INSTALLED CORRECTLY SO THAT THE MAST ARM WILL BE ANGLED AS SHOWN ON THE PLANS.
- 29.) IF PHASE 1 (UNDERGROUND ONLY) AND PHASE 2 (ABOVE GROUND) IS PROPOSED ON PERMITTING PROJECTS, CONTRACTOR IS RESPONSIBLE TO ENSURE EXPOSED BOLTS ARE PROTECTED FROM THE ELEMENTS (INSTALL BOLT CAPS).
- 30.) FOR MAST ARM SIGNAL INSTALLATIONS, THE CONTRACTOR SHALL INSTALL WIRE MESH SUPPORT GRIPS FOR STRAIN RELIEF. ALL SIGNAL CABLE MUST BE HELD BY A STRAIN RELIEF (LE GRAND BC0750FSS) ATTACHED TO THE J HOOK INSIDE OF A MAST ARM. TO USE APPROVED EQUIVALENT, SHOP DRAWINGS SHALL BE SUBMITTED TO PBC ENGINEER FOR PRE-APPROVAL. WRITTEN APPROVAL FOR SHOP DRAWINGS SHALL BE PROVIDED AT TIME OF FINAL SIGNAL INSPECTION.
- 31.) SIGNAL CABLE - CONTRACTOR SHALL INSTALL TRAFFIC SIGNAL CABLE IN ACCORDANCE WITH PBC STANDARDS. THERE SHALL BE NO SPLICING. IF CONTINUOUS RUNS ARE NOT POSSIBLE, THEN TERMINAL BLOCK SHALL BE USED.
- 32.) CONTROLLER CABINET - THE CONTROLLER CABINET SHALL BE INSTALLED SUCH THAT THE CONTROLLER DOOR WILL OPEN AWAY FROM THE ROADWAY TRAVEL LANES AND POSITIONED TO ALLOW THE TECHNICIAN TO SEE THE INTERSECTION.
- 33.) CONTRACTOR TO PROVIDE A MINIMUM 2 FEET CABLE SLACK AT ALL PULL BOXES AND HAND HOLES.
- 34.) PEDESTRIAN SIGNALS - EACH PEDESTRIAN SIGNAL SHALL BE FED WITH ONE 7 CONDUCTOR CABLE FOR PED SIGNAL HEAD AND ONE 4 CONDUCTOR CABLE FOR THE PED DETECTOR/PUSH BUTTON. THESE CABLES WILL RUN FROM EACH PEDESTRIAN SIGNAL/DETECTOR DIRECTLY TO CONTROL BOX WITH NO SPLICES.
- 35.) POSITION PULL BOXES, CABINETS, POLES AND OTHER OBSTRUCTIVE ITEMS CLEAR OF CURB CUT RAMPS. PULL BOXES SHALL BE PLACED BEHIND CURB AND GUTTER. IF THERE IS NO CURB AND GUTTER, THEN PULL BOXES SHALL BE PLACED AT LEAST 10 FEET FROM THE EDGE OF PAVEMENT. PULL BOXES SHALL NOT BE LOCATED AT THE BOTTOM OF ANY DITCH OR RETENTION AREA/POND. ALL PULL BOXES SHALL HAVE A 1' WIDE (MIN.) X 6" DEEP CONTINUOUS CONCRETE APRON SLOPED AWAY FROM BOX (TYPICALLY 1%).
- 36.) SPARE CABINET CONDUIT SHALL BE STUBBED AND CAPPED IN THE NEAREST PULL BOX. USE GEL CAPS FOR ANY SPARE/USED CONDUIT.
- 37.) THE USE OF "JONES" PLUGS FOR SIGNAL INSTALLATIONS SHALL BE PROHIBITED.
- 38.) ALL FIELD WIRING SHALL BE NEATLY BUNDLED AND CLEARLY IDENTIFIED WITH PERMANENT LEGIBLE, WEATHERPROOF TAGS THAT ARE SECURELY ATTACHED TO EACH CABLE. THE TAGGING SYSTEM PROPOSED SHALL BE SUBMITTED FOR APPROVAL WITH THE OTHER EQUIPMENT SUBMITTALS REQUIRED FOR THIS PROJECT.
- 39.) THE CONTRACTOR SHALL VERIFY COLOR CODES OF SIGNAL CABLE WITH PALM BEACH COUNTY BEFORE ORDERING.
- 40.) DO NOT INSTALL LOOP LEAD-INS WITHIN PAVERS OR IN THE AREA BETWEEN PAVERS AND EDGE OF CURB. FOR ANY INTERSECTIONS WITH PAVERS, THE LEAD-INS NEED TO RUN THROUGH CONDUITS UNDER THE PAVERS.
- 41.) INSTALL PEDESTRIAN SIGNALS PER ADA CLEARANCES, PROVIDING CONTINUOUS UNOBSTRUCTED PEDESTRIAN/WHEELCHAIR CIRCULATION PATH TO PEDESTRIAN AREAS (PUSH BUTTON, RAMP, ETC).
- 42.) THE T-BASE (PEDESTRIAN PEDESTAL BASE) SHALL BE ORIENTED SO THE TECHNICIAN CAN OPEN THE DOOR AND ALSO SEE ON-COMING TRAFFIC. CAULK AS NEEDED IF THERE IS A LARGE GAP BETWEEN CONCRETE FOUNDATION/SIDEWALK AND THE PEDESTAL BASE.
- 43.) PEDESTAL POLE BASE NUT SHOULD BE LARGE ENOUGH TO COVER HOLE AND WASHER.
- 44.) ALL SET SCREWS MUST BE INSTALLED (NONE SHOULD BE MISSING). MOST MANUFACTURES HAVE THEM DESIGNED INTO THE PED BASES FROM FACTORY. WHEN PEDESTAL POLE IS SET AT PROPER DIRECTION, DRILL AND TAP HOLE THRU BASE AND ALUMINUM CONDUIT. SET SCREWS SHOULD GO THROUGH SIDE OF BASE INTO PEDESTAL POLE TO PENETRATE INTO PIPE TO KEEP IT FROM ROTATING. USING A ¼"x20 SS HEX HEAD BOLT WILL LOCK THE PIPE FROM TURNING.
- 45.) BOLTS SHOULD BE LONG ENOUGH TO PROTRUDE THROUGH THE THREADED HOLE AND HOLD WASHER AND NUT.
- 46.) CAULKING/SEALANT TO BE APPLIED AT ALL SIGNALS FLANGE CONNECTIONS, INCLUDING BUT NOT LIMITED TO THE TOP OF THE FLASHER SIGNAL.
- 47.) THE CONTRACTOR SHALL BUILD NEW ELECTRICAL POWER SERVICE AND DISCONNECT ON MONUMENT WITH A MINIMUM HEIGHT OF EIGHT (8) FEET.
- 48.) THE CONTRACTOR SHALL COORDINATE AND FIELD VERIFY LOCATION(S) OF ELECTRICAL SERVICE POINT PRIOR TO INSTALLING CONDUIT, DISCONNECT SWITCH, TRANSFORMER AND PULL BOXES.
- 49.) POWER SOURCE - ON MODIFICATIONS/UPGRADES TO EXISTING TRAFFIC SIGNALS A) IF ADDING LOAD, THEN ADD METER; B) IF NOT ADDING LOAD (IE JUST RELOCATING SAME EQUIPMENT) KEEP EXISTING POWER SOURCE. ALL NEW INSTALLED SIGNALS WILL BE METERED. CONTRACTOR SHALL COORDINATE WITH FPL FOR NEW INSTALLATION AS REQUIRED. ELECTRIC SERVICE TO BE SET UP IN CONTRACTOR'S NAME, THEN TRANSFERRED TO PBC TRAFFIC DIVISION AFTER 90 DAY BURN AND FINAL ACCEPTANCE.
- 50.) THE CONTRACTOR SHALL COORDINATE WORK SCHEDULE, COORDINATE TIMING AND AUTHORIZATION OF POWER SERVICE WITH PALM BEACH COUNTY TRAFFIC ENGINEERING. CONTACT TIMING ENGINEER (561-684-4030) 2 WEEKS IN ADVANCE OF CONSTRUCTION AND TO COORDINATE TIMING CHANGES PRIOR TO LOOP DAMAGE.
- 51.) THE CONTRACTOR SHALL SUBMIT IN WRITING TO THE MAINTAINING AGENCY FOR FINAL INSPECTION. ALLOW TWO (2) WEEKS FOR INSPECTION.
- 52.) AT THE TIME OF FINAL ACCEPTANCE OF THE PROJECT, THE CONTRACTOR SHALL FURNISH PALM BEACH COUNTY WITH TWO (2) COMPLETE COPIES OF SIGNED AND SEALED AS-BUILT PLANS AND CONSULTANT TO PROVIDE ELECTRONIC CADD FILES.

ITEMS COMPLETED, THE CONTRACTOR WILL REQUEST THEM
CONTRACTOR OR CEI SHALL REQUEST ACTIVATION TWO WEE
56.) PER REQUEST OF CONTRACTOR OR CEI PALM BEACH
THE SIGNAL INSPECTION IS COMPLETED AND ALL OUTSTANDI
OR CEI SHALL REQUEST ACTIVATION TWO WEEKS IN ADVANCE
57.) DURING CONSTRUCTION OF NEW SIGNAL EQUIPMENT
SHALL COORDINATE THEIR ACTIVITIES TO ENSURE THAT FUN
58.) SPAN WIRE SIGNALS ONLY - DISCONNECTS FOR SIGN
#1150-18-T APL 659-004-007 WITH TRI STUD SPAN WIRE
BOTH ARE MANUFACTURED BY ENGINEERING CASTINGS AND
APPROVED BY PBC TRAFFIC PRIOR TO ORDERING VIA THE

MAINTENANCE OF TRAFFIC:

- 59.) THE CONTRACTOR SHALL PREPARE TRAFFIC CONTROL
THE ENGINEER OF RECORD AND THE TRAFFIC DIVISION - ,
PROPOSED WORK. NO LANE CLOSURES ARE ALLOWED DURING
ANALYSIS(S).
- 60.) THE CONTRACTOR SHALL INSTALL CONSTRUCTION SIGN
SHALL MAINTAIN SIGNING DURING ALL PHASES OF CONSTRUCTION
61.) NOTIFICATION OF PROPOSED LANE CLOSURES OR TEMPORARY
14 BUSINESS DAYS IN ADVANCE OF CLOSURE OR DETOUR.
62.) AT THE DISCRETION OF THE ENGINEER, IF A LANE CLOSURE
SHALL BE DIRECTED TO REOPEN THE CLOSED LANE(S) UNLESS AT AN
ACCEPTABLE LEVEL.
- 63.) THE ALTERATION OF TRAFFIC TRAVEL-WAYS TO CREATE
AND MATERIALS ARE READY FOR THE CONSTRUCTION IN THE
64.) REGULATORY SPEED DURING CONSTRUCTION SHALL BE
65.) THE CONTRACTOR SHALL REMOVE OR COVER ANY EXISTING
WHICH CONFLICT WITH THE TRAFFIC CONTROL THROUGH THE
THE CONTRACTOR SHALL RESTORE THE SIGNS OR PAVEMENT
66.) VARIABLE MESSAGE SIGNS SHALL BE INSTALLED SEVERAL
ACTIVATION AS FOLLOWS:

PRIOR TO SIGNAL ACTIVATION

T	R	A	F	F	I	C	
	S	I	G	N	A	L	
W	I	L	L		B	E	

PA

	A	C	T	I	V	E	
O	N		T	H	U	R	S
	J	U	N		2	5	

PA

F

(DATE SHOWN IS AN EXAMPLE ONLY)

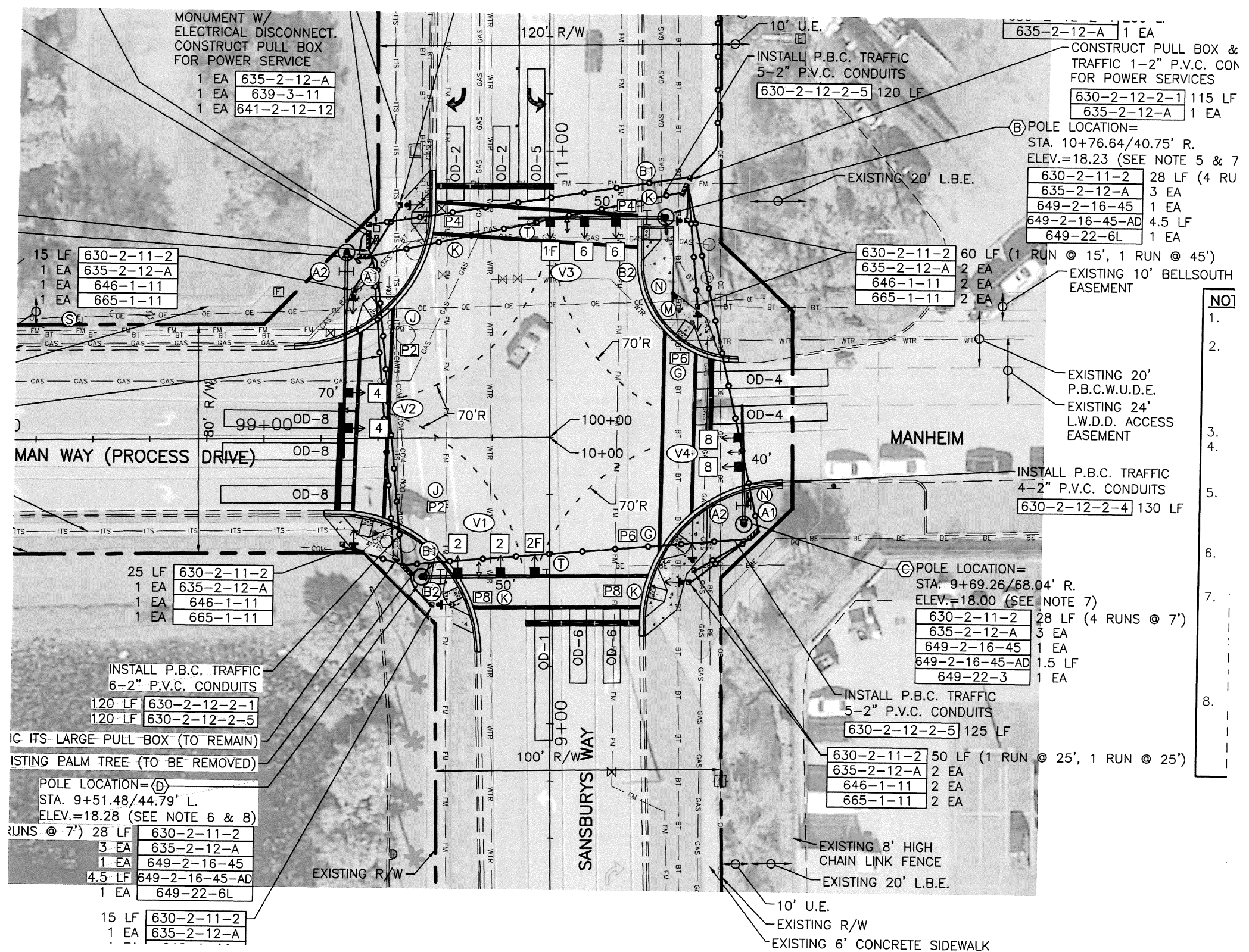

MONUMENT W/
ELECTRICAL DISCONNECT.
CONSTRUCT PULL BOX
FOR POWER SERVICE

1 EA	635-2-12-A
1 EA	639-3-11
1 EA	641-2-12-12

15 LF	630-2-11-2
1 EA	635-2-12-A
1 EA	646-1-11
1 EA	665-1-11

25 LF	630-2-11-2
1 EA	635-2-12-A
1 EA	646-1-11
1 EA	665-1-11

INSTALL P.B.C. TRAFFIC
6-2" P.V.C. CONDUITS

120 LF	630-2-12-2-1
120 LF	630-2-12-2-5

IC ITS LARGE PULL BOX (TO REMAIN)

EXISTING PALM TREE (TO BE REMOVED)

POLE LOCATION=(D)
STA. 9+51.48/44.79' L.
ELEV.=18.28 (SEE NOTE 6 & 8)

RUNS @ 7') 28 LF

3 EA	630-2-11-2
1 EA	635-2-12-A
1 EA	649-2-16-45
4.5 LF	649-2-16-45-AD
1 EA	649-22-6L

15 LF	630-2-11-2
1 EA	635-2-12-A

INSTALL P.B.C. TRAFFIC
5-2" P.V.C. CONDUITS

630-2-12-2-5	120 LF
--------------	--------

635-2-12-A	1 EA
------------	------

CONSTRUCT PULL BOX &
TRAFFIC 1-2" P.V.C. CON
FOR POWER SERVICES

630-2-12-2-1	115 LF
635-2-12-A	1 EA

POLE LOCATION=
STA. 10+76.64/40.75' R.
ELEV.=18.23 (SEE NOTE 5 & 7)

630-2-11-2	28 LF (4 RU
635-2-12-A	3 EA
649-2-16-45	1 EA
649-2-16-45-AD	4.5 LF
649-22-6L	1 EA

EXISTING 10' BELL SOUTH
EASEMENT

EXISTING 20'
P.B.C.W.U.D.E.
EXISTING 24'
L.W.D.D. ACCESS
EASEMENT

INSTALL P.B.C. TRAFFIC
4-2" P.V.C. CONDUITS

630-2-12-2-4	130 LF
--------------	--------

POLE LOCATION=
STA. 9+69.26/68.04' R.
ELEV.=18.00 (SEE NOTE 7)

630-2-11-2	28 LF (4 RUNS @ 7')
635-2-12-A	3 EA
649-2-16-45	1 EA
649-2-16-45-AD	1.5 LF
649-22-3	1 EA

INSTALL P.B.C. TRAFFIC
5-2" P.V.C. CONDUITS

630-2-12-2-5	125 LF
--------------	--------

630-2-11-2	50 LF (1 RUN @ 25', 1 RUN @ 25')
635-2-12-A	2 EA
646-1-11	2 EA
665-1-11	2 EA

EXISTING 8' HIGH
CHAIN LINK FENCE
EXISTING 20' L.B.E.

10' U.E.
EXISTING R/W
EXISTING 6' CONCRETE SIDEWALK

- NO
- 1.
 - 2.
 - 3.
 - 4.
 - 5.
 - 6.
 - 7.
 - 8.

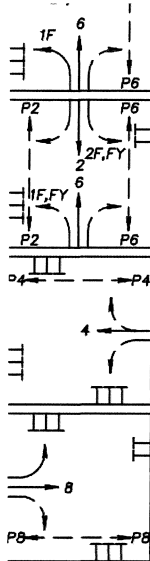

DIAGRAM



VIDEO DETECTOR CHART	
DETECTOR NO.	MOVEMENTS
V-1	2, 2F
V-2	4
V-3	1F, 6
V-4	8

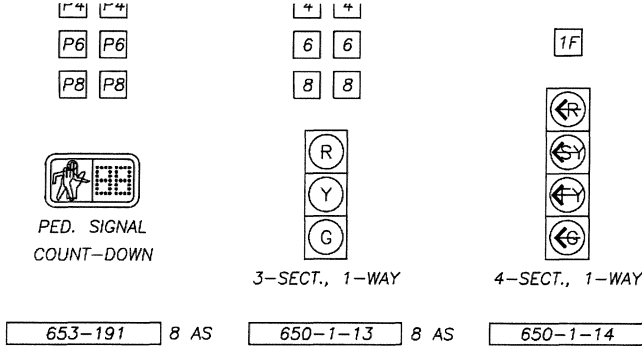

DETAIL OF STREET NAME SIGN
N.T.S.

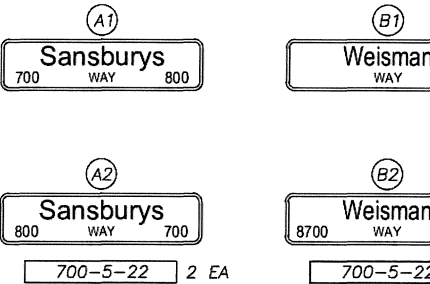

-MAXIMUM SIGN DIMENSION 8' LENGTH MAX. ,
-SIGNS SHALL MEET PALM BEACH COUNTY TY
MUTCD. REFER TO PALM BEACH COUNTY TYF
DETAILS ON SIGN INSTALLATION, DIMENSION ,

DETAIL OF SIGNS
N.T.S.

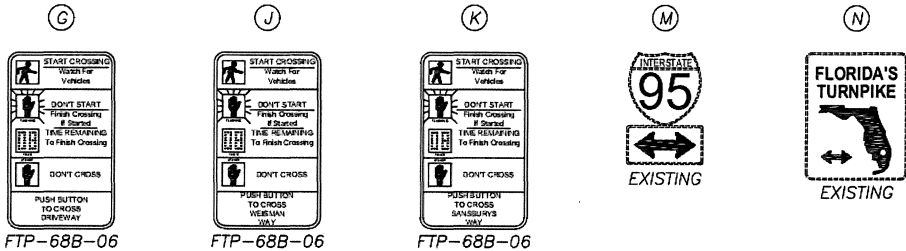

SPECIAL SIGNAL OPERATING PLAN.
) MINOR STREET IS WEISMAN WAY/MANHEIM.

COST OF FTP-68B-06 SIGNS SHALL BE
INCLUDED UNDER PAY ITEM 665-1-11.

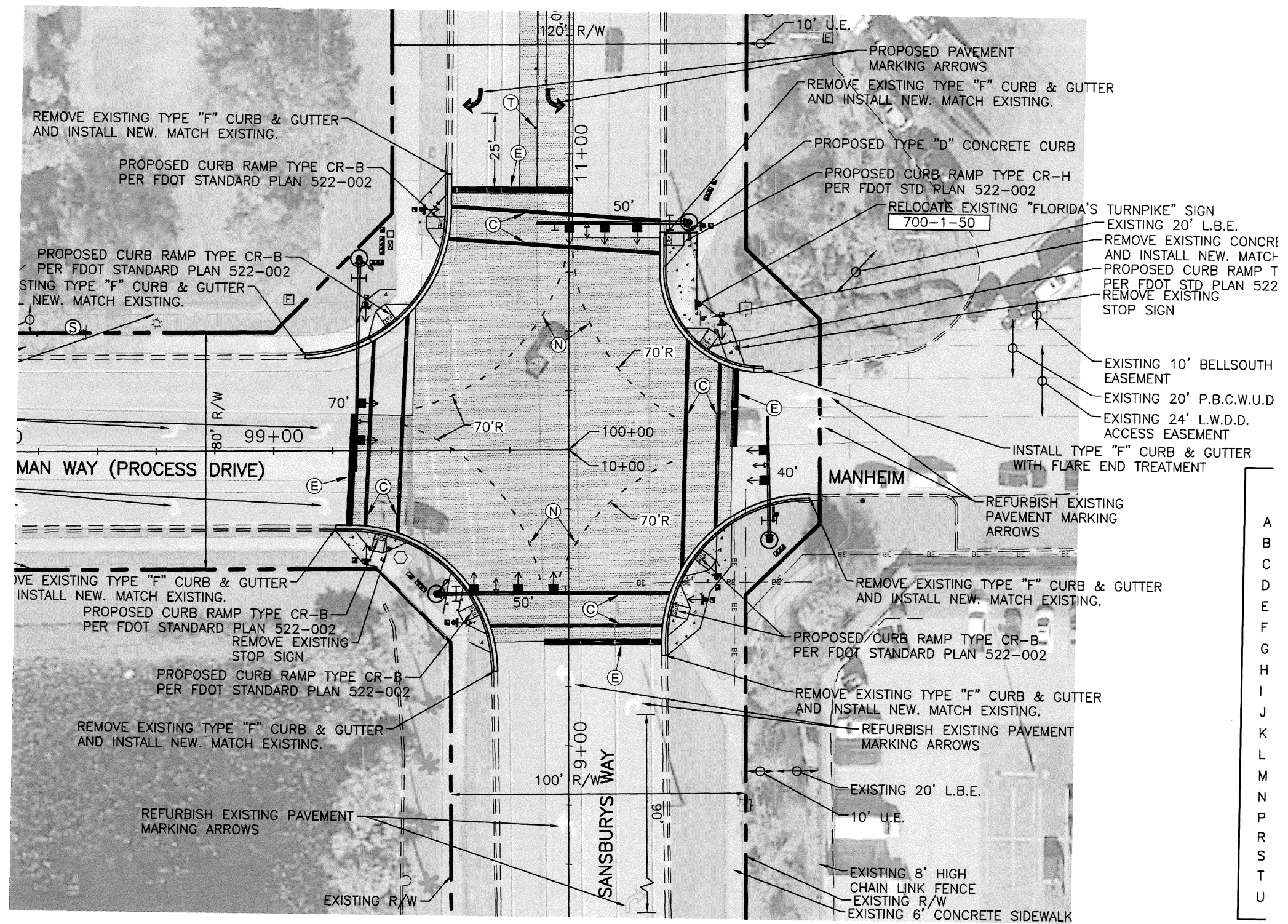

A
B
C
D
E
F
G
H
I
J
K
L
M
N
P
R
S
T
U

ID NUMBERS	DESIGNATION	ARM ID	FAA (ft.)	ARM ID	SAA (ft.)	(deg)	(deg)	POLE ID	UAA (ft.)	UB (ft.)	SHAFT ID
A	A70/S-P5/S/L-SPECIAL	A70/S					45	P5/S/L		22	SPECIAL
B	A50/S-P3/S/L-SPECIAL	A50/S					90	P3/S/L		21	SPECIAL
C	A40/S-P2/S-SPECIAL	A40/S						P2/S	24	21	SPECIAL
D	A50/S-P3/S/L-SPECIAL	A50/S					45	P3/S/L		21	SPECIAL

SPECIAL MAST ARM ASSEMBLIES DATA TABLE												TABLE DATE 07-31-20	
STRUCTURE NUMBERS	POLE BASE CONNECTION (IN)					SHAFT AND REINF.							
	#BOLTS	BA	BB	BC	BF	DA(FT)	DB(FT)	RA	RB	RC	RD(IN)	RE	RF(IN)
A	8	40	2.5	2	40	20.5	5	11	19	10	8	11	0
B	8	36	2.5	2	40	20.5	4.5	11	15	10	8	11	0
C	6	34	2.5	2	40	17.5	4.5	11	15	10	8	8	0
D	8	36	2.5	2	40	20.5	4.5	11	15	10	8	11	0

NOTES:

1. If an entry appears in column FAA, a shorter arm is required. This is obtained by removing length from the arm tip and the arm length shortened from FA to FAA. SAA Similar.
2. If an entry appears in column UAA, a shorter pole is required. This is obtained by removing length from the pole tip and the pole height shortened from UA to UAA.
3. Work this sheet with the Signal Designer's "Mast Arm Tabulation". See "Mast Arm Tabulation" for special instructions that include non-standard Handhole location, paint color, terminal compartment requirement, and pedestrian features.
4. Work with Indexes 649-030 and 649-031.

GEOTECHNICAL NOTES:

1. The Contractor shall anticipate difficult drilled shaft installation due to the presence of potentially loose sand, compacted fill, occasional shell layers or any combination of these layers. The presence of difficult soil conditions may occur at varying depths below the ground.
2. The Contractor shall anticipate potential cave-in of the sandy soils and shell. The Contractor shall take steps to mitigate the difficult drilled shaft installation through the use of specialized equipment and/or procedures.
3. All costs for labor, materials, equipment and incidentals necessary to mitigate difficult drilled shaft foundation installation shall be incidental to the pay item of the structure for which the drilled shaft foundation is required.

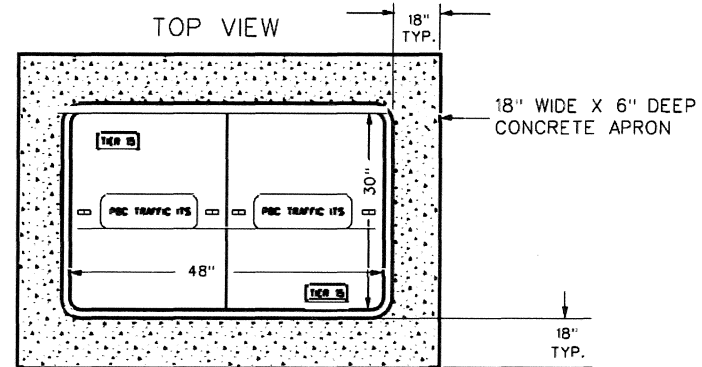
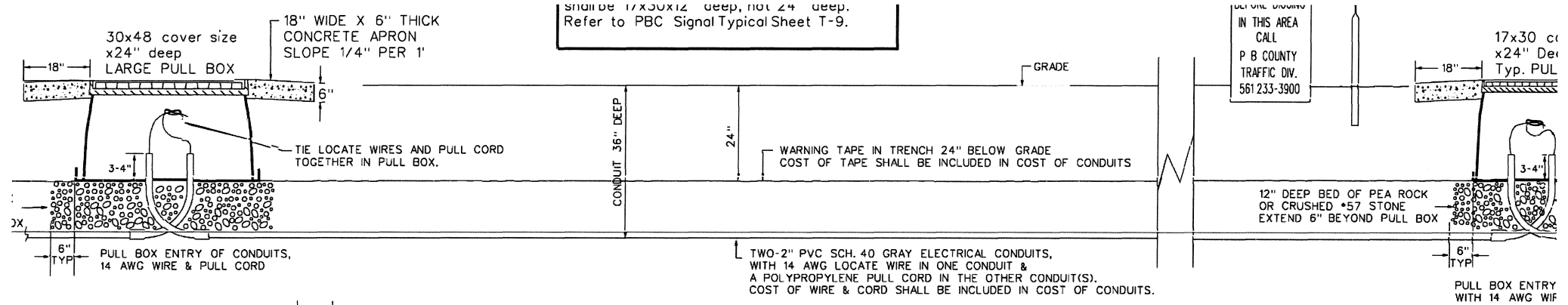

MATERIAL: FIBERGLASS REINFORCED POLYMER CONCRETE
CLASSIFICATION: MINIMUM TIER 15 (20K-22K) EXCEPT IN ROADWAY USE AASHTO H-20
STAMPED: "PBC TRAFFIC ITS". COVER TYPE: TWO PANEL WITH TWO PULL SLOTS EACH

INSTALL A TYPICAL PULL BOXES (17X30X24" DEEP) EVERY 500' (+/-). INSTALL A LARGE PULL BOX (30X48X24") AND AT EACH SIGNALIZED INTERSECTION, OR AS SHOWN ON THE PLANS. WHERE A LARGE PULL BOX IS INSTALLED, IT TAKES THE PLACE OF THE TYPICAL PULL BOX.

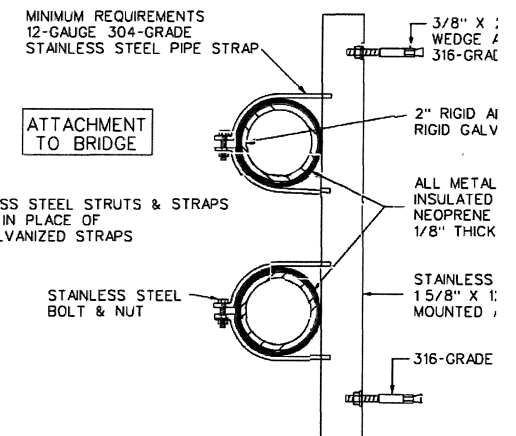
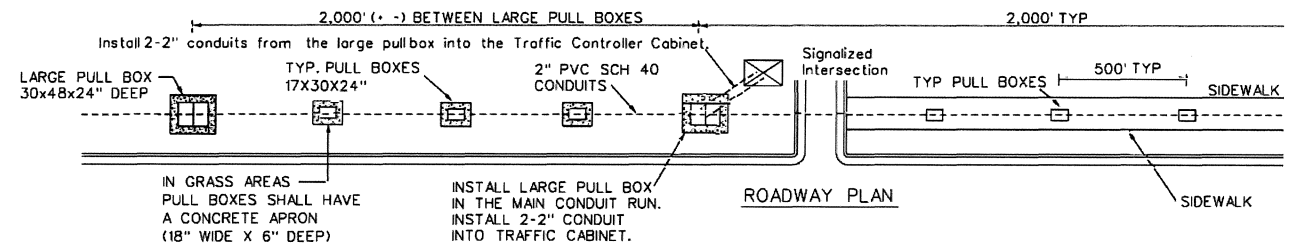

As shown in this typical the contractor shall refer to the specifications for Road and Bridge Construction. All pull boxes and pull box covers shall be a minimum TIER 15 (20K-22K). All pull boxes (in the roadway) shall be AASHTO H-20 stamped "PBC TRAFFIC ITS". All pull boxes (18") shall have two panels with two pulling slots in each panel.

Conduits shall be 2 inch schedule 40 or HDPE SDR 11, buried 36" below grade. Ends of conduit shall be sealed with duct seal, 630 (Conduit) of the FDOT Standard Specifications for Road and Bridge Construction.

Pull boxes shall not contain more than 90 degrees including pull box bends.

Warning tape, 1/2 inch thick, intended for burial and use as an underground utility warning notice, marked 'CAUTION BURIED FIBER OPTIC'. The tape shall be 2 inch high block letters on non color fading material. The marking tape shall be placed in the conduit trench from pull box to pull box. Cost included in cost of conduits.

Engineering, 2300 N Jog Rd, Tel.: 561-681-4326
The two warning label for each delineator- guide post.

Warning tape, & delineator- guide post shall be included in the cost of the conduits.
If 90's shall be 2" PVC schedule 40, gray electrical grade, or as indicated on the plans.

Pull boxes shall be installed with concrete aprons when not located within sidewalk. Aprons shall be 18" wide x 6" thick minimum. Apron shall be Min. 2,500 PSI non structural Class I concrete. The cost of the apron shall be included in the cost of the pull box.

Pull boxes shall be installed in a pedestrian ramp or sloped area of a pedestrian ramp.

At each signalized intersection, install two - 2" PVC Sch. 40 conduits from the large pull box into the traffic controller cabinet.

Install two or more 2" conduits as needed.

Bridge: Wrap neoprene (rubber) gasket completely around galvanized or aluminum IMC conduit. Seal the conduit from pipe strap. Size of neoprene (rubber) insulator: 1/8" thick x 2" wide x 8" long.

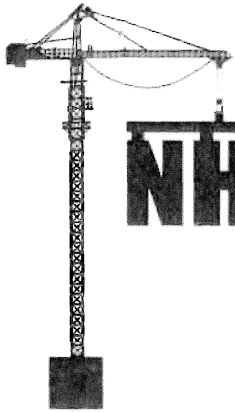

NHC

NIELSON, ROSENHAUS & ASSOCIATES
A NIELSON HOOVER GROUP COMPANY

ACRISURE
AGENCY PARTNER

October 11, 2023

Gerelco Traffic Controls, Inc.
560 NW Enterprise Drive
Port Saint Lucie, FL 34986

RE: Palm Beach County, as Oblige
Traffic Signalization Weisman Way & Sanbury Way ID #29862, Project #2022052-2018709, as Project
Bond No. 0255779

Dear Ladies and Gentlemen:

This letter gives Gerelco Traffic Controls, Inc., as Principal, and/or the Palm Beach County, as Oblige, the authority to date the Public Construction Bond and Power of Attorney with the contract date and date the Form of Guarantee upon substantial completion. The contract date MAY BE THE SAME date as the execution of the bond or PRIOR to the execution date of the bonds.

We will forward this information onto your surety company upon our receipt. Please return as soon as possible.

Thank you for your cooperation.

Sincerely,

Brett Rosenhaus
Attorney-in-Fact
Florida Licensed Agent

POWER OF ATTORNEY
BERKLEY INSURANCE COMPANY
WILMINGTON, DELAWARE

NOTICE: The warning found elsewhere in this Power of Attorney affects the validity thereof. Please review carefully.

KNOW ALL MEN BY THESE PRESENTS, that BERKLEY INSURANCE COMPANY (the "Company"), a corporation duly organized and existing under the laws of the State of Delaware, having its principal office in Greenwich, CT, has made, constituted and appointed, and does by these presents make, constitute and appoint: *Brett Rosenhaus or Dale A. Belis of Acrisure, LLC dba Nielson, Rosenhaus & Associates of Delray Beach, FL* its true and lawful Attorney-in-Fact, to sign its name as surety only as delineated below and to execute, seal, acknowledge and deliver any and all bonds and undertakings, with the exception of Financial Guaranty Insurance, providing that no single obligation shall exceed One Hundred Million and 00/100 U.S. Dollars (U.S.\$100,000,000.00), to the same extent as if such bonds had been duly executed and acknowledged by the regularly elected officers of the Company at its principal office in their own proper persons.

This Power of Attorney shall be construed and enforced in accordance with, and governed by, the laws of the State of Delaware, without giving effect to the principles of conflicts of laws thereof. This Power of Attorney is granted pursuant to the following resolutions which were duly and validly adopted at a meeting of the Board of Directors of the Company held on January 25, 2010:

RESOLVED, that, with respect to the Surety business written by Berkley Surety, the Chairman of the Board, Chief Executive Officer, President or any Vice President of the Company, in conjunction with the Secretary or any Assistant Secretary are hereby authorized to execute powers of attorney authorizing and qualifying the attorney-in-fact named therein to execute bonds, undertakings, recognizances, or other suretyship obligations on behalf of the Company, and to affix the corporate seal of the Company to powers of attorney executed pursuant hereto; and said officers may remove any such attorney-in-fact and revoke any power of attorney previously granted; and further

RESOLVED, that such power of attorney limits the acts of those named therein to the bonds, undertakings, recognizances, or other suretyship obligations specifically named therein, and they have no authority to bind the Company except in the manner and to the extent therein stated; and further

RESOLVED, that such power of attorney revokes all previous powers issued on behalf of the attorney-in-fact named; and further

RESOLVED, that the signature of any authorized officer and the seal of the Company may be affixed by facsimile to any power of attorney or certification thereof authorizing the execution and delivery of any bond, undertaking, recognizance, or other suretyship obligation of the Company; and such signature and seal when so used shall have the same force and effect as though manually affixed. The Company may continue to use for the purposes herein stated the facsimile signature of any person or persons who shall have been such officer or officers of the Company, notwithstanding the fact that they may have ceased to be such at the time when such instruments shall be issued.

IN WITNESS WHEREOF, the Company has caused these presents to be signed and attested by its appropriate officers and its corporate seal hereunto affixed this 14th day of November, 2019.

Attest:

(Seal) By Ira S. Lederman
Executive Vice President & Secretary

Berkley Insurance Company
By Jeffrey M. Hafter
Senior Vice President

WARNING: THIS POWER INVALID IF NOT PRINTED ON BLUE "BERKLEY" SECURITY PAPER.

STATE OF CONNECTICUT)
) ss:
COUNTY OF FAIRFIELD)

Sworn to before me, a Notary Public in the State of Connecticut, this 14th day of November, 2019, by Ira S. Lederman and Jeffrey M. Hafter who are sworn to me to be the Executive Vice President and Secretary, and the Senior Vice President, respectively, of Berkley Insurance Company.

MARIA C RUNDBAKEN
NOTARY PUBLIC
CONNECTICUT
MY COMMISSION EXPIRES
APRIL 30, 2024

Maria C Rundbaken
Notary Public, State of Connecticut

CERTIFICATE

I, the undersigned, Assistant Secretary of BERKLEY INSURANCE COMPANY, DO HEREBY CERTIFY that the foregoing is a true, correct and complete copy of the original Power of Attorney; that said Power of Attorney has not been revoked or rescinded and that the authority of the Attorney-in-Fact set forth therein, who executed the bond or undertaking to which this Power of Attorney is attached, is in full force and effect as of this date.

Given under my hand and seal of the Company, this 14th day of October, 2023

(Seal)

Vincent P. Forte
Vincent P. Forte

PUBLIC CONSTRUCTION BOND

BOND NUMBER 0255779

BOND AMOUNT \$501,623.16

CONTRACT AMOUNT \$501,623.16

CONTRACTOR’S NAME: Gerelco Traffic Controls, Inc.

CONTRACTOR’S ADDRESS: 560 NW Enterprise Drive, Port Saint Lucie, FL 34986

CONTRACTOR’S PHONE: (772) 340-7474

SURETY COMPANY: Berkley Insurance Company

SURETY’S ADDRESS: 475 Steamboat Road
 Greenwich, CT 06830

SURETY’S PHONE: (203) 542-3800

OWNER’S NAME: PALM BEACH COUNTY BOARD OF COUNTY COMMISSIONERS
 CAPITAL IMPROVEMENTS DIVISION

OWNER’S ADDRESS: 2633 Vista Parkway
 West Palm Beach, FL 33411-5604

OWNER’S PHONE: (561) 233-0261

PROJECT NAME: Weisman Way & Sansbury Way

PROJECT NUMBER: 2022052-2018709

CONTRACT NUMBER (to be provided after Contract award): 2022052

DESCRIPTION OF WORK: Traffic Signalization Weisman Way & Sanbury Way ID #29862

PROJECT ADDRESS, PCN, or LEGAL DESCRIPTION: Weisman Way & Sansbury Way

This Bond is issued in favor of the County conditioned on the full and faithful performance of the Contract.

KNOW ALL MEN BY THESE PRESENTS: that Contractor and Surety, are held and firmly bound unto
Palm Beach County Board of County Commissioners
301 N. Olive Avenue
West Palm Beach, Florida 33401

as Obligee, herein called County, for the use and benefit of claimant as hereinbelow defined, in the
amount of

Dollars (\$501,623.16)

Five Hundred One Thousand Six Hundred Twenty-Three Dollars and Sixteen Cents

for the payment whereof Principal and Surety bind themselves, their heirs, personal representatives,
executors, administrators, successors and assigns, jointly and severally, firmly by these presents.

WHEREAS,

Principal has by written agreement entered into a contract with the County for

Project Name: Traffic Signalization at Weisman Way & Sansbury Way, ID #29862
Project No.: 2022052-2018709
Project Description: Traffic Signalization at Weisman Way & Sansbury Way, ID #29862
Project Location: Weisman Way & Sansbury Way, ID #29862

in accordance with Drawings and Specifications prepared by

NAME OF ARCHITECTURAL FIRM: TBD
LOCATION OF FIRM: TBD
PHONE: TBD

which contract is by reference made a part hereof in its entirety, and is hereinafter referred to as the Contract.

THE CONDITION OF THIS BOND is that if Principal:

1. Performs the Contract dated _____ between Principal and County for the construction of the project as described above, the Contract being made a part of this bond by reference, at the times and in the manner prescribed in the contract; and
2. Promptly makes payments to all claimants, as defined in Section 255.05, Florida Statutes, supplying Principal with labor, materials, or supplies, used directly or indirectly by Principal in the prosecution of the work provided for in the contract; and
3. Pays County all losses, damages (including liquidated damages), expenses, costs, and attorneys' fees, including appellate proceedings, that County sustains because of a default by Principal under the contract; and
4. Performs the guarantee of all work and materials furnished under the contract for the time specified in the contract, then this bond is void; otherwise it remains in full force.
5. Any changes in or under the contract documents and compliance or noncompliance with any formalities connected with the contract or the changes does not affect Surety's obligation under this bond.

Any increase in the total contract amount as authorized by the County shall accordingly increase the Surety's obligation by the same dollar amount of said increase. Contractor shall be responsible for notification to Surety of all such changes.

6. The amount of this bond shall be reduced by and to the extent of any payment or payments made in good faith hereunder, inclusive of the payment by Surety of construction liens which may be filed of record against said improvement, whether or not claim for the amount of such lien be presented under and against the bond.

7. Principal and Surety expressly acknowledge that any and all provisions relating to consequential, delay and liquidated damages contained in the contract are expressly covered by and made a part of this Performance, Labor and Material Payment Bond. Principal and Surety acknowledge that any such provisions lie within their obligations and within the policy coverages and limitations of this instrument.

8. Section 255.05, Florida Statutes, as amended, together with all notice and time provisions contained therein, is incorporated herein, by reference, in its entirety. Any action instituted by a claimant under this bond for payment must be in accordance with the notice and time limitation provisions in Section 255.05(2), Florida Statutes. This instrument regardless of its form, shall be construed and deemed a statutory bond issued in accordance with Section 255.05, Florida Statutes.

9. Any action brought under this instrument shall be brought in the court of competent jurisdiction in Palm Beach County and not elsewhere.

Witness

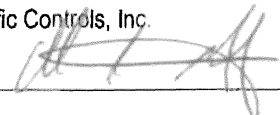

Witness Rita Lazarides

IMPORTANT: Surety companies executing bonds must appear and remain on the U.S. Treasury Department's most current list (Federal Register) during construction, guarantee and warranty periods, and be authorized to transact business in the State of Florida.

Gerelec Traffic Controls, Inc.

Principal (Seal)

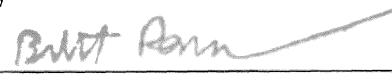
President
Title

Berkley Insurance Company
Surety (Seal)

Title Brett Rosenhaus, Attorney-in-Fact & FL Licensed Agent

POWER OF ATTORNEY
BERKLEY INSURANCE COMPANY
WILMINGTON, DELAWARE

NOTICE: The warning found elsewhere in this Power of Attorney affects the validity thereof. Please review carefully.

KNOW ALL MEN BY THESE PRESENTS, that BERKLEY INSURANCE COMPANY (the "Company"), a corporation duly organized and existing under the laws of the State of Delaware, having its principal office in Greenwich, CT, has made, constituted and appointed, and does by these presents make, constitute and appoint: *Brett Rosenhaus or Dale A. Belis of Acrisure, LLC dba Nielson, Rosenhaus & Associates of Delray Beach, FL* its true and lawful Attorney-in-Fact, to sign its name as surety only as delineated below and to execute, seal, acknowledge and deliver any and all bonds and undertakings, with the exception of Financial Guaranty Insurance, providing that no single obligation shall exceed One Hundred Million and 00/100 U.S. Dollars (U.S.\$100,000,000.00), to the same extent as if such bonds had been duly executed and acknowledged by the regularly elected officers of the Company at its principal office in their own proper persons.

This Power of Attorney shall be construed and enforced in accordance with, and governed by, the laws of the State of Delaware, without giving effect to the principles of conflicts of laws thereof. This Power of Attorney is granted pursuant to the following resolutions which were duly and validly adopted at a meeting of the Board of Directors of the Company held on January 25, 2010:

RESOLVED, that, with respect to the Surety business written by Berkley Surety, the Chairman of the Board, Chief Executive Officer, President or any Vice President of the Company, in conjunction with the Secretary or any Assistant Secretary are hereby authorized to execute powers of attorney authorizing and qualifying the attorney-in-fact named therein to execute bonds, undertakings, recognizances, or other suretyship obligations on behalf of the Company, and to affix the corporate seal of the Company to powers of attorney executed pursuant hereto; and said officers may remove any such attorney-in-fact and revoke any power of attorney previously granted; and further

RESOLVED, that such power of attorney limits the acts of those named therein to the bonds, undertakings, recognizances, or other suretyship obligations specifically named therein, and they have no authority to bind the Company except in the manner and to the extent therein stated; and further

RESOLVED, that such power of attorney revokes all previous powers issued on behalf of the attorney-in-fact named; and further

RESOLVED, that the signature of any authorized officer and the seal of the Company may be affixed by facsimile to any power of attorney or certification thereof authorizing the execution and delivery of any bond, undertaking, recognizance, or other suretyship obligation of the Company; and such signature and seal when so used shall have the same force and effect as though manually affixed. The Company may continue to use for the purposes herein stated the facsimile signature of any person or persons who shall have been such officer or officers of the Company, notwithstanding the fact that they may have ceased to be such at the time when such instruments shall be issued.

IN WITNESS WHEREOF, the Company has caused these presents to be signed and attested by its appropriate officers and its corporate seal hereunto affixed this 14th day of November, 2019.

Attest:

(Seal) By Ira S. Lederman
Executive Vice President & Secretary

Berkley Insurance Company
By Jeffrey M. Hafter
Senior Vice President

WARNING: THIS POWER INVALID IF NOT PRINTED ON BLUE "BERKLEY" SECURITY PAPER.

STATE OF CONNECTICUT)
) ss:
COUNTY OF FAIRFIELD)

Sworn to before me, a Notary Public in the State of Connecticut, this 14th day of November, 2019, by Ira S. Lederman and Jeffrey M. Hafter who are sworn to me to be the Executive Vice President and Secretary, and the Senior Vice President, respectively, of Berkley Insurance Company.

MARIA C RUNDRAKEN
NOTARY PUBLIC
CONNECTICUT
MY COMMISSION EXPIRES
APRIL 30, 2024

Maria C Rundbaken
Notary Public, State of Connecticut

CERTIFICATE

I, the undersigned, Assistant Secretary of BERKLEY INSURANCE COMPANY, DO HEREBY CERTIFY that the foregoing is a true, correct and complete copy of the original Power of Attorney; that said Power of Attorney has not been revoked or rescinded and that the authority of the Attorney-in-Fact set forth therein, who executed the bond or undertaking to which this Power of Attorney is attached, is in full force and effect as of this date.

Given under my hand and seal of the Company, this _____ day of _____, 2019.
(Seal) Vincent P. Forte

Bond No. 0255779

FORM OF GUARANTEE

GUARANTEE FOR Contractor Name: Gerelco Traffic Controls, Inc. and Surety
Name: Berkley Insurance Company

* 2022052-2018709

We the undersigned hereby guarantee that the Weisman Way & Sansbury Way, ID #29862 , Project No.* Palm Beach County, Florida, which we have constructed and bonded, has been done in accordance with the plans and specifications; that the work constructed will fulfill the requirements of the guaranties included in the Contract Documents. We agree to repair or replace any or all of our work, together with any work of others which may be damaged in so doing, that may prove to be defective in the workmanship or materials within a period of one year from the date of Substantial Completion of all of the above named work by the County of Palm Beach, State of Florida, without any expense whatsoever to said County of Palm Beach, ordinary wear and tear and unusual abuse or neglect excepted by the County. When correction work is started, it shall be carried through to completion.

In the event of our failure to acknowledge notice, and commence corrections of defective work within five (5) working days after being notified in writing by the Board of County Commissioners, Palm Beach County, Florida, we, collectively or separately, do hereby authorize Palm Beach County to proceed to have said defects repaired and made good at our expense and we will honor and pay the costs and charges therefore upon demand.

DATED _____
(Date to be filled in at substantial completion)

SEAL AND NOTARIAL
ACKNOWLEDGMENT OF SURETY

Gerelco Traffic Controls, Inc.
(Contractor Name) (Seal)

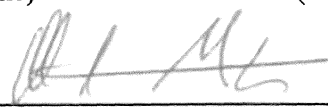
By: 
(Contractor Signature)

Kenneth A. Geremia Jr. President
(Print Name and Title)

Berkley Insurance Company
(Surety Name) (Seal)

By: 
(Surety Signature)

Brett Rosenhaus, Attorney-in-Fact & FL Licensed Agent
(Print Name and Title)

POWER OF ATTORNEY
BERKLEY INSURANCE COMPANY
WILMINGTON, DELAWARE

NOTICE: The warning found elsewhere in this Power of Attorney affects the validity thereof. Please review carefully.

KNOW ALL MEN BY THESE PRESENTS, that BERKLEY INSURANCE COMPANY (the "Company"), a corporation duly organized and existing under the laws of the State of Delaware, having its principal office in Greenwich, CT, has made, constituted and appointed, and does by these presents make, constitute and appoint: *Brett Rosenhaus or Dale A. Belis of Acrisure, LLC dba Nielson, Rosenhaus & Associates of Delray Beach, FL* its true and lawful Attorney-in-Fact, to sign its name as surety only as delineated below and to execute, seal, acknowledge and deliver any and all bonds and undertakings, with the exception of Financial Guaranty Insurance, providing that no single obligation shall exceed One Hundred Million and 00/100 U.S. Dollars (U.S.\$100,000,000.00), to the same extent as if such bonds had been duly executed and acknowledged by the regularly elected officers of the Company at its principal office in their own proper persons.

This Power of Attorney shall be construed and enforced in accordance with, and governed by, the laws of the State of Delaware, without giving effect to the principles of conflicts of laws thereof. This Power of Attorney is granted pursuant to the following resolutions which were duly and validly adopted at a meeting of the Board of Directors of the Company held on January 25, 2010:

RESOLVED, that, with respect to the Surety business written by Berkley Surety, the Chairman of the Board, Chief Executive Officer, President or any Vice President of the Company, in conjunction with the Secretary or any Assistant Secretary are hereby authorized to execute powers of attorney authorizing and qualifying the attorney-in-fact named therein to execute bonds, undertakings, recognizances, or other suretyship obligations on behalf of the Company, and to affix the corporate seal of the Company to powers of attorney executed pursuant hereto; and said officers may remove any such attorney-in-fact and revoke any power of attorney previously granted; and further

RESOLVED, that such power of attorney limits the acts of those named therein to the bonds, undertakings, recognizances, or other suretyship obligations specifically named therein, and they have no authority to bind the Company except in the manner and to the extent therein stated; and further

RESOLVED, that such power of attorney revokes all previous powers issued on behalf of the attorney-in-fact named; and further

RESOLVED, that the signature of any authorized officer and the seal of the Company may be affixed by facsimile to any power of attorney or certification thereof authorizing the execution and delivery of any bond, undertaking, recognizance, or other suretyship obligation of the Company; and such signature and seal when so used shall have the same force and effect as though manually affixed. The Company may continue to use for the purposes herein stated the facsimile signature of any person or persons who shall have been such officer or officers of the Company, notwithstanding the fact that they may have ceased to be such at the time when such instruments shall be issued.

IN WITNESS WHEREOF, the Company has caused these presents to be signed and attested by its appropriate officers and its corporate seal hereunto affixed this 14th day of November, 2019.

Attest:

(Seal) By Ira S. Lederman
Executive Vice President & Secretary

Berkley Insurance Company
By Jeffrey M. Hafter
Senior Vice President

WARNING: THIS POWER INVALID IF NOT PRINTED ON BLUE "BERKLEY" SECURITY PAPER.

STATE OF CONNECTICUT)
) ss:
COUNTY OF FAIRFIELD)

Sworn to before me, a Notary Public in the State of Connecticut, this 14th day of November, 2019, by Ira S. Lederman and Jeffrey M. Hafter who are sworn to me to be the Executive Vice President and Secretary, and the Senior Vice President, respectively, of Berkley Insurance Company.

MARIA C RUNDRAKEN
NOTARY PUBLIC
CONNECTICUT
MY COMMISSION EXPIRES
APRIL 30, 2024

Maria C Rundraken
Notary Public, State of Connecticut

CERTIFICATE

I, the undersigned, Assistant Secretary of BERKLEY INSURANCE COMPANY, DO HEREBY CERTIFY that the foregoing is a true, correct and complete copy of the original Power of Attorney; that said Power of Attorney has not been revoked or rescinded and that the authority of the Attorney-in-Fact set forth therein, who executed the bond or undertaking to which this Power of Attorney is attached, is in full force and effect as of this date.

Given under my hand and seal of the Company, this _____ day of _____, 2019.

(Seal) Vincent P. Forte



Office of
Equal Business Opportunity
50 South Military Trail, Suite 202
West Palm Beach, FL 33415
(561) 616-6840
www.pbcgov.com/oebo

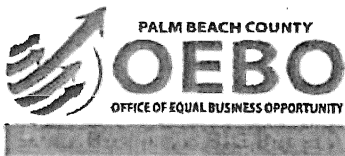

**Palm Beach County
Board of County
Commissioners**

Robert S. Weinroth, Mayor

Gregg K. Weiss, Vice Mayor

Maria G. Marino

Dave Kerner

Maria Sachs

Melissa McKinlay

Mack Bernard

County Administrator

Verdenia C. Baker

*"An Equal Opportunity
Affirmative Action Employer"*

Official Electronic Letterhead

INTER-OFFICE MEMORANDUM

Date: Thursday, January 20, 2022

To: David L. Ricks, County Engineer
Engineering and Public Works

From: Tonya Davis Johnson, Director *Gray*
Office of Equal Business Opportunity

Re: Approval of Request for Waiver of API Requirements for
Annual Traffic Signal Construction Contract Palm Beach
County Project #2022052

Your Request for Waiver of API Requirements for the above named project was received on Thursday, January 06, 2022 and has been reviewed. It is the determination of the Office of Equal Business Opportunity (OEBO) that the request for Waiver of API Requirements is **APPROVED**.

The OEBO is granting this waiver based upon the determination that sufficient qualified S/M/WBEs providing the goods or services required by the contract are unavailable in Palm Beach County despite every reasonable attempt to locate them.

If you have any questions, please contact Allen Gray at 561-616-6842 or email at agray@pcgov.org.

Thank you.

cc: Allen Gray, Manager

Attachment 3
Page 1 of 1

BOARD OF COUNTY COMMISSIONERS
PALM BEACH COUNTY
BUDGET Amendment

FUND County Transport Trust

BGRV 101823*36
BGEX 101823*158

ACCOUNT NUMBER	ACCOUNT NAME	ORIGINAL BUDGET	CURRENT BUDGET	INCREASE	DECREASE	ADJUSTED BUDGET	EXPENDED/ ENCUMBERED AS OF 12/07/2023	REMAINING BALANCE
<u>REVENUES</u>								
<u>JPA & DEVELOPER AGREEMENTS/ TRANSFER</u>								
1201-360-3224-6693	Developer Contributions	1,450,000	1,450,000	450,000	0	1,900,000		
TOTAL RECEIPTS & BALANCES		61,336,434	61,336,434	450,000	0	61,786,434		
<u>EXPENDITURES</u>								
<u>JPA & DEVELOPER AGREEMENTS/ TRANSFER</u>								
1201-360-3224-6408	Signals & Controllers	1,205,000	1,205,000	450,000	0	1,655,000	959,207	695,793
TOTAL APPROPRIATIONS & EXPENDITURES		61,336,434	61,336,434	450,000	0	61,786,434		

	SIGNATURE	DATE	By Board of County Commissioners At Meeting of <u>01/23/2024</u>
Engineering & Public Works	<u>Danny Ramdalsingh</u>	<u>12/07/2023</u>	
Administration / Budget Approval	<u>Lisa Martin</u>	<u>12/11/2023</u>	
OFMB Department – Posted			Deputy Clerk to the Board of County Commissioners



GERETRA-01

FOSTERJ

CERTIFICATE OF LIABILITY INSURANCE

DATE (MM/DD/YYYY)
8/24/2023

THIS CERTIFICATE IS ISSUED AS A MATTER OF INFORMATION ONLY AND CONFERS NO RIGHTS UPON THE CERTIFICATE HOLDER. THIS CERTIFICATE DOES NOT AFFIRMATIVELY OR NEGATIVELY AMEND, EXTEND OR ALTER THE COVERAGE AFFORDED BY THE POLICIES BELOW. THIS CERTIFICATE OF INSURANCE DOES NOT CONSTITUTE A CONTRACT BETWEEN THE ISSUING INSURER(S), AUTHORIZED REPRESENTATIVE OR PRODUCER, AND THE CERTIFICATE HOLDER.

IMPORTANT: If the certificate holder is an ADDITIONAL INSURED, the policy(ies) must have ADDITIONAL INSURED provisions or be endorsed. If SUBROGATION IS WAIVED, subject to the terms and conditions of the policy, certain policies may require an endorsement. A statement on this certificate does not confer rights to the certificate holder in lieu of such endorsement(s).

PRODUCER

Insurance Office of America
Abacoa Town Center
1200 University Blvd, Suite 200
Jupiter, FL 33458

CONTACT **Patty Beck**

PHONE (A/C, No, Ext): **(407) 998-5507 15507**

FAX (A/C, No): **(321) 214-6400**

E-MAIL ADDRESS: **Patty.Beck@ioausa.com**

INSURER(S) AFFORDING COVERAGE	NAIC #
INSURER A : Travelers Indemnity Company of America	25666
INSURER B : Ironshore Specialty Insurance Company	25445
INSURER C : Travelers Excess & Surplus Lines Company	29696
INSURER D :	
INSURER E :	
INSURER F :	

INSURED

Gereico Traffic Controls Inc.
683 NW Enterprise Dr.
Port St. Lucie, FL 34986

COVERAGES				CERTIFICATE NUMBER:		REVISION NUMBER:						
THIS IS TO CERTIFY THAT THE POLICIES OF INSURANCE LISTED BELOW HAVE BEEN ISSUED TO THE INSURED NAMED ABOVE FOR THE POLICY PERIOD INDICATED. NOTWITHSTANDING ANY REQUIREMENT, TERM OR CONDITION OF ANY CONTRACT OR OTHER DOCUMENT WITH RESPECT TO WHICH THIS CERTIFICATE MAY BE ISSUED OR MAY PERTAIN, THE INSURANCE AFFORDED BY THE POLICIES DESCRIBED HEREIN IS SUBJECT TO ALL THE TERMS, EXCLUSIONS AND CONDITIONS OF SUCH POLICIES. LIMITS SHOWN MAY HAVE BEEN REDUCED BY PAID CLAIMS.												
INSR LTR	TYPE OF INSURANCE			ADDL INSD	SUBR WVD	POLICY NUMBER	POLICY EFF (MM/DD/YYYY)	POLICY EXP (MM/DD/YYYY)	LIMITS			
A	X	COMMERCIAL GENERAL LIABILITY		X		CO3R184643	9/1/2023	9/1/2024	EACH OCCURRENCE	\$ 1,000,000		
		<input type="checkbox"/> CLAIMS-MADE	<input checked="" type="checkbox"/> OCCUR						DAMAGE TO RENTED PREMISES (Ea occurrence)	\$ 300,000		
									MED EXP (Any one person)	\$ 5,000		
									PERSONAL & ADV INJURY	\$ 1,000,000		
									GENERAL AGGREGATE	\$ 2,000,000		
GEN'L AGGREGATE LIMIT APPLIES PER:							PRODUCTS - COMP/OP AGG	\$ 2,000,000				
<input type="checkbox"/> POLICY		<input checked="" type="checkbox"/> PRO-JECT	<input type="checkbox"/> LOC									
OTHER:												
A	X	AUTOMOBILE LIABILITY				8103R216424	9/1/2023	9/1/2024	COMBINED SINGLE LIMIT (Ea accident)	\$ 1,000,000		
		<input type="checkbox"/> ANY AUTO OWNED AUTOS ONLY	<input type="checkbox"/> SCHEDULED AUTOS						BODILY INJURY (Per person)	\$		
									<input type="checkbox"/> HIRED AUTOS ONLY	<input type="checkbox"/> NON-OWNED AUTOS ONLY	BODILY INJURY (Per accident)	\$
											PROPERTY DAMAGE (Per accident)	\$
A	X	UMBRELLA LIAB	<input type="checkbox"/> OCCUR			CUP6S4012892	9/1/2023	9/1/2024	EACH OCCURRENCE	\$ 5,000,000		
		EXCESS LIAB	<input type="checkbox"/> CLAIMS-MADE						AGGREGATE	\$		
		DED	<input checked="" type="checkbox"/> RETENTION \$						10,000	Aggregate	\$ 5,000,000	
WORKERS COMPENSATION AND EMPLOYERS' LIABILITY				Y/N	N/A	<input type="checkbox"/>						
ANY PROPRIETOR/PARTNER/EXECUTIVE OFFICER/MEMBER EXCLUDED? (Mandatory in NH)												
If yes, describe under DESCRIPTION OF OPERATIONS below												
B	Pollution Commercial					ICELLUW00101898	9/1/2023	9/1/2024	Liability	2,000,000		
C	Equipment Floater					6303R198580	9/1/2023	9/1/2024	Liability	2,000,000		

DESCRIPTION OF OPERATIONS / LOCATIONS / VEHICLES (ACORD 101, Additional Remarks Schedule, may be attached if more space is required)

Project: Annual Traffic Signal Contract Palm Beach County Project No: 2019050, R2020-0759

ITS Account Number PLC2600

Palm Beach County Board of County Commissioners, a Political Subdivision of the State of Florida, its Officers, Employees and Agents, when required by written contract are additional insured with respects to General Liability when required by written contract.

CERTIFICATE HOLDER

Palm Beach County
Engineering & Public Works Dept.
2300 N. Jog Road, 3rd Floor
West Palm Beach, FL 33411

CANCELLATION

SHOULD ANY OF THE ABOVE DESCRIBED POLICIES BE CANCELLED BEFORE THE EXPIRATION DATE THEREOF, NOTICE WILL BE DELIVERED IN ACCORDANCE WITH THE POLICY PROVISIONS.

AUTHORIZED REPRESENTATIVE

Demetrius Thomas



GERETRA-02

AZHAMNOV

CERTIFICATE OF LIABILITY INSURANCE

DATE (MM/DD/YYYY)
12/8/2023

THIS CERTIFICATE IS ISSUED AS A MATTER OF INFORMATION ONLY AND CONFERS NO RIGHTS UPON THE CERTIFICATE HOLDER. THIS CERTIFICATE DOES NOT AFFIRMATIVELY OR NEGATIVELY AMEND, EXTEND OR ALTER THE COVERAGE AFFORDED BY THE POLICIES BELOW. THIS CERTIFICATE OF INSURANCE DOES NOT CONSTITUTE A CONTRACT BETWEEN THE ISSUING INSURER(S), AUTHORIZED REPRESENTATIVE OR PRODUCER, AND THE CERTIFICATE HOLDER.

IMPORTANT: If the certificate holder is an ADDITIONAL INSURED, the policy(ies) must have ADDITIONAL INSURED provisions or be endorsed. If SUBROGATION IS WAIVED, subject to the terms and conditions of the policy, certain policies may require an endorsement. A statement on this certificate does not confer rights to the certificate holder in lieu of such endorsement(s).

PRODUCER

Collinsworth, Alter, Fowler & French, LLC
15050 NW 79th Court
Suite 200
Miami Lakes, FL 33016

CONTACT NAME:

PHONE (A/C, No, Ext): (305) 822-7800

FAX (A/C, No): (305) 362-2443

E-MAIL ADDRESS:

INSURER(S) AFFORDING COVERAGE

INSURER A : Bridgefield Casualty Ins Co

INSURER B :

INSURER C :

INSURER D :

INSURER E :

INSURER F :

NAIC #
10335

INSURED

Gereico Traffic Controls, Inc
560 NW Enterprise Drive
Port Saint Lucie, FL 34986

COVERAGES			CERTIFICATE NUMBER:		REVISION NUMBER:				
THIS IS TO CERTIFY THAT THE POLICIES OF INSURANCE LISTED BELOW HAVE BEEN ISSUED TO THE INSURED NAMED ABOVE FOR THE POLICY PERIOD INDICATED. NOTWITHSTANDING ANY REQUIREMENT, TERM OR CONDITION OF ANY CONTRACT OR OTHER DOCUMENT WITH RESPECT TO WHICH THIS CERTIFICATE MAY BE ISSUED OR MAY PERTAIN, THE INSURANCE AFFORDED BY THE POLICIES DESCRIBED HEREIN IS SUBJECT TO ALL THE TERMS, EXCLUSIONS AND CONDITIONS OF SUCH POLICIES. LIMITS SHOWN MAY HAVE BEEN REDUCED BY PAID CLAIMS.									
INSR LTR	TYPE OF INSURANCE		ADDL INSD	SUBR WVD	POLICY NUMBER	POLICY EFF (MM/DD/YYYY)	POLICY EXP (MM/DD/YYYY)	LIMITS	
	COMMERCIAL GENERAL LIABILITY							EACH OCCURRENCE	\$
	<input type="checkbox"/>	CLAIMS-MADE <input type="checkbox"/> OCCUR						DAMAGE TO RENTED PREMISES (Ea occurrence)	\$
								MED EXP (Any one person)	\$
								PERSONAL & ADV INJURY	\$
	GEN'L AGGREGATE LIMIT APPLIES PER:							GENERAL AGGREGATE	\$
	POLICY <input type="checkbox"/>	PRO-JECT <input type="checkbox"/> LOC						PRODUCTS - COMP/OP AGG	\$
	OTHER:								\$
	AUTOMOBILE LIABILITY							COMBINED SINGLE LIMIT (Ea accident)	\$
	<input type="checkbox"/>	ANY AUTO OWNED AUTOS ONLY	<input type="checkbox"/>	SCHEDULED AUTOS				BODILY INJURY (Per person)	\$
	<input type="checkbox"/>	HIRED AUTOS ONLY	<input type="checkbox"/>	NON-OWNED AUTOS ONLY				BODILY INJURY (Per accident)	\$
								PROPERTY DAMAGE (Per accident)	\$
									\$
	<input type="checkbox"/>	UMBRELLA LIAB	<input type="checkbox"/>	OCCUR				EACH OCCURRENCE	\$
	<input type="checkbox"/>	EXCESS LIAB	<input type="checkbox"/>	CLAIMS-MADE				AGGREGATE	\$
	<input type="checkbox"/>	DED	<input type="checkbox"/>	RETENTION \$					\$
A	WORKERS COMPENSATION AND EMPLOYERS' LIABILITY				196515110103	9/1/2023	9/1/2024	<input checked="" type="checkbox"/> PER STATUTE <input type="checkbox"/> OTH-ER	
	ANY PROPRIETOR/PARTNER/EXECUTIVE OFFICER/MEMBER EXCLUDED? (Mandatory in NH)		Y/N	N/A				E.L. EACH ACCIDENT	\$ 1,000,000
	If yes, describe under DESCRIPTION OF OPERATIONS below							E.L. DISEASE - EA EMPLOYEE	\$ 1,000,000
								E.L. DISEASE - POLICY LIMIT	\$ 1,000,000

DESCRIPTION OF OPERATIONS / LOCATIONS / VEHICLES (ACORD 101, Additional Remarks Schedule, may be attached if more space is required)

Project No: 2019050, R2020-0759

Project Name: Palm Beach County Annual Traffic Signal Contract

Worker's Compensation Coverage provides Coverage in the state of Florida.

CERTIFICATE HOLDER

Palm Beach County
2300 N Jog Rd
West Palm Beach, FL 33411

CANCELLATION

SHOULD ANY OF THE ABOVE DESCRIBED POLICIES BE CANCELLED BEFORE THE EXPIRATION DATE THEREOF, NOTICE WILL BE DELIVERED IN ACCORDANCE WITH THE POLICY PROVISIONS.

AUTHORIZED REPRESENTATIVE