

II. FISCAL IMPACT ANALYSIS

A. Five Year Summary of Fiscal Impact:

Fiscal Years	2025	2026	2027	2028	2029
Capital Expenditures	\$ 830,039	-0-	-0-	-0-	-0-
Operating Costs	-0-	-0-	-0-	-0-	-0-
External Revenues	-0-	-0-	-0-	-0-	-0-
Program Income (County)	-0-	-0-	-0-	-0-	-0-
In-Kind Match (County)	-0-	-0-	-0-	-0-	-0-
NET FISCAL IMPACT	\$ 830,039	-0-	-0-	-0-	-0-
# ADDITIONAL FTE POSITIONS (Cumulative)	-0-	-0-	-0-	-0-	-0-

Is Item Included in Current Budget?	Yes	<input checked="" type="checkbox"/>	No	<input type="checkbox"/>
Is this item using Federal Funds?	Yes	<input type="checkbox"/>	No	<input checked="" type="checkbox"/>
Is this item using State Funds?	Yes	<input type="checkbox"/>	No	<input checked="" type="checkbox"/>

Budget Account No :				
Fund	Dept	Unit	Object	
3502	361	1658	6505	\$700,000.00
3950	361	1658	6505-AE10	\$130,038.75

Recommended Sources of Funds/Summary of Fiscal
Road Impact Fee Zone 2/Local Government One-Cent Infrastructure Surtax/
Australlian Ave. from Banyan Blvd to 45th St

Brief Description: Supplement No. 8 to a project contract

Supplement No. 8	
• Basic Services	\$429,012.75
• Optional Services	\$163,026.00
Total Supplement No. 8	\$592,038.75

Estimated Staff Costs	
• Roadway Production	\$118,000.00
• Roadway Production: Right-of-Way	\$ 30,000.00
• Survey	\$ 30,000.00
• Traffic	\$ 60,000.00
Total Staff Costs	\$238,000.00 <i>SKM</i>
Fiscal Impact	\$830,038.75

Impact Fee Description: This supplement is to provide a set of design plans to split the project into 2 parts for the ease of construction and to provide Maintenance of Traffic (MOT) plans to be used during the construction process. Extending the existing turn lanes in this project will allow for the additional capacity needed to serve new development within Impact Fee Zone 2. Use of Impact Fees is in accordance with Article 13, Chapter H, Section 4 of the ULDC.

C. Departmental Fiscal Review:

Danny Ranselberg

III. REVIEW COMMENTS

A. OFMB Fiscal and/or Contract Dev. and Control Comments:

Liz Herman 7/31/2025
10/1/21 OFMB *7/15/2025*

Theresa Mack 8/4/25
Contract Dev. and Control

B. Approved as to Form and Legal Sufficiency:

[Signature]
Assistant County Attorney
for Liz Herman

C. Other Department Review:

Department Director

This summary is not to be used as a basis for payment.



N

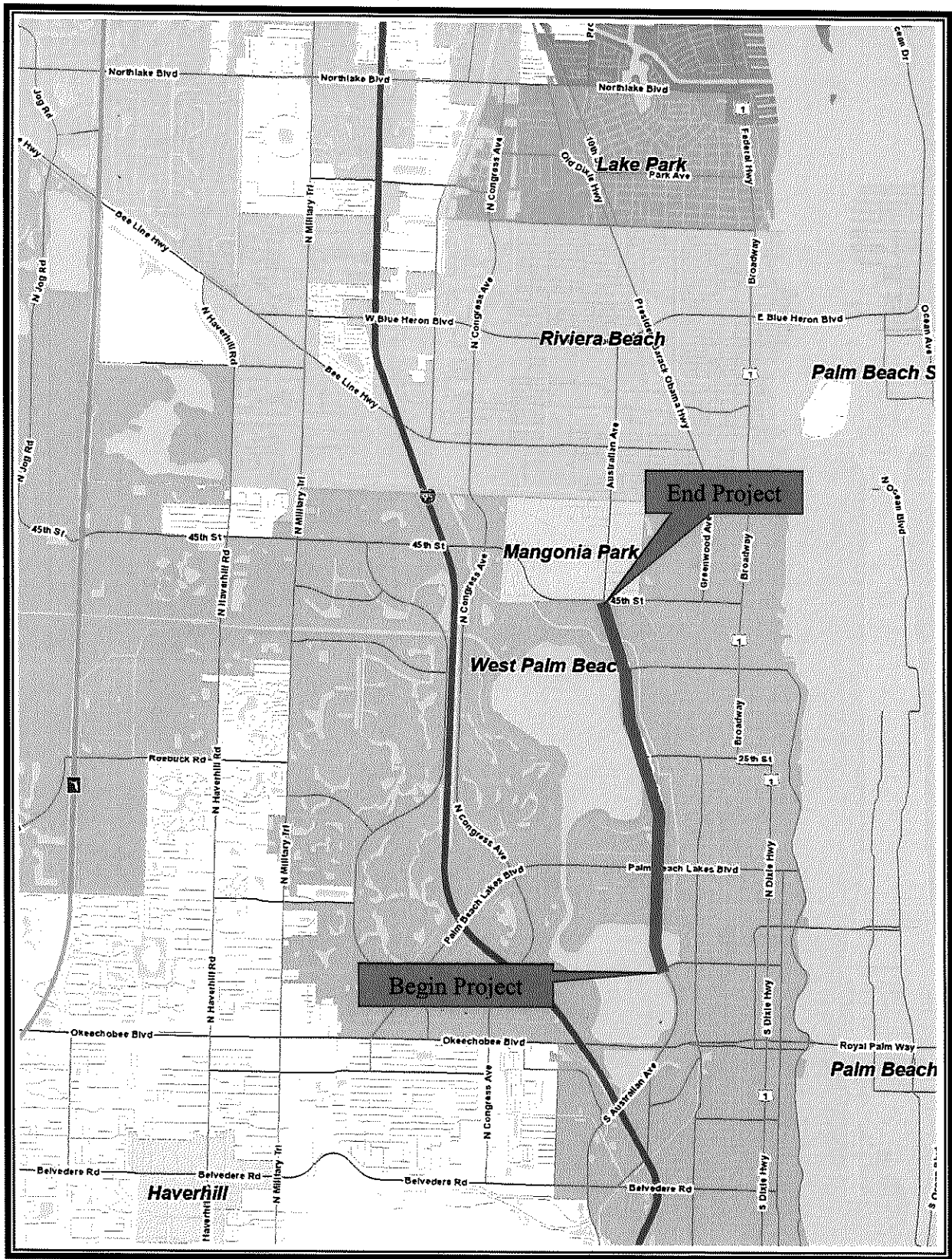

LOCATION MAP

ATTACHMENT 1

**SUPPLEMENT NO. 8 TO THE AUSTRALIAN AVENUE DRAINAGE
IMPROVEMENTS FROM BANYAN BOULEVARD TO
45TH STREET PROJECT CONTRACT**

Project Name: **Australian Avenue Drainage Improvements from Banyan Boulevard to
45th Street**

Project No: **2021827**

Commission District No.: **7**

	SBE
Participation for this authorization	39.73%
Participation to date for this Contract	76.03%
Contract Commitment	88%
This authorization is under the EBO Ordinance.	

**PALM BEACH COUNTY
BOARD OF COUNTY COMMISSIONERS**

**Account No.: 3502-361-1658-6505
3950-361-1658-6505-AE10**

Supplement No. 8 to the Project Contract dated April 12, 2022 (R2022-0335), (CONTRACT), between the COUNTY and the CONSULTANT identified herein is for the Additional Services described in **EXHIBIT A** and **EXHIBIT B** for this Supplement.

1. CONSULTANT: **HSQ Group, LLC**

2. Address: **1002 Yamato Road, Suite 105, Boca Raton, FL 33431**

3. CONSULTANT shall begin work promptly on the requested Additional Services, per the schedule attached as part of **EXHIBIT A**.

4. Scope of Services to be provided by CONSULTANT: Provide professional engineering services to Palm Beach County for the Australian Avenue Drainage Improvements from Banyan Boulevard to 45th Street project. Split the project into two parts, provide Maintenance of Traffic (MOT) plans and extend the existing turn lanes in accordance with the attached **EXHIBIT A** dated April 16, 2025.

5. The compensation to be paid CONSULTANT for providing the requested services as detailed in **EXHIBIT B** shall be:

<input checked="" type="checkbox"/> Basic Services in a lump sum fee of	\$429,012.75
<input checked="" type="checkbox"/> Optional Services capped at	<u>\$163,026.00</u>
Totaling	\$592,038.75

☒ OEBO Schedules 1 & 2 **EXHIBIT C**
☒ Project History **EXHIBIT D**

6. All terms of the CONTRACT shall apply to this CSA.

This Contract, including all Schedules, Forms, and attachments, is subject to the County Emergency Ordinance 2025-014, approved by the BCC on June 3, 2025. As a result, the M/WBE participation will not be enforced.

Attachment 2

**SUPPLEMENT NO. 8 TO THE AUSTRALIAN AVENUE DRAINAGE
IMPROVEMENTS FROM BANYAN BOULEVARD TO
45TH STREET PROJECT CONTRACT**

IN WITNESS WHEREOF, this Supplement is accepted as of the date signed by the COUNTY below, subject to the terms and conditions of the aforementioned CONTRACT.

CONSULTANT: **HSQ Group, LLC**
Federal ID: 20-2052928

COUNTY:

Approved as to Terms and Conditions

Signed: 
Typed Name: Nour Shehadeh, P.E.
Title: Managing Member
Date: June 20, 2025

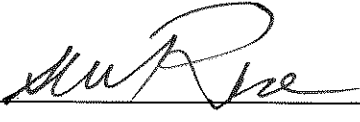
By: 
Typed Name: Morton L. Rose, P.E.
Title: Division Director

(Corporate Seal)
ATTEST WITNESS:

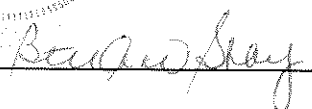
Signed: 
Typed Name: BethAnn Shay
Title: Office Manager
Date: June 20, 2025

SUPPLEMENT NO. 8 TO THE AUSTRALIAN AVENUE DRAINAGE
IMPROVEMENTS FROM BANYAN BOULEVARD TO
45TH STREET PROJECT CONTRACT

{SIGNATURE PAGES CONTINUED}

COUNTY: Palm Beach County, a Political
Subdivision of the State of Florida, by and
through its Board of County Commissioners

Signed: _____

Typed Name: Maria G. Marino

Title: Mayor

Date: _____

ATTEST:

Joseph Abruzzo

Clerk of the Circuit Court & Comptroller

By: _____

Deputy Clerk

Approved as to Form and Legal Sufficiency

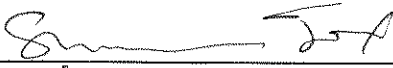
By:  _____

Typed Name: ^{for:} Yelizaveta B. Herman

Title: Assistant County Attorney

*f:\roadway\ccna\2021\2021827 australian ave
drainage improvements\project\supplement 8\csa and
supplement template.docx*



HSQ GROUP, LLC

Engineers • Planners

1001 Yamato Road • Boca Raton, Florida 33431, Suite 105 • Phone (561) 392-0221 hsqgroupinc.com

Supplemental Agreement 8

SCOPE OF SERVICES

Australian Avenue Drainage Improvements

from Banyan Boulevard to 45th Street

Palm Beach County Project No. 2021827

April 9, 2025

Rev. April 16, 2025

Project Description:

The purpose of this SA 8 is to split the project into two phases for construction purposes, provide Temporary Traffic Control Plans and redesign the driveways along the east side of Australian Ave from approximately station 331+30 to 10th Street.

Basic Services:

- 1- Based on directions received from the County to reevaluate the need for sketch and legal descriptions for Temporary Construction easements (TCE), Permanent Easements (PE) and Right of Way (ROW), HSQ did the evaluation and submitted the summary of the easements that can be deleted after design modifications as shown in the attached summary Table 1.
- 2- Prepare two separate construction sets of plans so that the project can be constructed in two phases:
Phase I from Banyan Blvd to 25th Street
Phase II from 25th Street to 45th Street.
- 3- Design the transition between the two phases assuming that both phases will be bidded together and both phases will be constructed from the north to the south.
- 4- Separate the quantities for bidding purposes for the two phases including roadway, signals, bridges and utilities. **Utility plans and lift station plan separation to be the responsibility of the City of West Palm Beach.**
- 5- Two quantity computation books will be submitted.
- 6- Prepare separate cost estimates.
- 7- Prepare two separate utility matrixes, one for each phase.
- 8- Redesign signals at 25th Street / Australian Ave and 36th Street / Australian Ave due to right of way impact.
- 9- HSQ will prepare the bid form for Australian Ave with applicable footnotes and pay items to include; roadway, signing and pavement marking, signals and bridge, utilities. This is a living



HSQ GROUP, LLC

Engineers • Planners

1001 Yamato Road • Boca Raton, Florida 33431, Suite 105 • Phone (561) 392-0221 hsqgroupinc.com

document that will continue to be updated through out the preparation for bid stage. Two bid forms will be prepared.

Temporary Traffic Control Plans (TTCP)

TTCP will be prepared by Stanley Consultant. See attached scope and fee. HSQ will coordinate with sub for this task.

Optional Services

1. HSQ will review the as-built drawings as part of post design services for conformance with the plans designed including any change orders.
2. Responses to RFI's and shop drawing
3. Attendance by EOR for final acceptance meeting with Signal Contractor and PBC Traffic.
4. Preparing as-built signal plan to reflect any field modifications for submittal to County along with a Cadd file based on PBC standards. This is not a survey by HSQ. It's the contractor responsibility to provide the as built plans of the existing condition after construction is done for review and HSQ will revise the original plans to reflect the as built and submit to the county.

Project Schedule:

The additional work will be done within 4 months from the Notice to Proceed for this supplemental agreement.

Estimate of Work Effort and Cost

Name of Project: Australian Avenue Drainage Improvements from Banyan Boulevard to 45th Street SA# 8
PBC Project Number: 2021827

Consultant Name: HSQ Group, LLC
Consultant Number:
Date: 4/17/2025

Task Description	Total Staff Hours	Staff Categories							Staff Hours By Activity	Salary Cost By Activity	Average Rate Per Task
		Principal Engineer	Senior Engineer	Project Manager	Project Engineer	Engineer Intern					
		\$72.00	\$65.00	\$70.00	\$54.00	\$35.00					
BASIC SERVICES											
3. Project General and Project Common Tasks	76 ✓	4.0	23.0	23.0	8.0	18.0			76.0	\$4,455.00	\$ 58.62
4. Roadway Analysis	220 ✓	22.0	44.0	110.0	22.0	22.0			220.0	\$14,102.00	\$ 64.10
5. Roadway Plans	150 ✓	8.0	8.0	30.0	45.0	59.0			150.0	\$7,691.00	\$ 51.27
6a. Drainage Analysis	78 ✓	16.0	23.0	23.0	8.0	8.0			78.0	\$4,969.00	\$ 63.71
6b. Drainage Plans	28 ✓	1.0	1.0	10.0	8.0	8.0			28.0	\$1,549.00	\$ 55.32
7. Utilities	24 ✓	0.0	2.0	12.0	5.0	5.0			24.0	\$1,415.00	\$ 58.96
8. Twin Lakes Driveways	78 ✓	12.0	31.0	16.0	8.0	11.0			78.0	\$4,816.00	
19. Signing and pavement marking	30 ✓	2.0	2.0	9.0	9.0	8.0			30.0	\$1,670.00	\$ 55.67
21. Signalization Analysis	114 ✓	6.0	34.0	40.0	23.0	11.0			114.0	\$7,069.00	\$ 62.01
22. Signalization Plans	70.0 ✓	4.0	7.0	14.0	18.0	27.0			70.0	\$3,640.00	\$ 52.00
Total Staff Hours (Basic Services)	868.0	75.0	175.0	287.0	154.0	177.0	8.0	0.0	0.0	868.0	
Total Staff Cost (Basic Services)		\$5,400.00	\$11,375.00	\$20,090.00	\$8,316.00	\$6,195.00	\$0.00	\$0.00	\$0.00	\$51,376.00	\$ 59.19

EBO SBE Calculation for this Fee Summary		SBE \$	Non-SBE \$
Prime		\$225,831.00	
Ritzel-Mason, Inc		\$7,305.75	
Stanley Consultants, Inc.			\$358,902.00
Totals		\$233,136.75	\$ 358,902.00

SBE % Achieved 39.37%
SBE % Committed 88.00%

Basic Services:	
Salary Related Costs:	\$51,376.00
Contract Multiplier 3.00	
Prime Consultant (Loaded)	\$154,128.00
Subtotal Basic Services (Prime Firm):	\$154,128.00
(Stanley Consultants, Inc.) Traffic Control Plans	\$267,579.00
Ritzel-Mason, Inc	\$7,305.75
	\$274,884.75
Basic Services Total:	\$429,012.75

Optional Services: see scope of services	
(HSQ Group, LLC)	\$71,703.00
(Stanley Consultants, Inc.)	\$91,323.00
Optional Services Total:	\$163,026.00

Grand Total Estimated Fees \$592,038.75

Australian Ave (Banyan Blvd - 45th St)
2021827

Task No.	Task	Units	No of Units	Hours/ Unit	Total Hours	Comments
3.1	Prepared bid form					
3.1.1	Prepae bld forms	EA	2	38	76	TO INCLUDE MOT quantities and utility quantities
3.1.2	Notifications	LS	1		0	
3.1.3	Preparing Mailing Lists	LS	1		0	
3.1.4	Median Modification Letters	LS	1		0	
3.1.5	Driveway Modification Letters	LS	1		0	
3.1.6	Newsletters	LS	1		0	
3.1.7	Power point and presentation boards	LS	1		0	
3.1.8	PowerPoint Presentation	LS	1		0	
3.1.9	Public Meeting Preparations	EA	5		0	
3.1.10	Public Meeting Attendance	LS	1		0	
3.1.11	Other Agency Meetings	LS	1		0	
3.1.12	Web Site	LS	1		0	
3.1 Public Involvement Subtotal					76	
3.2	Coordination with City	EA			0	
3.3	Coordinate with subs	EA			0	
3.4	Review permit on behalf of the county related to this project	EA			0	
3.5	Value Engineering (Multi-Discipline Team) Review	LS			0	
3.6	Prime Consultant Project Manager Meetings	LS			0	
3.7	Plans Update	LS			0	
3: Project Common and Project General Tasks Total					76	

Australian Ave (Banyan Blvd - 45th St)
2021827

Task No.	Task	Units	No of Units	Hours/ Unit	Total Hours	Comments
4.1	Typical Section	LS			0	
4.2	Evaluate SL, PE, ROW	LS	1	120	120	includes, evaluation/analyses and revisions of affected plans i.e, plans, driveway profiles, cross section, profiles etc.
4.3	Driveway profiles	LS			0	
4.4	master plan	LS			0	
4.5	Horizontal and vertical design	LS	1	16	16	design transition from phase II to phase I, Then the plans of Phase I will show the removal of th e transition to match. This task includes the plans geometry and profile adjustments
4.6	Access Management	LS			0	
4.7	Back of sidewalk profile evaluation and establishment	LS			0	
4.8	Guardrail design at bridges	EA			0	
4.9	Cross Section Design Files	LS			0	
4.10	Temporary Traffic Control Plan Analysis	LS			0	
4.11	Master TTCP Design Files	LS			0	
4.12a	Selective Clearing and Grubbing of Existing Vegetation Field Assessment	LS			0	
4.12b	Selective Clearing and Grubbing Site Inventory of Existing Vegetation and Cross-Discipline Coordination (OPTIONAL SERVICES)	LS			0	
4.12c	Selective Clearing and Grubbing- Existing Vegetation Maintenance Report	LS			0	
4.14	Design Variations and Exceptions	LS			0	
4.15	Design Report	LS			0	
4.16	Quantities	LS	2	30	60	
4.17	Cost Estimate	EA	2	12	24	
4.18	Technical Special Provisions for the type of separator	LS			0	
4. Roadway Analysis Total					220	✓

Australian Ave (Banyan Blvd - 45th St)
2021827

Task No.	Task	Scale	Units	No. of Units or Sheet	Hours/ Unit or Sheet	Total Hours	Comments
5.1	Key Sheet		Sheet	2	2	4	
5.2	Summary of Pay Items and pay item notes		Sheet	4	7	28	
5.3	Typical Section Sheets						
5.3.1	Typical Sections drafting		Sheet	6	2.5	15	3 sheets will be revised twice to separate phase I and phase II
5.3.2	Typical Section Details		Sheet				
5.4	General Notes		Sheet	2	1	2	general notes from phase I will be copied and modified to phase II
5.5	Summary of Quantities Sheets		Sheet				
5.6	Project Layout		Sheet				
5.7	Plan/Profile Sheet		Sheet		0	0	
5.8	Profile Sheet		Sheet	4	5	20	
5.9	Plan Sheet		Sheet	4	5	20	
5.10	Driveways profiles		EA	8	2	16	modifications depends on the transition and geometry
5.11	Back-of-Sidewalk Profile Sheet		Sheet				
5.12	Side streets profile		Sheet				
5.13	Ramp Terminal Details (Plan View)		Sheet				
5.14	Intersection Layout Details		Sheet	2	7	14	
5.15	Tree diposition plans		Sheet	3	3	9	modify charts 2 charts twice + modify 1 plan twice
5.16	Cross-Section Pattern Sheet(s)		Sheet		0	0	
5.17	Roadway Soil Survey Sheet(s)		LS	1	2	2	
5.18	Cross Sections		EA	10	2	20	all modifications are by hand at this stage of the design development
5. Roadway Plans Total						150	

Australian Ave (Banyan Blvd - 45th St)
2021827

Task No.	Task	Units	No of Units	Hours/ Unit	Total Hours	Comments
6a.1	Drainage Map HYDROLOGY	Per Map			0	
6a.2	Flood routing	EA			0	
6a.3	Pond Siting Analysis and Report	LS			0	
6a.4	Design of Cross Drains	EA	10	3	30	
6a.5	Design of Ditches	EA		0	0	
6a.6	Design of Stormwater Management Facility (Offsite or Infield Pond)	EA		0	0	
6a.7	Design of Stormwater Management Facility (Roadside Treatment Swales and Linear Ponds)	EA		0	0	
6a.8	Design of Floodplain Compensation	Per Floodplain Basin		0	0	
6a.9	Design of Storm Drains	EA	10	2	20	10 drainage structures will be affected with the split and transition
6a.10	Optional Culvert Material	EA			0	
6a.11	French Drain Systems	Per Cell			0	
6a.11.a	Existing French Drain Systems	Per Cell			0	
6a.12	Drainage Wells	EA			0	
6a.13	Drainage Design Documentation Report	LS	2	14	28	revise the drinage report to split the project
6a.19	Existing Permit Analysis	LS			0	
6a. Drainage Analysis Total					78	

Carries to Tab 3

Australian Ave (Banyan Blvd - 45th St)
2021827

Task No.	Task	Scale	Units	No. of Units or Sheet	Hours/ Unit or Sheet	Total Hours	Comments
6b.1	Drainage Map		Sheet	2	3	6	
6b.2	Bridge Hydraulics Recommendation Sheets		Sheet		0	0	
6b.3	Summary of Drainage Structures		Sheet		0	0	
6b.4	Optional Pipe/Culvert Material		Sheet		0	0	
6b.5	Drainage Structure Sheet(s)		Sheet	4	4	16	revise 2 sheets @2 hrs + create 2 additional sheets at 14 hrs
6b.6	Drainage Detail Sheets		Sheet			0	
6b.7	Lateral Ditch Plan/Profile		Sheet			0	
6b.8	Lateral Ditch Cross Sections		EA			0	
6b.9	Retention/Detention Ponds Detail Sheet(s)		Sheet			0	
6b.10	Retention Pond Cross Sections		EA			0	
6b.11	Erosion Control Plan Sheet(s)		Sheet			0	
6b.12	SWPPP Sheet(s)		Sheet	2	3	6	general notes, revise 2 sheets
6. Drainage Plans Total						28	

Project Activity 7: Utilities

Australian Ave (Banyan Blvd - 45th St)
2021827

Task No.	Task	Units	No of Units	Hours/ Unit	Total Hours		Comments
7.1	Utility Kickoff Meeting	LS			0		
7.2	Identify Existing Utility Agency Owner(s)	LS			0		
7.3	Make initail Utility Contact plans	LS			0		
7.4	Exception Processing	LS			0		
7.5	Utility Meetings	LS			0		
7.6	Individual/Field Meetings	LS			0		
7.7	Collect and Review Plans / create dgn	LS			0		
7.8	Subordination of Easements Coordination	LS			0		
7.9	Utility Design Meeting	LS			0		
7.10	Review Utility Markups & Work Schedules, and Processing of Schedules & Agreements	LS			0		
7.11	Utility CONFLICT MATRIX	LS	2	8	16		including any potential conflicts due to the transition
7.12	Utility Constructability Review	LS			0		
7.13	Additional Utility Services	LS			0		
7.14	Processing Utility Work by Highway Contractor (UWHC)	LS			0		
7.15	Contract Plans to UAO(s)	LS			0		
7.16	Certification/Close-Out	LS			0		
7.17	Roadway utility adjustment sheets	LS	1	8	8		
7. Utilities Total					24	✓	

Australian Ave (Banyan Blvd - 45th St)

HSQ

2021827

Task No.	Task	Units	No. of Units	Hours/ Units	Total Hours	Comments
	Twin Lakes Driveways					
	NO PERMIT MODIFICATION FOR THIS MINOR CHANGE IN THE IMPERVIOUS AREA IS INCLUDED NOR ANY DRAINAGE RE ANALYSES WILL BE DONE					
8.1	Field review	LS	1	6	6	2 people, TOO MANYTHINGS TO LOOK AT AT THE BACK OF THE HOUSES
8.2	Revise plan views to show driveways	EA	2	8	16	driveways will be entended to the back of the house to have the turn around
8.3	Driveway details	EA	10	3	30	
8.4	Driveway profiles	EA	7	3	21	some of the driveways may not be extend as they are to the back due to obsticales in the way which will be confirmed by survey. From evluation it looks like that 7 driveways will be redone
8.5	Quantities	LS	1	5	5	
total					78 ✓	

Australian Ave (Banyan Blvd - 45th St)
2021827

Task No.	Task	Units	No. of Units	Hours/ Units	Total Hours	Comments
19.1	Traffic Data Analysis	LS	1	0	0	
19.2	No Passing Zone Study	LS	1		0	
19.3	Reference and Master Design File	LS	1		0	
19.4	Multi-Post Sign Support Calculations	EA	1		0	
19.5	Sign Panel Design Analysis	EA	1		0	
19.6	Sign Lighting/Electrical Calculations	EA	1		0	
19.7	Quantities	LS	1	8	8	
19.8	Cost Estimate	LS	1	2	2	
19.9	Technical Special Provisions and Modified Special Provisions	LS	1		0	
19.10	Signing and Pavement Marking plans	EA	4	5	20	2 SHEETS WILL BE REVISED TWICE FOR THE 2 PHASES
Signing and Pavement Marking Analysis Technical Subtotal					30 ✓	
19.11	Field Reviews	LS	1		0	
19.12	Technical Meetings	LS	1		0	
19.13	Quality Assurance/Quality Control	LS	%		0	
19.14	Independent Peer Review	LS	%		0	
19.15	Supervision	LS	%		0	
Signing and Pavement Marking Analysis Nontechnical Subtotal					0	
19. Signing and Pavement Marking Analysis Total					30	

Estimator:

Australian Ave (Banyan Blvd - 45th St)

2021827

Task No.	Task	Units	No. of Units	Hours/ Units	Total Hours	Comments
21.1	Traffic Data Collection	LS	1	0	0	
21.2	Traffic Data Analysis	PI	0	0	0	
21.3	Signal Warrant Study	LS	1	0	0	
21.4	System Timings	LS	1	0	0	
21.5	Reference and Master Signalization Design File	PI	2	40	80	
21.6	Reference and Master Interconnect Communication Design File	LS	1	0	0	
21.7	Overhead Street Name Sign Design	EA	0	2	0	
21.8	Pole Elevation Analysis	LS	1	8	8	
21.9	Traffic Signal Operation Report	LS	1	0	0	
21.10	Quantities	LS	1	8	8	
21.11	Cost Estimate	LS	1	8	8	
21.12	Technical Special Provisions and Modified Special Provisions	LS	0	0	0	
21.13	Other Signalization Analysis	LS				
Signalization Analysis Technical Subtotal					104	
21.14	Field Reviews	LS	1	6	6	2 employees
21.15	Technical Meetings	LS	1	4	4	Meetings are listed below
Signalization Analysis Nontechnical Subtotal					10	
21.19	Coordination	LS	%	0%	0	
21. Signalization Analysis Total					114	

Australian Ave (Banyan Blvd - 45th St)
2021827

Task No.	Task	Scale	Units	No of Units	Hours/ Unit	No. of Sheets	Total Hours	Comments
22.1	Key Sheet		Sheet	2	2	2	4	SPLIT PROJECT TO 2 PHASES
22.2	General notes and pay item notes		Sheet	1	2	1	2	
22.3	Tabulation of Quantities		Sheet	2	8	2	16	
22.4	plan sheets		Sheet	2	12	2	24	
22.5	Misc Plan Sheet		Sheet	1	11	1	11	25TH Street could be designed as span wire
22.6	Interconnect Plans		Sheet	1	0	1	0	
22.7	Traffic Monitoring Site		EA	0	0		0	
22.8	Guide Sign Worksheet		EA	1	0		0	
22.9	Special Details		Sheet	1	0	1	0	
22.10	Service Point Details		EA	1	0	1	0	
22.11	Mast Arm/Monotube Tabulation Sheet		PI	1	5	1	5	
22.12	Strain Pole Schedule		PI	0	0	0	0	
22.13	TTCP Signal		EA	0	0	0	0	
22.14	Temporary Detection Sheet		PI	0	0		0	
22.15	Utility Conflict Sheet		Sheet	1	4	1	4	
22.16	signature sheets		EA	2	2		4	
Signalization Plans Technical Subtotal						13	70	
22.17	Quality Assurance/Quality Control		LS	%	0%		0	
22.18	Supervision		LS	%	0%		0	
22. Signalization Plans Total						13	70	

ESTIMATE OF WORK EFFORT AND COST PRIME CONSULTANT

Name of Project: Australian Avenue Drainage Improvements from Banyan Boulevard to 45th Street
Project No.: 2021827
County: Palm Beach

Consultant Name: HSQ Group, LLC
Estimator: NS

Staff Classification	Total Staff Hours From "SH Summary - Firm"	Principal Engineer	Senior Engineer	Project Manager	Project Engineer	Engineer Intern	SH By Activity	Salary Cost By Activity	Average Rate Per Task
		\$72.00	\$65.00	\$70.00	\$54.00	\$35.00			
3. Post design	410	21	123	123	41	102	410	\$23,901	\$58.30
Total Roadway Basic Staff Hours	410	21	123	123	41	102	410		
Total Roadway Basic Staff Cost		\$1,512.00	\$7,995.00	\$8,610.00	\$2,214.00	\$3,570.00		\$23,901.00	\$58.30

Approved Multiplier 3.00

SALARY RELATED ROADWAY BASIC STAFF COSTS X 3: ✓
OPTIONAL SERVICES
GRAND TOTAL ESTIMATED FEE: \$71,703.00 ✓

Australian Ave (Banyan Blvd - 45th St)
2021827

Task No.	Task	Units	No of Units	Hours/ Unit	Total Hours	Comments
1.0	review as built	EA	2	40	80	
2.0	Shop drawings for 2 phases	EA	190	1	190	2 limerock + 2 asphalt mix+ 2 curb + 2 sidewalks+2 filter fabric+ 2 pipes+ 2 sediment barrier+ 2 flowable fill+ 4 misc asphalt+ 2 gravity walls+ 11 control structures+ 1 yard drains+ 115 drainage inlets+ 1 flumes+ 17 MH+ 2 FD pipes and stones+ 2 pipe handrail+ 2 GR and end treatments+ 2 conduites+ 6 pull boxes+ 2 PVC pipes+ 6 drainage pipe liner
3.0	Respond to RFI	EA	40	2	80	
4.0	Revise plans as needed for potential changes in the field	EA	20	3	60	
3. Total					410	✓



February 5, 2025

Australian Avenue – Banyan Boulevard to 45th Street

Temporary Traffic Control Plans Design

Scope of Services – Revision 2

Project Description and Basic Services:

Australian Avenue, from Banyan Boulevard to 45th Street, is being reconstructed to provide a four-lane divided facility with 11 ft travel lanes, outside 4 ft paved shoulders, curb & gutter (inside and outside), and 6-8 ft sidewalks. The project improvements include eight signalized intersections (Banyan Blvd, 7th St, Palm Beach Lakes Blvd, 15th St, 25th St, 36th St, 42nd St and 45th St) and two bridge replacements (Clear Lake Bridge and Carver Canal Bridge). To implement the improvements, Temporary Traffic Control Plans (TTCP) are to be prepared. The TTCP will offer an approach to construct the proposed improvements while maintaining reasonable traffic flow, access, and pedestrian detours. The TTCP will address the installations of roadway, drainage, structures, traffic signals, lighting, and utilities infrastructure. Due to the complexity of the proposed improvements, detailed traffic control plan sheets for each construction phase are recommended. TTCP phasing is anticipated to accommodate the bridge construction sequencing as currently shown on the structural (bridge) plans. If it is determined that the current bridge construction sequencing needs to be modified to complement the TTCP phasing for any reason, then this work will be considered as optional services.

The TTCP design will be divided in two standalone components to support the two construction segments with the same limits:

- 1. South Segment: Banyan Boulevard to south of 25th Street
- 2. North Segment: South of 25th Street to 45th Street

Each segment set of plans will include: TTCP Notes, Phase Typical Sections, TTCP sheets for each phase, temporary signalization plans and TTCP quantities.

Design Submittals:

Two submittals of the TTCP set to Palm Beach County are anticipated for each segment: 60% and Final submittal. FDOT Standard Index 102 Series, FDOT Pay Items, and FDOT Specifications will be used to develop the TTCP.

60% Submittal	Final Submittal
60% TTCP Set	60% Comment Responses/Final TTCP Set
Engineer's Cost Estimate	Engineer's Cost Estimate
	Traffic Control Summary of Quantities

Summary of Basic Services for each segment include:

- Prepare a set of TTCP including TTCP Notes, Phase Typical Sections, TTCP Sheets, and Temporary Signalization Plans.
- Prepare Traffic Control Summary of Quantities.
- Develop Engineer's Cost Estimate for TTCP Items.
- Coordination tasks and meetings with Palm Beach County and City of West Palm Beach.



Australian Avenue from Banyan Boulevard to 45th Street

Optional Services will include:

- Post Design Services for TTCP
- Special Traffic Control Details, Detour Plans
- Modifying Bridge Construction Sequencing

ESTIMATE OF WORK EFFORT AND COST - SUBCONSULTANT								
Name of Project:		Australian Avenue Drainage Improvements - TTCP				Consultant Name: Stanley Consultants Inc.		
County:		South Segment (Banyan Blvd to south of 25th Street)				Consultant Project No.: 30693.01		
FPN:		Palm Beach County				Date: 4/8/2025		
FAP No.:		2021827 (Palm Beach County Project Number)				Estimator: CK / AA / RJ		
		N/A						
Staff Classification	Total Staff Hours From "SH Summary Firm"	Project Manager	Senior Engineer	Project Engineer	Senior Designer	SH By Activity	Salary Cost By Activity	Average Rate Per Task
4. Roadway Analysis	460	115	230	92	22	459	\$28,936	\$63.04
5. Roadway Plans	167	33	33	68	33	167	\$9,579	\$57.36
6a. Drainage Analysis	50	10	40	0	0	50	\$3,300	\$66.00
22. Signalization Plans	80	15	33	24	8	80	\$4,843	\$60.54
Total Staff Hours	757	173	336	184	63	756		
Total Staff Cost		\$12,110.00	\$21,840.00	\$9,936.00	\$2,772.00		\$46,658.00	\$61.72

Check = \$46,658.00

BASIC SERVICES - RAW LABOR	\$46,658.00
BASIC SERVICES + MULTIPLIER (3.0)	\$139,974.00
TOTAL BASIC SERVICES (SOUTH SEGMENT)	\$139,974.00
TOTAL BASIC SERVICES (NORTH SEGMENT)	\$127,605.00
TOTAL BASIC SERVICE	\$267,579.00
*OPTIONAL SERVICES-POST DESIGN SERVICES	\$8,100.00
*OPTIONAL SERVICES-SPECIAL TRAFFIC CONTROL DETAILS, DETOUR PLANS	\$46,740.00
*OPTIONAL SERVICES-NEW BRIDGE CONSTRUCTION SEQUENCING	\$36,483.00
TOTAL OPTIONAL SERVICES	\$91,323.00
GRAND TOTAL ESTIMATED FEE:	\$358,902.00

Estimator: RJ/CJK		4. Roadway Analysis Staff Hours				Australian Avenue Drainage Improvements - TTCP South Segment (Banyan Blvd to south of 25th Street) 2021827 (Palm Beach County Project Number)			
Representing		Print Name				Signature / Date			
Palm Beach County									
Stanley Consultants Inc.									
NOTE: Signature Block is optional, per District preference									
Task No.	Task	Project Parameter			Staff Hours				Documentation
		Description	Units	Complexity	Calculated	Department	Consultant	Negotiated	Provide documentation when negotiated hours differ from the calculated hours.
What is the overall project complexity? (See Roadway Guidelines)					Upper				
4.12	TTCP Analysis	LS	1	Upper	100	0	100	0	Begin Limit - Approximate Station 303+00. End Limit Approximate Station 395+00 to include transitions at each end. 1.75 miles X 3 major phases = 1.75 x 3 = 5.25 miles total, 210 / 5.25 = 40 hrs/mi
	Length (Phase-Miles)	5.25	Upper	210	0	210	0		
	TTCP Master Design Files	Pedestrian	1	Complex	40	0	40	0	
4.14	TTCP Quantities for EQ Report	Major Phases	3	Complex	36	0	36	0	12 hr / Phase
4.15	Cost Estimate	Engineer Estimate	2	Upper	28	0	28	0	14 hr / submittal
		LRE Updates	0	Upper	0	0	0	0	
4.17	Other Roadway Tasks	Other Analysis			0	0	24	0	Estimate duration of TTCP phases.
Roadway Analysis Technical Subtotal					414	0	438	0	
4.20	Roadway Meetings (listed below)	Meetings	5		10	0	10	0	
4.21	Field Reviews (listed below)	LS			12	0	12	0	
Roadway Analysis Non-Technical Subtotal					22	0	22	0	
4.22	Coordination	LS	0	3%	0	0	0	0	
4. Roadway Analysis Total					436	0	460	0	

Carries to Summary Tab

Technical Meetings	# Meetings Designer	Travel Time (Hours)	# Meetings PM	Documentation
Typical Section	0	0	0	
Pavement Design	0	0	0	
Access Management / Driveways	0	0	0	
15% Line and Grade	0	0	0	
RRR / ECAR Resolution	0	0	0	
Local Governments (cities, counties, MPO)	1	0	1	City of WPB
Work Zone Traffic Control	2	0	2	
30/60/90/100% Comment Review Meetings	0	0	2	Meeting with the County
Utility Coordination	0	0	0	
Other Meetings	2	0	0	
Subtotal Technical Meetings	5	0	5	
Progress Meetings (if required by FDOT)	0	0		
Phase Review Meetings	0	0		
Total Roadway Meetings	5	0		

Field Reviews	# of Staff	Site Time (per staff)	Travel Time (per staff)	Total Hours
Field Review #1	2	2	1	6
Field Review #2	2	2	1	6
Field Review #3	0	0	0	0
Field Review #4	0	0	0	0
Plans-in-hand Field Review	0	0	0	0
Total Field Review Hours				12

Estimator: RJ/CJK

5. Roadway Plans Staff Hours

Australian Avenue Drainage Improvements - TTCP South Segment (Banyan Blvd to south of 25th Street)
2021827 (Palm Beach County Project Number)

Representing	Print Name		Signature / Date	
Palm Beach County				
Stanley Consultants Inc.				

NOTE: Signature Block is optional, per District preference

Task No.	Task	Project Parameter			Staff Hours				Documentation
		Description	Units	Complexity	Calculated	Department	Consultant	Negotiated	Provide documentation when negotiated hours differ from the calculated hours.
What is the overall project complexity? (See Roadway Guidelines)									
5.14	Temporary Traffic Control Plan	TTC Notes	1	Above	4	0	4	0	
		Length (Miles)	5.25	Above	147	0	147	0	Begin Limit - Approximate Station 303+00. End Limit Approximate Station 395+00 to include transitions at each end. 1.75 miles X 3 major phases = 1.75 x 3 = 5.25 miles total that require TTCP plan sheets 147/5.25 mi = 28 hr / ml
		TTC Details	2		16	0	16	0	8 / Detail
		Roadway Plans Technical Hours Subtotal				167	0	167	0
Roadway Plans Total				167	0	167	0		

Cartello Summary Tab

Estimator: RJ

6a. Drainage Analysis Staff Hours

Australian Avenue Drainage Improvements - TTCP South Segment (Banyan Blvd to south of 25th Street)
2021627 (Palm Beach County Project Number)

Representing	Print Name	Signature / Date
Palm Beach County		
Stanley Consultants Inc.		

NOTE: Signature Block is optional, per District preference

Task No.	Task	Project Parameter			Staff Hours				Documentation
		Description	Units	Complexity	Calculated	Department	Consultant	Negotiated	Provide documentation when negotiated hours differ from the calculated hours.
6a.6	Temporary Drainage Analysis	LS	1	Complex	40	0	40	0	
Drainage Analysis Technical Subtotal					40	0	40	0	
6a.27	Drainage Meetings (listed below)	Meetings	1		2	0	2	0	
		Travel Time			0	0	0	0	
6a.28	Field Reviews (listed below)	LS			6	0	6	0	
Drainage Analysis Non-Technical Subtotal					6	0	6	0	
6a.29	Coordination	%	1	3%	2	0	2	0	
Drainage Analysis Total					50	0	50	0	

Continue Summary Tab

Technical Meetings	# Meetings Designer	Travel Time (Hours)	# Meetings PM	Documentation
Base Clearance Water Elevation	0	0	0	
Pond Siting	0	0	0	
Agency	0	0	0	
Local Governments (cities, counties)	0	0	0	
FDOT Drainage	0	0	0	
Utility Coordination	0	0	0	
Other Meetings	0	0	0	
Subtotal Technical Meetings	0	0	0	
Progress Meetings (if required by FDOT)	0	0		
Phase Review Meetings	1	0		
Total Drainage Meetings	1	0		

Field Reviews	# of Staff	Site Time (per staff)	Travel Time (per staff)	Total Hours
Field Review #1	2	2	1	6
Field Review #2	0	0	0	0
Field Review #3	0	0	0	0
Field Review #4	0	0	0	0
Plans-in-hand Field Review	0	0	0	0
Total Field Review Hours				6

Estimator		22. Signalization Plans Staff Hours				Australian Avenue Drainage Improvements - TTCP South Segment (Banyan Blvd to south of 25th Street) 2021027 (Palm Beach County Project Number)			
Representing		Print Name				Signature / Date			
Palm Beach County									
Stanley Consultants Inc.									
NOTE: Signature Block is optional, per District preference									
Task No.	Task	Project Parameter			Staff Hours				Documentation
		Description	Units	Complexity	Calculated	Department	Consultant	Negotiated	Provide documentation when negotiated hours differ from the calculated hours.
What is the overall project complexity? (See Signalization Guidelines)				Mid					
22.11	TTCP Signal	Intersections with pod signal	4	Mid	96	0	64	0	Banyan Blvd, 7th Street, Palm Beach Lakes Blvd, 15th Street. 25th Street included in South segment. 96/4 = 24 hr / int.
22.12	Temporary Detection Sheet	Intersections	4		16	0	16	0	Bayan Blvd, 7th Street, Palm Beach Lakes Blvd, 15th Street. 25th Street included in South segment. 16/4 = 4 hr / int
Signalization Plans Technical Hours Subtotal					112	0	80	0	
Signalization Plans Total					112	0	80	0	

Carried to Summary Tab

ESTIMATE OF WORK EFFORT AND COST - SUBCONSULTANT								
Name of Project:		Australian Avenue Drainage Improvements - TTCP North Segment (South of 25th Street to 45th Street)				Consultant Name: Stanley Consultants Inc.		
County:		Palm Beach County				Consultant Project No.: 30693.01		
FPN:		2021827 (Palm Beach County Project Number)				Date: 4/8/2025		
FAP No.:		N/A				Estimator: CK / AA		
Staff Classification	Total Staff Hours From "SH Summary Firm"	Project Manager	Senior Engineer	Project Engineer	Senior Designer	SH By Activity	Salary Cost By Activity	Average Rate Per Task
4. Roadway Analysis	424 ✓	106	212	85	21	424	\$26,714	\$63.00
5. Roadway Plans	142 ✓	28	28	58	28	142	\$8,144	\$57.35
6a. Drainage Analysis	48 ✓	10	38	0	0	48	\$3,170	\$66.04
9. Structures - Misc. Tasks, Dwgs, Non-Tech.	14 ✓	3	7	3	1	14	\$871	\$62.21
22. Signalization Plans	60 ✓	12	24	18	6	60	\$3,636	\$60.60
Total Staff Hours		688 ✓	159	309	164	56	688	
Total Staff Cost			\$11,130.00	\$20,085.00	\$8,856.00	\$2,464.00	\$42,535.00	\$61.82

Check = \$42,535.00

BASIC SERVICES - RAW LABOR	\$42,535.00 ✓
BASIC SERVICES + MULTIPLIER (3.0)	\$127,605.00
TOTAL BASIC SERVICES (NORTH SEGMENT)	\$127,605.00 ✓

Estimator: RJ/CK

4. Roadway Analysis Staff Hours

Australian Avenue Drainage Improvements - TTCP North Segment (South of 25th Street to 45th Street)
2021027 (Palm Beach County Project Number)

Representing		Print Name				Signature / Date			
Palm Beach County									
Stanley Consultants Inc.									

NOTE: Signature Block is optional, per District preference

Task No.	Task	Project Parameter			Staff Hours				Documentation	
		Description	Units	Complexity	Calculated	Department	Consultant	Negotiated	Provide documentation when negotiated hours differ from the calculated hours.	
4.12	What is the overall project complexity? (See Roadway Guidelines)			Upper	100	0	100	0	Begin Limit - Approximate Station 386+00. End Limit Approximate Station 461+00 to include transitions at each end. 1.45 miles X 3 major phases = 1.45 X 3 = 4.35 miles total. 174 / 4.35 = 40 hr / mi	
	TTCP Analysis		LS	1						Upper
	TTCP Master Design Files		Length (Phase-Miles)	4.35	Upper	174	0	174		0
			Pedestrian	1	Complex	40	0	40		0
	TTCP Quantities for EQ Report		Major Phases	3	Complex	36	0	36		0
4.15	Cost Estimate	Engineer Estimate	2	Upper	28	0	28	0	14 hr / pphase	
4.17	Other Roadway Tasks	Other Analysis			0	0	24	0	Estimate duration of TTCP phases.	
Roadway Analysis Technical Subtotal					378	0	402	0		
4.20	Roadway Meetings (listed below)	Meetings	5		10	0	10	0		
4.21	Field Reviews (listed below)	LS			12	0	12	0		
Roadway Analysis Non-Technical Subtotal					22	0	22	0		
4.22	Coordination	LS	0	3%	0	0	0	0		
4. Roadway Analysis Total					400	0	424	0		

Click to Summary Tab

Technical Meetings	# Meetings Designer	Travel Time (Hours)	# Meetings PM	Documentation
Typical Section	0	0	0	
Pavement Design	0	0	0	
Access Management / Driveways	0	0	0	
15% Line and Grade	0	0	0	
RRR / ECAR Resolution	0	0	0	
Local Governments (cities, counties, MPO)	1	0	1	City of WPB
Work Zone Traffic Control	2	0	2	
30/60/90/100% Comment Review Meetings	0	0	2	
Utility Coordination	0	0	0	
Other Meetings	2	0	0	
Subtotal Technical Meetings	5	0	5	
Progress Meetings (if required by FDOT)	0	0		
Phase Review Meetings	0	0		
Total Roadway Meetings	5	0		

Field Reviews	# of Staff	Site Time (per staff)	Travel Time (per staff)	Total Hours
Field Review #1	2	2	1	6
Field Review #2	2	2	1	6
Field Review #3	0	0	0	0
Field Review #4	0	0	0	0
Plans-in-hand Field Review	0	0	0	0
Total Field Review Hours				12

Estimator: RJ/CK		5. Roadway Plans Staff Hours				Australian Avenue Drainage Improvements - TTCP North Segment (South of 25th Street to 45th Street) 2021027 (Palm Beach County Project Number)			
Representing		Print Name				Signature / Date			
Palm Beach County									
Stanley Consultant Inc.									
NOTE: Signature Block is optional, per District preference									
Task No.	Task	Project Parameter			Staff Hours				Documentation
		Description	Units	Complexity	Calculated	Department	Consultant	Negotiated	
What is the overall project complexity? (See Roadway Guidelines)					Above				Provide documentation when negotiated hours differ from the calculated hours.
5.14	Temporary Traffic Control Plan	TTC Notes	1		4	0	4	0	
		Length (Miles)	4.35	Above	122	0	122	0	Begin Limit - Approximate Station 386+00. End Limit Approximate Station 461+00 to include transitions at each end. 1.45 miles X 3 major phases = 1.45 X 3 = 4.35 miles total require TTCP plan sheets. 122 / 4.35 = 28 hr / ml
		TTC Details	2		16	0	16	0	8 hour detail
5.15	Utility Adjustment Sheets	Length (Miles)	0.00		0	0	0	0	
5.16	Project Control Sheets		0		0	0	0	0	
5.17	Utility Verification Data (SUE)		0		0	0	0	0	
Roadway Plans Technical Hours Subtotal					142	0	142	0	
5.18	Quality Assurance/Quality Control	%	0	5%	0	0	0	0	
5.19	Supervision	%	0	5%	0	0	0	0	
Roadway Plans Total					142	0	142	0	

Copies to Summary Tab

Estimator: RJ		6a. Drainage Analysis Staff Hours				Australian Avenue Drainage Improvements - TTCP North Segment (South of 25th Street to 45th Street) 2021627 (Palm Beach County Project Number)			
Representing		Print Name				Signature / Date			
Palm Beach County									
Stanley Consultants Inc.									
NOTE: Signature Block is optional, per District preference									
Task No.	Task	Project Parameter			Staff Hours				Documentation
		Description	Units	Complexity	Calculated	Department	Consultant	Negotiated	Provide documentation when negotiated hours differ from the calculated hours.
6a.6	Temporary Drainage Analysis	LS	1	Complex	40	0	40	0	
Drainage Analysis Technical Subtotal					40	0	40	0	
6a.27	Drainage Meetings (listed below)	Meetings	1		2	0	2	0	
6a.28	Field Reviews (listed below)	LS			6	0	6	0	
Drainage Analysis Non-Technical Subtotal					8	0	8	0	
6a.29	Coordination	%		3%	0	0	0	0	
Drainage Analysis Total					48	0	48	0	

Carries to Summary Tab

Technical Meetings	# Meetings Designer	Travel Time (Hours)	# Meetings PM	Documentation
Base Clearance Water Elevation	0	0	0	
Pond Siting	0	0	0	
Agency	0	0	0	
Local Governments (cities, counties)	0	0	0	
FDOT Drainage	0	0	0	
Utility Coordination	0	0	0	
Other Meetings	0	0	0	
Subtotal Technical Meetings	0	0	0	
Progress Meetings (if required by FDOT)	0	0		
Phase Review Meetings	1	0		
Total Drainage Meetings	1	0		

Field Reviews	# of Staff	Site Time (per staff)	Travel Time (per staff)	Total Hours
Field Review #1	2	2	1	6
Field Review #2	0	0	0	0
Field Review #3	0	0	0	0
Field Review #4	0	0	0	0
Plans-in-hand Field Review	0	0	0	0
Total Field Review Hours				6

Estimator:

Australian Avenue Drainage Improvements - TTCP North Segment (South of 25th Street to 45th Street)
2021827 (Palm Beach County Project Number)

Representing	Print Name	Signature / Date
FDOT District		
Consultant Name		

NOTE: Signature Block is optional, per District preference

Task No.	Task	Units	Design and Production Staffhours				Comments
			No. of Units	Hours per Unit	No. of Sheets	Total	
	General Drawings						
9.4	Miscellaneous Common Details	Sheet	1	14	1	14	Provide FDOT Standard Plans to Caver Canal Bridge Plan set and preparing two sets of structures plans. Splitting plan sets
Structures - Summary and Miscellaneous Tasks and Drawings					1	14	
9. Structures - Summary and Miscellaneous Tasks and Drawings					14		

Technical Meetings	Units	No of Units	Hours/ Unit	Total Hours	Comments	PM Attendance at Meeting Required?	Number
BDR Coordination/Review	EA	0	0	0			0
90/100% Comment Review	EA	0	0	0			0
Aesthetics Coordination	EA	0	0	0			0
Regulatory Agency	EA	0	0	0			0
Local Governments (cities, counties)	EA	0	0	0			0
Utility Companies	EA	0	0	0			0
Other Meetings	EA	0	0	0			0
Subtotal Technical Meetings				0			0
Progress Meetings (if required by FDOT)	EA	0	0	0	PM attendance at Progress Meetings is manually entered on General Task 3		--
Phase Review Meetings	EA	0	0	0	PM attendance at Phase Review Meetings is manually entered on General Task 3		--
Total Meetings				0	Total Project Manager Meetings (carries to Tab 3)		0

Estimator: CK/AA		22. Signalization Plans Staff Hours				Australian Avenue Drainage Improvements - TTCP North Segment (South of 25th Street to 45th Street) 2021027 (Palm Beach County Project Number)			
Representing		Print Name				Signature / Date			
Palm Beach County									
Stanley Consultants Inc.									
NOTE: Signature Block is optional, per District preference									
Task No.	Task	Project Parameter			Staff Hours				Documentation
		Description	Units	Complexity	Calculated	Department	Consultant	Negotiated	Provide documentation when negotiated hours differ from the calculated hours.
What is the overall project complexity? (See Signalization Guidelines)									
22.11	TTCP Signal	Intersections with ped signal	3	Mid	72	0	48	0	25th Street, 36th Street, 45th Street. No current signal at 42nd Street, so none required. 3 intersections at 16 hrs/each = 48hrs. 72 / 3 = 24 hr / Int
22.12	Temporary Detection Sheet	Intersections	3		12	0	12	0	25th Street, 36th Street, 45th Street. No current signal at 42nd Street, so none required. 12 / 3 = 4 hr / Int
Signalization Plans Technical Hours Subtotal					84	0	60	0	
Signalization Plans Total					84	0	60	0	

Carries to Summary Tab

ESTIMATE OF WORK EFFORT AND COST - SUBCONSULTANT								
Name of Project:		Australian Avenue Drainage Improvements - TTCP				Consultant Name: Stanley Consultants Inc.		
County:		Palm Beach County				Consultant Project No.: 30693.01		
FPN:		2021827 (Palm Beach County Project Number)				Date: 2/6/2025		
FAP No.:		N/A				Estimator: CK / AA / RJ		
Staff Classification	Total Staff Hours From "SH Summary Firm"	Project Manager	Senior Engineer	Project Engineer	Senior Designer	SH By Activity	Salary Cost By Activity	Average Rate Per Task
3. General Tasks (OPTIONAL SERVICES)	40	20	20	0	0	40	\$2,700	\$67.50
Total Staff Hours	40	20	20	0	0	40		
Total Staff Cost		\$1,400.00 ✓	\$1,300.00 ✓	\$0.00	\$0.00		\$2,700.00	\$67.50

Check = \$2,700.00

OPTIONAL SERVICES - RAW LABOR	\$2,700.00 ✓
OPTIONAL SERVICES + MULTIPLIER (3.0)	\$8,100.00
TOTAL OPTIONAL SERVICES (MLA)	\$8,100.00 ✓

Project Activity 3: General Tasks

Estimator: CK / AA						Australian Avenue Drainage Improvements - TTCP 2021827 (Palm Beach County Project Number)	
Representing		Print Name			Signature / Date		
Palm Beach County							
Consultant Name		Stanley Consultants Inc.					
NOTE: Signature Block is optional, per District preference							
Task No.	Task	Units	No of Units	Hours/ Unit	Total Hours	Comments	
3.0	Post Design Services	LS	1	40	40	40 hrs to provide responses to RFI's, RFM, shop drawing reviews and attend necessary construction meetings for TTCP Items. OPTIONAL SERVICES	
3. Post Design Services Total					40		

ESTIMATE OF WORK EFFORT AND COST - SUBCONSULTANT								
Name of Project:		Australian Avenue Drainage Improvements - TTCP (TTCP Special Details and Detours - Optional Services)				Consultant Name: Stanley Consultants Inc.		
County:		Palm Beach County				Consultant Project No.: 30693.01		
FPN:		2021827 (Palm Beach County Project Number)				Date: 2/11/2025		
FAP No.:		N/A				Estimator: CK / AA / RJ		
Staff Classification	Total Staff Hours From "SH Summary Firm"	Project Manager	Senior Engineer	Project Engineer	Senior Designer	SH By Activity	Salary Cost By Activity	Average Rate Per Task
4. Roadway Analysis	101 ✓	25	51	20	5	101	\$6,365	\$63.02
5. Roadway Plans	156 ✓	31	55	39	31	156	\$9,215	\$59.07
Total Staff Hours		56	106	59	36	257		
Total Staff Cost		\$3,920.00	\$6,890.00	\$3,186.00	\$1,584.00		\$15,580.00	\$60.62

Check = \$15,580.00

OPTIONAL SERVICES - RAW LABOR	\$15,580.00 ✓
OPTIONAL SERVICES + MULTIPLIER (3.0)	\$46,740.00 ✓
TOTAL OPTIONAL SERVICES	\$46,740.00 ✓

Estimator:		4. Roadway Analysis Staff Hours							Australian Avenue Drainage Improvements - TTCP 2021827 (Palm Beach County Project Number)	
Representing		Print Name						Signature / Date		
Palm Beach County										
Stanley Consultants, Inc.										
NOTE: Signature Block is optional, per District preference										
Task No.	Task	Project Parameter			Staff Hours				Documentation	
		Description	Units	Complexity	Calculated	Department	Consultant	Negotiated		
What is the overall project complexity? (See Roadway Guidelines)									Provide documentation when negotiated hours differ from the calculated hours.	
4.1	Typical Section Package	Cover	0		0	0	0	0		
		Typical	0	2-Lane FS & Ramps	0	0	0	0		
		Typical	0	2-Lane C & Multi-Lane FS	0	0	0	0		
		Typical	0	LA w/ Barrier & Multi-Lane C	0	0	0	0		
4.2	Pavement Type Selection Report	Report	0		0	0	0	0		
4.3	Pavement Design Package	Report & Assembly	0		0	0	0	0		
		Pavt Designs	0	Travel/Aux. Lanes	0	0	0	0		
		Pavt Designs	0	Other Roads & Shoulders	0	0	0	0		
4.4	Cross Slope Analysis (lanes and shoulders)	X-Slope Assessment	0.00	Undivided Roadway	0	0	0	0		
		X-Slope Assessment	0.00	Divided Roadway	0	0	0	0		
		Concepts for Corrections	0		0	0	0	0		
4.5	Safety Analysis	HSM Assessment	0		0	0	0	0		
		Crash Analysis	0		0	0	0	0		
4.6	Design Analysis	Monitor Exist. Structures	0		0	0	0	0		
		Access Management	0.00		0	0	0	0		
4.7	Operational Analysis	Roundabout	0	1x1 Roundabout	0	0	0	0		
		Roundabout	0	1x2 Roundabout	0	0	0	0		
		Roundabout	0	2x2 Roundabout	0	0	0	0		
4.8	Design Reports	RRR	0		0	0	0	0		
		Other Reports			0	0	0	0		
4.9	Design Variations and Exceptions	Variation Memo	0		0	0	0	0		
		Formal Variation	0		0	0	0	0		
		Design Exception	0		0	0	0	0		
4.10	Master Design File Setup & Maintenance, Model Management Plan	LS	0		0	0	0	0		

4.11	Horizontal /Vertical Master Design Files	Mainline	0.00		0	0	0	0	
		Side Road & Ramps	0.00		0	0	0	0	
		Frontage Road	0.00		0	0	0	0	
	3D Modeling Development	Mainline	0.00		0	0	0	0	
		Side Road & Ramps	0.00		0	0	0	0	
		Frontage Road	0.00		0	0	0	0	
		AMG Files	0		0	0	0	0	
4.12	TTCP Analysis	LS	0		0	0	32	0	Analysis for detours and special details - (16 hours south segment, 16 hours north segment)
	TTCP Master Design Files	Length (Phase-Miles)	0.00		0	0	50	0	Updates to TTCP design files for detour and special details (25 hours south segment, 25 hours north segment)
		Pedestrian	0		0	0	0	0	
	TTCP 3D Modeling (Isolated Locations)	Locations	0		0	0	0	0	
4.13	Utility Data Collection & Analysis	LS	0		0	0	0	0	
4.14	Roadway Quantities for EQ Report	Length (Miles)	0.00		0	0	0	0	
		Interchanges Rest Areas	0		0	0	0	0	
		Validation	0		0	0	0	0	
	TTCP Quantities for EQ Report	Major Phases	0		0	0	8	0	Updates to quantities for Detours and Special Details (4 hours for south segment, 4 hours for north segment)
4.15	Cost Estimate	Engineer Estimate	0		0	0	8	0	Updates to cost estimate for Detours and Special Details (4 hours for south segment, 4 hours for north segment)
		LRE Updates	0		0	0	0	0	
4.16	Technical or Modified Special Provisions	TSPs & MSPs	0		0	0	0	0	
4.17	Other Roadway Tasks	Other Analysis			0	0	0	0	
Roadway Analysis Technical Subtotal					0	0	98	0	
4.18	Quality Assurance/Quality Control	LS	0	5%	0	0	0	0	
4.19	Supervision	LS	0	5%	0	0	0	0	
4.20	Roadway Meetings (listed below)	Meetings	0		0	0	0	0	
		Travel Time			0	0	0	0	
4.21	Field Reviews (listed below)	LS			0	0	0	0	
Roadway Analysis Non-Technical Subtotal					0	0	0	0	
4.22	Coordination	LS	1	3%	0	0	3	0	
4. Roadway Analysis Total					0	0	101	0	

Continue to Summary Tab

Technical Meetings	# Meetings Designer	Travel Time (Hours)	# Meetings PM	Documentation
Typical Section	0	0	0	
Pavement Design	0	0	0	
Access Management / Driveways	0	0	0	
15% Line and Grade	0	0	0	
RRR / ECAR Resolution	0	0	0	
Local Governments (cities, counties, MPO)	0	0	0	
Work Zone Traffic Control	0	0	0	
30/60/90/100% Comment Review Meetings	0	0	0	
Utility Coordination	0	0	0	
Other Meetings	0	0	0	
Subtotal Technical Meetings	0	0	0	
Progress Meetings (if required by FDOT)	0	0		
Phase Review Meetings	0	0		
Total Roadway Meetings	0	0		

Field Reviews	# of Staff	Site Time (per staff)	Travel Time (per staff)	Total Hours
Field Review #1	0	0	0	0
Field Review #2	0	0	0	0
Field Review #3	0	0	0	0
Field Review #4	0	0	0	0
Plans-in-hand Field Review	0	0	0	0
Total Field Review Hours				0

Estimator:		5. Roadway Plans Staff Hours							Australian Avenue Drainage Improvements - TTOP 2021827 (Palm Beach County Project Number)	
Representing		Print Name							Signature / Date	
Palm Beach County										
Stanley Consultants, Inc										
NOTE: Signature Block is optional, per District preference										
Task No.	Task	Project Parameter			Staff Hours				Documentation	
		Description	Units	Complexity	Calculated	Department	Consultant	Negotiated	Provide documentation when negotiated hours differ from the calculated hours.	
What is the overall project complexity? (See Roadway Guidelines)										
5.1	Key Sheet		0		0	0	0	0		
	Signature Sheet		0		0	0	0	0		
5.2	Typical Section Sheets	Typical Sections w/ CADD	0		0	0	0	0		
		Typical Sections w/o CADD	0		0	0	0	0		
		Partial Sections	0		0	0	0	0		
		Pavement Segments	0		0	0	0	0		
5.3	Cross Slope Correction Details		0		0	0	0	0		
5.4	General Notes/Pay Item Notes		0		0	0	0	0		
5.5	Project Layout/Model Management		0		0	0	0	0		
5.6	Plan View (Plan Sheets)	Length (Miles)	0.00		0	0	0	0		
		Interchange	0		0	0	0	0		
		Roundabout	0		0	0	0	0		
5.7	Profile View (Plan/Profile Sheets)	Length (Miles)	0.00	Flush Shoulder	0	0	0	0		
		Length (Miles)	0.00	Curbed	0	0	0	0		
5.8	Special Profiles	Driveway Curb Return	0		0	0	0	0		
		Intersection RR Xing	0		0	0	0	0		
5.9	Sidewalk Profiles	Length (Miles)	0.00		0	0	0	0		
5.10	Interchange Layout Sheet	Interchange	0	Standard 2 Levels	0	0	0	0		
			0	Complex 3+ Levels	0	0	0	0		
5.11	Details	Ramp Terminal	0		0	0	0	0		
		Intersection Layout	0		0	0	0	0		
		Special	0		0	0	0	0		
5.12	Soil Survey Sheets		0		0	0	0	0		
5.13	Cross Sections	Alignments	0		0	0	0	0		

5.14	Temporary Traffic Control Plan	TTC Notes	1		4	0	4	0	Update TTCP Notes to accommodate detours - 2 hours south segment, 2 hours north segment
		Length (Miles)	0.00		0	0	0	0	
		Critical Cross Sections	0		0	0	0	0	
		TTC Details	1		8	0	152	0	Assume 5 detours total (3 detours on south segment, 2 detours on north segment) at 16 hours each (5x16) and 6 special TTCP details (3 on south segment, 3 on north segment) at 12 hours each (6 x 12) = 152 hrs
5.15	Utility Adjustment Sheets	Length (Miles)	0.00		0	0	0	0	
5.16	Project Control Sheets		0		0	0	0	0	
5.17	Utility Verification Data (SUE)		0		0	0	0	0	
Roadway Plans Technical Hours Subtotal					12	0	156	0	
5.18	Quality Assurance/Quality Control	%	0	5%	0	0	0	0	
5.19	Supervision	%	0	5%	0	0	0	0	
Roadway Plans Total					12	0	156	0	

Continue to Summary Tab



April 17, 2025

Nour Shehadeh, PE
HSQ Group, LLC
1001 Yamato Road, Suite 105
Boca Raton, Florida 33431

Ritzel-Mason, Inc.

5330 Van Buren Road
Delray Beach, FL 33484

Subject: Fee Proposal for Surveying Services

Phone: 786.472.0358

Project: Australian Avenue – additional topo at Twin Lakes

www.ritzel-mason.com

Dear Mr. Shehadeh:

Ritzel-Mason appreciates the opportunity to prepare this fee proposal for providing specific purpose / topographic services on the above referenced project. Ritzel-Mason is registered and licensed in the state of Florida. This letter will serve as our official scope of services and is accompanied by the included fee estimate. Ritzel-Mason has been requested by the Client to provide above ground topographic surveying services.

Project Limits: The limits of our investigation will include Australian Avenue from baseline sta.331+20 to sta.340+20 from the back of the easterly sidewalk to 125' east. Limits will match to previous topographic survey. See attached exhibit for project limits as outlined in red as emailed to Ritzel-Mason on April 16, 2025.

Scope of Basic Services: Ritzel-Mason proposed **Specific Purpose Survey / Topographic Survey** as described below:

Existing horizontal and vertical control will be recovered and/or set as needed. Control will be referenced to the Palm Beach County Control Network which is the NAD83/90 and NAVD88 datums. A closed level run will be performed through set control points.

Above ground data will be obtained to create a surface of the existing conditions. Topography will include visible fixed improvements such as bank lines, natural ground, curbing, asphalt, medians, sidewalks, mast arms, overhead utility lines & directions, driveway aprons, drop curbs, above ground utilities, etc. Sufficient data will be obtained to create a DTM surface. Grade breaks will be included. The maximum interval between points on a straight line will be 50 feet and 25 feet on a curve.

Trees 4-inch DBH and greater will be located. Finish Floor Elevations within the above project limits. Maintained water elevation and edge of water for ponds are ditches are included.



Australian Avenue – additional topo at Twin Lakes

April 17, 2025

An *updated* Specific Purpose / Topographic Survey will be prepared and will meet and be certified to the applicable portions of the Standards of Practice as set forth in the Florida Board of Professional Surveyors and Mappers in rule 5J-17.050-0.52, Florida Administrative Code, pursuant to Chapter 472.027, Florida Statutes and this Appendix C and D of the Palm Beach County Roadway Design Procedures (January 2019), codes, rules and Statues governing Surveying and Mapping. 11"x17" sheets at 1"=40' scale will be prepared.

Ritzel-Mason proposes **drainage services** as described below:

Ritzel-Mason will locate drainage features and pipes including invert elevations, top of structure elevations, bottom of structure elevations, pipe directions, pipe connectivity, pipe sizes and pipe materials. Upstream and downstream structures will be located.

Deliverables (Basic Services):

- Updated DGN (SURVRD01.dgn) and PDF (digitally signed) of Specific Purpose/Topographic Survey, 11x17" sheets at 1"=40' scale
- Updated digitally signed Specific Purpose/Topographic Survey
- DTM DGN and XML
- An ASCII file of points (x,y,z)

Schedule for Basic Services:

We propose to mobilize for this work 10 business days from receipt of this proposal duly signed and barring weather and any unforeseen condition.

Client Responsibilities:

- Provide or facilitate access to project area for field investigations.

Fees: See attached spreadsheet.

Basis: The fees listed above are based on Ritzel-Mason's crews being able to work during the hours of 7:00am to 6:00pm and being granted access to the site. Ritzel-Mason is equipped to supply minor MOT services. Ritzel-Mason's field crews and equipment are not equipped or prepared to work in any area that possibly are, or may have been, contaminated with hazardous materials at any time. Any fee or permit requested in order to perform the work will be submitted to the client at cost.

Australian Avenue – additional topo at Twin Lakes

April 17, 2025



Again, we appreciate the opportunity to provide our surveying services for HSQ Group. Please call me directly at 786.472.0358, if you have any questions or comments. We look forward to beginning work on this project upon receiving your authorization to proceed.

Sincerely,

A handwritten signature in black ink, appearing to read 'Dennis Ritzel'.

Dennis Ritzel, PSM
Director of Business Operations
786.472.0358
Email: dennis@ritzel-mason.com

www.ritzel-mason.com

April 17, 2025

A SURVEYING & MAPPING FIRM

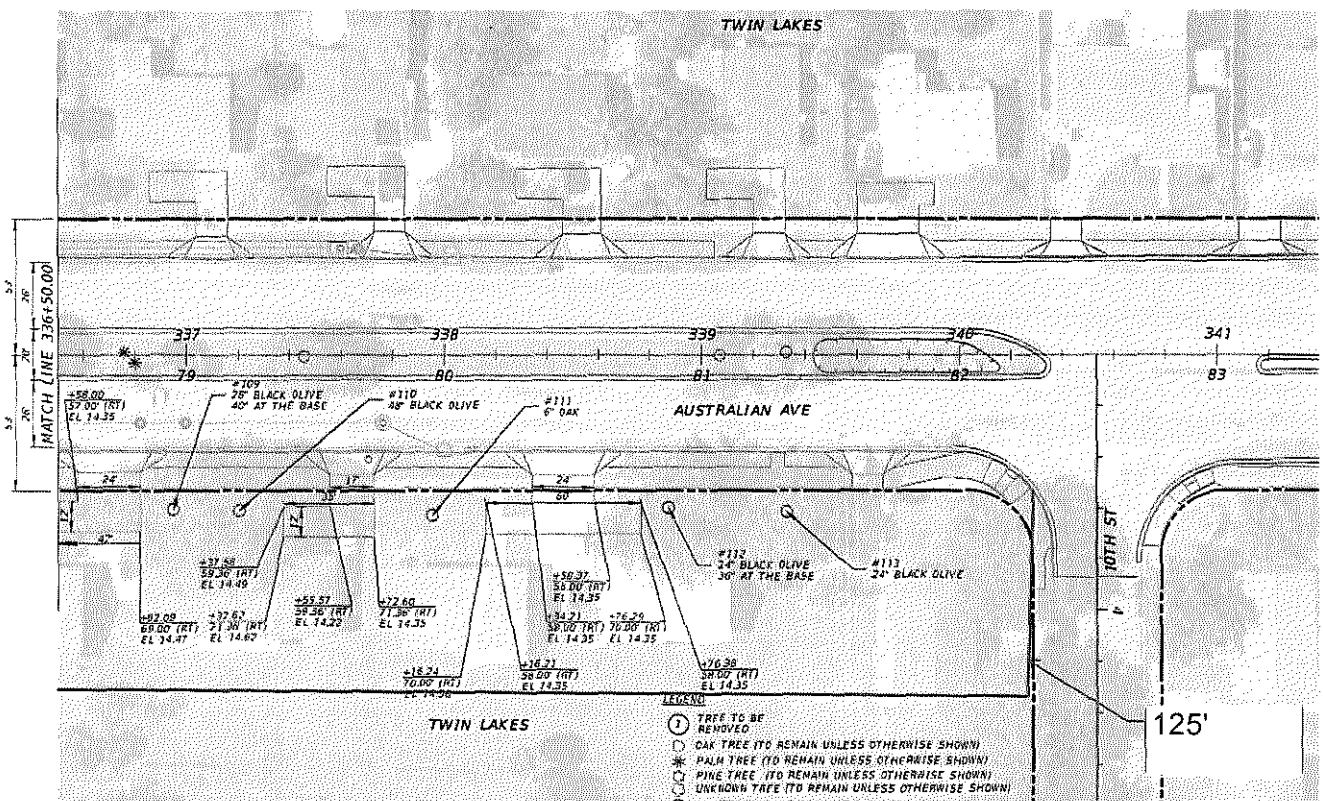

Project Activity 14: Survey - Field						
Task No.	Task	Units	No of Units	Hours/Unit	Total Hours	Comments
14.1	Horizontal Project Control (HPC)					
	2-Lane Roadway	LM	0.18	15.00	3	Establish horizontal control. Establish secondary control points. Redundant RTK VRS GPS. Datum will be NAD 83/90.
	Multi-lane Roadway	LM	0.00	0.00	0	
14.2	Vertical PC / Bench Line					
	2-Lane Roadway	LM	0.50	8.00	4	Verify vertical on PNC sheet control. Established vertical data on control. NAVD88.
	Multi-lane Roadway	LM	0.00	0.00	0	
14.3	Reference Points					
	2-Lane Roadway	EA	0.00	0.50	0	
	Multi-lane Roadway	EA	0.00	0.00	0	
14.4	Baseline Layout	LM	0.00	15.00	0	
14.5	Section, Subdivision & Property Ties	EA	0.00	2.00	0	
14.6	Topography/DTM (3D)	LM	0.18	62.00	11	full topography from 331+20 to 340+20, 100' wide
14.7	Cross Sections	EA	0.00	0.15	0	
14.8	Side Street Surveys	LM	0.00	0.00	0	
14.9	SUE	EA	0.00	0.00	0	
14.10	Locates - Pothole	EA	0.00	2.00	0	
14.11	Outfall Survey	LM	0.00	0.00	0	
14.12	Drainage Survey	EA	6.00	0.75	5	Drainage structures
14.13	Bridge Survey	EA	0.00	0.00	0	
14.14	Canal Survey	LM	0.00	0.00	0	
14.15	Channel Survey and Soundings	LS	0.00	0.00	0	
14.16	Pond Site Survey	EA	0.00	0.00	0	
14.17	Jurisdictional Line Survey	LS	0.00	0.00	0	
14.18	Tree Survey	EA	50.00	0.03	1	Locate 4-inch and greater trees
14.19	Route/Corridor Survey	LM	0.00	0.00	0	

Task No.	Task	Units	No of Units	Hours/Unit	Total Hours	Comments
14.20	Boundary Survey	LS	0.00	0.00	0	
14.21	Topographic Survey	LS	0.00	0.00	0	
14.22	Specific Purpose Survey	LS	0.00	0.00	0	
14.23	Hydrographic Survey	LS	0.00	0.00	0	
14.24	Quantity Survey	LS	0.00	0.00	0	
14.25	Record/As-Built Survey	LS	0.00	0.00	0	
14.26	R/W Staking					
	Parcel	EA	0.00	0.00	0	
	R/W Line	LM	0.00	0.00	0	
14.27	Meetings	EA	0.00	2.00	0	
14. Survey - Field Total					24	

Project Activity 15: Survey Plans						
Task No.	Task	Units	No. of Units	Hours/ Unit or Sheet	Total Hours	Comments
15.1	Alignment	EA	0.00	12.00	0	
15.2	Section and 1/4 Section Lines	EA	0.00	6.00	0	
15.3	Subdivisions / Property Lines	EA	0.00	6.00	0	
15.4	Existing R/W	EA	0.00	8.00	0	
15.5	Topography	LM	0.18	70.00	13	Process topography of intersection
15.6	Parent Tract Properties/Existing Easements	EA	0.00	0.00	0	
15.7	Title Review	LS	0.00	12.00	0	
15.8	Jurisdictional/Agency Lines	LM	1.00	0.00	0	
15.9	Survey Key Sheet	Sheet	0.00	10.00	0	
15.10	Survey Detail & Legend Sheet	Sheet	0.00	13.00	0	
15.11	Reference Point Sheet	Sheet	0.00	0.00	0	
15.12	Project Control Sheet	Sheet	0.00	10.00	0	
15.13	Specific Purpose & Topographic Survey	Sheet	2.00	7.00	14	Updated Specific Purpose & Topographic Survey
15.14	Boundary Survey	EA	0.00	0.00	0	
15.15	Technical Meetings	EA	0.00	4.00	0	
15. Survey Plans Total					27 ✓	

**HSQ GROUP, LLC**
Engineers • Planners

1001 Yamato Road • Boca Raton, Florida 33431, Suite 105 • Phone (561) 392-0221 hsqgroupinc.com

Summary Table 1

Legal Instrument #	Station location	Side	Notes	Action Required	
				Delete	Keep
TCE 301	314+50 to 315+50	Left	TCE is not needed. City property, no revisions to plans	X	
TCE 302A	307+82 to 315+00	Right	Gravity wall required if TCE is eliminated. No revision to design (city parcel)		X
TCE 302B	316+50 to 319+20	Right	TCE is not needed. City property No revisions to design		X
TCE 302C	322+58 to 328+83	Right	Gravity wall is required if TCE is eliminated. Can eliminate TCE for driveway however curb return on south side does not match up with existing and slope change for driveway profile would be 3.29%. no revisions to design (city parcel)		X
TCE 305	343+80	Right	TCE is not needed. No revision to plans	X	
TCE 306	344+86 to 346+36	Right	Regrade lanes to 2%. Regrade driveway, add gravity wall and header curb to eliminate need for TCE. Revise construction plans.	X	
TCE 307	345+45.89, 345+89.60	Left	Regrade lanes to 2%. Regrade driveway to eliminate need for TCE. Revise construction plans	X	
TCE 309	349+07	Left	TCE is not needed. No revision to construction plans	X	
TCE 310	349+91	Left	TCE can be eliminated if travel lane cross slope revised to 2% and driveway is re-graded. Revise construction plans	X	
TCE 311A	357+61 to 360+63	Left	Move sidewalk to the east by reducing grass verge. Curb returns do not line up with existing. Would need to revise driveway layout. No revision to construction plans. City parcel		X
TCE 311B	360+85	Left	Curb returns do not line up with existing. Would need to revise driveway layout. No revision to construction plans. City parcel		X
TCE 312	363+40 to 364+15 +/-	Right	Curb return does not line up on south side. Potential ponding in driveway if work ends at right of way line. No revision to plans. School parcel		X
TCE 313	367+58	Left	Curb returns do not align on south side of driveway. Existing curb return can remain however this would not be aesthetically pleasing. No revision to construction plans.	X	
TCE 314	376+16	Right	County to meet with owner		X
TCE 315A	379+20	Left	Need to re-do the curb return in order to eliminate the TCE. Would result in a low point in the driveway. No revisions to construction plans		X
TCE 315B	379+60	Left	Need to re-do the curb return in order to eliminate the TCE. Would result in a low point in the driveway. No revision to construction plans		X
TCE 316	379+51	Right	Curb return does not line up on north side. Ponding will occur in driveway if grade is matched at the right of way line. No revision to construction plans		x
TCE 317	360+60	Right	TCE can be eliminated if travel lane cross slope revised to 2% and driveway is re-graded. Revise construction plans	X	
TCE 319A	411+61	Left	Not needed, no revisions to construction plans	X	
TCE 319B	412+20	Left	TCE is not needed. No revisions to construction plans	X	
TCE 320	412+48	Left	TCE is not needed. no revision to construction plans	X	
TCE 322	427+78	Right	TCE not required. No revisions to construction plans	X	
TCE 323	428+59	Right	TCE not required. No revisions to construction plans	X	

**HSQ GROUP, LLC**
Engineers • Planners

1001 Yamato Road • Boca Raton, Florida 33431, Suite 105 • Phone (561) 392-0221 hsqgroupinc.com

TCE 324	428+68	Right	TCE not required, no revisions to construction plans	X	
TCE 325A	439+00 to 442+00 +/-	Right	County parcel. TCE/ROW is required. No revisions to construction plans. County parcel		X
TCE 325B	445+92 to 454+88	Right	TCE is not required. No revisions to construction plans. County parcel	X	
TCE 326	436+62	Right	TCE is required. No revisions to construction plans		X
TCE 327	445+04	Left	Elimination of TCE would result in low point/ponding in driveway. No revisions to construction plans		x
TCE 328	445+80	Left	No need for TCE since an "L" shape driveway will be constructed, no change to construction plans, the county can ask for right of entry	X	
TCE 329	446+45	Left	Elimination of TCE would result in low point/ponding in driveway. No revisions to construction plans		x
TCE 330	450+61	Left	No need for TCE since an "L" shape driveway will be constructed, no change to construction plans, the county can ask for right of entry	X	
RW 101	306+25 to 313+72	Left	ROW from city is required.		X
RW 102	322+58 to 324+45	Right	Reduce sidewalk width to 6' to eliminate ROW acquisition.		X
RW 107	346+00 +/-	Left	Reduce sidewalk to 6' to eliminate need for TCE. Revise construction plans	X	
RW 115	377+34 to 379+00 +/-	Left	Reduce sidewalk to 6'. Add header curb. Revise construction plans	X	
PE 217	390+00 +/-	Left	Signal Easement @ 25th Street, redesign signal	X	
PE 218	390+25 to 391+34	Left	Signal Easement @ 25th Street, redesign signal	X	
PE 222	427+00 +/-	Right	Signal redesign is required	X	
				X	

OEBO SCHEDULE 1

SOLICITATION/PROJECT/BID NAME: Australian Avenue Drainage Improvements from Banyan Boulevard to 45th Street
SOLICITATION OPENING/SUBMITTAL DATE: 3/2/2021

SOLICITATION/PROJECT/BID NO.: 2021827
COUNTY DEPARTMENT: Engineering & Public Works

Section A PLEASE LIST THE DOLLAR AMOUNT OR PERCENTAGE OF WORK TO BE COMPLETED BY THE PRIME CONTRACTOR/CONSULTANT* ON THE PROJECT:

NAME OF PRIME RESPONDENT/BIDDER: HSQ Group, LLC ADDRESS: 1001 Yamato Rd., Ste. 105, Boca Raton, FL 33431
CONTACT PERSON: Nour Shehadeh PHONE NO.: 561-392-0221 E-MAIL: nour@hsqgroup.net
PRIME'S DOLLAR AMOUNT OR PERCENTAGE OF WORK: \$225,831.00
*SMWBE Prime's must include their percentage or dollar amount in the Total Participation line under section B.

Non-SBE ☐ MBE ☐ WBE ☐ SBE ☒

Section B PLEASE LIST THE DOLLAR AMOUNT OR PERCENTAGE OF WORK TO BE COMPLETED BY ALL SUBCONTRACTORS/SUBCONSULTANTS ON THE PROJECT BELOW:

Subcontractor/Sub consultant Name	(Check all Applicable Categories)				DOLLAR AMOUNT OR PERCENTAGE OF WORK					
	Non-SBE	MBE	WBE	SBE	Black	Hispanic	Women	Caucasian	Asian	Other
		Minority Business	Women Business	Small Business						
1. Stanley Consultants, Inc.	<input checked="" type="checkbox"/>	<input type="checkbox"/>	<input type="checkbox"/>	<input type="checkbox"/>				\$358,902.00		
2. Ritzel Mason, Inc.	<input type="checkbox"/>	<input type="checkbox"/>	<input type="checkbox"/>	<input checked="" type="checkbox"/>				\$7,305.75		
3.	<input type="checkbox"/>	<input type="checkbox"/>	<input type="checkbox"/>	<input type="checkbox"/>						
4.	<input type="checkbox"/>	<input type="checkbox"/>	<input type="checkbox"/>	<input type="checkbox"/>						
5.	<input type="checkbox"/>	<input type="checkbox"/>	<input type="checkbox"/>	<input type="checkbox"/>						

(Please use additional sheets if necessary)

Total \$717,804.00

Total Bid/Offer Price \$592,038.75

Total Certified S/M/WBE Participation \$233,136.75

I hereby certify that the above information is accurate to the best of my knowledge: Nour Shehadeh Managing Member

Name & Authorized Signature Title

Note:

- The amount listed on this form for a Subcontractor/sub consultant must be supported by price or percentage listed on the properly executed bid.
- Only those firms certified by Palm Beach County at the time of solicitation due date are eligible to meet the established OEBO Affirmative Action goal and list the dollar amount or percentage under the appropriate demographic category.
- Modification of this form is not permitted and will be rejected upon submittal.
- If a Mandatory API goal applies, failure to submit a properly executed Schedule 2 will result in a determination of non-responsiveness to the solicitation.

This Schedule is subject to the provisions of Emergency Ordinance 2025-014 approved by the BCC on June 3, 2025. As a result, the M/WBE participation is not enforceable.

REVISIED 09/26/2024

If you have experienced or witnessed a violation of the EBO Ordinance or would like to file a complaint, please scan the QR Code

A completed Schedule 2 is a binding document between the Prime Contractor/consultant and a Subcontractor/subconsultant (for any tier) and should be treated as such. All Subcontractors/subconsultants, including any tiered Subcontractors/subconsultants, must properly execute this document. If a Mandatory API goal applies, failure to submit a properly executed Schedule 2 will result in a determination of non-responsiveness to the solicitation. Each properly executed Schedule 2 must be submitted with the bid/proposal.

SOLICITATION/PROJECT NUMBER: 2021827

SOLICITATION/PROJECT NAME: Australian Avenue Drainage Improvements from Banyan Boulevard to 45th Street

Prime Contractor: HSQ Group, LLC Subcontractor: N/A

(Check box(s) that apply)

[X]SBE []WBE []MBE []M/WBE []Non-S/M/WBE Date of Palm Beach County Certification (if applicable):

The undersigned affirms they are the following (select one from each column if applicable):

Column 1 Column 2 Column 3
[X]Male []Female []African-American/Black []Asian American [X]Caucasian American []Supplier
[]Hispanic American []Native American

S/M/WBE PARTICIPATION – S/M/WBE Primes must document all work to be performed by their own work force on this form. Specify in detail, the scope of work to be performed or items supplied with the dollar amount and/or percentage for each work item. When applicable, identify the line item(s) associated with the service/product being supplied. S/M/WBE credit will only be given for the areas in which the S/M/WBE is certified. A detailed quote/proposal may be attached to a properly executed Schedule 2 for additional information.

Table with 6 columns: Line Item, Item Description, Unit Price, Quantity/Units, Contingencies/Allowances, Total Price/Percentage. Rows include Basic Roadway Services and Optional Roadway Services.

The undersigned Subcontractor/subconsultant is prepared to self-perform the above-described work in conjunction with the aforementioned project at the following total price or percentage: \$225,831.00

If the undersigned intends to subcontract any portion of this work to another Subcontractor/subconsultant, please list the business name and the amount below accompanied by a separate properly executed Schedule 2.

N/A Price or Percentage:
Name of 2nd/3rd tier Subcontractor/subconsultant

HSQ Group, LLC
Print Name of Prime
By: [Signature]
Authorized Signature
Nour Shehadeh
Print Name
Managing Member
Title
Date: 6/2/2025

N/A
Print Name of Subcontractor/subconsultant
By:
Authorized Signature
Print Name
Title
Date:



If you have experienced or witnessed a violation of the EBO Ordinance or would like to file a complaint, please scan the QR Code

This Schedule is subject to the provisions of Emergency Ordinance 2025-014 approved by the BCC on June 3, 2025 As a result, the M/WBE participation is not enforceable.

A completed Schedule 2 is a binding document between the Prime Contractor/consultant and a Subcontractor/subconsultant (for any tier) and should be treated as such. All Subcontractors/subconsultants, including any tiered Subcontractors/subconsultants, must properly execute this document. If a Mandatory API goal applies, failure to submit a properly executed Schedule 2 will result in a determination of non-responsiveness to the solicitation. Each properly executed Schedule 2 must be submitted with the bid/proposal.

SOLICITATION/PROJECT NUMBER: 2021827
SOLICITATION/PROJECT NAME: Australian Avenue Drainage Improvements from Banyan Boulevard to 45th Street

Prime Contractor: HSQ Group, LLC Subcontractor: Stanley Consultants, Inc.
(Check box(s) that apply)

☐SBE ☐WBE ☐MBE ☐M/WBE ☒Non-S/M/WBE Date of Palm Beach County Certification (if applicable):

The undersigned affirms they are the following (select one from each column if applicable):

Column 1 Column 2 Column 3
☒Male ☐Female ☐African-American/Black ☐Asian American ☒Caucasian American ☐Supplier
☐Hispanic American ☐Native American

S/M/WBE PARTICIPATION – S/M/WBE Primes must document all work to be performed by their own work force on this form. Specify in detail, the scope of work to be performed or items supplied with the dollar amount and/or percentage for each work item. When applicable, identify the line item(s) associated with the service/product being supplied. S/M/WBE credit will only be given for the areas in which the S/M/WBE is certified. A detailed quote/proposal may be attached to a properly executed Schedule 2 for additional information.

Line Item	Item Description	Unit Price	Quantity/ Units	Contingencies/ Allowances	Total Price/Percentage
1	Basic Roadway Services	1	1	0	\$267,579.00
2	Optional Roadway Services	1	1	0	\$91,323.00

The undersigned Subcontractor/subconsultant is prepared to self-perform the above-described work in conjunction with the aforementioned project at the following total price or percentage: \$358,902.00

If the undersigned intends to subcontract any portion of this work to another Subcontractor/subconsultant, please list the business name and the amount below accompanied by a separate properly executed Schedule 2.
N/A Price or Percentage:
Name of 2nd/3rd tier Subcontractor/subconsultant

HSQ Group, LLC
Print Name of Prime
By: Nour Shehadeh
Authorized Signature
Nour Shehadeh
Print Name
Managing Member
Title
Date: 6/2/2025

Stanley Consultants, Inc.
Print Name of Subcontractor/subconsultant
By: Michael A. Penn, P.E.
Authorized Signature
Michael A. Penn, P.E.
Print Name
Client Service Manager
Title
Date: May 20, 2025



If you have experienced or witnessed a violation of the EBO Ordinance or would like to file a complaint, please scan the QR Code

This Schedule is subject to the provisions of Emergency Ordinance 2025-014 approved by the BCC on June 3, 2025. As a result, the M/WBE participation is not enforceable.

A completed Schedule 2 is a binding document between the Prime Contractor/consultant and a Subcontractor/subconsultant (for any tier) and should be treated as such. All Subcontractors/subconsultants, including any tiered Subcontractors/subconsultants, must properly execute this document. If a Mandatory API goal applies, failure to submit a properly executed Schedule 2 will result in a determination of non-responsiveness to the solicitation. Each properly executed Schedule 2 must be submitted with the bid/proposal.

SOLICITATION/PROJECT NUMBER: 2021827

SOLICITATION/PROJECT NAME: Australian Avenue Drainage Improvements from Banyan Boulevard to 45th Street

Prime Contractor: HSQ Group, LLC Subcontractor: Ritzel Mason, Inc.

(Check box(s) that apply)

[X]SBE []WBE []MBE []M/WBE []Non-S/M/WBE Date of Palm Beach County Certification (if applicable): 4/10/25-4/9/28

The undersigned affirms they are the following (select one from each column if applicable):

Column 1 Column 2 Column 3
[X]Male []Female []African-American/Black []Asian American [X]Caucasian American []Supplier
[]Hispanic American []Native American

S/M/WBE PARTICIPATION – S/M/WBE Primes must document all work to be performed by their own work force on this form. Specify in detail, the scope of work to be performed or items supplied with the dollar amount and/or percentage for each work item. When applicable, identify the line item(s) associated with the service/product being supplied. S/M/WBE credit will only be given for the areas in which the S/M/WBE is certified. A detailed quote/proposal may be attached to a properly executed Schedule 2 for additional information.

Table with 6 columns: Line Item, Item Description, Unit Price, Quantity/Units, Contingencies/Allowances, Total Price/Percentage. Row 1: 1, Surveying Services, 1, 1, 0, \$7,305.75

The undersigned Subcontractor/subconsultant is prepared to self-perform the above-described work in conjunction with the aforementioned project at the following total price or percentage: \$7,305.75

If the undersigned intends to subcontract any portion of this work to another Subcontractor/subconsultant, please list the business name and the amount below accompanied by a separate properly executed Schedule 2.
N/A
Name of 2nd/3rd tier Subcontractor/subconsultant Price or Percentage:

HSQ Group, LLC
Print Name of Prime
By: [Signature]
Authorized Signature
Nour Shehadeh
Print Name
Managing Member
Title
Date: 6/21/2025

Ritzel Mason, Inc.
Print Name of Subcontractor/subconsultant
By: [Signature]
Authorized Signature
Dennis Ritzel
Print Name
Vice President
Title
Date: May 20, 2025



If you have experienced or witnessed a violation of the EBO Ordinance or would like to file a complaint, please scan the QR Code

This Schedule is subject to the provisions of Emergency Ordinance 2025-014 approved by the BCC on June 3, 2025. As a result, the M/WBE participation is not enforceable.

Australian Avenue Drainage Improvements from Banyan Boulevard to 45th Street					
Project # 2021827 - R2022-0335 - HSQ Group, LLC					
Contract API(s):		20% SBE and SBE Evaluation Preference			
Contract Commitment:		88% SBE			
GSC Date:		10/7/2020			
Executed By	Supplement #	Date Approved	Total Amount	SBE	
				Total \$	Total %
BCC	0	4/12/22	\$ 2,679,239.13	\$ 2,420,816.13	90.35%
BCC	1	1/24/23	\$ 110,889.00	\$ 28,611.00	25.80%
Lead	2	3/15/23	\$ 33,252.00	\$ 33,252.00	100.00%
BCC	3	9/19/23	\$ 482,294.03	\$ 305,361.74	63.31%
Lead	4	11/17/23	\$ -	\$ (29,310.00)	#DIV/0!
BCC	5	5/14/24	\$ 148,853.51	\$ 148,853.51	100.00%
BCC	6	11/19/24	\$ 124,725.00	\$ 27,570.00	22.10%
Lead	7	12/13/24	\$ 69,606.88	\$ 56,086.68	80.57%
BCC	8	4/23/25	\$ 592,038.75	\$ 233,136.75	39.37%
Project Totals			\$ 4,240,898.30	\$ 3,224,377.81	76.03%



Palm Beach County
Compliance Summary Report

Vendor Number	Vendor Name	AM Best Rating	Insurance Carrier	Policy #	Eff. Date	Exp. Date	Coverage	Contract Number	Contract Name
DX00001723	HSQ Group, LLC		Compliant					2021827	Australian Avenue Drainage Improvements Banyan Boulevard to 45th Street
		A+g , XV	American Guarantee and Liability Insurance Company	SXS445976201	11/1/2024	11/1/2025	Excess Liability		
		A+g , XV	Zurich American Insurance Company	GLO429303601	11/1/2024	11/1/2025	General Liability		
		A+p , XV	Pacific Insurance Company, Limited	83OH058521724	12/15/2024	12/15/2025	Professional Liability		
		Ar , XV	Illinois National Insurance Co.	WC088407048fl	7/1/2024	7/1/2025	Workers Comp		

Risk Profile : Standard - Professional Services
Required Additional Insured : Palm Beach County Board of County Commissioners
Ownership Entity :