

PALM BEACH COUNTY  
BOARD OF COUNTY COMMISSIONERS

AGENDA ITEM SUMMARY

Meeting Date: April 21, 2026 Consent [X] Regular [ ]  
Public Hearing [ ]

Department: Water Utilities Department

I. EXECUTIVE BRIEF

**Motion and Title:** Staff recommends motion to approve: Supplement No. 4 to Consultant Services Authorization (CSA) No. 3 to the Consulting/Professional Services System-Wide Wellfield Improvements Hydrogeologic Engineering Design and Construction Services (Contract) with JLA Geosciences, Inc., (Consultant), for the System-Wide Wellfield Improvement Phase 2 (Project) Construction Phase Services for a not to exceed amount of \$205,013.35.

**Summary:** On April 2, 2019, the Board of County Commissioners (BCC) approved the Palm Beach County Water Utilities Department (PBCWUD) Contract (R2019-0439) with the Consultant. Supplement No. 4 to CSA No. 3 provides for additional construction phase services for six (6) months for PBCWUD Water Treatment Plant (WTP) Nos. 2 and 8. This supplement aligns the construction phase services with the current construction duration of the Project for which the Consultant oversees. The anticipated completion date for the Project was November 2025. The Consultant will provide additional project management, construction oversight and review requests for additional information and change orders for the additional time duration requested.

The Contract was procured under the requirements for the 2002 Small Business Enterprise (SBE) Ordinance (R2002-0064). The SBE proposed participation for this Supplement No. 4 to CSA No. 3 100%. To date, the overall participation achieved on this Contract is 79.66%. Consultant is a Palm Beach County based company. The Project is included in the PBCWUD FY 2026 Budget. (PBCWUD Project 19-022) Districts 2 & 3 (MWJ)

**Background and Justification:** PBCWUD is committed to proactive rehabilitation in order to increase overall production well efficiency and reliability, as well as reduce energy consumption. Completion of the work provided for in the Project will provide for the work necessary to rehabilitate the wellfields for WTP Nos. 2 and 8. Supplement No. 4 to CSA No. 3 will provide for an extension of the construction management services and field oversight needed for the rehabilitation of the surficial aquifer production wells.

**Attachments:**

- 1. Two (2) Originals of CSA No. 3 Supplement No. 4
- 2. Location Map
- 3. EBIX Compliance Summary Report

Recommended By: Ali Bayat 3/27/2026  
Department Director Date

Approved By: [Signature] 3/31/26  
Deputy County Administrator Date

**II. FISCAL IMPACT ANALYSIS**

**A. Five Year Summary of Fiscal Impact:**

<b>Fiscal Years</b>	<b>2026</b>	<b>2027</b>	<b>2028</b>	<b>2029</b>	<b>2030</b>			
Capital Expenditures	<u>\$205,014</u>	<u>0</u>	<u>0</u>	<u>0</u>	<u>0</u>			
Operating Costs	<u>0</u>	<u>0</u>	<u>0</u>	<u>0</u>	<u>0</u>			
External Revenues	<u>0</u>	<u>0</u>	<u>0</u>	<u>0</u>	<u>0</u>			
Program Income (County)	<u>0</u>	<u>0</u>	<u>0</u>	<u>0</u>	<u>0</u>			
In-Kind Match County	<u>0</u>	<u>0</u>	<u>0</u>	<u>0</u>	<u>0</u>			
<b>NET FISCAL IMPACT</b>	<b><u>\$205,014</u></b>	<b><u>0</u></b>	<b><u>0</u></b>	<b><u>0</u></b>	<b><u>0</u></b>			
<b># ADDITIONAL FTE POSITIONS (Cumulative)</b>	<b><u>0</u></b>	<b><u>0</u></b>	<b><u>0</u></b>	<b><u>0</u></b>	<b><u>0</u></b>			
<b>Budget Account No.:</b>	<b>Fund</b>	<b><u>4011</u></b>	<b>Dept</b>	<b><u>721</u></b>	<b>Unit</b>	<b><u>W004</u></b>	<b>Object</b>	<b><u>6541</u></b>

Is Item Included in Current Budget? Yes X No     

Is this item using Federal Funds? Yes      No X

Is this item using State Funds? Yes      No X

Reporting Category N/A

**B. Recommended Sources of Funds/Summary of Fiscal Impact:**

One (1) time expenditure from user fees, connection fees and balance brought forward.

**C. Department Fiscal Review:** Joany Soeman

**III. REVIEW COMMENTS**

**A. OFMB Fiscal and/or Contract Development and Control Comments:**

<u>Shirley M. [Signature]</u> OFMB 3/26/26 3/25 3.26	<u>[Signature]</u> Contract Development and Control 3/24/26 26.3.26.26
--	---

**B. Legal Sufficiency:**

[Signature]  
 Assistant County Attorney  
 3/30/26

**C. Other Department Review:**

\_\_\_\_\_  
 Department Director

SUPPLEMENT NO. 4  
CONSULTANT SERVICES AUTHORIZATION NO. 3  
Palm Beach County Water Utilities Department  
Contract for Consulting/Professional Services  
*System-Wide Wellfield Improvements Hydrogeologic, Engineering Design and Construction Services*  
Resolution No. R2019-0439 Contract Dated April 2, 2019

**Project Title:** System-Wide Wellfield Improvements Phase 2 Construction Phase Services

**PBCWUD Project No.:** 19-022

**Consultant:** JLA Geosciences, Inc.

**Address:** 1907 Commerce Lane, Suite 104, Jupiter, Florida 33458

**Budget Line Item No.:** 4011-721-W004-6541

**District No.:** 2 & 3

This Supplement Consultant Services Authorization provides for: professional services to provide additional construction phase services for six (6) months for Palm Beach County Water Utilities Department (PBCWUD) Water Treatment Plant Nos. 2 and 8, located in West Palm Beach, Florida.

(See ATTACHMENT A for detailed scope of services)

The Contract provides for 59% SBE participation. This Supplement Consultant Services Authorization includes 100% overall SBE participation. The cumulative SBE participation, including this Supplement Consultant Services Authorization is 79.66%.

1. Services completed by the Consultant to date:  
**See ATTACHMENT B.**
2. Consultant shall begin work upon receipt of Notice to Proceed correspondence.
3. The compensation to be paid to the Consultant for providing the requested services shall be:
  - A. Computation of time charges plus expenses, not to exceed \$205,013.35
  - B. Fixed price of \$ 0.00
  - C. Total \$ 205,013.35
4. This Authorization may be terminated, in whole or in part, by the County with or without cause in accordance with the Contract terms. In the event of termination not the fault of the Consultant, the Consultant shall be compensated for all services performed to termination date, together with reimbursable expenses (if applicable) then due in accordance with the Contract terms. Consultant agrees to waive any and all claims for lost profits or anticipated future profits in the event of a termination with or without cause under this Contract.

SUPPLEMENT NO. 4  
CONSULTANT SERVICES AUTHORIZATION NO. 3  
Palm Beach County Water Utilities Department  
Contract for Consulting/Professional Services  
*System-Wide Wellfield Improvements Hydrogeologic, Engineering Design and Construction Services*  
Resolution No. R2019-0439 Contract Dated April 2, 2019

**Project Title:** System-Wide Wellfield Improvements Phase 2 Construction Phase Services

**PBCWUD Project No.:** 19-022

5. SBE participation is included in **ATTACHMENT C** under this Authorization. The attached Schedule 1 defines the SBE applied to this Authorization and Schedule 2 establishes the SBE contribution from each Sub-Consultant (Letter of Intent).
6. This Authorization does not amend, change, or modify the Contract dated April 2, 2019 which remains in full force and effect.
7. All Attachments to this Authorization are incorporated herein and made a part of this Consultant Services Authorization.
8. The Contract and this Consultant Services Authorization is subject to the County Emergency Ordinance 2025-014, approved by the Board of County Commissioners on June 3, 2025.

SUPPLEMENT NO. 4  
CONSULTANT SERVICES AUTHORIZATION NO. 3  
Palm Beach County Water Utilities Department  
Contract for Consulting/Professional Services  
System-Wide Wellfield Improvements Hydrogeologic, Engineering Design and Construction Services  
Resolution No. R2019-0439 Contract Dated April 2, 2019

Project Title: System-Wide Wellfield Improvements Phase 2 Construction Phase Services

PBCWUD Project No.: 19-022

IN WITNESS WHEREOF, this Authorization is accepted, subject to the terms, conditions and obligations of the aforementioned Contract.

PALM BEACH COUNTY, A POLITICAL SUBDIVISION OF THE STATE OF FLORIDA

Michael A. Caruso, Clerk of the Circuit Court  
& Comptroller, Palm Beach County

Palm Beach County, Board  
of County Commissioners

ATTEST:

Signed: \_\_\_\_\_

Signed: \_\_\_\_\_ *our J.P. For TSM*

*AB*

Sara Baxter, Mayor

Typed Name: \_\_\_\_\_  
Deputy Clerk

\_\_\_\_\_  
(Date)

Approved as to Form and Legal  
Sufficiency

JLA Geosciences, Inc.  
(Consultant)

Signed: *[Signature]*

Julia I. Pavlock  
(Print Name)

Typed Name: Michael W. Jones  
County Attorney

*[Signature]*  
(Signature)

CFO  
(Title)

03/16/2026  
(Date)

STATE OF FLORIDA  
COUNTY OF Palm Beach

The foregoing instrument was acknowledged before me by means of  physical presence or  online notarization,  
this 16<sup>th</sup> day of March, 2026, by Julia I. Pavlock who is  personally  
known to me or  has produced \_\_\_\_\_ as identification.

*[Signature]*  
(Signature of Notary Public - State of Florida)

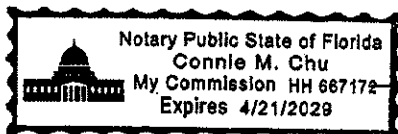

Connie M. Chu  
(Print, Type, or Stamp Commissioned Name of Notary Public)

SUPPLEMENT NO. 4  
CONSULTANT SERVICES AUTHORIZATION NO. 3  
Palm Beach County Water Utilities Department  
Contract for Consulting/Professional Services  
*System-Wide Wellfield Improvements Hydrogeologic, Engineering Design and Construction Services*  
Resolution No. R2019-0439 Contract Dated April 2, 2019

**LIST OF ATTACHMENTS**

<b>ATTACHMENT A</b>	Scope of Services
<b>ATTACHMENT B</b>	Summary and Status of Consultant Services Authorizations
<b>ATTACHMENT C</b>	OSBD Schedules 1 and 2
<b>ATTACHMENT D</b>	Project Schedule
<b>ATTACHMENT E</b>	Budget Summary
<b>ATTACHMENT F</b>	Summary of SBE Business Tracking
<b>ATTACHMENT G</b>	Location Map

REVISED 01-27-26

# ATTACHMENT A

## SCOPE OF SERVICES

PBCWUD Project No.: 19-022

Project Title: System-Wide Wellfield Improvements Phase 2 Construction Phase Services

### BACKGROUND

Palm Beach County Water Utilities Department (PBCWUD) contracted JLA Geosciences, Inc. (CONSULTANT) to perform oversight for construction phase services associated with PBCWUD Project Number No. PBCWUD 19-022, System-Wide Wellfield Improvements Phase 2. The original duration for Consultant Services Authorization (CSA) No. 3 was approved on December 21, 2021, for an anticipated 900 calendar day period. Subsequently, CSA No. 3, Supplements Nos. 2 and 3 extended the construction phase services an additional ten (10) months. Based on the current schedule provided by the awarded contractor, Florida Design Drilling LLC, the anticipated project completion date is now October 2025, requiring an additional six (6) months of construction phase services. This CSA supplement outlines the scope of work associated with these additional services.

JLA Geosciences, Inc. (CONSULTANT) shall perform:

### TASK 1.0 ADDITIONAL CONSTRUCTION PHASE SERVICES

The CONSULTANT shall provide additional project management and construction oversight associated with PBCWUD System-Wide Wellfield Improvements Phase 2 Construction Phase Services through project completion. Florida Design Drilling LLC, the awarded PBCWUD contractor, currently anticipates project completion in October 2025.

- Task 1.1 Additional Project Management (6 months estimated)** – The CONSULTANT shall provide project coordination with PBCWUD representatives and Construction Contractor and overall general project management during field services.
- Task 1.2 Preconstruction meeting** – Not Applicable.
- Task 1.3 Additional Progress Meetings (6 months estimated)** – The CONSULTANT shall prepare for and attend monthly progress meetings throughout the duration of the project (6 months) including summarized meeting minutes and agendas.
- Task 1.4 Additional Contractor submittal review (8 estimated)** – The CONSULTANT and its SUBCONSULTANTS shall review up to eight (8) contractor submitted requests for additional information (RAIs) and contract change orders. The CONSULTANT and its SUBCONSULTANTS shall provide clarifications and interpretations of the Contract documents in response to the RAIs in a written format to the Contractor. The CONSULTANT shall review Contractor submitted change orders and provide recommendations to PBCWUD for approval or rejection.

**Task 1.5 Additional Payment Application Review (6 months estimated)** – The CONSULTANT and its SUBCONSULTANTS shall review and provide recommendations for the acceptance of the contractor-submitted payment applications (6 estimated).

**Task 1.6 Additional Daily Work Reports, Weekly Project Summary Updates (6 months estimated)** – The CONSULTANT and its SUBCONSULTANTS shall prepare daily work reports for site inspection activities and submit them to the PBCWUD on a weekly basis during well field construction activities.

**Task 1.7 Additional Field Construction Oversight (6 months estimated)** - The CONSULTANT and its SUBCONSULTANTS shall provide construction oversight, development, and testing during critical phases of construction including: casing installations, grouting, completion of interval drilling, well development, step drawdown testing, including performing water level measurements, specific capacity analysis and field water quality testing. This task will also include well construction field logs, water quality field data summaries, and copies of the geophysical logs provided by the Contractor. Digital photos will be taken of significant activities during well construction.

The CONSULTANT and its SUBCONSULTANTS shall provide coordination and management of mechanical and electrical improvements, including field assistance during well start-up, pump test results and recommendations for permanent pump setting depth and in-service pumping rate.

The CONSULTANT and its SUBCONSULTANTS shall prepare daily work reports for site inspection activities and submit them to the PBCWUD on a weekly basis during well field construction activities.

#### **Deliverables**

- Electronic copies of monthly progress meeting agendas and minutes shall be submitted to PBCWUD in Portable Document Format (PDF).
- Electronic copies of monthly pay application reviews shall be submitted to PBCWUD in electronic mail (email) format.
- Contractor submitted RAIs and change order reviews shall be submitted to PBCWUD in email format.
- Weekly project summaries shall be to PBCWUD in email format.

#### **Assumptions**

- Assumptions shall be in accordance with the existing approved CSA No. 3.

## ATTACHMENT B

### SUMMARY AND STATUS OF CONSULTANT SERVICES AUTHORIZATIONS

Auth. No.	PBCWUD Project No.	Title	Status	Project Total Amount	SBE Total Amount	SBE Participation %	Approved	
							By	Date
1	19-022	System-Wide Wellfield Improvements, Design, Permitting and Bidding Services	Approved	\$ 1,208,727.59	\$ 745,711.63	61.69%	BCC	4/2/2019
1.1	19-022	System-Wide Wellfield Improvements, Design, Permitting and Bidding Services	Approved	\$ 96,394.62	\$ 92,035.88	95.47%	CRC	10/2/2019
1.2	19-022	System-Wide Wellfield Improvements, Design, Permitting and Bidding Services	Approved	\$ 57,513.55	\$ 39,503.55	68.68%	CRC	1/8/2020
1.3	19-022	System-Wide Wellfield Improvements, Design, Permitting and Bidding Services	Approved	\$ 6,302.99	\$ 6,302.99	100.00%	Director	4/9/2020
1.4	19-022	System-Wide Wellfield Improvements, Design, Permitting and Bidding Services	Approved	\$ 35,097.58	\$ 12,321.58	35.10%	Director	2/2/2021
1.5	19-022	System-Wide Wellfield Improvements, Design, Permitting and Bidding Services	Approved	\$ 15,801.00	\$ 7,890.00	49.93%	Director	11/16/2021
1.6	19-022	System-Wide Wellfield Improvements, Design, Permitting and Bidding Services	Approved	\$ 60,292.73	\$ 38,229.61	63.40%	CRC	8/31/2022
2	19-022	System-Wide Wellfield Improvements Phase 1 Construction Phase Services	Approved	\$ 1,761,713.50	\$ 1,646,729.50	93.47%	BCC	10/20/2020
2.1	19-022	System-Wide Wellfield Improvements Phase 1 Construction Phase Services	Approved	\$ 7,707.00	\$ 5,220.00	67.73%	Director	8/5/2024
3	19-022	System-Wide Wellfield Improvements Phase 2 Construction Phase Services	Approved	\$ 1,314,167.20	\$ 1,031,711.20	78.50%	BCC	12/21/2021
3.1	19-022	System-Wide Wellfield Improvements Phase 2 Construction Phase Services	Approved	\$ 17,561.00	\$ 17,561.00	100.00%	Director	9/18/2023
3.2	19-022	System-Wide Wellfield Improvements Phase 2 Construction Phase Services	Approved	\$ 57,287.10	\$ 27,917.94	48.73%	CRC	10/16/2024
3.3	19-022	System-Wide Wellfield Improvements Phase 2 Construction Phase Services	Approved	\$ 403,585.45	\$ 304,100.17	75.34%	BCC	2/11/2025
3.4	19-022	System-Wide Wellfield Improvements Phase 2 Construction Phase Services	Pending	\$ 205,013.35	\$ 205,013.35	100.00%	BCC	Pending

**ATTACHMENT C**

**OSBD SCHEDULE 1**

# Office of Small Business Development

REVISED 01-27-26

# OSBD SCHEDULE 1

System-Wide Wellfield Improvements Phase 2 Construction Phase Services

SOLICITATION/PROJECT/BID NAME: \_\_\_\_\_

SOLICITATION/PROJECT/BID NO.: 19-022

SOLICITATION OPENING/SUBMITTAL DATE: \_\_\_\_\_

COUNTY DEPARTMENT: Palm Beach County Water Utilities Department

**Section A** PLEASE LIST THE DOLLAR AMOUNT OR PERCENTAGE OF WORK TO BE COMPLETED BY THE PRIME CONTRACTOR/CONSULTANT\* ON THE PROJECT:

NAME OF PRIME RESPONDENT/BIDDER: JLA Geosciences, Inc. ADDRESS: 1907 Commerce Lane, Suite 104, Jupiter, FL 33458

CONTACT PERSON: James L. Andersen PHONE NO.: 561-746-0228 E-MAIL: jandersen@jlageosciences.com

PRIME'S DOLLAR AMOUNT OR PERCENTAGE OF WORK: \$138,122.08

SBE Prime's must include their percentage or dollar amount in the Total Participation line under section B.

Non-SBE  SBE

**Section B** PLEASE LIST THE DOLLAR AMOUNT OR PERCENTAGE OF WORK TO BE COMPLETED BY ALL SUBCONTRACTORS/SUBCONSULTANTS ON THE PROJECT BELOW:

Subcontractor/Sub consultant Name	(Check all Applicable Categories)		DOLLAR AMOUNT OR PERCENTAGE OF WORK
	Non-SBE	SBE	
1. Electrical Design Associates, Inc.	<input type="checkbox"/>	<input checked="" type="checkbox"/>	<u>\$66,891.27</u>
2.	<input type="checkbox"/>	<input type="checkbox"/>	_____
3.	<input type="checkbox"/>	<input type="checkbox"/>	_____
4.	<input type="checkbox"/>	<input type="checkbox"/>	_____
5.	<input type="checkbox"/>	<input type="checkbox"/>	_____

(Please use additional sheets if necessary)

Total Bid/Offer Price \$ \$205,013.35 Total \$205,013.35  
 Total Certified SBE Participation \$ \$205,013.35

I hereby certify that the above information is accurate to the best of my knowledge: James L. Andersen President  
Name & Authorized Signature Title

- Note:**
1. The amount listed on this form for a Subcontractor/sub consultant must be supported by price or percentage listed on the properly executed Schedule 2 or attached signed proposal.
  2. Only those firms certified by Palm Beach County at the time of solicitation due date are eligible to meet the established OSBD Affirmative Procurement Initiative (API). Please
  3. Modification of this form is not permitted and will be rejected upon submittal.
  4. If a Mandatory API goal applies, failure to submit a properly executed Schedule 2 will result in a determination of non-responsiveness to the solicitation.

**ATTACHMENT C**

**OSBD SCHEDULE 2**

**Office of Small Business Development**

REVISED 01-27-26

**OSBD LETTER OF INTENT – SCHEDULE 2\***

**A completed Schedule 2 is a binding document between the Prime Contractor/consultant and a Subcontractor/subconsultant (for any tier) and should be treated as such.** All Subcontractors/subconsultants, including any tiered Subcontractors/subconsultants, must properly execute this document. If a Mandatory API goal applies, failure to submit a properly executed Schedule 2 will result in a determination of non-responsiveness to the solicitation. Each properly executed Schedule 2 must be submitted with the bid/proposal.

SOLICITATION/PROJECT NUMBER: 19-022  
 SOLICITATION/PROJECT NAME: System-Wide Wellfield Improvements Phase 2 Construction Phase Services

Prime Contractor: JLA Geosciences, Inc. Subcontractor: \_\_\_\_\_  
**(Check box(s) that apply)**

SBE  Non-SBE  Supplier Date of Palm Beach County Certification (if applicable): 4/10/23-4/9/26

**SBE PARTICIPATION – SBE Primes must document all work to be performed by their own work force on this form.** Specify in detail, the scope of work to be performed or items supplied with the dollar amount and/or percentage for each work item. When applicable, identify the line item(s) associated with the service/product being supplied. SBE credit will only be given for the areas in which the SBE is certified. A detailed quote/proposal may be attached to a properly executed Schedule 2 for additional information.

Line Item	Item Description	Unit Price	Quantity/ Units	Contingencies/ Allowances	Total Price/Percentage
	Hydrogeologic Consulting	\$205,013.35	1	-	\$205,013.35
	Commodity Codes: 91843, 91855, 92683, 96143, 96892				

The undersigned Subcontractor/subconsultant is prepared to self-perform the above-described work in conjunction with the aforementioned project at the following total price or percentage: \$138,122.08

**If the undersigned intends to subcontract any portion of this work to another Subcontractor/subconsultant, please list the business name and the amount below accompanied by a separate properly executed Schedule 2.**

Electrical Design Associates, Inc. Price or Percentage: \$66,891.27  
 Name of 2<sup>nd</sup>/3<sup>rd</sup> tier Subcontractor/subconsultant

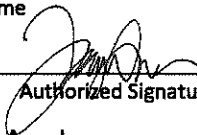
JLA Geosciences, Inc.  
 Print Name of Prime  
 By:   
 Authorized Signature  
James L. Andersen  
 Print Name  
President  
 Title  
 Date: 03/16/2026

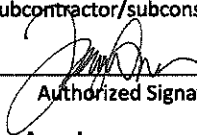
JLA Geosciences, Inc.  
 Print Name of Subcontractor/subconsultant  
 By:   
 Authorized Signature  
James L. Andersen  
 Print Name  
President  
 Title  
 Date: 03/16/2026

\*Revised 6.5.2025 pursuant to Emergency Ordinance 2025-014, approved on June 3, 2025

**OSBD LETTER OF INTENT – SCHEDULE 2\***

**A completed Schedule 2 is a binding document between the Prime Contractor/consultant and a Subcontractor/subconsultant (for any tier) and should be treated as such.** All Subcontractors/subconsultants, including any tiered Subcontractors/subconsultants, must properly execute this document. If a Mandatory API goal applies, failure to submit a properly executed Schedule 2 will result in a determination of non-responsiveness to the solicitation. Each properly executed Schedule 2 must be submitted with the bid/proposal.

SOLICITATION/PROJECT NUMBER: 19-022  
 SOLICITATION/PROJECT NAME: System-Wide Wellfield Improvements Phase 2 Construction Phase Services

Prime Contractor: JLA Geosciences, Inc. Subcontractor: Electrical Design Associates, Inc.  
**(Check box(s) that apply)**

SBE  Non-SBE  Supplier Date of Palm Beach County Certification (if applicable): 06/07/24-06/06/27

**SBE PARTICIPATION – SBE Primes must document all work to be performed by their own work force on this form.** Specify in detail, the scope of work to be performed or items supplied with the dollar amount and/or percentage for each work item. When applicable, identify the line item(s) associated with the service/product being supplied. SBE credit will only be given for the areas in which the SBE is certified. A detailed quote/proposal may be attached to a properly executed Schedule 2 for additional information.

Line Item	Item Description	Unit Price	Quantity/ Units	Contingencies/ Allowances	Total Price/Percentage
	Electrical Engineering	\$66,891.27	1	-	\$66,891.27
	Commodity Codes: 92531, 9253130				

The undersigned Subcontractor/subconsultant is prepared to self-perform the above-described work in conjunction with the aforementioned project at the following total price or percentage: \$66,891.27

If the undersigned intends to subcontract any portion of this work to another Subcontractor/subconsultant, please list the business name and the amount below accompanied by a separate properly executed Schedule 2.

N/A Price or Percentage: N/A  
 Name of 2<sup>nd</sup>/3<sup>rd</sup> tier Subcontractor/subconsultant

JLA Geosciences, Inc.  
 Print Name of Prime  
 By:   
 Authorized Signature  
James L. Andersen  
 Print Name  
President  
 Title  
 Date: 03/16/2026

Electrical Design Associates, Inc.  
 Print Name of Subcontractor/subconsultant  
 By:   
 Authorized Signature  
Dameion Donaldson, P.E.  
 Print Name  
President  
 Title  
 Date: 03/16/2026

\*Revised 6.5.2025 pursuant to Emergency Ordinance 2025-014, approved on June 3, 2025

# ATTACHMENT - D

## PROJECT SCHEDULE

The completion dates for this work will be as follows (starting from CONSULTANT'S receipt of Notice-to-Proceed).

Engineering Services	Completion Date from Notice to Proceed (Calendar Days)
Task 1.0 Construction Phase Services	183 Days

REVISED 01-27-26

**ATTACHMENT E  
BUDGET SUMMARY**

Palm Beach County Water Utilities Department  
 Contract for Consulting/Professional Services: System-Wide Wellfield Improvements Hydrogeologic, Engineering Design and Construction Services  
 Resolution No.: R2019-0439 Contract Dated: April 2, 2019  
 Consultant Service Authorization No.: 3.4  
 Consultant: JLA Geosciences, Inc.  
 Project Title: System-Wide Wellfield Improvements Phase 2 Construction Phase Services  
 PBCWUD Project No.: 19-022

Task No.	Task Description	Labor Classification and Hourly Rate											Mileage (\$0.655/mi)	ODC	Sub-Consultant Services	TASK TOTAL	
		President	Prin./Hydro Corp. Officer	Pj. Manager Sr Hydro III	Senior Hydro II	Senior Hydro I	Geol / Hydro III	Geol / Hydro II	Geol / Hydro I	Hydro Tech	Admin / Tech	Total Labor					
1.0	Construction Phase Services																
1.1	Additional Project Management (6 months) <i>Subconsultant - Electrical Design Associates, Inc.</i>	6.0	46.0														\$ 7,948.86
1.3	Additional Project Meetings (6 months) <i>Subconsultant - Electrical Design Associates, Inc.</i>		6.0		12.0												\$ 4,507.68
1.4	Additional Contractor submittal review (3 estimated) <i>Subconsultant - Electrical Design Associates, Inc.</i>		3.0		2.0												\$ 921.88
1.5	Additional Payment Application Review (6 months) <i>Subconsultant - Electrical Design Associates, Inc.</i>		3.0		6.0												\$ 4,236.06
1.6	Additional Daily Work Reports, Weekly Project Summary Updates (6 months) <i>Subconsultant - Electrical Design Associates, Inc.</i>	3.0	27.0		84.0			27.0									\$ 1,126.92
1.7	Additional Field Construction oversight (6 months) <i>Subconsultant - Electrical Design Associates, Inc.</i>	3.0	138.0		360.0			141.0									\$ 9,478.26
	<b>Subtotal Task 1.0</b>	<b>12.0</b>	<b>225.0</b>	<b>0.0</b>	<b>464.0</b>	<b>0.0</b>	<b>0.0</b>	<b>168.0</b>	<b>0.0</b>	<b>0.0</b>	<b>0.0</b>	<b>0.0</b>	<b>0.0</b>	<b>0.0</b>	<b>889.0</b>	<b>\$ -</b>	<b>\$ 66,891.27</b>
	Labor Subtotal Hours	12.0	225.0	0.0	464.0	0.0	0.0	168.0	0.0	0.0	0.0	0.0	0.0	0.0	889.0	\$ -	\$ 66,891.27
	Labor Hourly Billing Rates	\$ 196.96	\$ 206.00	\$ 174.45	\$ 151.94	\$ 146.00	\$ 129.43	\$ 112.55	\$ 102.00	\$ 67.53	\$ 67.53						
	Labor Raw Costs	\$ 67.92	\$ 71.03	\$ 60.16	\$ 52.39	\$ 50.34	\$ 44.63	\$ 38.01	\$ 35.17	\$ 23.29	\$ 23.29						
	Labor Multiplier	2.9	2.9	2.9	2.9	2.9	2.9	2.9	2.9	2.9	2.9						
	Labor Sub Total	\$ 2,383.52	\$ 46,350.00	\$ -	\$ 70,500.16	\$ -	\$ -	\$ 18,908.40	\$ -	\$ -	\$ -						
	Labor Total																\$ 138,122.08
	Mileage/ODC																\$ 0.00
	Subconsultant Total																\$ 66,891.27
	<b>Project Total</b>																<b>\$ 205,013.36</b>

Mileage calculated based on current US Internal Revenue Service standard rates.

**ATTACHMENT - E**  
**BUDGET SUMMARY**

Palm Beach County Water Utilities Department

Project Title: System-Wide Wellfield Improvements Phase 2 - Additional Construction Phase Services

PBCWUD Project No.: 19-022

Consultant Service Authorization: 3, Sup. 3.4

Consultant: Electrical Design Associates, Inc.

Task No.	Task Description	Labor Classification and Hourly Rate						Total Labor	TASK TOTAL
		Principal	Senior Electrical Engineer	Engineer	Senior Associate	Cadd Tech	Clerical / Admin		
<b>1.0</b>	<b>Phase 2 Additional Construction Phase Services</b>								
1.1	Additional Project Management (6 month est.)								
	<i>Subcontractor - Electrical Design Associates, Inc.</i>	0	20	12	0	0	6	48	\$ 7,948.88
1.3	Attend additional monthly progress meetings (6 estimated)								
	<i>Subcontractor - Electrical Design Associates, Inc.</i>	0	24	0	0	0	0	24	\$ 4,507.68
1.4	Additional Contractor submittal review (8 estimated)								
	<i>Subcontractor - Electrical Design Associates, Inc.</i>	3	10	8	0	2	3	26	\$ 4,236.08
1.5	Additional Payment Application Review (6 month est.)								
	<i>Subcontractor - Electrical Design Associates, Inc.</i>	0	6	0	0	0	0	6	\$ 1,126.92
1.6	Additional Daily Work Report, Project Summary updates (6 month est.; 24 weeks)								
	<i>Subcontractor - Electrical Design Associates, Inc.</i>	0	38	18	0	0	0	54	\$ 9,478.20
1.7	Provide additional field construction oversight								
1.7.1	Provide additional field construction oversight during rehabilitation, abandonments, and electrical improvements for 4 wells - WTP 8 (6 month est.)								
	<i>Subcontractor - Electrical Design Associates, Inc.</i>	3	120	102	0	0	12	237	\$ 39,593.49
	<b>Subtotal Task 2</b>	<b>6</b>	<b>226</b>	<b>140</b>	<b>0</b>	<b>2</b>	<b>21</b>	<b>395.0</b>	
	Labor Subtotal Hours	6	226	140	0	2	21		
	Labor Hourly Billing Rates	\$ 218.01	\$ 187.82	\$ 150.93	\$ 134.16	\$ 122.42	\$ 83.85		
	Labor Raw Costs	\$ 73.16	\$ 63.03	\$ 50.65	\$ 45.02	\$ 41.08	\$ 28.14		
	Labor Multiplier	2.98	2.98	2.98	2.98	2.98	2.98		
	Labor SubTotal	\$ 1,308.08	\$ 42,447.32	\$ 21,130.20	\$ -	\$ 244.84	\$ 1,760.85		\$ 66,891.27
	Labor Total								\$66,891.27
	Mileage/ODC								\$0.00
	Subconsultant Total								\$66,891.27

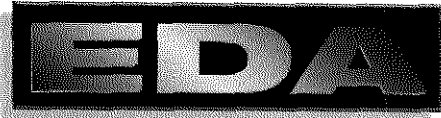

August 22, 2025

## *Electrical Design Associates*

Ms. Rani K. Smith, P.G.  
Principal Hydrogeologist  
JLA Geosciences, Inc.  
1907 Commerce Lane, Suite 104  
Jupiter, Florida 33458

Re: System-Wide Wellfield Improvements Phase 2 – Additional Construction Phase Services  
Project Number: WUD 19-022, CSA#3, Supplement 3.4  
Palm Beach County, FL

Dear Ms. Smith:

We are pleased to submit our revised proposal for additional general services during construction as it relates to the electrical design for the above referenced project. The following serves to provide an overview of the engineering services Electrical Design Associates, Inc. (EDA) intends to furnish on the above referenced project to JLA Geosciences, Inc (JLA). Your signature on this agreement will serve as your letter of intent.

The project originally included 30 months of anticipated construction oversight. Based on the Contractor's schedule and WUD-approved change orders, the project extended to an estimated 40 months under Supplement 3.3. However, based on the current Contractor schedule the project looks to extend to an estimated 46 months of construction oversight and progress meetings.

Our services shall include additional general services during construction and shall include the following:

### **TASK 1.0 PHASE 2: ADDITIONAL CONSTRUCTION PHASE SERVICES**

- Task 1.1 Additional Project Management (6 months estimated)** – EDA shall assist JLA in providing additional project coordination with COUNTY representatives and Construction Contractor and overall general project management during field services.
- Task 1.3 Additional Progress Meetings (6 estimated)** – EDA shall attend six (6) additional construction progress meeting at periods appropriate to the various stages of construction as necessary based on the progress of the job and estimated hours provided herein, throughout the duration of the project (6 months). Concurrently on the day of the monthly construction progress meeting, observe the construction of the project and discuss any concerns with the COUNTY.
- Task 1.4 Additional Contractor submittal review (8 estimated)** - EDA shall review additional contractor submitted shop drawings and submittals for electrical, instrumentation and all mechanical equipment with electrical and/or instrumentation interface (8 estimated). EDA shall respond to reasonable and appropriate Contractor requests for information (RFI) and issue necessary clarifications and interpretations of the Contract Documents to the COUNTY as appropriate to the orderly completion of the Contractor's work. The hourly estimate is based on one (1) RFI.

7284 WEST PALMETTO PARK RD, SUITE 302-S  
BOCA RATON, FL 33433

**Task 1.5 Additional Payment Application Review (6 months estimated)** – EDA shall assist JLA with additional review and provide recommendations for the acceptance of the contractor submitted payment applications (6 estimated).

**Task 1.6 Additional Daily Work Reports, Weekly Project Summary Updates (6 months estimated; 24 weeks)** – EDA shall provide assistance to JLA in preparing additional daily work report for site inspection activities and submit to the COUNTY on a weekly basis during well field construction activities. EDA's assistance includes preparation of the electrical weekly report based on site visit and/or coordination activities performed during the week. The hourly estimate is based one (1) site visit per week.

**Task 1.7 Additional Field Construction oversight (6 months estimated)**

**Task 1.7.1 Additional Field Construction oversight – WTP 8 Well Replacement/Rehabilitation for 4 wells (6 months estimated)** – EDA shall provide additional oversight, development, testing during critical phases of construction for the electrical and instrumentation improvements. One (1) site visit per week is assumed during the duration of major field work associated with the electrical system. Digital photos will be taken of significant activities during well construction.

EDA shall provide coordination and management of electrical improvements, including field assistance during well startup, examining startup documentation provided by vendors, providing troubleshooting assistance to the Contractor and providing guidance to the COUNTY.

#### **Task 1.0 – Assumptions**

- All coordination with COUNTY shall be through the COUNTY Project Manager.
- Project job trip reports shall be delivered in electronic format compatible with MS Office 2016 and Adobe Acrobat in accordance with the project schedule.
- Construction oversight is based on the final design construction schedule (approximately 6 months). EDA shall be onsite during critical phases of electrical construction only.
- EDA shall not be responsible for the acts or omissions of a Contractor, or of any of their subcontractors, suppliers, or of any other individual or entity performing or furnishing the Work.
- No permitting costs are included in this Task.
- Visits and observations by EDA are not intended to be exhaustive or to extend to every aspect of the Contractor's work in progress. Observations are to be limited to spot checking, selective measurement, and similar methods of general observation of the Work based on EDA's exercise of professional judgement. Based on the information obtained during such visits and such observations, EDA will determine if the Contractor's work is generally proceeding in accordance with the Contract Documents, and EDA shall keep the COUNTY informed of the general progress of the work through weekly reporting.
- The purpose of EDA's visits to the site will be to enable EDA to better carry out the duties and responsibilities outlined in this CSA to provide the COUNTY a greater degree of confidence that the completed Work will conform in general to the Contract Documents and

that the integrity of the design concept of the completed project as a functioning whole as indicated in the Contract Documents has been implemented and preserved by the Contractor. EDA shall not, during such visits or as a result of such observations of the Contractor's work in progress, supervise, direct, or have control over the Contractor's work, nor shall EDA have authority over or responsibility for the means, methods, techniques, equipment choice and usage, sequences, schedules, or procedures of construction selected by the Contractor, for safety precautions and programs incident to the Contractor's work, nor for any failure of the Contractor to comply with laws and regulations applicable to the Contractor's furnishing and performing the Work. Accordingly, EDA neither guarantees the performance of any Contractor nor assumes responsibility for any Contractor's failure to furnish and perform its work in accordance with the Contract Documents.

- EDA shall recommend to the COUNTY that the Contractor's work be disapproved and rejected while it is in progress if, on the basis of such observations, EDA believes that such work will not produce a completed Project that confirms generally to the Contractor Documents or that it will prejudice the integrity of the design concept of the completed Project as a functioning whole as indicated in the Contract Documents. EDA shall not have the authority or responsibility to stop the work of any Contractor.

Our scope of work shall be as outlined above and as indicated on the attached estimate of work effort. Services not specifically defined are not included. Additional services can be provided under separate Scope of Service(s) or by an amendment to this Scope of Services. Travel to and from the site and other direct costs are included in the overhead rate and will not be billed as a separate line item. Our fee for this work shall be billed lump sum, billed monthly, and shall be payable as follows:

Task 1.1 Additional Project Management	\$	7,948.86
Task 1.3 Additional Progress Meetings	\$	4,507.68
Task 1.4 Additional Contractor Submittal Review	\$	4,236.06
Task 1.5 Additional Payment Application Review	\$	1,126.92
Task 1.6 Add. Daily Work Reports/Wkly Proj. Summary	\$	9,478.26
Task 1.7.1 Add. Field Const. Oversight – WTP 8	\$	<u>39,593.49</u>
<b>Total:</b>	\$	<b>66,891.27</b>

Very truly yours,



Dameion Donaldson, P.E.

ACCEPTED \_\_\_\_\_

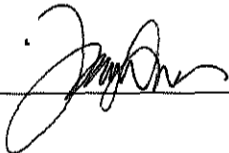

DATE 3/16/26

Enclosures

Activity ID	Activity Name	Original Duration	Remaining Duration	Actual Duration	Start	Finish	Activity % Complete	Total Float	Gantt Chart											
									Q	Q	Q	Q	Q	Q	Q	Q	Q	Q	Q	Q
<b>PBC Wellfield Improvements Phase 2 (19-022)</b>									<ul style="list-style-type: none"> <li>◆ Notice to Proceed, 30-Dec-21 A</li> <li>◆ Milestone 1 - 2W-3R Work Area Reduction (230 days 8/17/22),</li> <li>◆ Milestone 2 - T2W Electrical Work (357 days 12/22/22),</li> <li>◆ Constraint to Start Work @ Wells 2W-4, 5 &amp; 6 (420 days 2/23/23), 23-Feb-23 A</li> <li>◆ Constraint to Start 2W-3R Access Road (420 days 2/23/23), 23-Feb-23 A</li> <li>◆ Milestone 3 - 2W-3R &amp; 2W-7R RTU's (545 days 8/28/23),</li> <li>◆ Milestone 4 - 2W-3R &amp; 2W-7R Completion (885 days 11/15/23),</li> <li>◆ Miles</li> <li>◆ Sul</li> <li>◆ I</li> <li>◆ I</li> </ul>											
<b>General Requirements</b>																				
<b>General Conditions</b>																				
A1000	Notice to Proceed	0	0	0	30-Dec-21 A	08-Oct-25	100%													
A1010	Bldg Permits	22	0	60	30-Dec-21 A	25-Mar-22 A	100%													
A1020	Milestone 1 - 2W-3R Work Area Reduction (230 days 8/17/22)	0	0	0		17-Aug-22 A	100%													
A1030	Milestone 2 - T2W Electrical Work (357 days 12/22/22)	0	0	0		22-Dec-22 A	100%													
A1090	Constraint to Start Work @ Wells 2W-4, 5, & 6 (420 days 2/23/23)	0	0	0	23-Feb-23 A		100%													
A1100	Constraint to Start 2W-3R Access Road (420 days 2/23/23)	0	0	0	23-Feb-23 A		100%													
A1040	Milestone 3 - 2W-3R & 2W-7R RTU's (545 days 8/28/23)	0	0	0		28-Jun-23 A	100%													
A1050	Milestone 4 - 2W-3R & 2W-7R Completion (885 days 11/15/23)	0	0	0		17-Jul-23 A	100%													
A1060	Milestone 5 - All WTP 8 Wells Completion (980 days 7/26/25)	0	0	0		18-Aug-25*	0%	-238	◆ Miles											
A1070	Substantial Completion (9/05/24)	0	0	0		08-Sep-25*	0%	-252	◆ Sul											
A1110	Punchlist	22	22	0	09-Sep-25	08-Oct-25	0%	-252	◆ I											
A1080	Final Completion (9/05/24)	0	0	0		08-Oct-25*	0%	-252	◆ I											
<b>Submittal Review</b>																				
A1160	Well screens	10	0	20	08-Nov-21 A	08-Dec-21 A	100%		- Well screens											
A1860	Misc metals	10	0	19	10-Nov-21 A	09-Dec-21 A	100%		- Misc metals											
A1190	Ductile iron pipe, fittings, appurtenances	10	0	18	11-Nov-21 A	09-Dec-21 A	100%		- Ductile iron pipe, fittings, appurtenances											
A1200	Underground valves	10	0	13	11-Nov-21 A	02-Dec-21 A	100%		- Underground valves											
A1210	Flanged valves	10	0	13	11-Nov-21 A	02-Dec-21 A	100%		- Flanged valves											
A1120	WTP 2 Basic Electrical Materials	15	0	8	15-Nov-21 A	29-Nov-21 A	100%		- WTP 2 Basic Electrical Materials											
A2980	WTP 2 electrical manholes	15	0	8	15-Nov-21 A	29-Nov-21 A	100%		- WTP 2 electrical manholes											
A1250	Concrete mix designs	10	0	5	23-Nov-21 A	02-Dec-21 A	100%		- Concrete mix designs											
A1220	WTP 2 I&C	15	0	82	24-Nov-21 A	24-Mar-22 A	100%		- WTP 2 I&C											
A1170	WTP 2 pumps & motors	15	0	4	30-Nov-21 A	06-Dec-21 A	100%		- WTP 2 pumps & motors											
A1180	WTP 8 pumps & motors	15	0	4	30-Nov-21 A	06-Dec-21 A	100%		- WTP 8 pumps & motors											
A1140	Basic Well Drilling Materials	10	0	1	01-Dec-21 A	02-Dec-21 A	100%		- Basic Well Drilling Materials											
A2500	Stepdown transformers	15	0	18	01-Dec-21 A	28-Dec-21 A	100%		- Stepdown transformers											
A1150	Wellheads	10	0	8	08-Dec-21 A	20-Dec-21 A	100%		- Wellheads											
A1280	WTP 2 electrical gear	15	0	9	08-Dec-21 A	21-Dec-21 A	100%		- WTP 2 electrical gear											
A5020	Wind load calculations	15	0	44	03-Jan-22 A	04-Mar-22 A	100%		- Wind load calculations											
A2980	WTP 8 electrical gear	15	0	8	12-Jan-22 A	24-Jan-22 A	100%		- WTP 8 electrical gear											
A1130	WTP 8 Basic Electrical Materials	15	0	17	20-Jan-22 A	14-Feb-22 A	100%		- WTP 8 Basic Electrical Materials											
A3350	WTP 8 electrical manholes	15	0	8	02-Feb-22 A	14-Feb-22 A	100%		- WTP 8 electrical manholes											
A5030	Radio Survey for WTP 8	15	0	10	22-Feb-22 A	08-Mar-22 A	100%		- Radio Survey for WTP 8											
A1240	Chain link fences & gates	10	0	3	01-Mar-22 A	04-Mar-22 A	100%		- Chain link fences & gates											
A1230	WTP 8 I&C	15	0	168	08-Mar-22 A	02-Nov-22 A	100%		- WTP 8 I&C											
A4840	Short circuit coordination study	15	15	0	04-Aug-25	22-Aug-25	0%	-242												
A5040	Electrical test reports	15	15	0	18-Aug-25	08-Sep-25	0%	-252												
<b>Procurement</b>									<ul style="list-style-type: none"> <li>◆ 06-Dec-23 A, Procurement</li> </ul>											
A2850	Well screens	30	0	44	08-Nov-21 A	13-Jan-22 A	100%		- Well screens											
A2870	WTP 2 electrical manholes	40	0	85	29-Nov-21 A	30-Mar-22 A	100%		- WTP 2 electrical manholes											
A2880	WTP 2 pumps & motors	100	0	201	06-Dec-21 A	20-Sep-22 A	100%		- WTP 2 pumps & motors											
A2870	WTP 8 pumps & motors	100	0	202	08-Dec-21 A	20-Sep-22 A	100%		- WTP 8 pumps & motors											

PBC Wellfield Improvements Phase 2 (19-022)		PDF-FDD					12-Aug-25 13:37																													
Activity ID	Activity Name	Original Duration	Remaining Duration	Actual Duration	Start	Finish	Activity % Complete	Total Float	Gantt Chart (D J F M A M J J A S O N D J F M A M J J A S O N D J F M A M J J A S O N D J F M A M J J A S O)																											
A2900	Flanged valves	50	0	160	06-Dec-21 A	22-Jul-22 A	100%		Flanged valves																											
A2810	WTP 2 Basic Electrical Materials	10	0	16	08-Dec-21 A	03-Jan-22 A	100%		WTP 2 Basic Electrical Materials																											
A2880	Ductile iron pipe, fittings, appurtenances	60	0	157	09-Dec-21 A	22-Jul-22 A	100%		Ductile iron pipe, fittings, appurtenances																											
A2890	Underground valves	50	0	154	14-Dec-21 A	22-Jul-22 A	100%		Underground valves																											
A2940	Misc metals	40	0	113	15-Dec-21 A	25-May-22	100%		Misc metals																											
A2990	WTP 2 electrical gear	150	0	341	21-Dec-21 A	25-Apr-23 A	100%		WTP 2 electrical gear																											
A2830	Basic Well Drilling Materials	5	0	4	03-Jan-22 A	07-Jan-22 A	100%		Basic Well Drilling Materials																											
A2840	Wellheads	80	0	102	03-Jan-22 A	26-May-22	100%		Wellheads																											
A2950	Stepdown transformers	200	0	304	03-Jan-22 A	13-Mar-23 A	100%		Stepdown transformers																											
A3000	WTP 8 PP6	150	0	476	24-Jan-22 A	09-Dec-23 A	100%		WTP 8 PP6																											
A4100	WTP 8 VFD's	150	0	373	24-Jan-22 A	12-Jul-23 A	100%		WTP 8 VFD's																											
A3960	WTP 8 electrical manholes	40	0	117	14-Feb-22 A	29-Jul-22 A	100%		WTP 8 electrical manholes																											
A2910	WTP 2 I&C	100	0	84	24-Mar-22 A	22-Jul-22 A	100%		WTP 2 I&C																											
A2920	WTP 8 I&C	100	0	107	24-Mar-22 A	24-Aug-22 A	100%		WTP 8 I&C																											
A2820	WTP 8 Basic Electrical Materials	10	0	9	18-Jul-22 A	29-Jul-22 A	100%		WTP 8 Basic Electrical Materials																											
A2830	Chain link fences & gates	20	0	80	03-Mar-23 A	23-Jun-23 A	100%		Chain link fences & gates																											
<b>Construction Phase</b>		918	11	907	03-Jan-22 A	19-Aug-25		4	18-A																											
<b>WTP 2</b>		869	0	864	03-Jan-22 A	03-Jun-25 A			03-Jun-25 A																											
<b>General Work On Site WTP 2</b>		237	0	237	18-Jan-22 A	15-Oct-22 A			15-Oct-24 A, General Work On Site																											
A5080	Tree removal by alb Vance	22	0	218	18-Jan-22 A	23-Nov-22 A	100%		Tree removal by alb Vance																											
A3130	Install J-boxes & exposed conduits at hypo bldg	10	0	10	04-Apr-22 A	15-Apr-22 A	100%		Install J-boxes & exposed conduits at hypo bldg																											
A3080	Install conduits to 2W-7R	10	0	17	02-May-22 A	25-May-22	100%		Install conduits to 2W-7R																											
A3150	Restore access road to 2W-7R	5	0	4	23-May-22 A	27-May-22	100%		Restore access road to 2W-7R																											
A3010	Install conduits from hypo bldg to MH-1	10	0	12	05-Jul-22 A	21-Jul-22 A	100%		Install conduits from hypo bldg to MH-1																											
A3020	Install all electrical manholes	10	0	62	05-Jul-22 A	15-Sep-22 A	100%		Install all electrical manholes																											
A3140	Restore asphalt & sidewalks near hypo bldg	5	0	26	26-Jul-22 A	30-Aug-22 A	100%		Restore asphalt & sidewalks near hypo bldg																											
A3030	Install conduits from MH-1 to MH-2	10	0	16	29-Aug-22 A	21-Sep-22 A	100%		Install conduits from MH-1 to MH-2																											
A3060	Install conduits from MH-4 to MH-5	10	0	17	19-Sep-22 A	12-Oct-22 A	100%		Install conduits from MH-4 to MH-5																											
A3050	Install conduits from MH-3 to MH-4	10	0	4	13-Oct-22 A	19-Oct-22 A	100%		Install conduits from MH-3 to MH-4																											
A3090	Install conduits to 2W-4R	5	0	3	08-Nov-22 A	10-Nov-22 A	100%		Install conduits to 2W-4R																											
A3100	Install conduits to 2W-5R	5	0	3	13-Nov-22 A	17-Nov-22 A	100%		Install conduits to 2W-5R																											
A3110	Install conduits to 2W-6R	5	0	3	20-Nov-22 A	24-Nov-22 A	100%		Install conduits to 2W-6R																											
A3040	Install conduits from MH-2 to MH-3	10	0	13	05-Dec-22 A	22-Dec-22 A	100%		Install conduits from MH-2 to MH-3																											
A3160	Relocate backwash bucket in MCC, Install new breakers for 2W-7R & T-2W	5	0	1	12-Dec-22 A	13-Dec-22 A	100%		Relocate backwash bucket in MCC, Install new breakers for 2W-7R & T-2W																											
A3200	Install conduit & cables to backwash PS control panel	5	0	1	12-Dec-22 A	13-Dec-22 A	100%		Install conduit & cables to backwash PS control panel																											
A5050	Shutdown for T-2W breaker installation	1	0	0	13-Dec-22 A	13-Dec-22 A	100%		Shutdown for T-2W breaker installation																											
A3070	Install conduits to 2W-3R	10	0	13	03-Jan-23 A	19-Jan-23 A	100%		Install conduits to 2W-3R																											
A3120	FRP pad & bollard inserts for T-2W	5	0	9	27-Feb-23 A	10-Mar-23 A	100%		FRP pad & bollard inserts for T-2W																											
A3170	Pull cables from hypo bldg to MH-1	5	0	5	30-Mar-23 A	05-Apr-23 A	100%		Pull cables from hypo bldg to MH-1																											
A3180	Pull cables from MH-1 to MH-2	5	0	5	28-Apr-23 A	04-May-23	100%		Pull cables from MH-1 to MH-2																											
A3190	Pull cables from MH-2 to MH-5	10	0	10	05-May-23 A	18-May-23	100%		Pull cables from MH-2 to MH-5																											
A1820	BY OTHERS put new RWM to 2W-3 in b service	60	0	58	30-Nov-23 A	21-Feb-24 A	100%		BY OTHERS put new RWM to 2W-3 in b service																											
A1550	Abandon existing 14" RWM	5	0	9	12-Feb-24 A	23-Feb-24 A	100%		Abandon existing 14" RWM																											
A1720	Grout fill existing 14" RWM	5	0	6	07-Oct-24 A	15-Oct-24 A	100%		Grout fill existing 14" RWM																											
<b>2W-3R (Milestone 4)</b>		661	0	660	03-Jan-22 A	15-Sep-24 A			13-Sep-24 A, 2W-3R (Milestone 4)																											
A1260	Take well 2W-3 offline	0	0	0	03-Jan-22 A		100%		Take well 2W-3 offline, 03-Jan-22 A																											

Actual Level of Effort
  Remaining Work
  Critical Remaining Work
  Primary Baseline
  Actual Work
  Milestone

Data Date  
04-Aug-25













PBC Wellfield Improvements Phase 2 (19-022)		PDF-FDD					12-Aug-25 13:38																													
Activity ID	Activity Name	Original Duration	Remaining Duration	Actual Duration	Start	Finish	Activity % Complete	Total Float	Gantt Chart (Days: D, J, F, M, A, M, J, J, A, S, O, N, D, J, F, M, A, M, J, J, A, S, O, N, D, J, F, M, A, M, J, J, A, S, O)																											
A4360	Contractor startup	5	0	5	07-Sep-23 A	13-Sep-23 A	100%		Contractor startup																											
A4370	Disinfection & bac-T sampling	10	0	12	18-Sep-23 A	04-Oct-23 A	100%		Disinfection & bac-T sampling																											
A4380	Witnessed startup & testing	5	0	1	27-Sep-23 A	28-Sep-23 A	100%		Witnessed startup & testing																											
A4390	Health department clearance	20	0	12	04-Oct-23 A	20-Oct-23 A	100%		Health department clearance																											
A4410	Put well 8W-17 into service	0	0	0		25-Oct-23 A	100%		Put well 8W-17 into service.																											
A4420	Final restoration & sodding	5	0	5	30-Oct-23 A	06-Nov-23 A	100%		Final restoration & sodding																											
<b>8W-18 (Milestone 5)</b>		260	0	260	19-Sep-22 A	06-Nov-23 A			<ul style="list-style-type: none"> <li>Take well 8W-18 offline, 19-Sep-22 A</li> <li>Pre-work video &amp; logging</li> <li>Remove 16" screen &amp; riser casing</li> <li>Demolish wellhead &amp; piping</li> <li>Clean out borehole</li> <li>Gravel Procurement Delay</li> <li>Install new 16" screen, casing &amp; gravel pack</li> <li>Logging &amp; optional video</li> <li>Setup formation water disposal system</li> <li>Well development</li> <li>Pump testing &amp; WQ sampling</li> <li>Final video &amp; logging</li> <li>Install casing flange</li> <li>Pothole existing RWM</li> <li>Install wellhead &amp; submersible pump</li> <li>Restrain existing RWM</li> <li>Install RWM piping &amp; pressure test</li> <li>Install BFV</li> <li>FRP antenna base</li> <li>Electrical slab rough-in &amp; install racks</li> <li>Install fence posts</li> <li>FRP well slab</li> <li>Install panels &amp; instrument stands</li> <li>Install chainlink fencing &amp; gates</li> <li>Put &amp; connect electrical wires</li> <li>Contractor startup</li> <li>Disinfection &amp; bac-T sampling</li> <li>Witnessed startup &amp; testing</li> <li>Health department clearance</li> <li>Put well 8W-18 into service.</li> <li>Final restoration &amp; sodding</li> </ul>																											
A4450	Take well 8W-18 offline	0	0	0	19-Sep-22 A		100%																													
A4480	Pre-work video & logging	1	0	0	19-Sep-22 A	19-Sep-22 A	100%																													
A4490	Remove 16" screen & riser casing	5	0	3	20-Sep-22 A	23-Sep-22 A	100%																													
A4470	Demolish wellhead & piping	1	0	0	21-Sep-22 A	21-Sep-22 A	100%																													
A4500	Clean out borehole	3	0	3	24-Oct-22 A	28-Oct-22 A	100%																													
A4980	Gravel Procurement Delay	30	0	54	27-Oct-22 A	17-Jan-23 A	100%																													
A4540	Install new 16" screen, casing & gravel pack	3	0	3	24-Jan-23 A	28-Jan-23 A	100%																													
A4510	Logging & optional video	1	0	1	24-Jan-23 A	24-Jan-23 A	100%																													
A4550	Setup formation water disposal system	3	0	3	25-Jan-23 A	27-Jan-23 A	100%																													
A4560	Well development	40	0	27	30-Jan-23 A	08-Mar-23 A	100%																													
A4580	Pump testing & WQ sampling	2	0	2	08-Mar-23 A	09-Mar-23 A	100%																													
A4590	Final video & logging	1	0	1	10-Mar-23 A	13-Mar-23 A	100%																													
A4500	Install casing flange	2	0	0	19-Apr-23 A	19-Apr-23 A	100%																													
A4430	Pothole existing RWM	1	0	0	19-Apr-23 A	19-Apr-23 A	100%																													
A4510	Install wellhead & submersible pump	2	0	0	21-Apr-23 A	21-Apr-23 A	100%																													
A4440	Restrain existing RWM	2	0	1	24-Apr-23 A	25-Apr-23 A	100%																													
A4620	Install RWM piping & pressure test	5	0	4	30-May-23 A	02-Jun-23 A	100%																													
A4480	Install BFV	3	0	0	30-May-23 A	30-May-23 A	100%																													
A4630	FRP antenna base	3	0	3	05-Jun-23 A	07-Jun-23 A	100%																													
A4640	Electrical slab rough-in & install racks	8	0	13	08-Jun-23 A	26-Jun-23 A	100%																													
A4650	Install fence posts	2	0	2	27-Jun-23 A	28-Jun-23 A	100%																													
A4660	FRP well slab	4	0	5	29-Jun-23 A	07-Jul-23 A	100%																													
A4670	Install panels & instrument stands	3	0	5	13-Jul-23 A	19-Jul-23 A	100%																													
A4690	Install chainlink fencing & gates	2	0	2	27-Jul-23 A	28-Jul-23 A	100%																													
A4680	Put & connect electrical wires	5	0	5	08-Aug-23 A	14-Aug-23 A	100%																													
A4700	Contractor startup	5	0	5	07-Sep-23 A	13-Sep-23 A	100%																													
A4710	Disinfection & bac-T sampling	10	0	12	18-Sep-23 A	04-Oct-23 A	100%																													
A4720	Witnessed startup & testing	5	0	1	27-Sep-23 A	28-Sep-23 A	100%																													
A4730	Health department clearance	20	0	12	04-Oct-23 A	20-Oct-23 A	100%																													
A4750	Put well 8W-18 into service	0	0	0		25-Oct-23 A	100%																													
A4760	Final restoration & sodding	5	0	5	30-Oct-23 A	06-Nov-23 A	100%																													
<b>8W-22 (Milestone 5)</b>		410	0	410	28-Sep-23 A	27-Feb-25 A			<ul style="list-style-type: none"> <li>Cable delivery for 8W-22 and 8W-3</li> <li>Procure new manholes</li> <li>Put new cables to 8W-22</li> <li>Take well 8W-22 offline</li> <li>Terminate new cables &amp; demolish existing cables</li> <li>Put well 8W-22 online</li> </ul>																											
A4970	Cable delivery for 8W-22 and 8W-3	20	0	106	28-Sep-23 A	28-Feb-24 A	100%																													
A5010	Procure new manholes	40	0	171	13-Mar-24 A	12-Nov-24 A	100%																													
A4770	Put new cables to 8W-22 & test	5	0	55	02-Dec-24 A	25-Feb-25 A	100%																													
A4830	Take well 8W-22 offline	0	0	0	0	25-Feb-25 A	100%																													
A4920	Terminate new cables & demolish existing cables	1	0	1	25-Feb-25 A	26-Feb-25 A	100%																													
A4780	Put well 8W-22 online	0	0	0		27-Feb-25 A	100%																													
<b>8W-3 (Milestone 5)</b>		175	11	62	09-Dec-24 A	18-Aug-25 A		238																												

Actual Level of Effort    
 Remaining Work    
 Critical Remaining Work    
 Primary Baseline    
 Actual Work    
 Milestone    
→ summary

Data Date  
04-Aug-25



# ATTACHMENT F

Palm Beach County Water Utilities Department

Contract for Consulting/Professional Services  
System-Wide Wellfield Improvements Phase 2 Construction Phase  
Services

Resolution No. R2019-0439      Contract Dated: 4/2/2019

## SUMMARY OF SBE BUSINESS TRACKING

Master Contract Goals	SBE: 59%
<b>Current Proposal</b>	
Value of Authorization No. <u>3.4</u>	\$ 205,013.35
Value of SBE Letters of Intent	\$ 205,013.35
Actual Percentage	100.00%
<b>Signed/Approved Authorizations</b>	
Total Value of Authorizations	\$ 5,042,151.31
Total Value of SBE Signed Subcontractors	\$ 3,975,235.05
Actual Percentage	78.84%
<b>Signed/Approved Authorizations Plus Current Proposal</b>	
Total Value of Authorizations	\$ 5,247,164.66
Total Value of Subcontractors & Letters of Intent	\$ 4,180,248.40
Actual Percentage	79.66%

REVISED 01-27-26

# ATTACHMENT G

Project Title: System-Wide Wellfield Improvements Phase 2 Construction Phase Services  
PBCWUD Project No.: 19-022

## Location Map

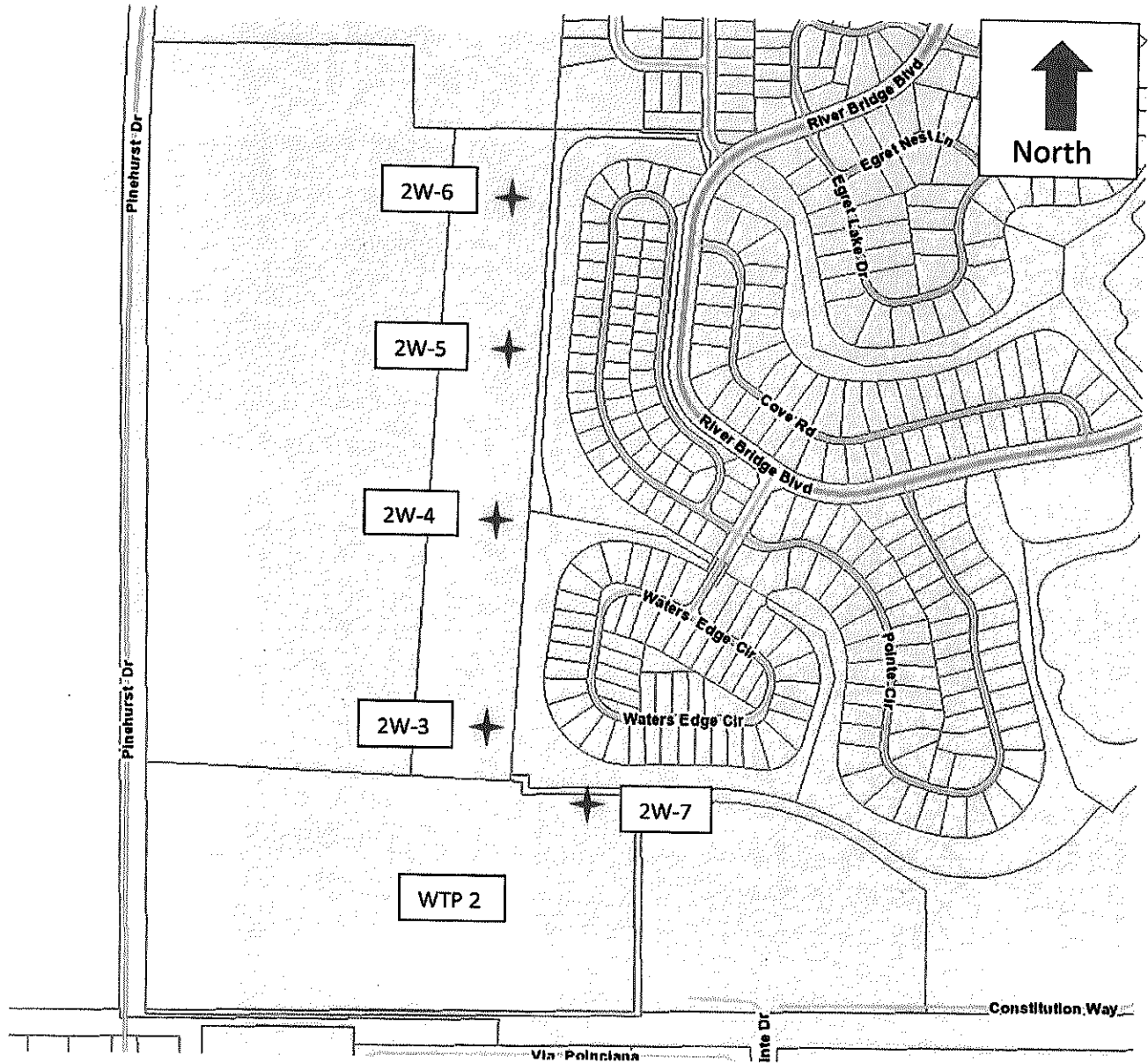

★ Well Locations

Not to Scale

WTP 2 – Water Treatment Plant No. 2

REVISED 01-27-26

# ATTACHMENT G

Project Title: System-Wide Wellfield Improvements Phase 2 Construction Phase Services  
PBCWUD Project No.: 19-022

## Location Map

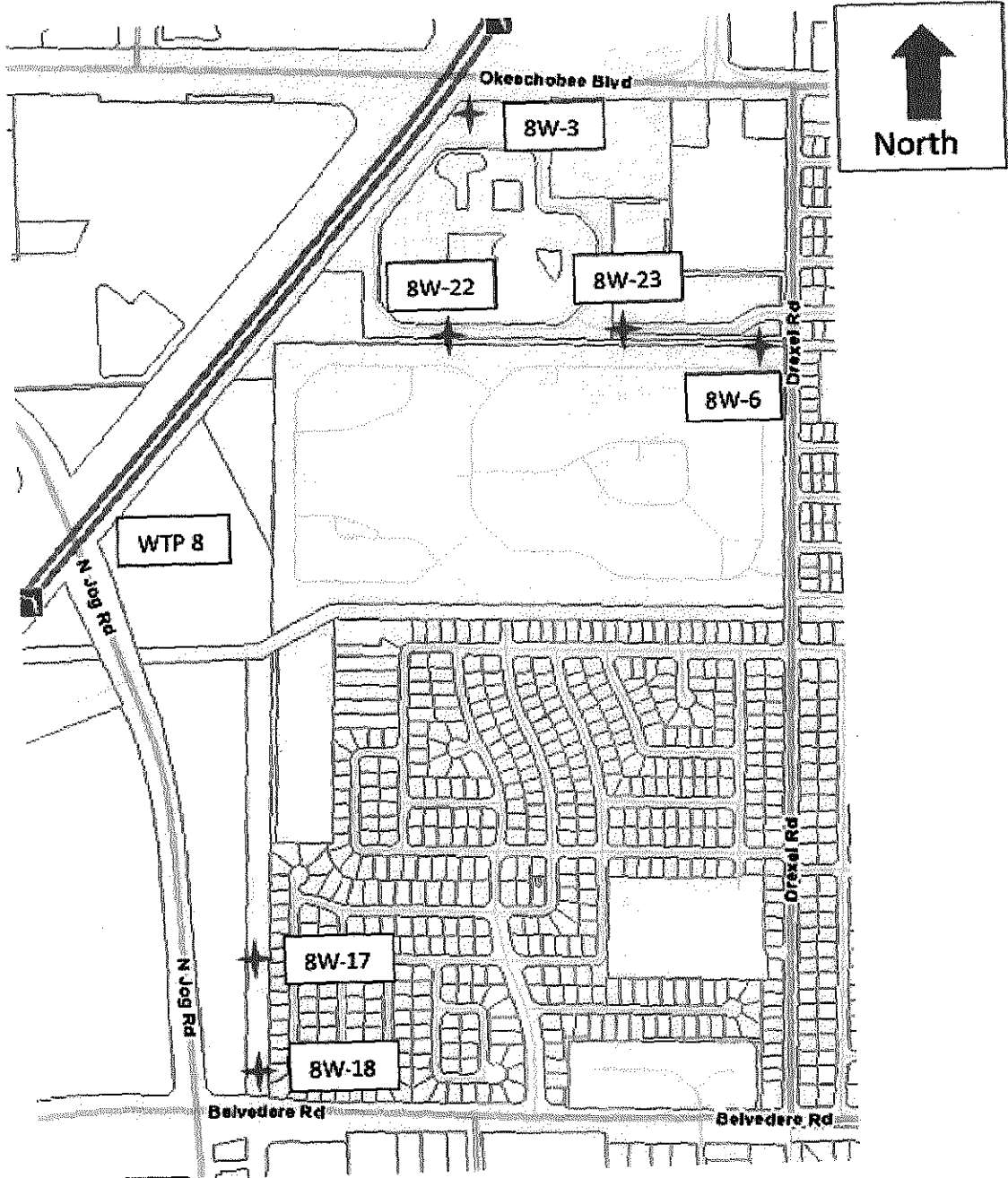

★ Well Locations

WTP 8 – Water Treatment Plant No. 8

Not to Scale

REVISED 01-27-26



July 23, 2025

Mr. James L. Andersen, President  
JLA Geosciences, Inc.  
1907 Commerce Lane, Suite 104  
Jupiter, Florida 33458

Water Utilities Department  
Administration  
8100 Forest Hill Blvd.  
West Palm Beach, FL 33413  
(561) 493-6000  
Fax: (561) 493-6008  
www.pbcwater.com

Re: Project Number: 18-051  
System-Wide Wellfield Improvements Hydrogeologic,  
Engineering Design And Construction Services  
Notification of Contract Clauses No Longer Being Enforced  
Pursuant to Emergency Ordinance 2025-014

Dear Mr. Andersen,

On June 3, 2025, the Board of County Commissioners (BCC) approved an emergency ordinance to suspend the race and gender conscious provisions of the County's EBO ordinance. The suspension will remain in effect for two years or until further direction by the BCC, whichever comes first. As a result, the provisions relating to minority/women-owned business enterprise (M/WBEs) participation contained in the contract document (R2019-0439) in Article 7- Subcontracting will not be enforced as of June 3, 2025, only the small business enterprise (SBE) provisions will apply.

Please sign below to acknowledge receipt of this notification. This acknowledgement will be included in, and made part of, the contract file.

Should you require any additional information please contact Ms. Christina Bervin at [cbervin@pbcwater.com](mailto:cbervin@pbcwater.com) or at (561) 493 5203.

Cordially,

Jane House, P.E., LEED AP  
Director of Engineering Division

Receipt Acknowledged and In Agreement:

JLA Geosciences, Inc.  
(Consultant)

JAMES L. ANDERSEN  
(Print Name)

(Signature)

7-29-2025  
(Date)

Palm Beach County  
Board of County  
Commissioners

- Maria G. Marino, Mayor
- Sara Baxter, Vice Mayor
- Gregg K. Weiss
- Joel G. Flores
- Marci Woodward
- Maria Sachs
- Bobby Powell Jr.

Interim County Administrator  
Todd J. Bonlarron

"An Equal Opportunity Employer"  
Official Electronic Letterhead

# Inter-Office Memorandum

---

Palm Beach County



Water Utilities Department

**DATE:** March 16, 2026  
**TO:** File  
**FROM:** Toral Hertzberg, P.E., Project Manager *THP for TSH*  
Palm Beach County Water Utilities Department, Engineering Division  
**RE:** 19-022 Supplement 3.4  
System-Wide Wellfield Improvements Phase 2 Construction Phase Services  
**FILE:** PBCWUD Project No. 19-022

---

This supplement provides additional professional services to provide additional construction phase services for six months for Water Treatment Plants 2 and 8. Florida Design Drilling (FDD) was further behind than what was anticipated in the previous supplement. Additionally, electrical issues due to damaged boxes and problems with conduit cable runs pushed the schedule back further. JLA oversight is needed for the additional work performed by FDD, leading to the need for this supplement. The goal of this supplement is to provide services to the completion of the project.

A fee analysis of this supplement has been attached. The average burn rate for this CSA, including supplements 1-4, is now \$42,883.81 per month. This is a decrease from the average at the time of CSA 3.3, which was \$44,224.57 per month. CSA 3.1 and CSA 3.2 were in a similar range. This indicates that these costs are in line with previously approved supplements 3.1, 3.2, and 3.3.

# ATTACHMENT 2

Project Title: System-Wide Wellfield Improvements Phase 2 Construction Phase Services  
PBCWUD Project No.: 19-022

## Location Map

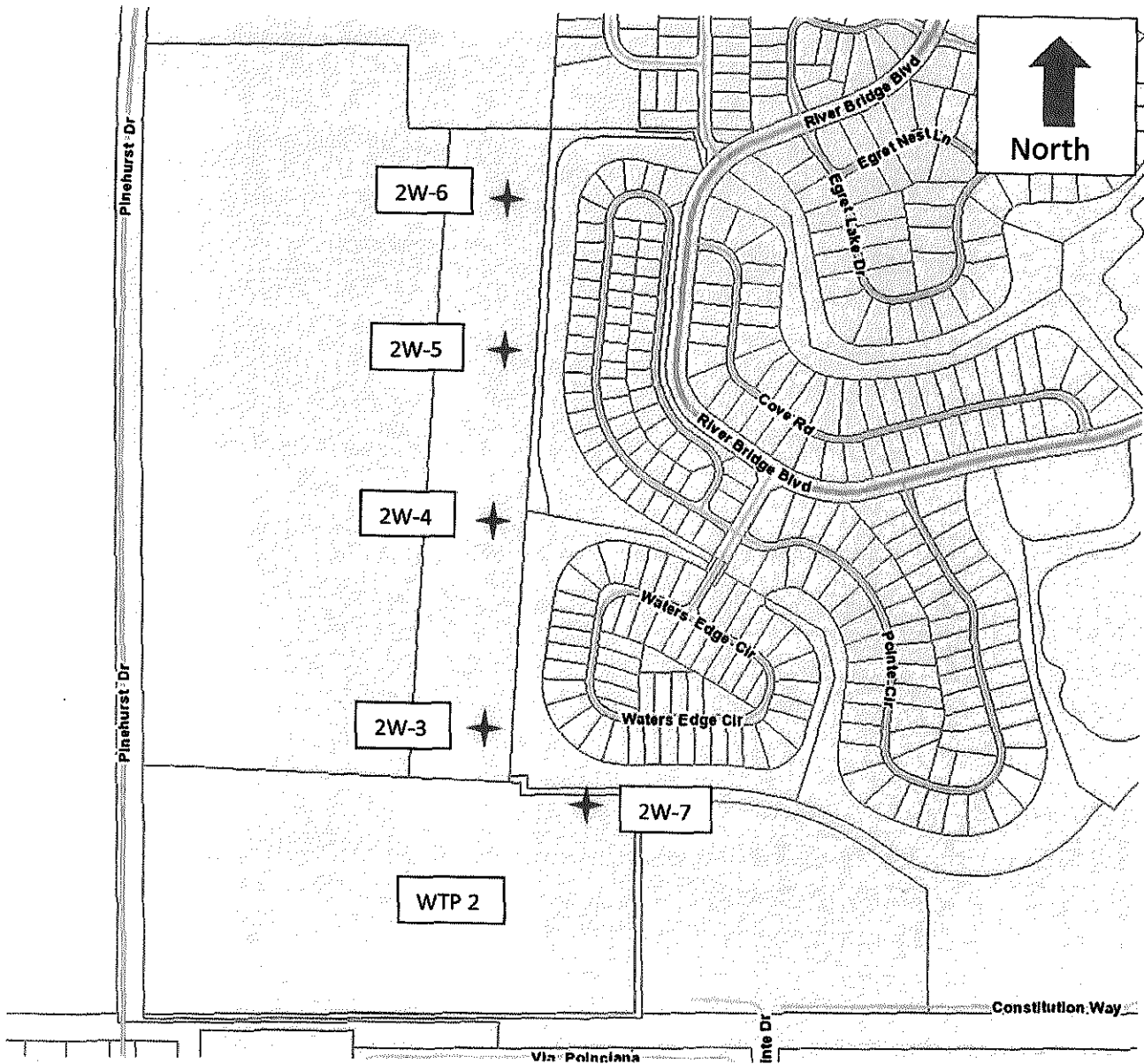

✦ Well Locations

Not to Scale

WTP 2 – Water Treatment Plant No. 2

REVISED 01-27-26

### Location Map

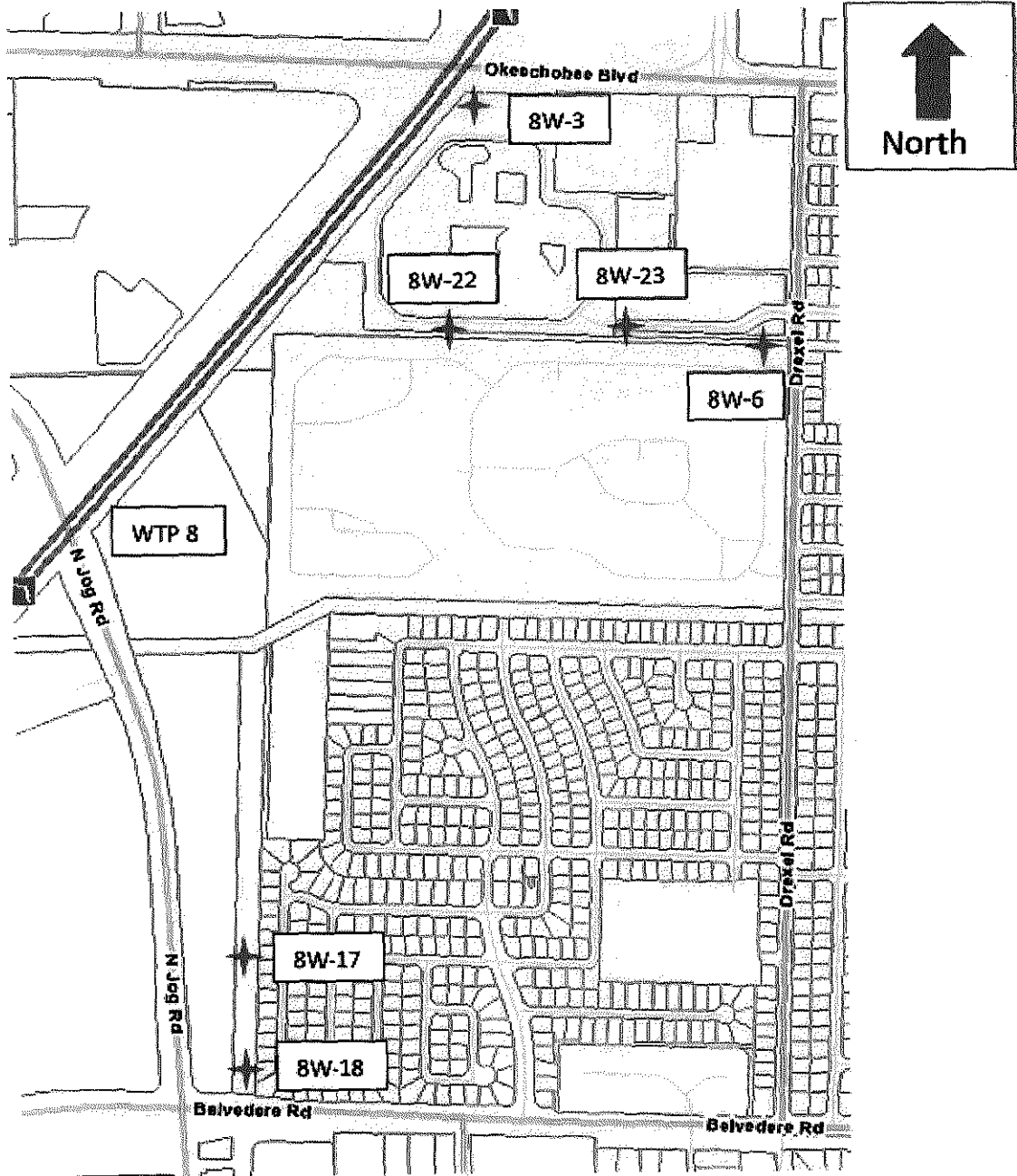

★ Well Locations

Not to Scale

WTP 8 – Water Treatment Plant No. 8

REVISED 01-27-26



**Palm Beach County  
Compliance Summary Report**

Vendor Number	Vendor Name	AM Best Rating	Insurance Carrier	Policy #	Eff. Date	Exp. Date	Coverage	Contract Number	Contract Name
DX00000331	JLA Geosciences Inc	Modified	Compliant					18-051	Consulting/Professional Services system-Wide Wellfield Improvements Hydrogeologic, Engineering Design and Construction Services
		Ar , XV	Midvale Indemnity Company	CA00024841	4/22/2025	4/22/2026	Auto Liability		
		Ap , X	Palomar Excess and Surplus Insurance Company	Binder Received-Policy number required	4/22/2025	4/22/2026	Excess Liability		
		Ap , X	Palomar Excess and Surplus Insurance Company	enc031332801	4/22/2025	4/22/2026	General Liability		
		Ap , X	Palomar Excess and Surplus Insurance Company	enc031332801	4/22/2025	4/22/2026	Professional Liability		
		A-r , XV	Associated Industries Insurance Company, Inc.	twc4600647	5/8/2025	5/8/2026	Workers Comp		

**Risk Profile :** Contract Review Requirements  
**Required Additional Insured :** Palm Beach County Board of County Commissioners  
**Ownership Entity :**