

Amendment ID	Ordinance Number	Adoption Date
LGA 2004-00047	2004-066	12/13/2004

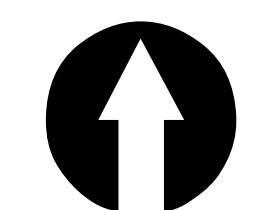
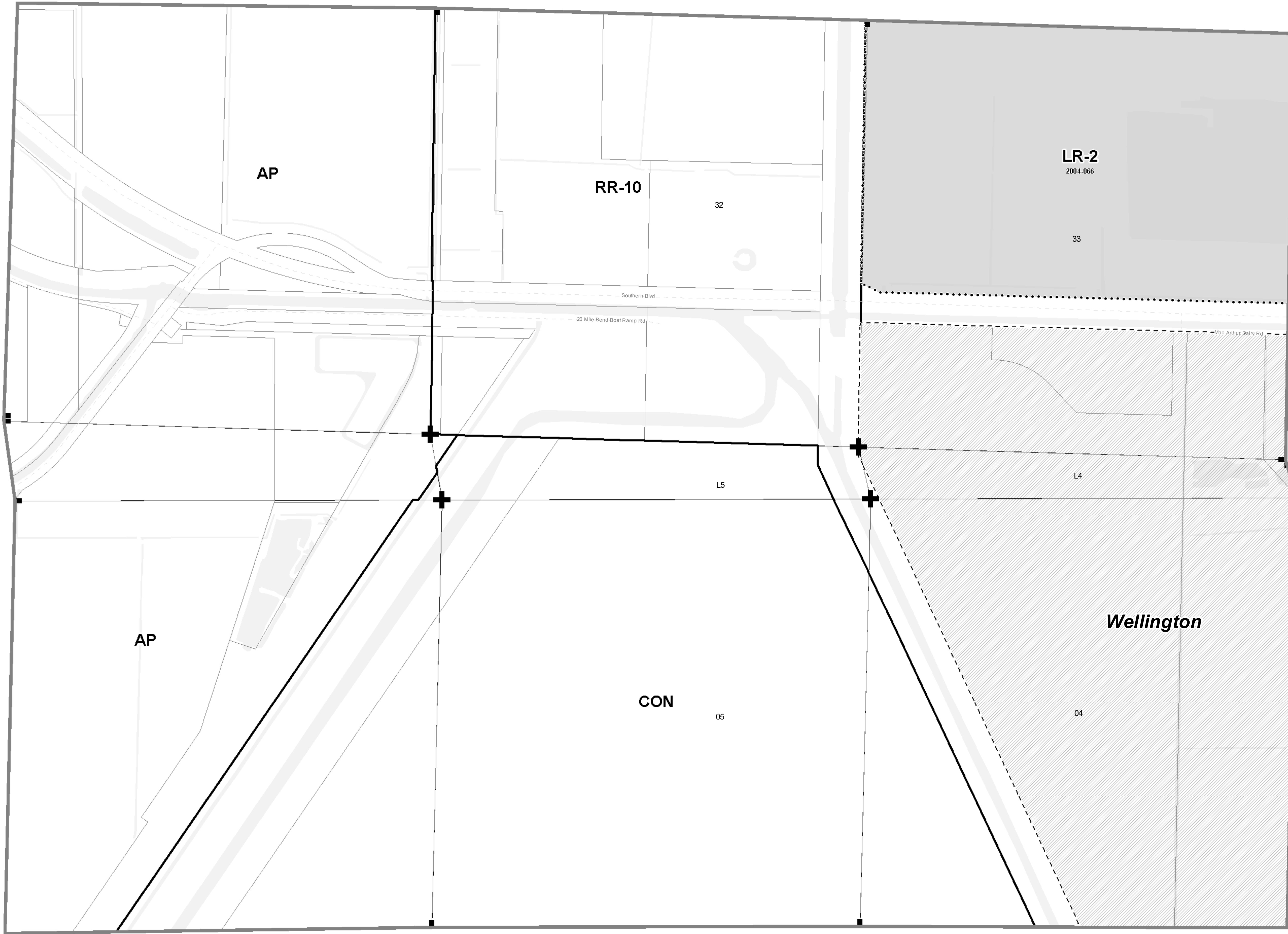

1 inch equals 600 feet  
 0 600 1,200 Feet

This map is a representation of the official copy of the map on file with Palm Beach County Planning Division.

354	355	356	357	358	359	360	361	362	363	364	365	366	367	368	369	370	371	372	373	374	375	376	377	378	379	380	381	382	383	384	385	386	387	388	389	390	391	392	393	394	395	396	397	398	399	400				
150	151	152	153	154	155	156	157	158	159	160	161	162	163	164	165	166	167	168	169	170	171	172	173	174	175	176	177	178	179	180	181	182	183	184	185	186	187	188	189	190	191	192	193	194	195	196	197	198	199	200

01	02	03	04	05	06	07	08	09	10	11	12	13	14	15	16	17	18	19	20	21	22	23	24	25	26	27	28	29	30	31	32	33	34	35	36	37	38	39	40	41	42	43	44	45	46	47	48	49	50
51	52	53	54	55	56	57	58	59	60	61	62	63	64	65	66	67	68	69	70	71	72	73	74	75	76	77	78	79	80	81	82	83	84	85	86	87	88	89	90	91	92	93	94	95	96	97	98	99	100

# Future Land Use Atlas of Palm Beach County, Florida

## ATLAS PAGE 59

Last Printed On:  
Dec 29, 2005

- Future Land Use
- FLU Atlas Page
- Amendments
- Parcels
- Municipality
- Water

Note: The numbers depicted upon the Future Land Use Atlas represent the adopting ordinances for Future Land Use amendments. Please refer to the amendment table for details.



Palm Beach County  
Planning, Zoning and Building Department