

| Amendment ID | Ordinance Number | Adoption Date |
|------------------|------------------|---------------|
| 91D-60, 67 TND 1 | 1993-032 | 12/20/1993 |
| 01-53, 60 RR 1 | 2001-042 | 8/27/2001 |
| 01-60 RR 1 | 2001-042 | 8/27/2001 |
| LGA 2004-00047 | 2004-066 | 12/13/2004 |
| 91D-60, 67 TND 1 | 1991-033 | |

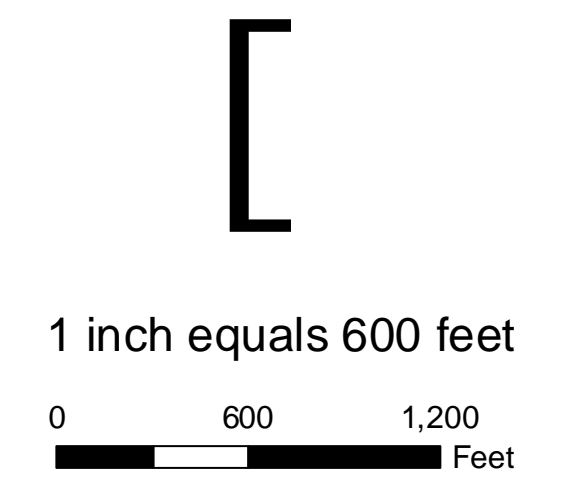
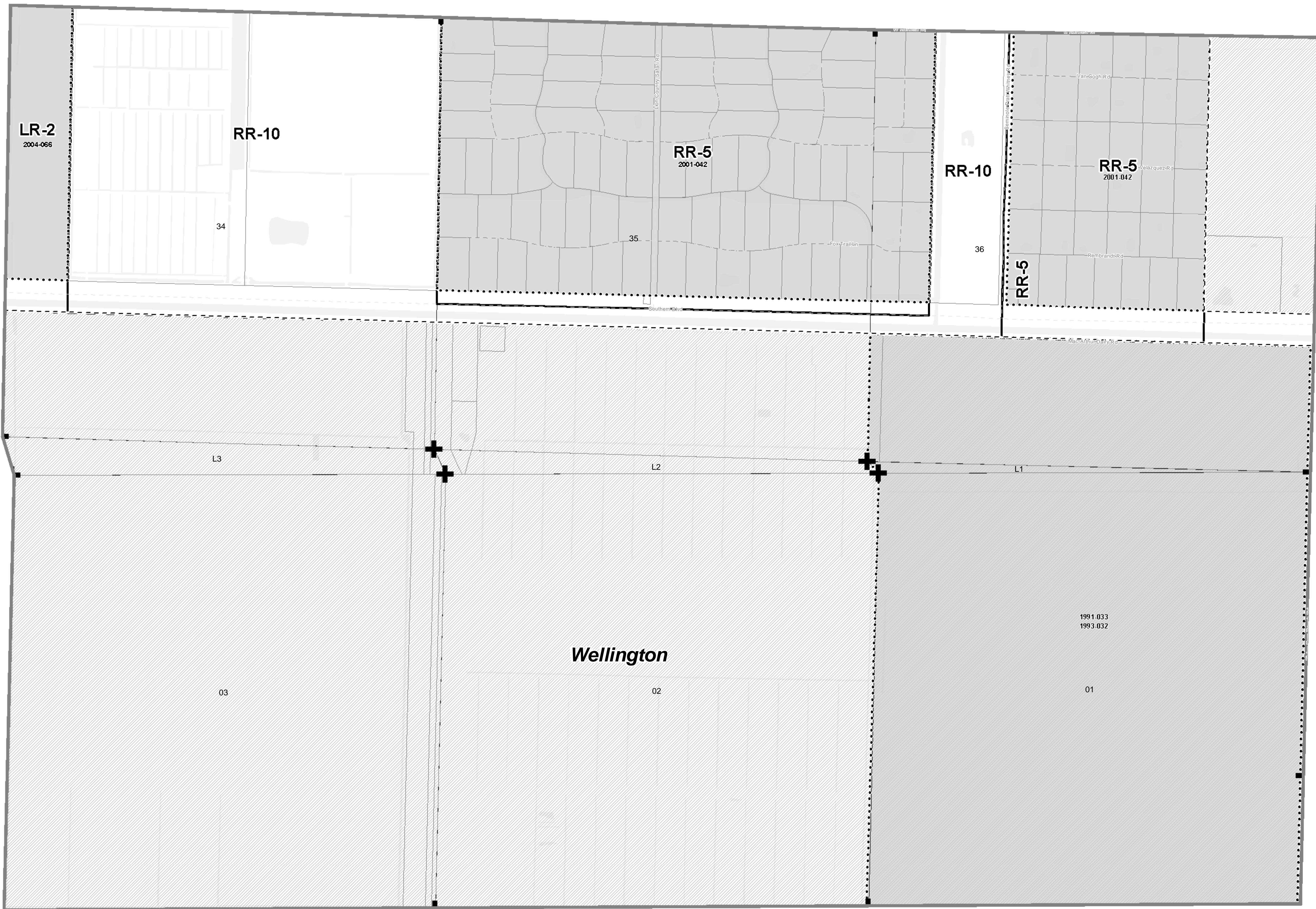

This map is a representation of the official copy of the map on file with Palm Beach County Planning Division.

Future Land Use Atlas of Palm Beach County, Florida

ATLAS PAGE 60

Last Printed On:
Nov 03, 2006

- Future Land Use
- FLU Atlas Page
- Amendments
- Parcels
- Municipality
- Water

Note: The numbers depicted upon the Future Land Use Atlas represent the adopting ordinances for Future Land Use amendments. Please refer to the amendment table for details.



Palm Beach County
Planning, Zoning and Building Department

