

19-5

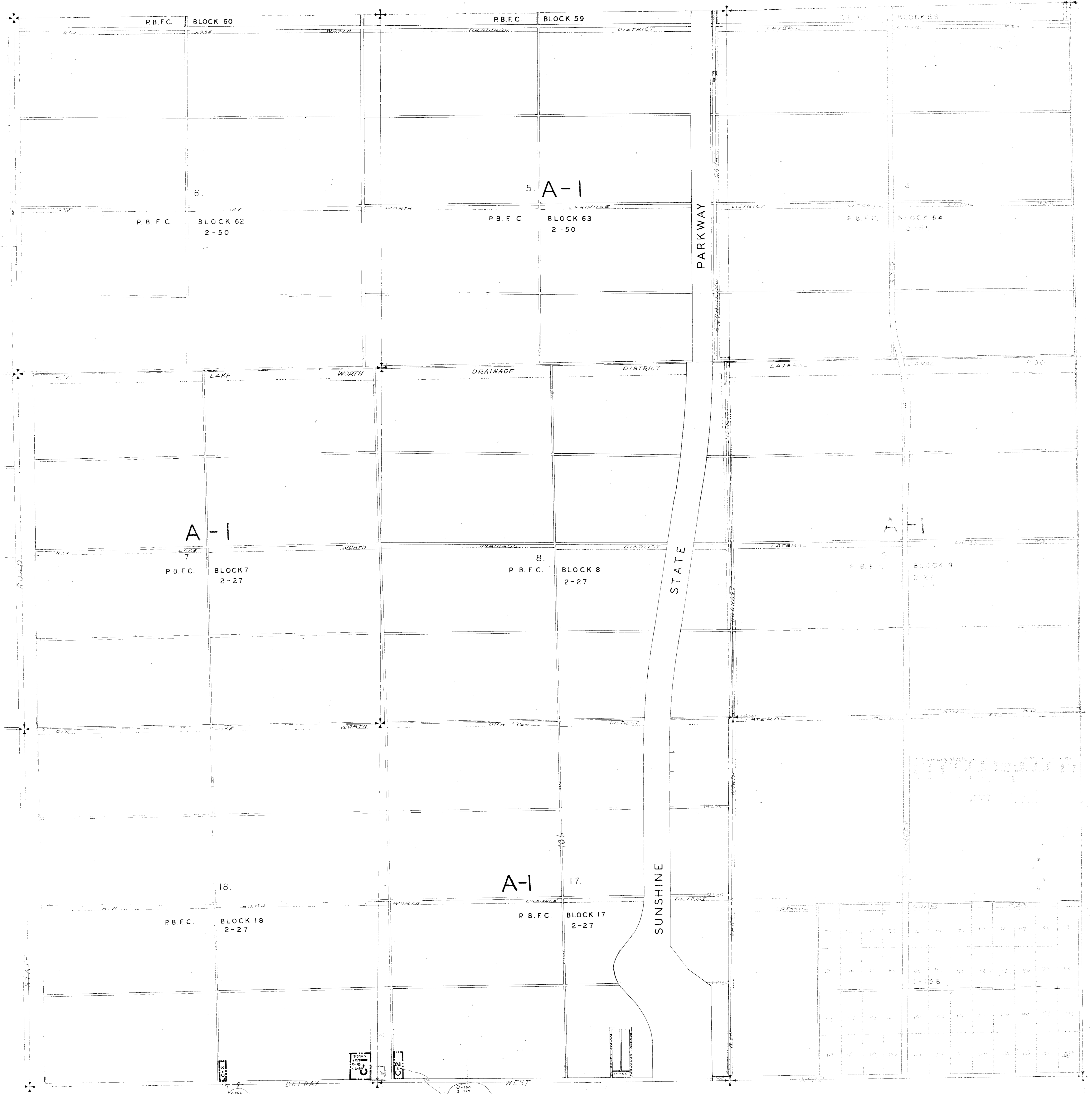

4-150  
 4-152  
 7-13  
 5-16  
 3-1-60

4-150  
 4-152  
 7-13  
 5-16  
 P.B.F.C. #1  
 3-1-60

1/4 800' 3-13-59  
 46-422 C 51  
 NPR  
 DISTRICT BOUNDARIES  
 CORPORATE BOUNDARIES

C-51