

WORTH

LAKE

PORT OF PALM BEACH

SE
R-90-1294
P-90-2
19900807

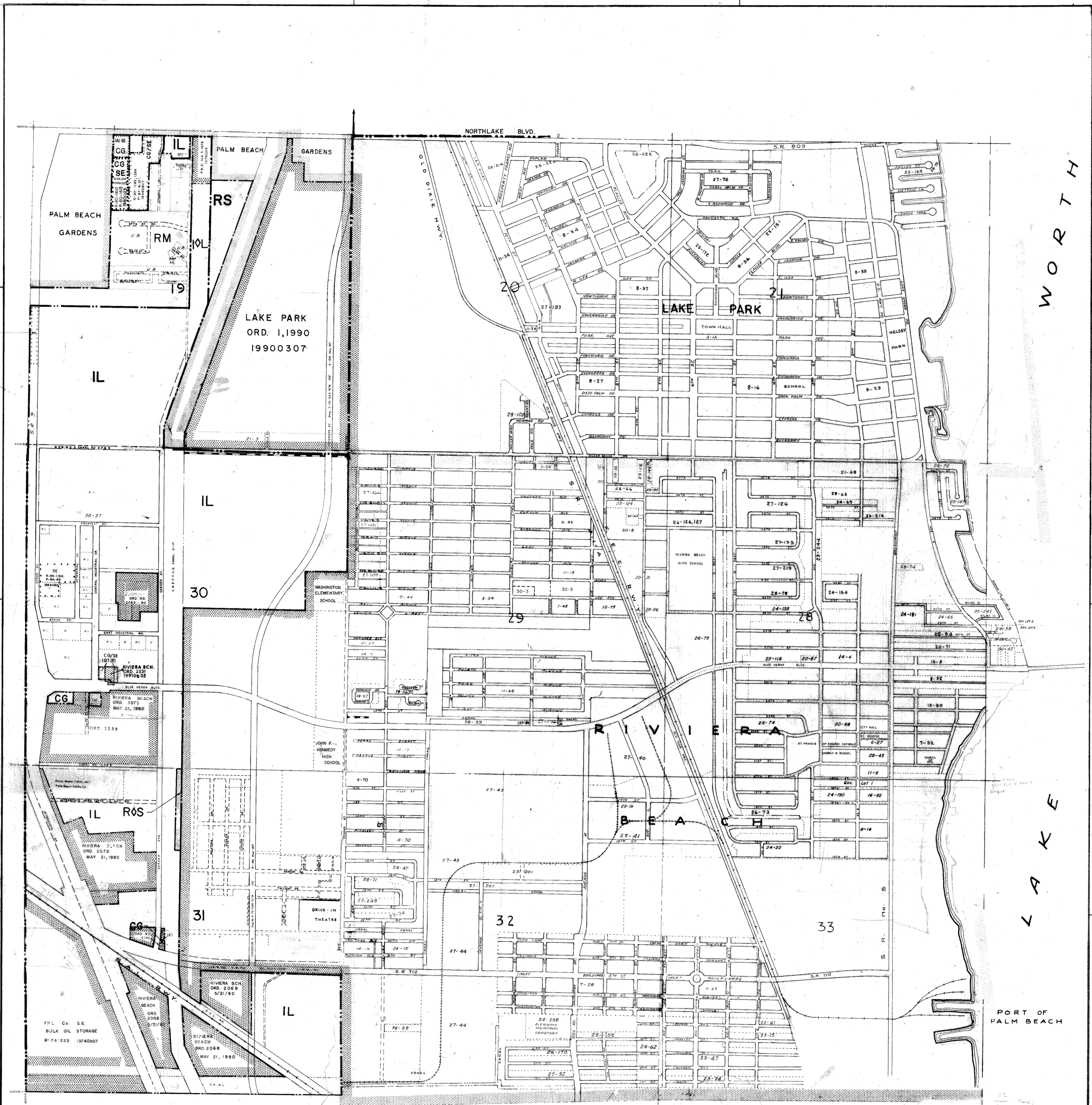

LAKE PARK
ORD. 1,1990
19900307

PALM BEACH
GARDENS

LAKE PARK

RIVIERA BEACH

RESOLUTIONS

01 P-81-104, 06/76	017 02 00 00 00 00	017 02 00 00 00 00
01 P-81-102, 09/07	017 02 00 00 00 00	017 02 00 00 00 00
017 02 00 00 00 00	017 02 00 00 00 00	017 02 00 00 00 00
017 02 00 00 00 00	017 02 00 00 00 00	017 02 00 00 00 00
017 02 00 00 00 00	017 02 00 00 00 00	017 02 00 00 00 00
017 02 00 00 00 00	017 02 00 00 00 00	017 02 00 00 00 00
017 02 00 00 00 00	017 02 00 00 00 00	017 02 00 00 00 00
017 02 00 00 00 00	017 02 00 00 00 00	017 02 00 00 00 00
017 02 00 00 00 00	017 02 00 00 00 00	017 02 00 00 00 00
017 02 00 00 00 00	017 02 00 00 00 00	017 02 00 00 00 00

DISTRICT BOUNDARIES
CORPORATE BOUNDARIES

Zoning Categories indicated on this sheet do not necessarily indicate consistency with Comprehensive Plan Requirements. Please contact the Planning Division at 800 1st Street (407) 637-4001 to confirm Comprehensive Plan Land Use designation.

PALM BEACH COUNTY, FLORIDA
OFFICIAL ZONING DISTRICT MAP

Scale 1" = 600' approx. Date _____

Quadrant 42 43C Sheet No. 14