

City of West Palm Beach

City of West Palm Beach

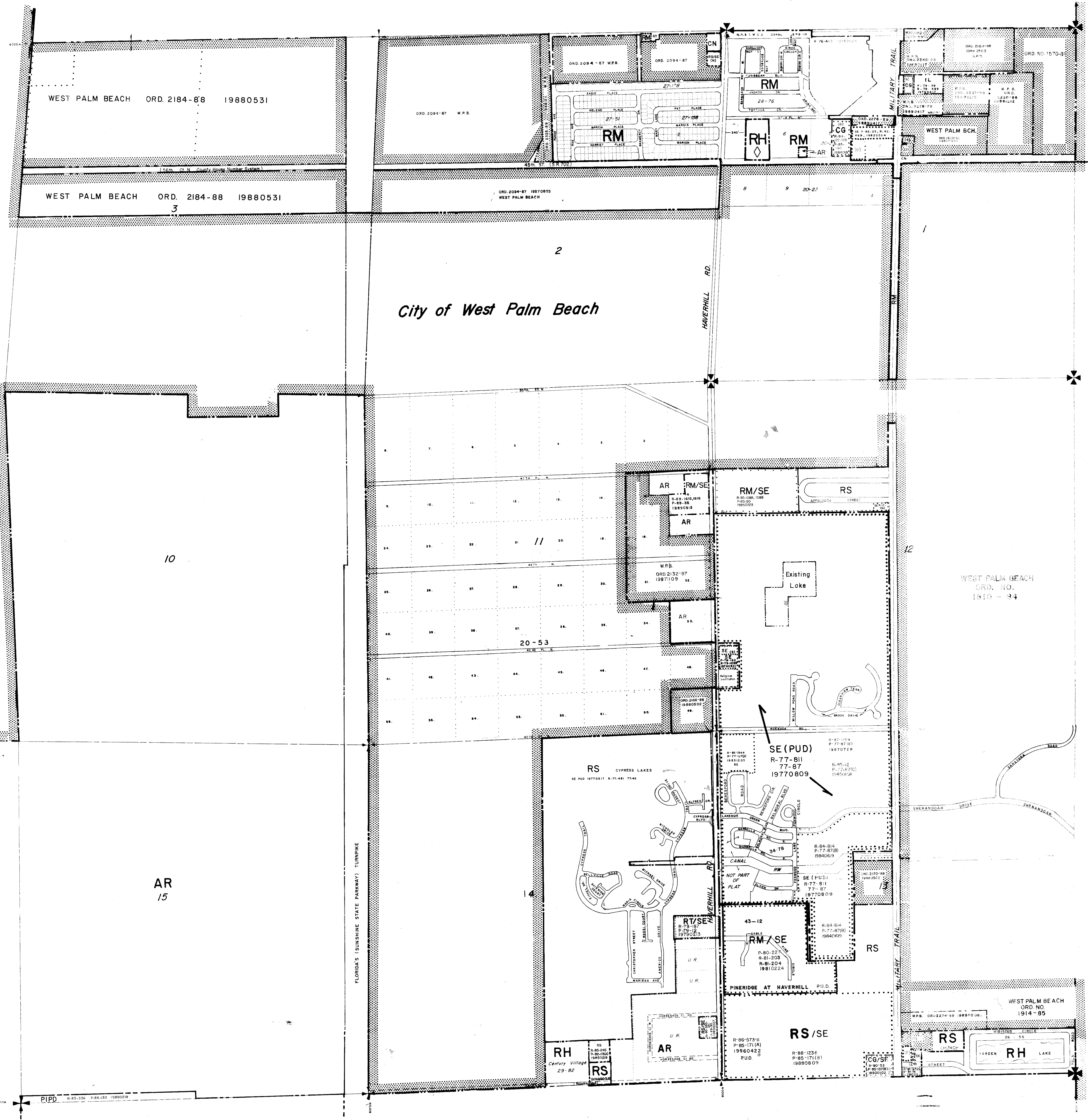

RESOLUTIONS			
14-81-037-1-1-1 (81-81-037-1-1-1) P-83-740 (81-1987020)	81-81-037-200 SE (81-81-037-200 SE) P-83-740 (81-1987020)	15-85-240 (85-240) P-85-101 (85-101) (1985012)	15-85-240 SE (85-240 SE) P-85-101 (85-101) (1985012)
15-85-240 (85-240) P-85-101 (85-101) (1985012)	15-85-240 SE (85-240 SE) P-85-101 (85-101) (1985012)	15-85-240 (85-240) P-85-101 (85-101) (1985012)	15-85-240 SE (85-240 SE) P-85-101 (85-101) (1985012)
15-85-240 (85-240) P-85-101 (85-101) (1985012)	15-85-240 SE (85-240 SE) P-85-101 (85-101) (1985012)	15-85-240 (85-240) P-85-101 (85-101) (1985012)	15-85-240 SE (85-240 SE) P-85-101 (85-101) (1985012)

RESOLUTIONS <u>30</u>			

Zoning Categories indicated on this sheet do not necessarily indicate consistency with Comprehensive Plan Requirements. Please contact the Planning Division at 800 13th Street (407) 897-4001 to confirm Comprehensive Plan Land Use designation.

PALM BEACH COUNTY, FLORIDA
OFFICIAL ZONING DISTRICT MAP
 Scale 1" = 400' approx. Date May 1981
 Quadrant 43-42 A Sheet No. 30

..... PUD BOUNDARIES
 DISTRICT BOUNDARIES
 CORPORATE BOUNDARIES