

14,000

14,000

14,000

14,000

S. R. 706 INDIANTOWN ROAD

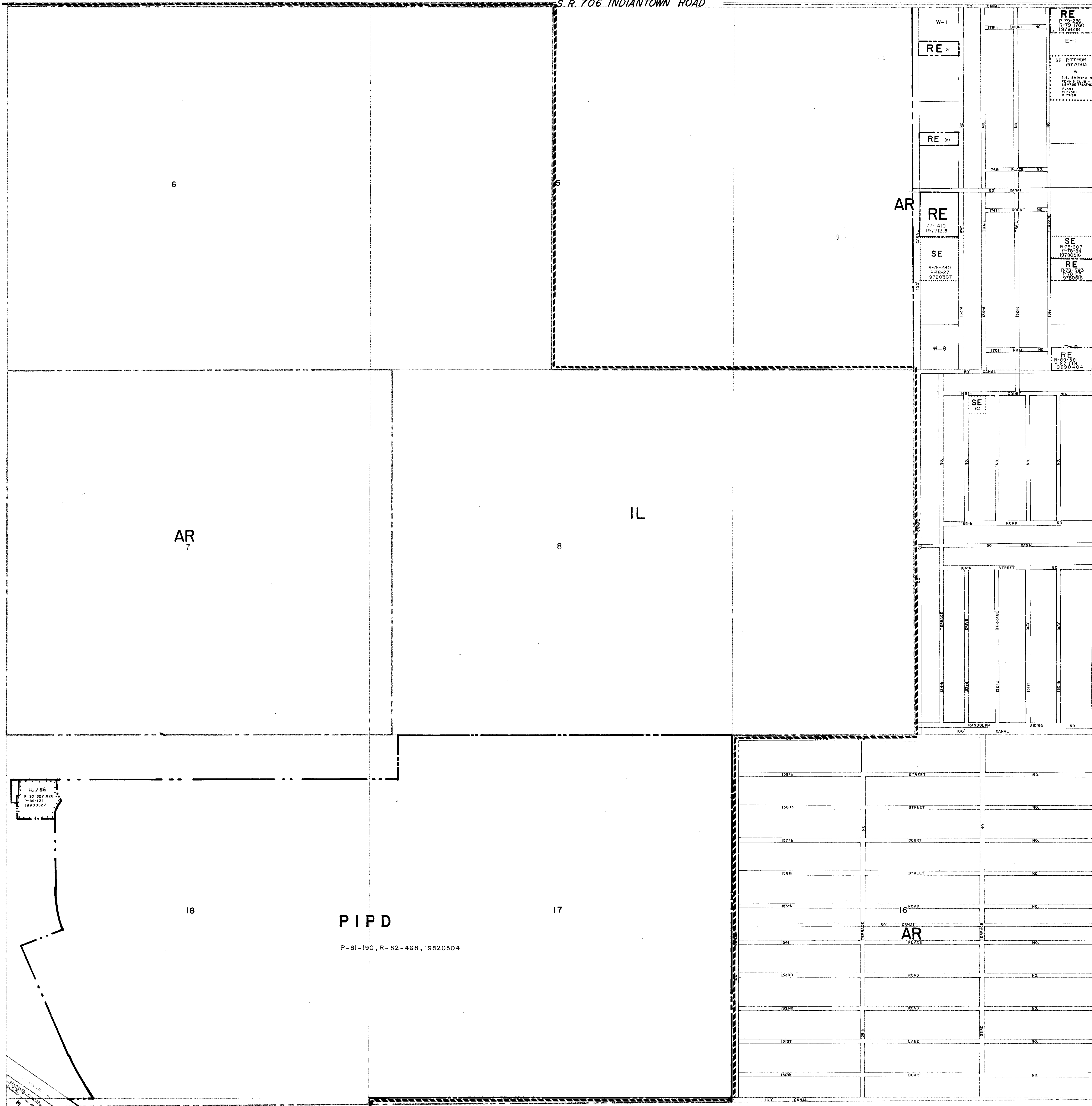

IL/SE
 4-90-82-024
 P-89-121
 1982022

W-1
 RE (1)
 RE (2)
 AR
 RE
 SE
 RE
 W-2
 SE
 RE
 W-3
 SE
 RE
 W-4
 SE
 RE
 W-5
 SE
 RE
 W-6
 SE
 RE
 W-7
 SE
 RE
 W-8
 SE
 RE
 W-9
 SE
 RE
 W-10
 SE
 RE
 W-11
 SE
 RE
 W-12
 SE
 RE
 W-13
 SE
 RE
 W-14
 SE
 RE
 W-15
 SE
 RE
 W-16
 SE
 RE
 W-17
 SE
 RE
 W-18
 SE
 RE
 W-19
 SE
 RE
 W-20
 SE
 RE
 W-21
 SE
 RE
 W-22
 SE
 RE
 W-23
 SE
 RE
 W-24
 SE
 RE
 W-25
 SE
 RE
 W-26
 SE
 RE
 W-27
 SE
 RE
 W-28
 SE
 RE
 W-29
 SE
 RE
 W-30
 SE
 RE
 W-31
 SE
 RE
 W-32
 SE
 RE
 W-33
 SE
 RE
 W-34
 SE
 RE
 W-35
 SE
 RE
 W-36
 SE
 RE
 W-37
 SE
 RE
 W-38
 SE
 RE
 W-39
 SE
 RE
 W-40
 SE
 RE
 W-41
 SE
 RE
 W-42
 SE
 RE
 W-43
 SE
 RE
 W-44
 SE
 RE
 W-45
 SE
 RE
 W-46
 SE
 RE
 W-47
 SE
 RE
 W-48
 SE
 RE
 W-49
 SE
 RE
 W-50
 SE
 RE
 W-51
 SE
 RE
 W-52
 SE
 RE
 W-53
 SE
 RE
 W-54
 SE
 RE
 W-55
 SE
 RE
 W-56
 SE
 RE
 W-57
 SE
 RE
 W-58
 SE
 RE
 W-59
 SE
 RE
 W-60
 SE
 RE
 W-61
 SE
 RE
 W-62
 SE
 RE
 W-63
 SE
 RE
 W-64
 SE
 RE
 W-65
 SE
 RE
 W-66
 SE
 RE
 W-67
 SE
 RE
 W-68
 SE
 RE
 W-69
 SE
 RE
 W-70
 SE
 RE
 W-71
 SE
 RE
 W-72
 SE
 RE
 W-73
 SE
 RE
 W-74
 SE
 RE
 W-75
 SE
 RE
 W-76
 SE
 RE
 W-77
 SE
 RE
 W-78
 SE
 RE
 W-79
 SE
 RE
 W-80
 SE
 RE
 W-81
 SE
 RE
 W-82
 SE
 RE
 W-83
 SE
 RE
 W-84
 SE
 RE
 W-85
 SE
 RE
 W-86
 SE
 RE
 W-87
 SE
 RE
 W-88
 SE
 RE
 W-89
 SE
 RE
 W-90
 SE
 RE
 W-91
 SE
 RE
 W-92
 SE
 RE
 W-93
 SE
 RE
 W-94
 SE
 RE
 W-95
 SE
 RE
 W-96
 SE
 RE
 W-97
 SE
 RE
 W-98
 SE
 RE
 W-99
 SE
 RE
 W-100
 SE
 RE

AR 7

IL 8

18

PIP D

P-81-190, R-82-468, 19820504

17

AR 16

AR 17

AR

RESOLUTIONS	
01-87-210	
01-87-211	
01-87-212	
01-87-213	
01-87-214	
01-87-215	
01-87-216	
01-87-217	
01-87-218	
01-87-219	
01-87-220	
01-87-221	
01-87-222	
01-87-223	
01-87-224	
01-87-225	
01-87-226	
01-87-227	
01-87-228	
01-87-229	
01-87-230	

RT-0
 DISTRICT BOUNDARIES
 CORPORATE BOUNDARIES

B	A
C	D

Zoning Categories indicated on this sheet do not necessarily indicate consistency with Comprehensive Plan Requirements. Please contact the Planning Division at 600 13th Street (407) 697-4801 to confirm Comprehensive Plan Land Use designation.

PALM BEACH COUNTY, FLORIDA
OFFICIAL ZONING DISTRICT MAP

Scale 1" = 600' approx. Date 4-1-73
 Quadrant 41-41 B Sheet No. 71