

LAKE  
OKEECHOBEE

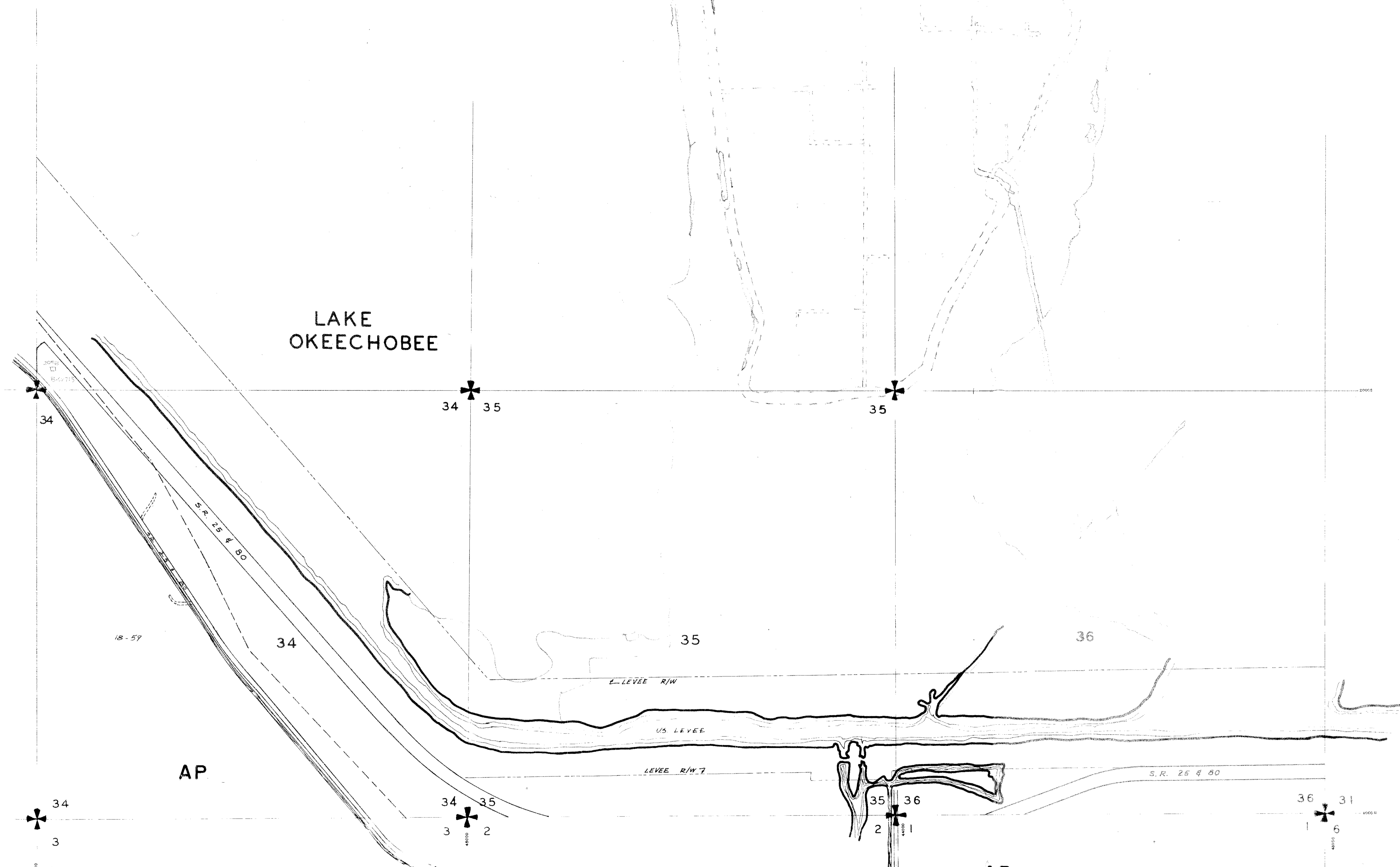

RESOLUTIONS			

--- DISTRICT BOUNDARIES  
 [Hatched Box] CORPORATE BOUNDARIES

Zoning Categories indicated on this sheet do not necessarily indicate consistency with Comprehensive Plan Requirements. Please contact the Planning Division at 800 13th Street (407) 697-4001 to confirm Comprehensive Plan Land Use designation.

**PALM BEACH COUNTY, FLORIDA**  
**OFFICIAL ZONING DISTRICT MAP**  
 Scale 1" = 600' approx. Date 4-1-73  
 Quadrant 43 35D Sheet No 251