

VILLAGE OF WELLINGTON *

RE/SE

6

PB43P82

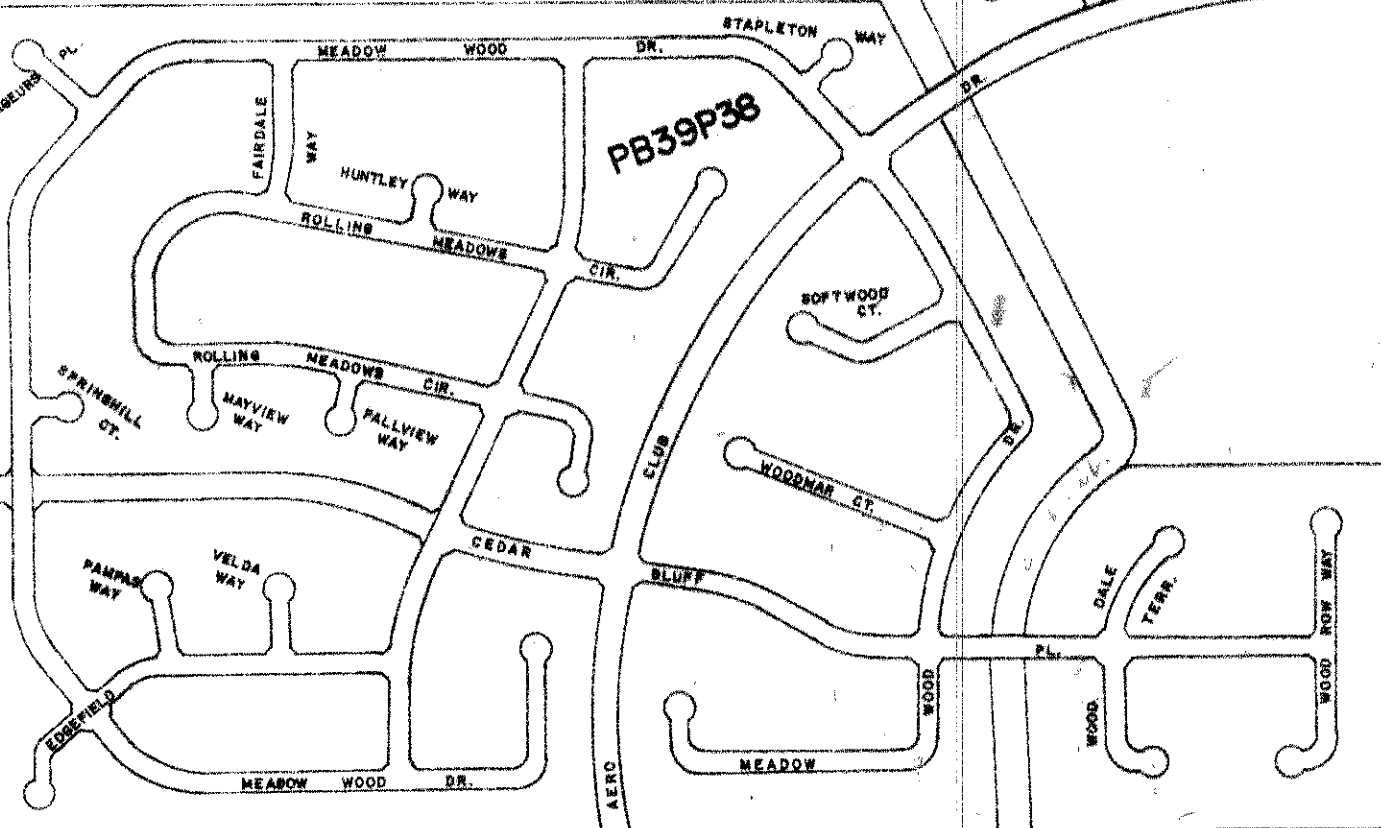
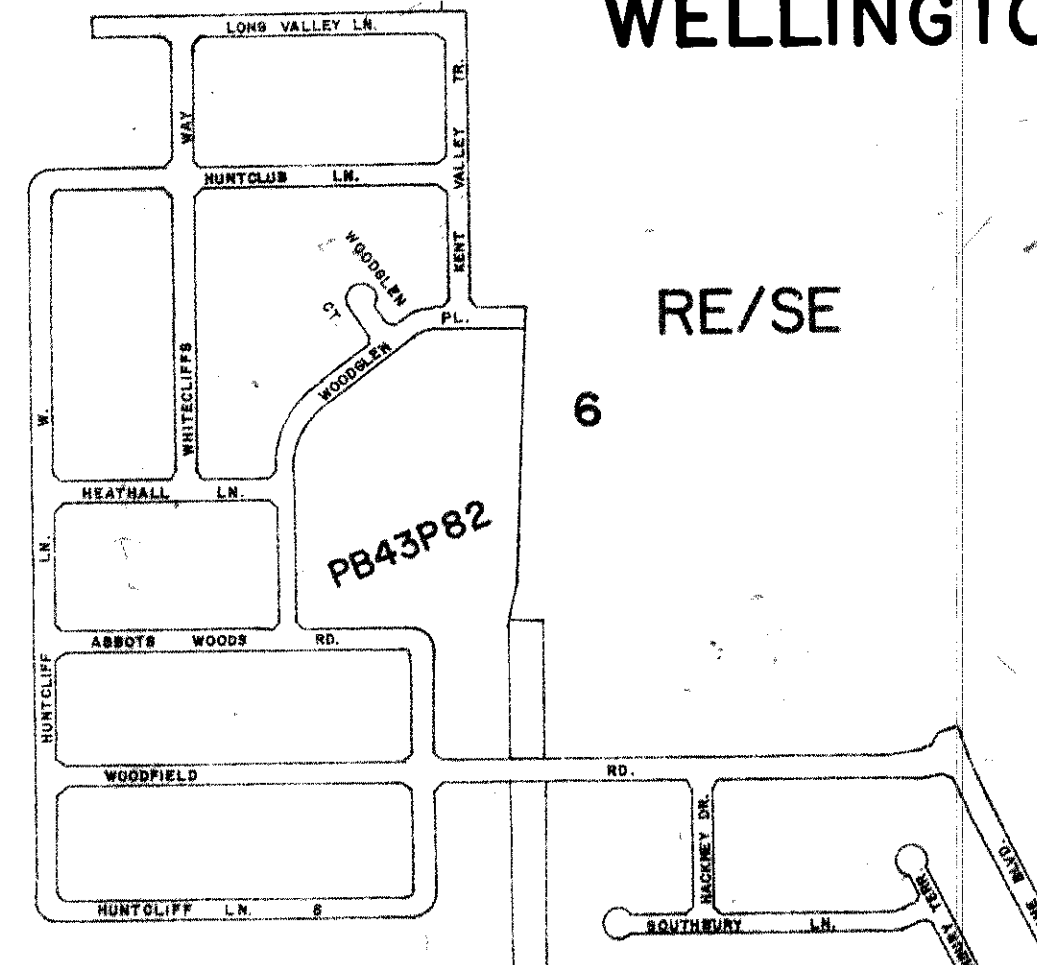

7
RE/SE

R-79-95
P-78-287
19790123

R-86-309
P-78-287(A)
19800219
R-86-073-1
P-78-287(C)
19860422
SE
R-89-2172
P-86-327(E)
19891205

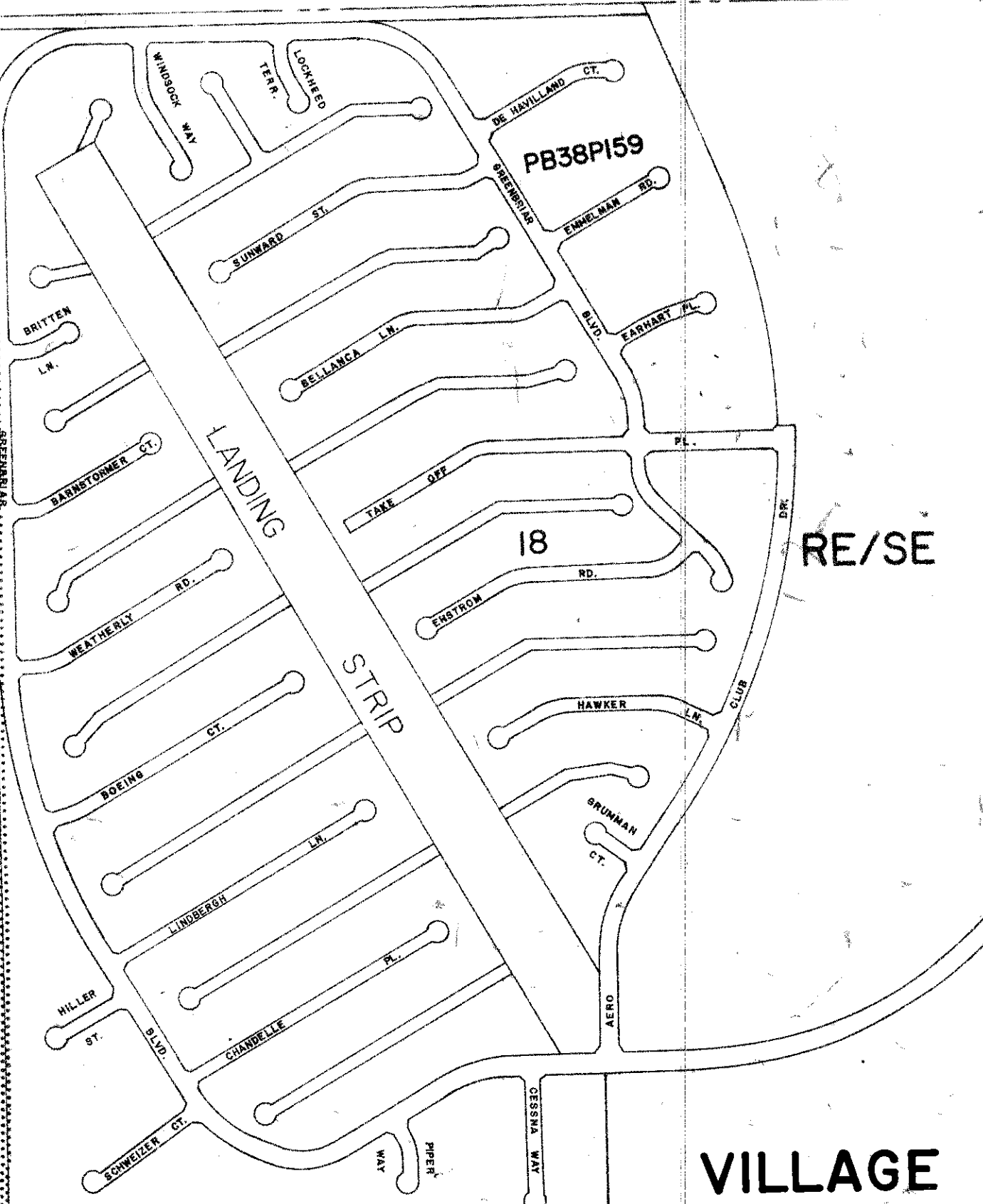

VILLAGE OF WELLINGTON *

RE/SE

18

PB38P159



8

PB41P99

SE
R-89-336
P-86-32(I)
19900316

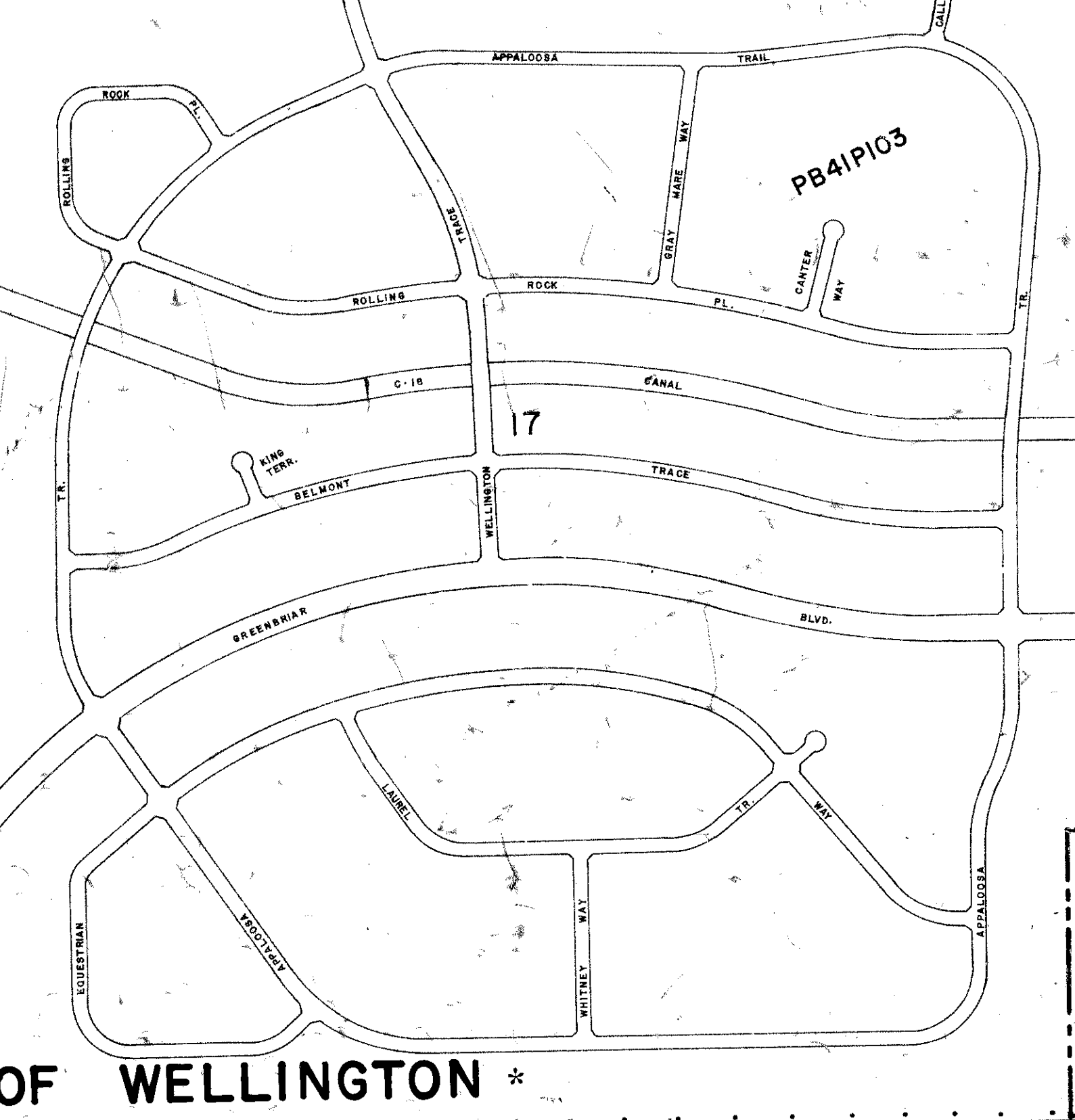

17

PB41P103

SE
R-89-443
P-86-32(D)
19890314

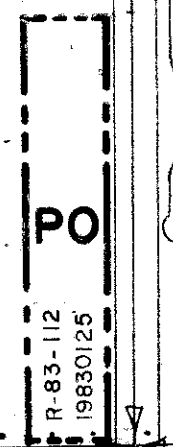

PO
R-83-112
P-86-32(J)
19890105

SE
R-89-216
P-86-32(M)
19891212

RESOLUTIONS	
R-89-216	
P-86-32(F) SE	
19890308	

* The Palm Beach County Unified Land Development Code's zoning categories apply to properties within the corporate boundaries of the Village of Wellington under an Interlocal Agreement between Palm Beach County and the Village of Wellington.

Zoning Categories indicated on this sheet do not necessarily indicate consistency with Comprehensive Plan Requirements. Please contact the Planning Division at 800 13th Street (407) 897-4001 to confirm Comprehensive Plan Land Use designation.

PALM BEACH COUNTY, FLORIDA
OFFICIAL ZONING DISTRICT MAP

Scale 1" = 600' approx. Date _____
Quadrant 777 Sheet No. _____