

S. R. 706 INDIANTOWN ROAD

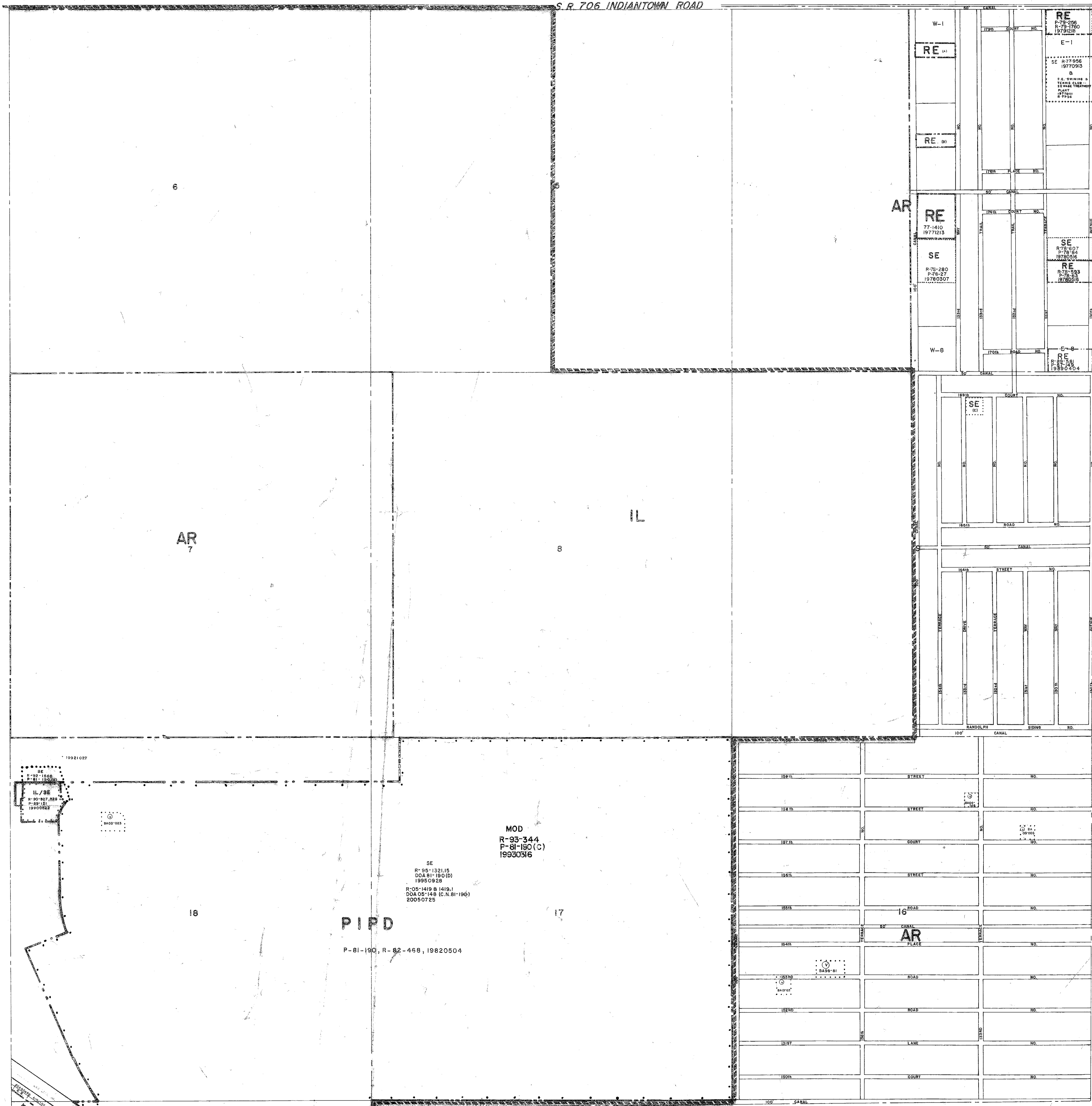

17021027
 IL/SE
 R-90-127, 128
 P-81-190
 19900512

MOD
 R-93-344
 P-81-150(C)
 19930316

SE
 R-93-132115
 D-81-190(D)
 19950928

R-05-1419 B (1991)
 D-05-1418 (C.N. 81-190)
 20050725

PIPD
 P-81-190, R-82-468, 19820504

RESOLUTIONS	
BY	
DATE	
BY	
DATE	
BY	
DATE	

RT-0
 DISTRICT BOUNDARIES
 CORPORATE BOUNDARIES

B	A
C	D

The zoning category for the property indicated on this sheet may not be consistent with the property's Future Land Use designation under the Palm Beach County Comprehensive Plan. Please contact the Palm Beach County Planning Division at 100 Australian Avenue, West Palm Beach, FL 33406, (561) 233-5500, to confirm the property's Future Land Use designation and other relevant Comprehensive Plan requirements.

PALM BEACH COUNTY, FLORIDA
OFFICIAL ZONING DISTRICT MAP

Scale 1" = 600' approx. Date 4-1-73
 Quadrant 41-41 B Sheet No. 71