

APN	Area	Zone	APN	Area	Zone	APN	Area	Zone
12345	12345	12345	12345	12345	12345	12345	12345	12345
12346	12346	12346	12346	12346	12346	12346	12346	12346
12347	12347	12347	12347	12347	12347	12347	12347	12347
12348	12348	12348	12348	12348	12348	12348	12348	12348
12349	12349	12349	12349	12349	12349	12349	12349	12349
12350	12350	12350	12350	12350	12350	12350	12350	12350
12351	12351	12351	12351	12351	12351	12351	12351	12351
12352	12352	12352	12352	12352	12352	12352	12352	12352
12353	12353	12353	12353	12353	12353	12353	12353	12353
12354	12354	12354	12354	12354	12354	12354	12354	12354
12355	12355	12355	12355	12355	12355	12355	12355	12355
12356	12356	12356	12356	12356	12356	12356	12356	12356
12357	12357	12357	12357	12357	12357	12357	12357	12357
12358	12358	12358	12358	12358	12358	12358	12358	12358
12359	12359	12359	12359	12359	12359	12359	12359	12359
12360	12360	12360	12360	12360	12360	12360	12360	12360

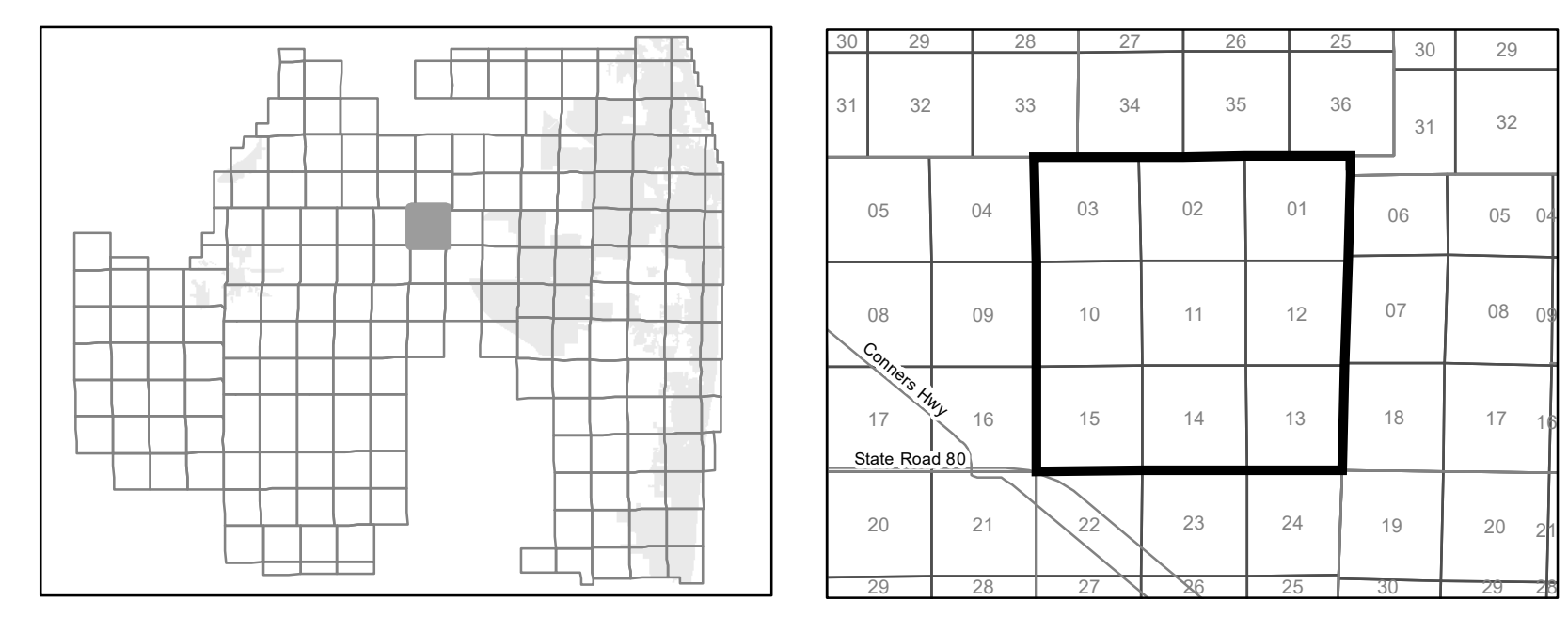
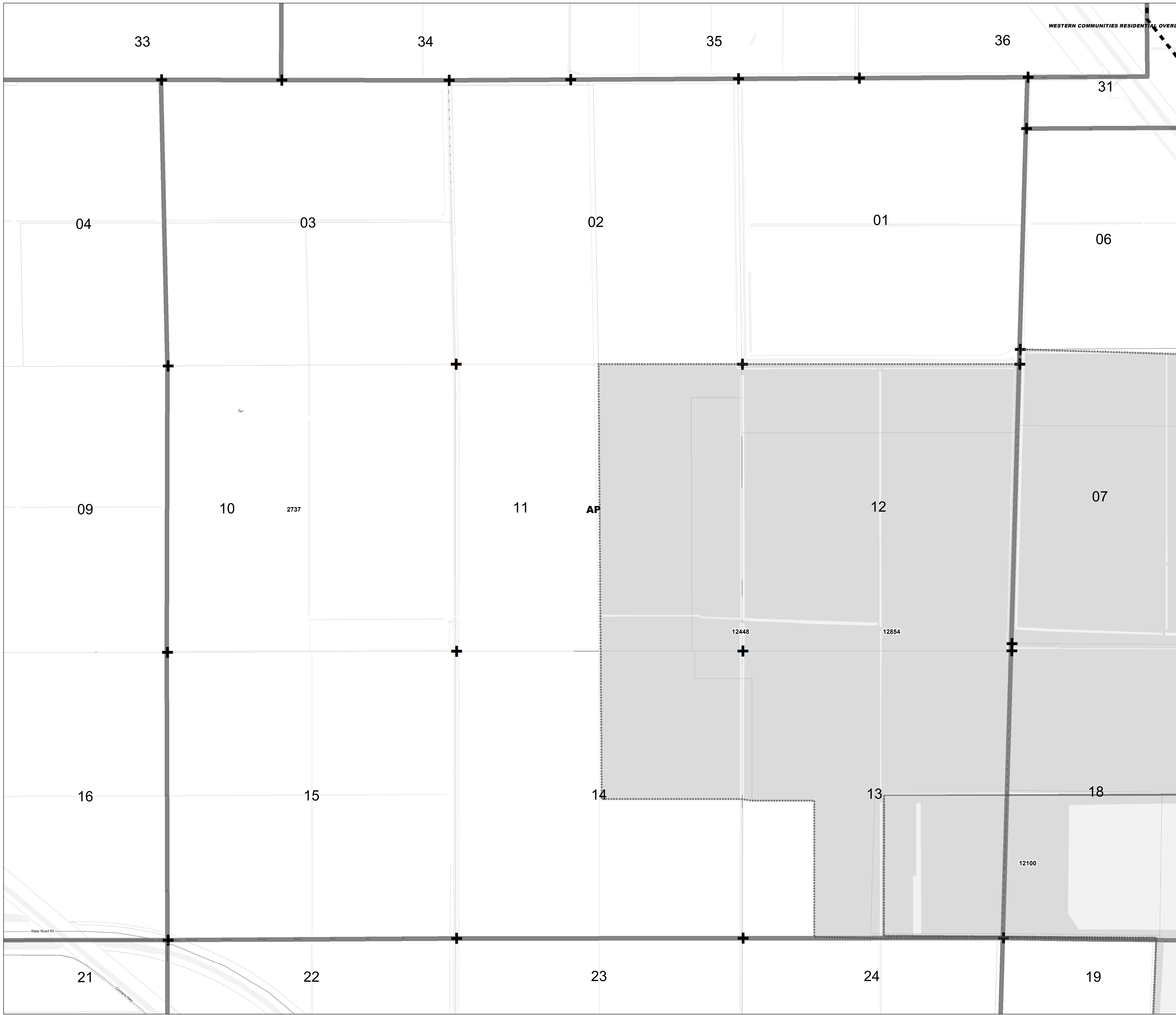

ZONING QUAD 122

Zoning District Map of Palm Beach County
December 08, 2017

12345	Additional Approvals		Overlays		Water
	Zoning Quad Boundary		Parcels		Section Lines
	Zoning District Boundary		Municipality		
	Corresponding PDD (CPDD) - Pursuant to Article 3.A.2.D of the ULDC (amended under Ordinance 2012-003) The Zoning Director has the authority to update the Official Zoning Map administratively to delineate a Planned Development District that corresponds to those prior approvals that are specified in Art.3.A.3.E.2, Planned Development Districts.				

PALM BEACH COUNTY
 Planning, Zoning and Building Department