

PROJECT NO.	APPROVAL	SECTION	DATE	REVISION
12345	AP	01	12/09/13	1
12345	AP	02	12/09/13	1
12345	AP	03	12/09/13	1
12345	AP	04	12/09/13	1
12345	AP	05	12/09/13	1
12345	AP	06	12/09/13	1
12345	AP	07	12/09/13	1
12345	AP	08	12/09/13	1
12345	AP	09	12/09/13	1
12345	AP	10	12/09/13	1
12345	AP	11	12/09/13	1
12345	AP	12	12/09/13	1
12345	AP	13	12/09/13	1
12345	AP	14	12/09/13	1
12345	AP	15	12/09/13	1
12345	AP	16	12/09/13	1
12345	AP	17	12/09/13	1
12345	AP	18	12/09/13	1
12345	AP	19	12/09/13	1
12345	AP	20	12/09/13	1
12345	AP	21	12/09/13	1
12345	AP	22	12/09/13	1
12345	AP	23	12/09/13	1
12345	AP	24	12/09/13	1
12345	AP	25	12/09/13	1
12345	AP	26	12/09/13	1
12345	AP	27	12/09/13	1
12345	AP	28	12/09/13	1
12345	AP	29	12/09/13	1
12345	AP	30	12/09/13	1
12345	AP	31	12/09/13	1
12345	AP	32	12/09/13	1
12345	AP	33	12/09/13	1
12345	AP	34	12/09/13	1
12345	AP	35	12/09/13	1
12345	AP	36	12/09/13	1

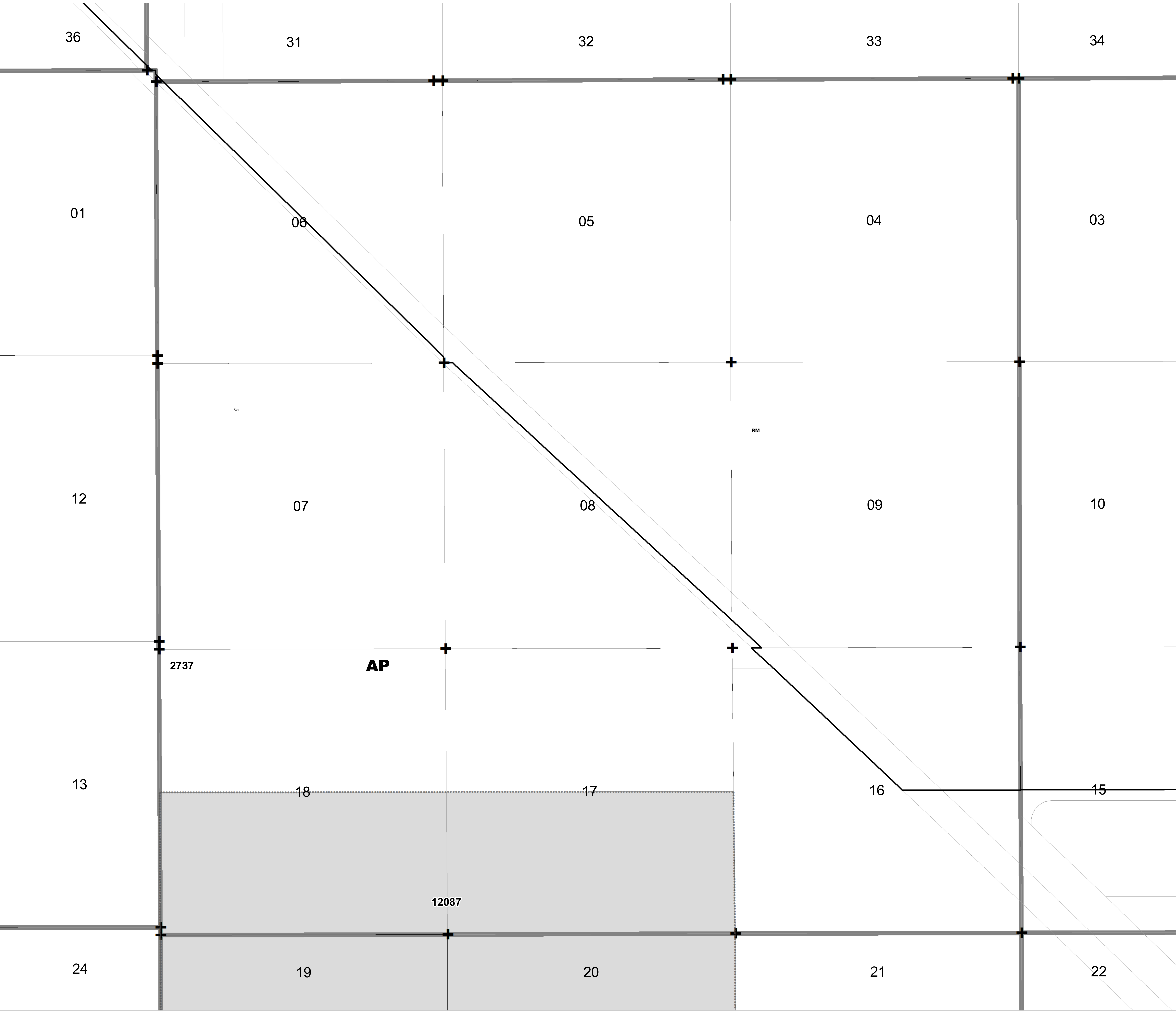

35	36	31	32	33	34	35
02	01	06	05	04	03	02
11	12	07	08	09	10	11
14	13	18	17	16	15	14
23	24	19	20	21	22	23
26	25	30	29	28	27	26

ZONING QUAD 134
 Zoning District Map of Palm Beach County
 December 09, 2013

12345	Additional Approvals		Overlays		Water
	Zoning Quad Boundary		Parcels		Section Lines
	Zoning District Boundary		Municipality		1 inch = 600 feet
	Corresponding PDD (CPDD) - Pursuant to Article 3.A.2.D of the ULDC (amended under Ordinance 2012-003) The Zoning Director has the authority to update the Official Zoning Map administratively to delineate a Planned Development District that corresponds to those prior approvals that are specified in Art.3.A.3.E.2, Planned Development Districts.	 PALM BEACH COUNTY Planning, Zoning and Building Department			