

APPROVAL	DATE	BY	FOR

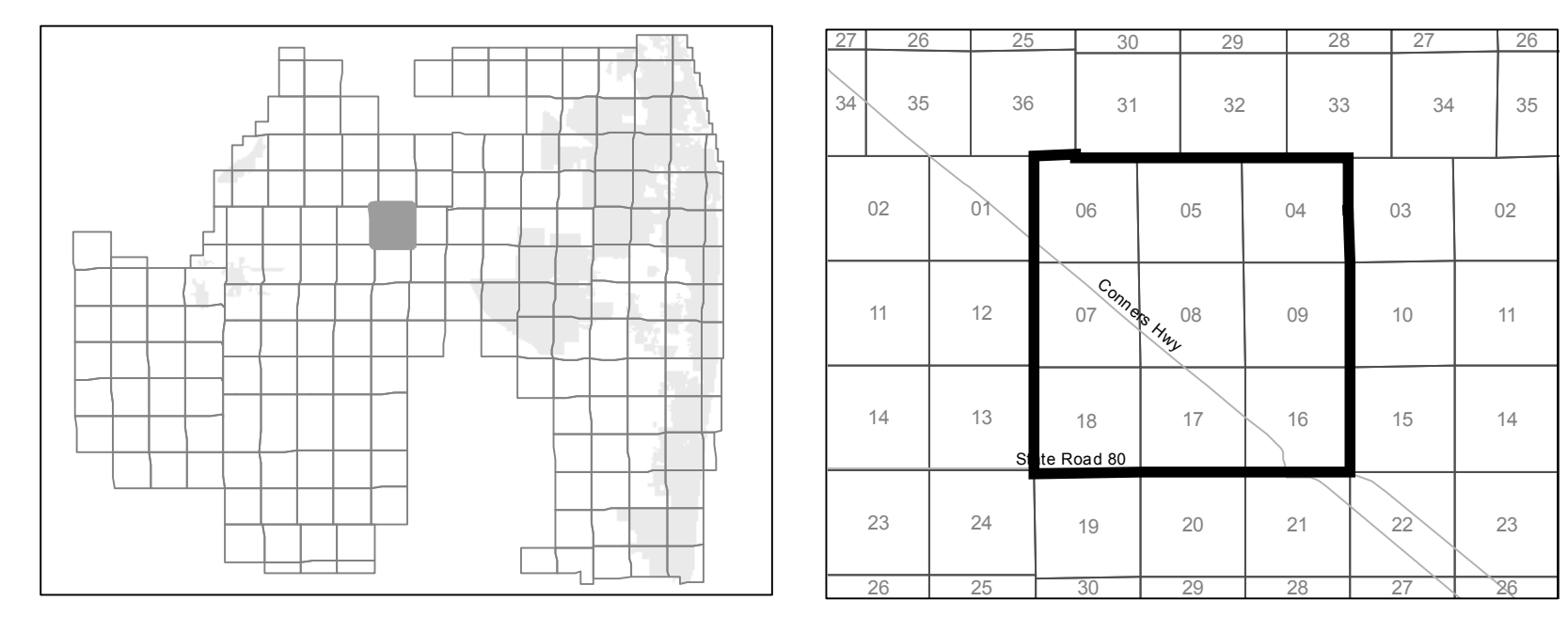
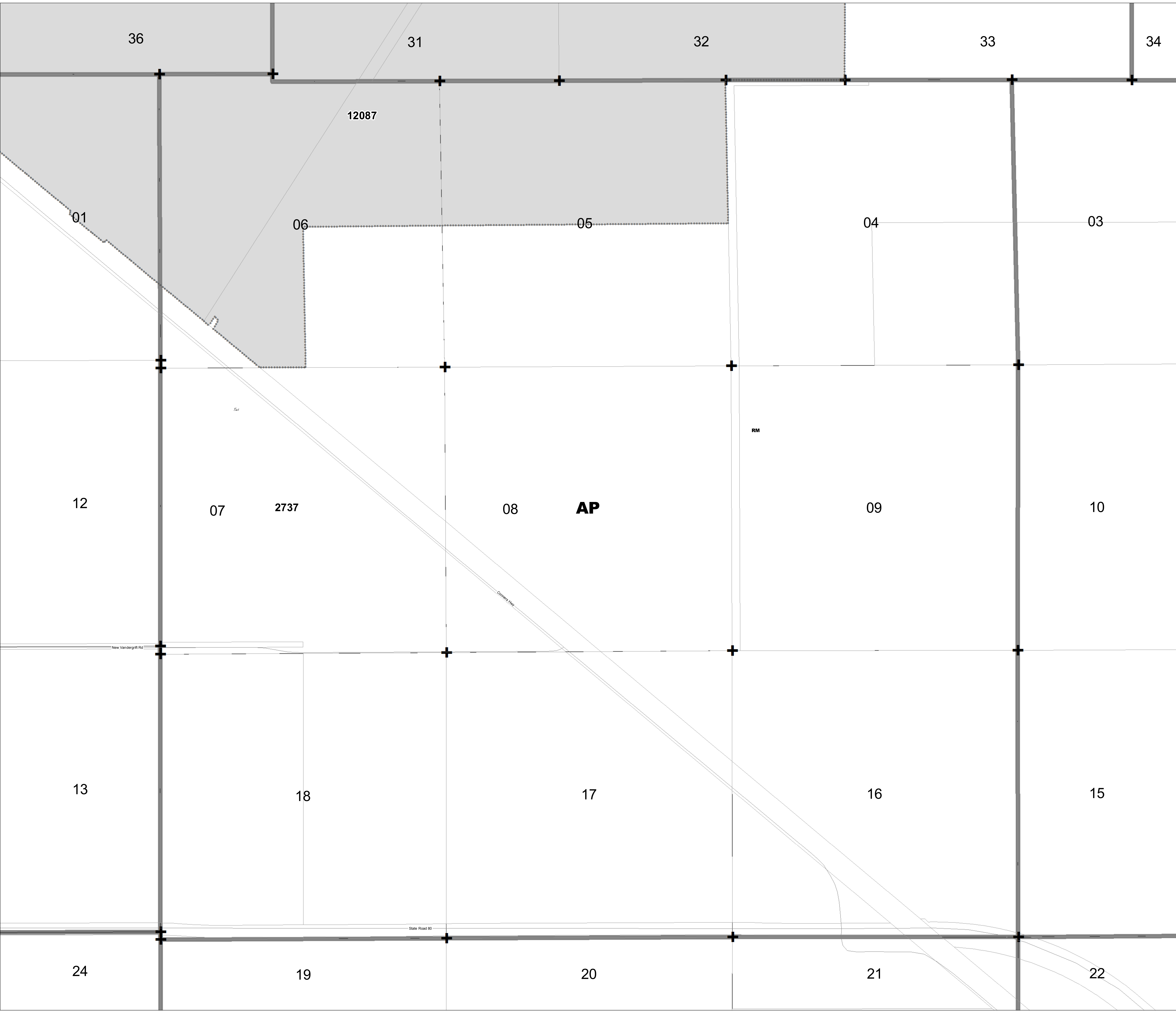

ZONING QUAD 136
 Zoning District Map of Palm Beach County
 December 09, 2013

12345	Additional Approvals		Overlays		Water
	Zoning Quad Boundary		Parcels		Section Lines
	Zoning District Boundary		Municipality		1 inch = 600 feet 0 600 1,200 Feet
	Corresponding PDD (CPDD) - Pursuant to Article 3.A.2.D of the ULDC (amended under Ordinance 2012-003) The Zoning Director has the authority to update the Official Zoning Map administratively to delineate a Planned Development District that corresponds to those prior approvals that are specified in Art.3.A.3.E.2, Planned Development Districts.				

PALM BEACH COUNTY
 Planning, Zoning and Building Department