

DATE: 04/07/2017 11:00 AM
 DRAWN BY: J. B. BROWN
 CHECKED BY: J. B. BROWN
 PROJECT: ZONING QUAD 155
 SHEET: 155-01

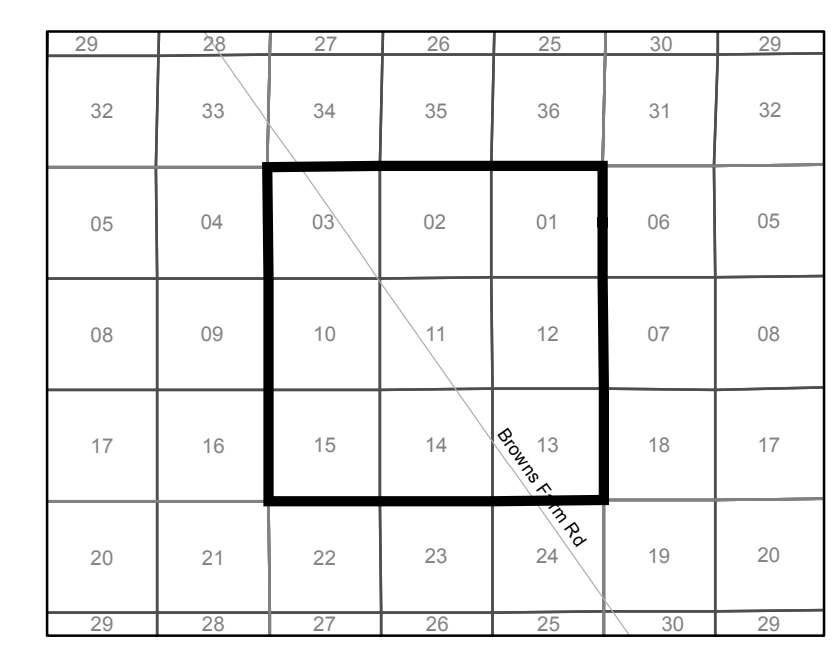
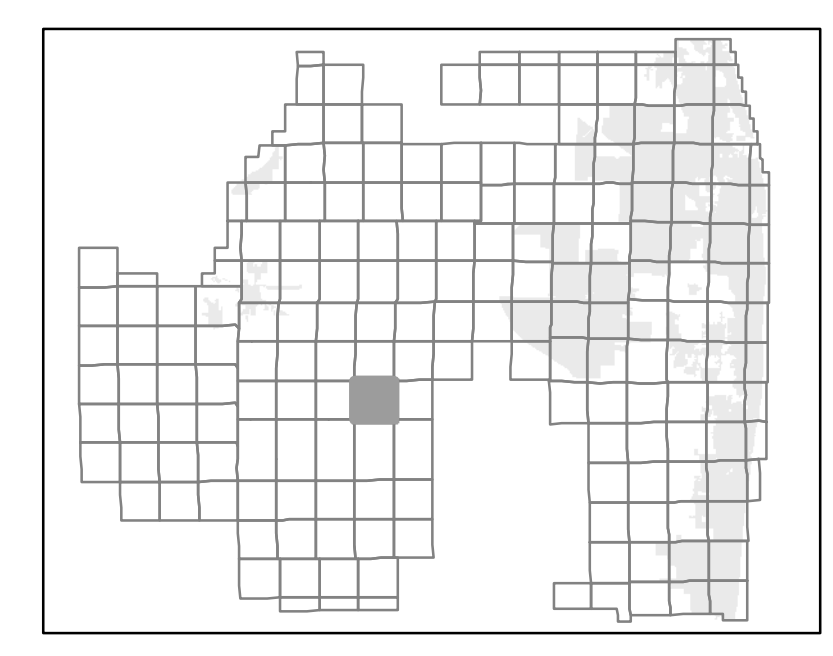
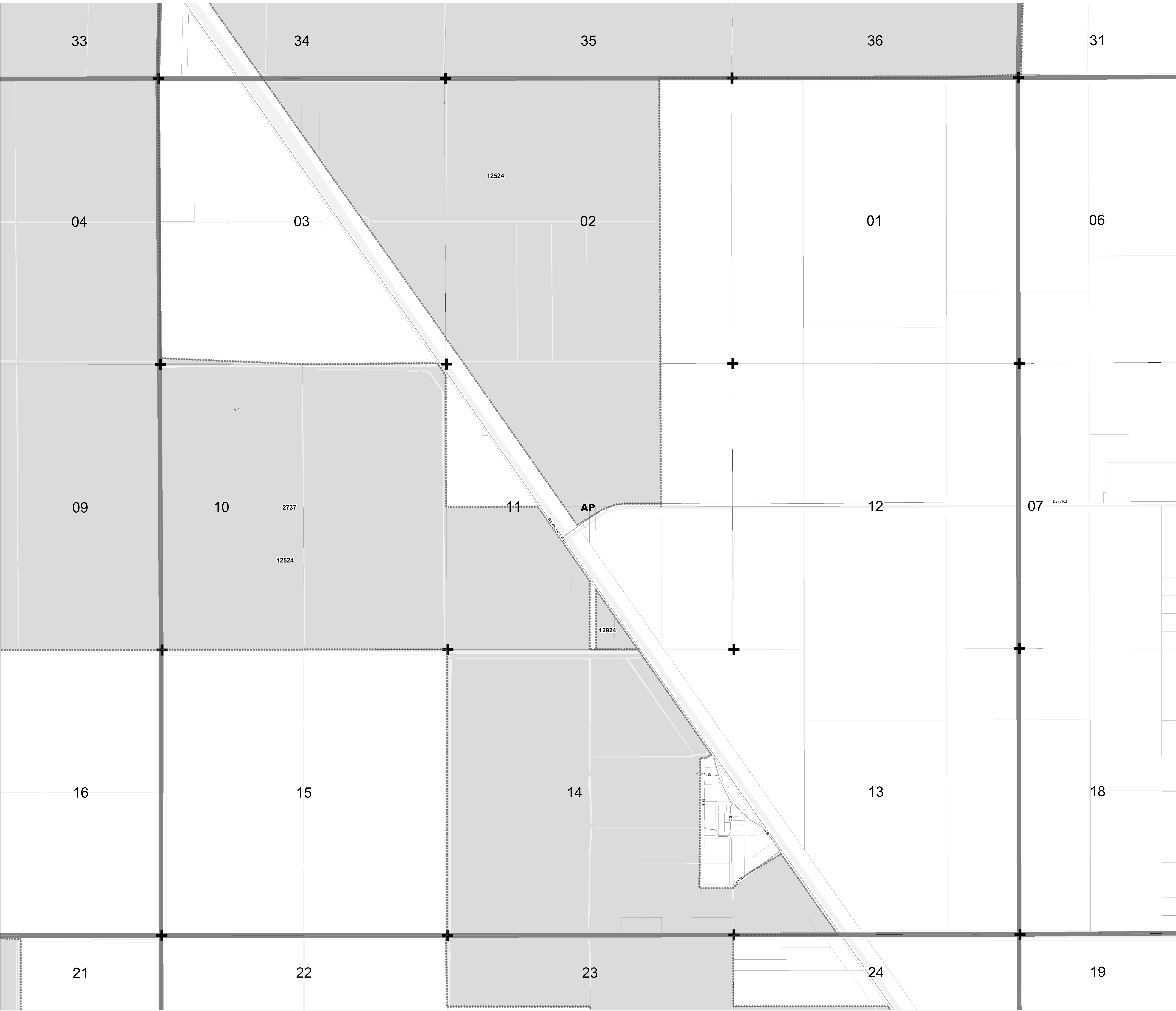

ZONING QUAD 155

Zoning District Map of Palm Beach County
 April 07, 2017

- 12345 Additional Approvals
- Zoning Quad Boundary
- Zoning District Boundary
- Corresponding PDD (CPDD) - Pursuant to Article 3.A.2.D of the ULDC (amended under Ordinance 2012-003) The Zoning Director has the authority to update the Official Zoning Map administratively to delineate a Planned Development District that corresponds to those prior approvals that are specified in Art.3.A.3.E.2, Planned Development Districts.
- Overlays
- Parcels
- Municipality
- Water
- Section Lines

