

AGENT NO.	PLANNING APPROVAL	DEVELOPMENT RESOLUTION	DATE	DECISION	STATUS
1207	CA	2006-0008	NA	11-08-06	APPROVED
1208	CA	2006-0009	NA	11-08-06	APPROVED
1209	CA	2006-0010	NA	11-08-06	APPROVED
1210	CA	2006-0011	NA	11-08-06	APPROVED
1211	CA	2006-0012	NA	11-08-06	APPROVED
1212	CA	2006-0013	NA	11-08-06	APPROVED
1213	CA	2006-0014	NA	11-08-06	APPROVED
1214	CA	2006-0015	NA	11-08-06	APPROVED
1215	CA	2006-0016	NA	11-08-06	APPROVED
1216	CA	2006-0017	NA	11-08-06	APPROVED
1217	CA	2006-0018	NA	11-08-06	APPROVED
1218	CA	2006-0019	NA	11-08-06	APPROVED
1219	CA	2006-0020	NA	11-08-06	APPROVED
1220	CA	2006-0021	NA	11-08-06	APPROVED
1221	CA	2006-0022	NA	11-08-06	APPROVED
1222	CA	2006-0023	NA	11-08-06	APPROVED
1223	CA	2006-0024	NA	11-08-06	APPROVED
1224	CA	2006-0025	NA	11-08-06	APPROVED
1225	CA	2006-0026	NA	11-08-06	APPROVED
1226	CA	2006-0027	NA	11-08-06	APPROVED
1227	CA	2006-0028	NA	11-08-06	APPROVED
1228	CA	2006-0029	NA	11-08-06	APPROVED
1229	CA	2006-0030	NA	11-08-06	APPROVED
1230	CA	2006-0031	NA	11-08-06	APPROVED
1231	CA	2006-0032	NA	11-08-06	APPROVED
1232	CA	2006-0033	NA	11-08-06	APPROVED
1233	CA	2006-0034	NA	11-08-06	APPROVED
1234	CA	2006-0035	NA	11-08-06	APPROVED
1235	CA	2006-0036	NA	11-08-06	APPROVED
1236	CA	2006-0037	NA	11-08-06	APPROVED
1237	CA	2006-0038	NA	11-08-06	APPROVED
1238	CA	2006-0039	NA	11-08-06	APPROVED
1239	CA	2006-0040	NA	11-08-06	APPROVED
1240	CA	2006-0041	NA	11-08-06	APPROVED
1241	CA	2006-0042	NA	11-08-06	APPROVED
1242	CA	2006-0043	NA	11-08-06	APPROVED
1243	CA	2006-0044	NA	11-08-06	APPROVED
1244	CA	2006-0045	NA	11-08-06	APPROVED
1245	CA	2006-0046	NA	11-08-06	APPROVED
1246	CA	2006-0047	NA	11-08-06	APPROVED
1247	CA	2006-0048	NA	11-08-06	APPROVED
1248	CA	2006-0049	NA	11-08-06	APPROVED
1249	CA	2006-0050	NA	11-08-06	APPROVED
1250	CA	2006-0051	NA	11-08-06	APPROVED
1251	CA	2006-0052	NA	11-08-06	APPROVED
1252	CA	2006-0053	NA	11-08-06	APPROVED
1253	CA	2006-0054	NA	11-08-06	APPROVED
1254	CA	2006-0055	NA	11-08-06	APPROVED
1255	CA	2006-0056	NA	11-08-06	APPROVED
1256	CA	2006-0057	NA	11-08-06	APPROVED
1257	CA	2006-0058	NA	11-08-06	APPROVED
1258	CA	2006-0059	NA	11-08-06	APPROVED
1259	CA	2006-0060	NA	11-08-06	APPROVED
1260	CA	2006-0061	NA	11-08-06	APPROVED
1261	CA	2006-0062	NA	11-08-06	APPROVED
1262	CA	2006-0063	NA	11-08-06	APPROVED
1263	CA	2006-0064	NA	11-08-06	APPROVED
1264	CA	2006-0065	NA	11-08-06	APPROVED
1265	CA	2006-0066	NA	11-08-06	APPROVED
1266	CA	2006-0067	NA	11-08-06	APPROVED
1267	CA	2006-0068	NA	11-08-06	APPROVED
1268	CA	2006-0069	NA	11-08-06	APPROVED
1269	CA	2006-0070	NA	11-08-06	APPROVED
1270	CA	2006-0071	NA	11-08-06	APPROVED
1271	CA	2006-0072	NA	11-08-06	APPROVED
1272	CA	2006-0073	NA	11-08-06	APPROVED
1273	CA	2006-0074	NA	11-08-06	APPROVED
1274	CA	2006-0075	NA	11-08-06	APPROVED
1275	CA	2006-0076	NA	11-08-06	APPROVED
1276	CA	2006-0077	NA	11-08-06	APPROVED
1277	CA	2006-0078	NA	11-08-06	APPROVED
1278	CA	2006-0079	NA	11-08-06	APPROVED
1279	CA	2006-0080	NA	11-08-06	APPROVED
1280	CA	2006-0081	NA	11-08-06	APPROVED
1281	CA	2006-0082	NA	11-08-06	APPROVED
1282	CA	2006-0083	NA	11-08-06	APPROVED
1283	CA	2006-0084	NA	11-08-06	APPROVED
1284	CA	2006-0085	NA	11-08-06	APPROVED
1285	CA	2006-0086	NA	11-08-06	APPROVED
1286	CA	2006-0087	NA	11-08-06	APPROVED
1287	CA	2006-0088	NA	11-08-06	APPROVED
1288	CA	2006-0089	NA	11-08-06	APPROVED
1289	CA	2006-0090	NA	11-08-06	APPROVED
1290	CA	2006-0091	NA	11-08-06	APPROVED
1291	CA	2006-0092	NA	11-08-06	APPROVED
1292	CA	2006-0093	NA	11-08-06	APPROVED
1293	CA	2006-0094	NA	11-08-06	APPROVED
1294	CA	2006-0095	NA	11-08-06	APPROVED
1295	CA	2006-0096	NA	11-08-06	APPROVED
1296	CA	2006-0097	NA	11-08-06	APPROVED
1297	CA	2006-0098	NA	11-08-06	APPROVED
1298	CA	2006-0099	NA	11-08-06	APPROVED
1299	CA	2006-0100	NA	11-08-06	APPROVED

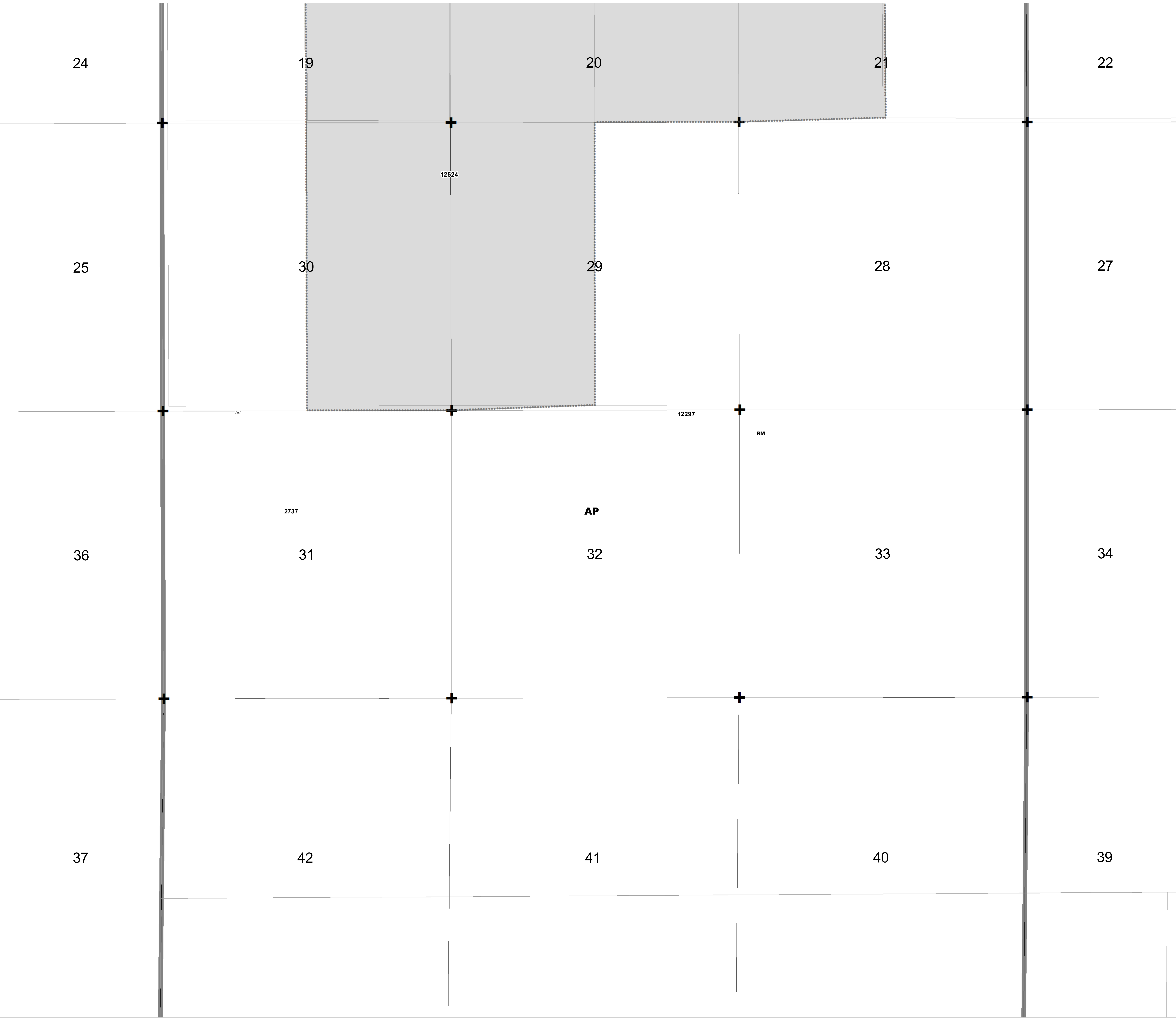

14	13	12	11	10	9	8	7	6	5	4	3	2	1
23	24	19	20	21	22	23	24	25	26	27	28	29	30
35	36	31	32	33	34	35	36	37	38	39	40	41	42
49	50	45	46	47	48	49	50	51	52	53	54	55	56
67	68	63	64	65	66	67	68	69	70	71	72	73	74
85	86	81	82	83	84	85	86	87	88	89	90	91	92

**ZONING QUAD 175**  
 Zoning District Map of Palm Beach County  
 February 19, 2014

1234-5	Additional Approvals		Overlays		Water
	Zoning Quad Boundary		Parcels		Section Lines
	Zoning District Boundary		Municipality		
	Corresponding PDD (CPDD) -Pursuant to Article 3.A.2.D of the ULDC (amended under Ordinance 2012-003) The Zoning Director has the authority to update the Official Zoning Map administratively to delineate a Planned Development District that corresponds to those prior approvals that are specified in Art.3.A.3.E.2, Planned Development Districts.				1 inch = 600 feet 0 600 1,200 Feet

