

S. R. 706 INDIANTOWN ROAD

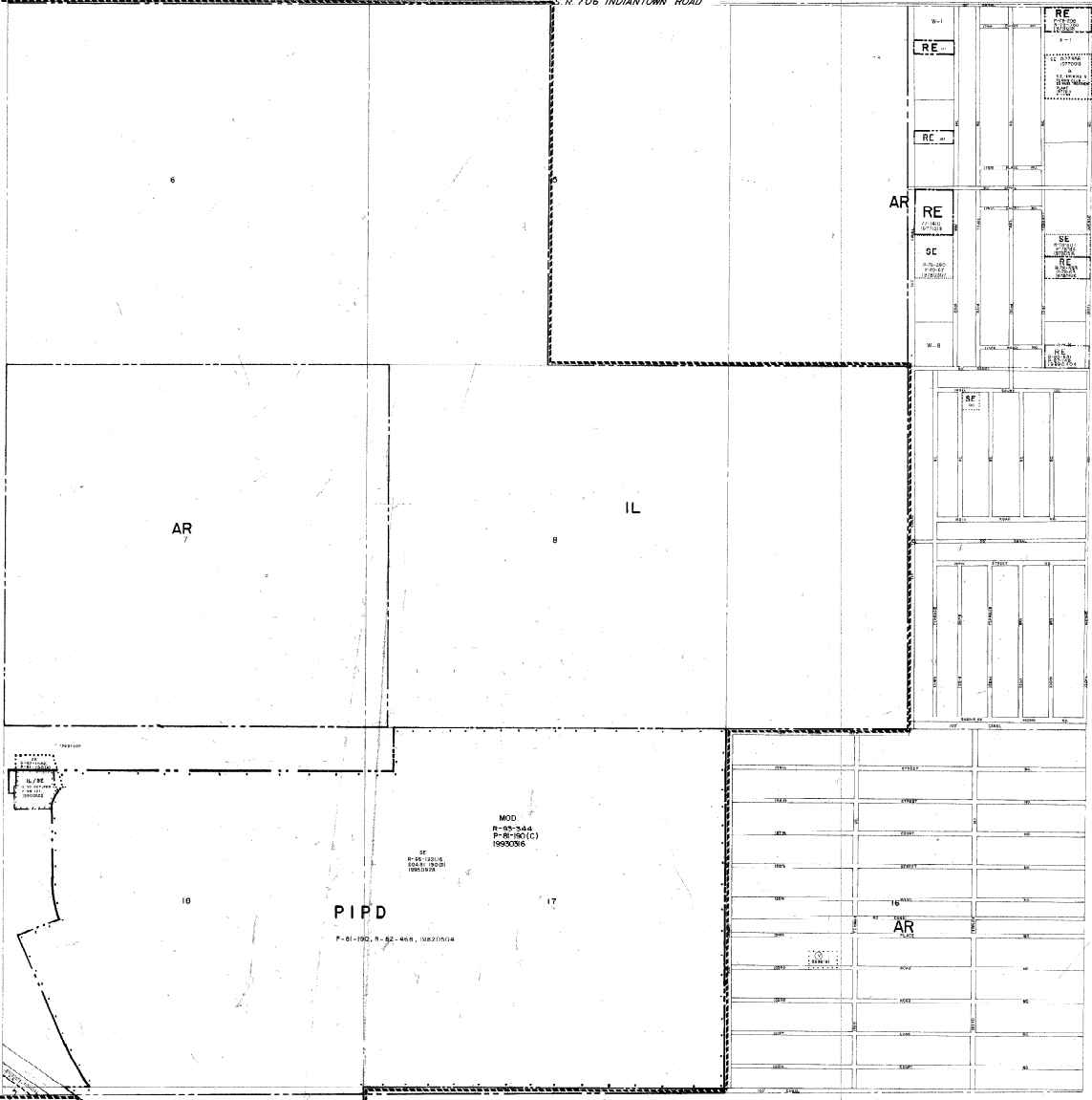

11/98
12/01
10/02

MOD.
R-53-54.4
P-R-100(C)
1993/036

PIP
P-61-192, R-62-46 R, 1082/0104

RESOLUTIONS	

RT-D
DISTRICT BOUNDARIES
CORPORATE BOUNDARIES

The zoning category for the property indicated on this sheet may not be consistent with the property's future land use. Interested parties are encouraged to contact the Palm Beach County Planning Department at 1111 Australian Avenue, West Palm Beach, FL 33409, (561) 835-3500, to discuss the property's future land use designation and other relevant comprehensive plan requirements.

PALM BEACH COUNTY, FLORIDA
OFFICIAL ZONING DISTRICT MAP
 Scale 1" = 600' approx. Date 4-1-73
 District 61-61 B Sheet No. 71

B A
C D